



Recycler[®] Kit

42 inch Mower for TimeCutter[®] Z Riding Mowers

Model No. 79218

Installation Instructions

Note: Determine the left and right sides of the machine from the normal operating position.

Loose Parts

Note: Use the chart below to identify parts for assembly.

Description	Qty.	Use
Upper baffle	1	Installing the upper baffle
Bolt, 5/16 x 5/8 inch	3	
Flange nut, 5/16 inch	3	
Bolt, 1/4 x 5/8 inch	4	
Locknut, 1/4 inch	4	
Kicker plates	2	Installing the kicker plates
Phillips head screw, #8 x 5/8 inch	6	
Bolt, 1/4 x 5/8 inch	1	Installing the washout fitting
Discharge cover	1	Installing the discharge cover
Bolt, 1/4 x 2-3/4 inch	2	
Cap nut, 1/4 inch	2	
Decal	1	Installing the decal
Installation instructions	1	Read before installing kit

Preparing the Mower

1. Stop the engine and remove the ignition key.
2. Remove the mower from the unit as outlined in your *Operator's Manual*.
3. Turn the mower upside down.
4. Remove the blades from the mower as outlined in your *Operator's Manual*.

Installing the Upper Baffle

Complete the following procedure to convert to a mulching mower.

1. Remove the lock nut (3/8 inch) securing the discharge chute retaining rod to the deck. The lock nut is located on the underside of the deck. Save the fastener for later use.
2. Remove the bolts and flange nuts from the front side of the deck that line up with the three tabs of the upper baffle as shown in Figure 1.

Important The tabs in the upper baffle will line up with existing hardware on some decks. For example, the fasteners on the anti-scalp roller brackets may need to be removed to accommodate the upper baffle.

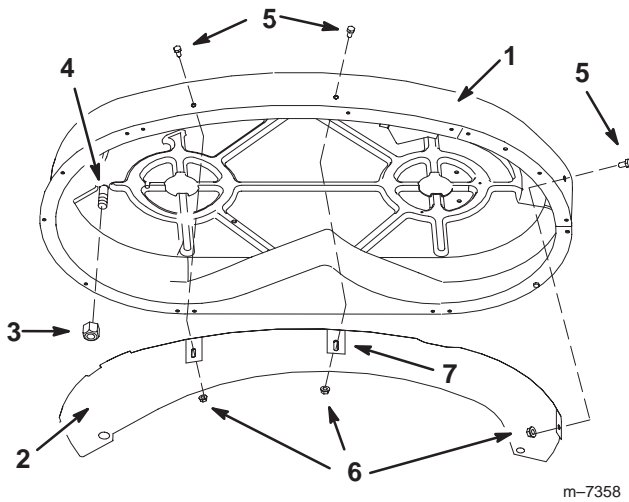

Figure 1

- | | |
|-----------------------------------|---------------------------|
| 1. Deck | 5. Bolts, 5/16 x 5/8 inch |
| 2. Upper baffle | 6. Flange nuts, 5/16 inch |
| 3. Lock nut, 3/8 inch | 7. Tabs, upper baffle |
| 4. Discharge chute retaining rod. | |

3. Install the upper baffle, tabs pointed down, into the deck as shown in Figure 2. Make sure the threads of the discharge chute rod come through the baffle hole.

4. Install the locknut removed previously over the threads of the discharge chute rod to secure the baffle to the deck (Fig. 2).

5. Press the baffle flush to the underside of the deck to make sure it is properly installed and the slotted holes in the baffle tabs line up with the holes in the side of the deck (Fig. 2).

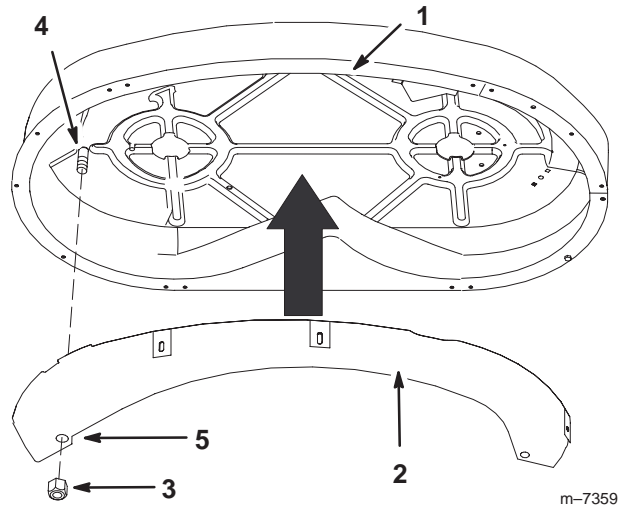

Figure 2

- | | |
|-----------------------|----------------------------------|
| 1. Deck | 4. Discharge chute retaining rod |
| 2. Upper baffle | 5. Baffle hole |
| 3. Lock nut, 1/4 inch | |

6. Install three bolts (5/16 x 5/8 inch) and three flange nuts (5/16 inch) through the side of the deck at each tab as shown in Figure 3. Install the fasteners with the nuts on the inside.

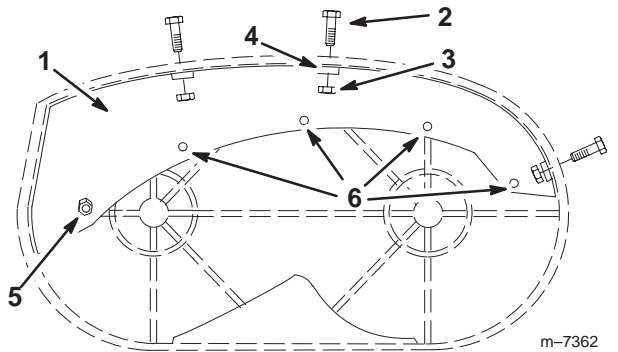

Figure 3

Bottom view

- | | |
|---------------------------|------------------------|
| 1. Upper baffle | 4. Tab |
| 2. Bolts, 5/16 x 5/8 inch | 5. Discharge chute rod |
| 3. Flange nuts, 5/16 inch | |

7. Check that the holes in the upper baffle (Fig. 3) line up with existing holes in the deck. If there are not pre-existing holes, the deck will need to be modified to accommodate the mulching kit. Proceed to the next section. If the deck has pre-existing holes skip ahead to the *Mounting the Baffle* section on page 4.

Altering the Mower Deck

1. Use the four holes in the upper baffle to mark spots in the deck for drilling holes (Fig. 4).
2. Drill four holes, 9/32 inch diameter, in the four spots marked in the deck.

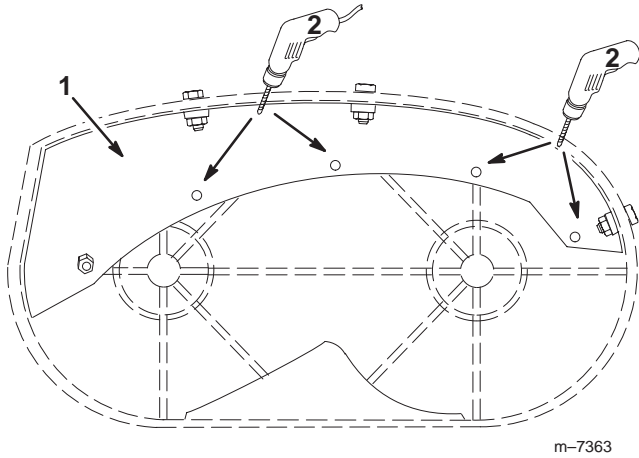

Figure 4
Bottom view

1. Upper baffle
2. Drill holes, 11/32 inch diameter

Removing the Washout Fitting

Remove the two carriage bolts, washers and locknuts securing the washout fitting to the deck. Save fasteners for later use (Fig. 5).

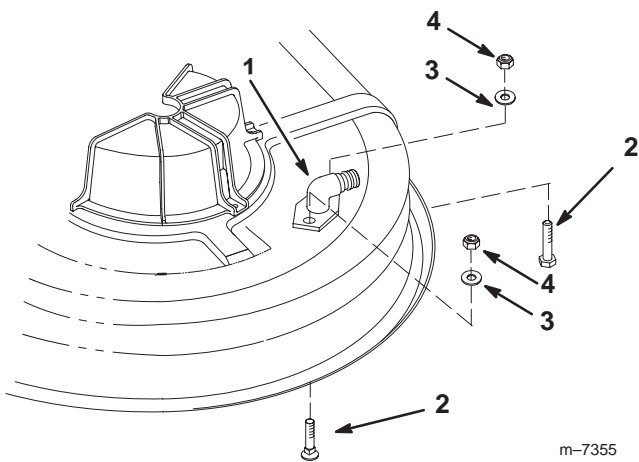

Figure 5

1. Washout fitting
2. Carriage bolt
3. Washer
4. Locknut

Drilling Kicker Plate and Washout Fitting Holes

1. Locate and cut out the templates located on pages 7 and 9.
2. Line up and tape Templates 1 and 2 in place on the top of the left side of the mower deck as shown in Figure 6.

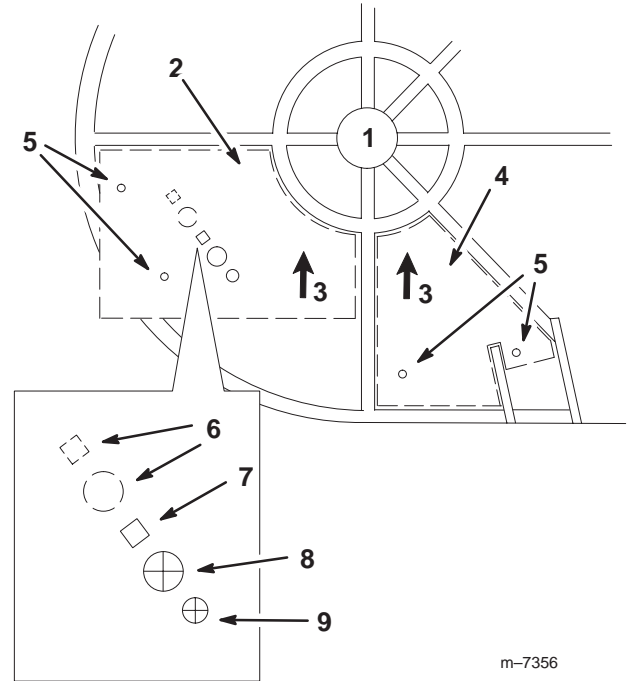

Figure 6
Top view

1. Left side of mower deck
2. Template 1
3. Orientation arrow
4. Template 2
5. Kicker plate drill holes, 13/64 inch diameter
6. Existing washout holes
7. Slotted reference hole, line up template with deck here
8. Washout fitting drill hole, 3/8 inch diameter
9. Washout fastener drill hole, 9/32 inch diameter

3. Mark the holes to be drilled with a punch or other sufficient tool.

Important When marking holes in Template 2, take care not to drill through any weldments on the deck. If necessary, adjust the template as a whole and maintain the correct distances between drill points to avoid any weldments.

4. Drill the holes as marked by the templates (Fig. 6).

Installing the Washout Fitting

The washout fitting will move from its previous position to the holes drilled previously using the Template 1.

1. Remove one carriage bolt from the existing fasteners and substitute a bolt (1/4 x 3/4 inch) located in loose parts.
2. Secure the washout fitting to the new holes with one bolt (1/4 x 3/4 inch), one washer (1/4 inch), and one lock nut (1/4 inch) as shown in Figure 7.
3. Use the carriage bolt (1/4 x 3/4 inch) in the existing open square hole, one washer (1/4 inch), and one lock nut (1/4 inch) as shown in Figure 7.

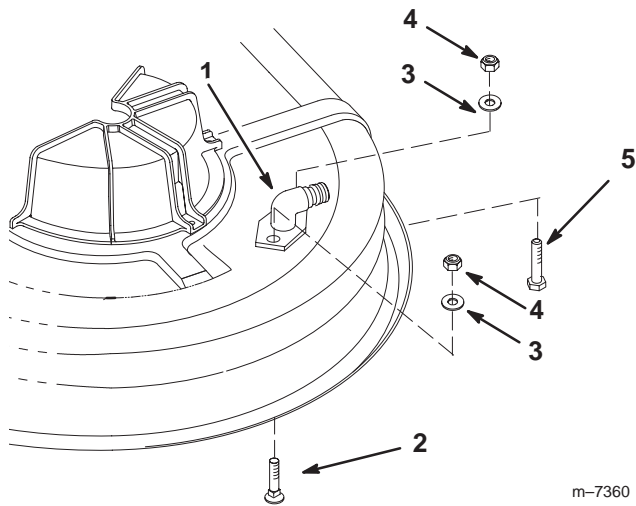

Figure 7

- | | |
|----------------------------------|-------------------------|
| 1. Washout Fitting | 3. Washer 1/4 inch |
| 2. Carriage Bolt, 1/4 x 3/4 inch | 4. Lock nut, 1/4 inch |
| | 5. Bolt, 1/4 x 3/4 inch |

Mounting the Upper Baffle

1. Secure the upper baffle to the deck.
2. Install four bolts (1/4 x 5/8 inch) in the baffle and up through the top of the deck and secure it with four lock nuts (1/4 inch) as shown in Figure 8.

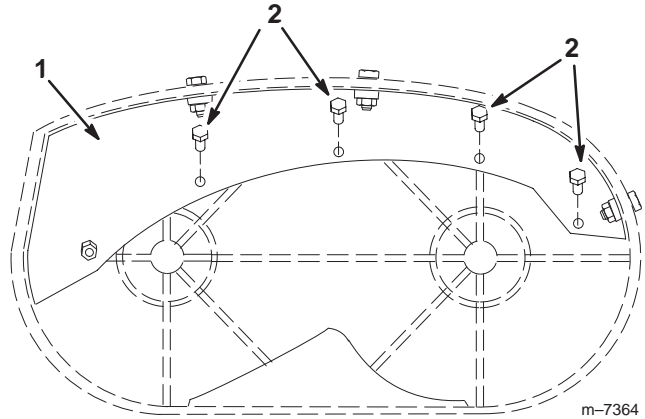

Figure 8

Bottom view

- | | |
|-----------------|--------------------------|
| 1. Upper baffle | 2. Bolts, 1/4 x 5/8 inch |
|-----------------|--------------------------|

Installing the Kicker Plates

1. Orientate the three kicker plates with holes toward the top of the deck (Fig. 9). The long slope of the kickers must be face inward as the kickers placed in clockwise fashion.
2. Secure the plates to the deck using six phillips head screws (#8 x 5/8 inch). The screws come from the top, down through the deck, and into the plate (Fig. 9).

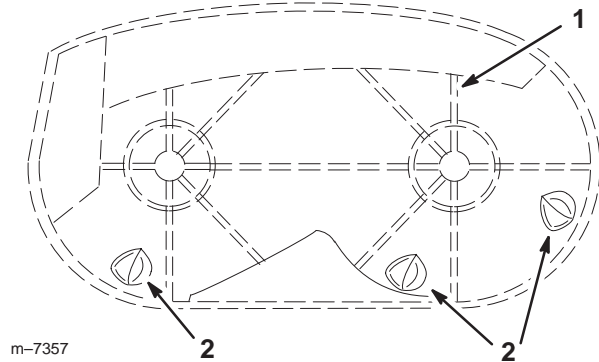

Figure 9

Bottom view

- | | |
|---------------|----------------------------|
| 1. Mower deck | 2. Kicker plate, installed |
|---------------|----------------------------|

Installing the Discharge Cover

1. Lift the grass deflector and slide the tabs on top of the discharge cover under the grass deflector retaining rod. Rotate the discharge cover down over the opening, and onto the lower lip of the mower (Fig. 10).
2. Secure the discharge cover to the lower lip of the mower with two bolts (1/4 x 2-3/4 inch) and two cap nuts (1/4 inch) as shown in Figure 10.

Note: Do not over-tighten the nuts, this could distort the cover and cause blade contact.

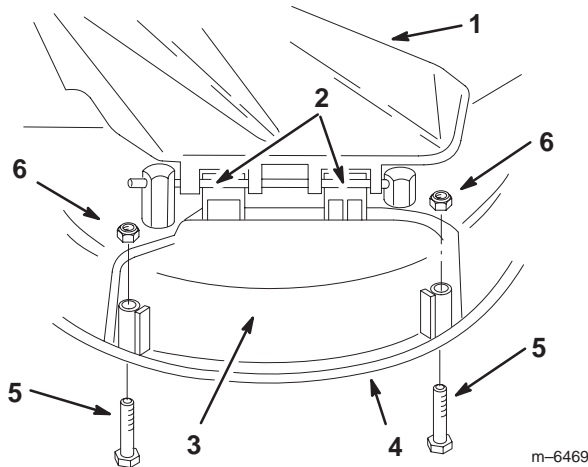

Figure 10

- | | |
|-----------------------------|---------------------------|
| 1. Grass deflector | 4. Lower lip of mower |
| 2. Tabs under retaining rod | 5. Bolt, 1/4 x 2-3/4 inch |
| 3. Discharge cover | 6. Nut, 1/4 inch |

Installing the Decal

Install the decal on left side of mower (Fig. 11).

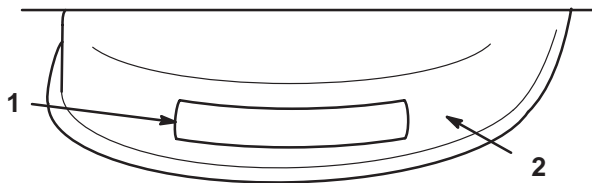

Figure 11

- | | |
|-------------------|-----------------------|
| 1. Recycler decal | 2. Left side of mower |
|-------------------|-----------------------|

Finishing the Installation

1. Install the blades removed previously to the mower as outlined in your *Operator's Manual*.
2. Install the mower to the unit as outlined in your *Operator's Manual*.

Removing the Discharge Cover

To convert to side discharge mode do the following procedure.

1. Stop the engine and remove the ignition key.
2. Remove the 2 bolts (1/4 x 2-3/4 inch) and 2 nuts (1/4 inch) that secure the discharge cover to the mower (Fig. 10).
3. Remove the discharge cover and lower the grass deflector over the discharge opening.

Side Discharge or Mulch Grass



Danger



Without the grass deflector, discharge cover, or complete grass catcher assembly mounted in place, you and others are exposed to blade contact and thrown debris. Contact with rotating mower blade(s) and thrown debris will cause injury or death.

- Never remove the grass deflector from the mower because the grass deflector routes material down toward the turf. If the grass deflector is ever damaged, replace it immediately.
- Never put your hands or feet under the mower.
- Never try to clear discharge area or mower blades unless you move the power take off (PTO) to *disengage* and turn the ignition key to *off*. Also remove the key and pull the wire off the spark plug(s).

Note: To use the mower in side discharge mode, only the discharge cover must be removed. Mounting hardware must be installed in open holes.

Ensure the mower has a hinged grass deflector that disperses clippings to the side and down toward the turf, while in side discharge mode.

To mulch grass clippings the discharge cover must be installed into the opening in the side of the mower; refer to Installing the Discharge Cover, page 5.

Recycling Tips

Selecting the Proper Height-of-Cut Setting to Suit the Conditions

Remove approximately one inch or no more than 1/3 of the grass blade when cutting. In exceptionally lush and dense grass you may have to raise the height-of-cut setting another notch or convert to side discharge or bagging operations.

Mowing in Extreme Conditions

Air is required to cut and recut grass clippings in the mower housing, so do not set the height-of-cut too low or totally surround the housing by uncut grass. Always have one side of the mower housing free from uncut grass, allowing air to be drawn into housing. When making an initial cut through the center of the uncut area, operate the machine at a slower speed and back up if the mower starts to clog.

Mowing at the Proper Intervals

Under normal conditions you'll need to mow every 4–5 days. However, grass grows at different rates at different times. Thus, in order to maintain the same height-of-cut, which is a good practice, you'll need to cut more frequently in early spring; as the grass growth rate slows in mid summer, cut only every 8–10 days. If you are unable to mow for an extended period due to the weather conditions or other reasons, convert to side discharge or bagging options or mow first with the height-of-cut at a high level; then mow again 2–3 days later with a lower height setting.

Always Mow with Sharp Blades

A sharp blade cuts cleanly and without tearing or shredding the grass blade like a dull blade. Tearing and shredding causes the grass to turn brown at the edges which impairs growth and increases susceptibility to disease.

Cleaning After Operating

To ensure optimum performance, clean the underside of the mower housing. If residue is allowed to build up in mower housing, cutting performance will decrease.

Template No. 1

Drill a $\frac{13}{64}$ inch hole here.

Drill a $\frac{13}{64}$ inch hole here.

Existing washout fitting holes

Drill a $\frac{3}{8}$ inch hole here.

Cut out square here. Line up with existing hole

Drill a $\frac{9}{32}$ inch hole here.

FRONT →

Cut out template here

Template No. 2

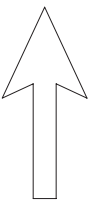
FRONT

Drill a 13/64 inch
hole here.

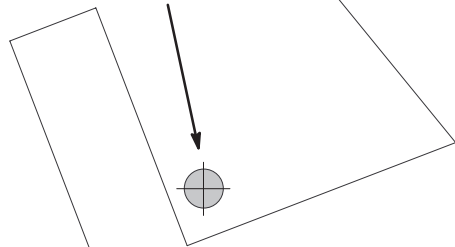

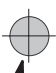
Drill a 13/64 inch
hole here.

Cut out template here

