



# Roll Over Protection System Kit

## 100 Series Z Masters

Part No. 107-3066

Form No. 3350-456 Rev A

### Installation Instructions

**Note:** This kit is used for replacing an existing ROPS or adding it to a machine without an existing ROPS.

## Loose Parts

**Note:** Use the chart below to identify parts for assembly.

Step	Description	Qty.	Use
<b>1</b>	No parts needed	–	Raising the machine up
<b>2</b>	No parts needed	–	Removing the rear tires
<b>3</b>	Template	1	Drilling holes for the ROPS
<b>4</b>	No parts needed	–	Removing the existing seat
<b>5</b>	Seat frame	1	Installing the new seat frame
<b>6</b>	Seat latch catch Bolt, 5/16 x 7/8 inch Locknut, 5/16 inch	1 2 2	Installing the new seat latch catch
<b>7</b>	Seat belt Bolt, 7/16 x 1 inch Locknut, 7/16 inch	1 2 2	Installing the seat belt
<b>8</b>	Roll bar, right section Roll bar, left section Roll bar, center section Bolt, 3/8 x 1 inch Curved washer, 3/8 inch Flange nut, 3/8 inch Bolt, 1/2 x 3-1/4 inches Flange nut, 1/2 inch Lanyard	1 1 1 8 8 8 2 2 2	Installing the roll over protection system (ROPS)
<b>9</b>	Domestic footrest decal International footrest decal International ROPS decal	1 1 1	Installing the Decals
<b>10</b>	Wheels	2	Installing the drive wheels
<b>11</b>	No parts needed	–	Checking the tire pressure



**Step****1****Raising the Machine Up****Parts needed for this step:**

None

**Procedure**

1. Loosen the wheel nuts from both sides of the vehicle.
2. Raise the back of the machine up and support it with jack-stands.

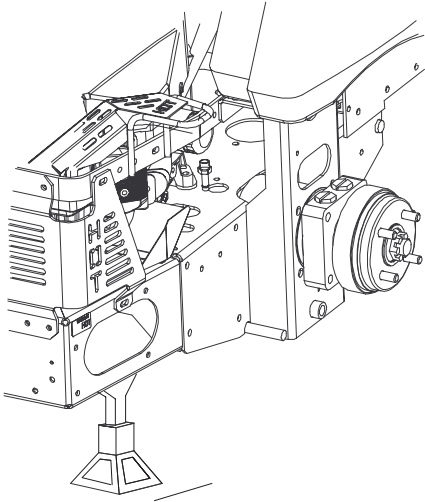

m-6919

**Step****2****Removing the Rear Tires****Parts needed for this step:**

None

**Procedure**

1. Remove the wheel nuts from both sides of the vehicle.
2. Remove the rear wheels.

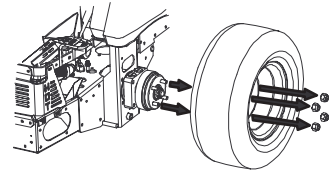

m-7026

## Step

## 3

## Drilling Holes for the Roll Over Protection System (ROPS)

**Note:** If you are replacing an existing ROPS, this step does not need to be performed.

### Parts needed for this step:

Qty.	Part
1	Template

### Procedure

1. Place the template to the side of the frame.

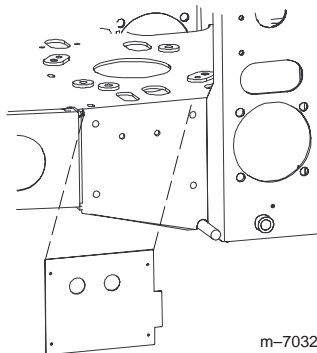

2. Align the template flush to the top of the frame and against the wheel motor frame.

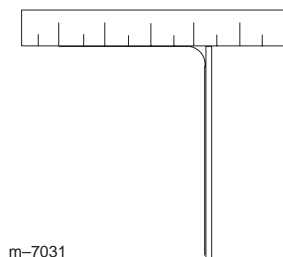
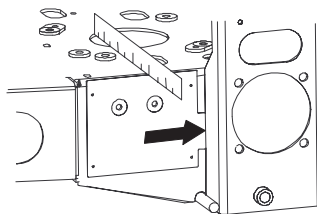

3. Clamp the template into place.

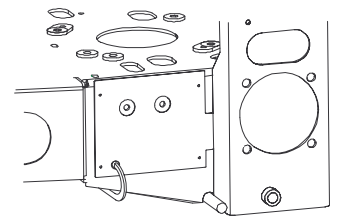

m-7035

4. Mark and center punch the holes in the template.

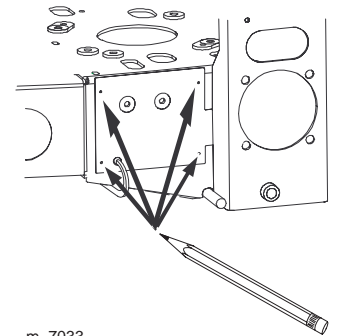

m-7033

5. Remove the template and drill 1/8 inch pilot holes in the marked locations.

6. Drill 13/32 inch holes through the 1/8 inch pilot holes.

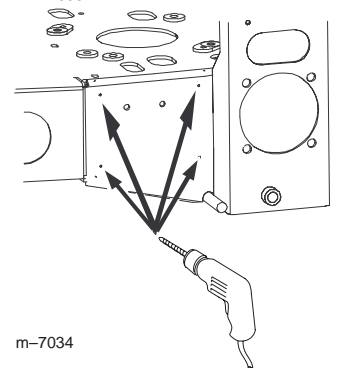

m-7034

7. Repeat this for the opposite side of the frame.

**Step****4****Removing the Existing Seat Frame****Parts needed for this step:**

None

**Procedure**

1. Remove the 2 bolts and 2 locknuts at the front of the seat where it is hinged. Save the hardware.

2. Remove the seat assembly from the machine.

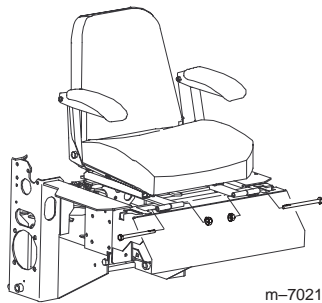

3. Remove the nut and bolt from the seat retaining rod.

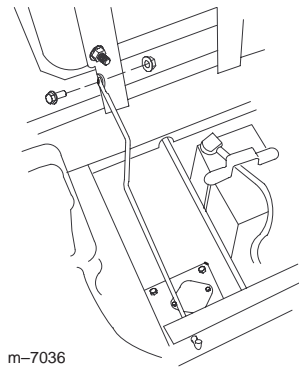

4. Remove the seat frame from the existing seat by removing the four locknuts. Discard the seat frame.



5. Install the seat retaining rod with the nut and bolt previously removed.

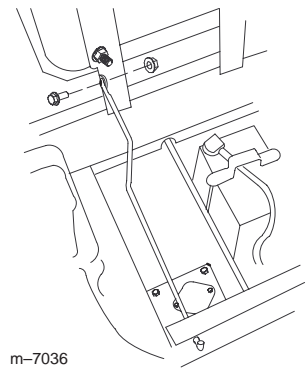

## Step

## 5

## Installing the New Seat Frame

### Parts needed for this step:

Qty.	Part
1	Seat frame

### Procedure

1. Install the seat to the new seat frame with the four locknuts previously removed.



2. Install the seat at the hinges with the 2 bolts and 2 locknuts previously removed.

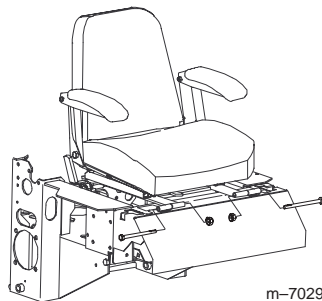

## Step

## 6

## Installing the Seat Latch Catch

### Parts needed for this step:

Qty.	Part
1	Seat latch catch
2	Bolt, 5/16 x 7/8 inches
2	Locknut, 5/16 inch

### Procedure

1. Locate the existing holes in the right side of the frame and drill the holes to 11/32 inch diameter.

2. Install the seat latch catch under the frame with 2 bolts (5/16 x 7/8 inch) and 2 locknuts (5/16 inch).

**Note:** The bent part of the latch catch should point downward.

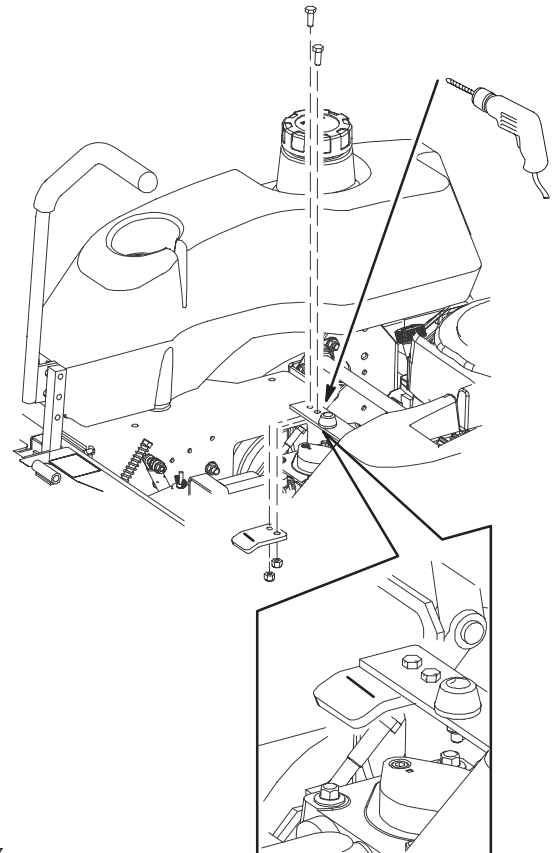

m-7027

**Step****7****Installing the Seat Belt****Parts needed for this step:**

Qty.	Part
2	Seat belt
2	Bolt, 7/16 x 1 inch
2	Locknut, 7/16 inch

**Procedure**

1. Install the receiver part of the seat belt between the cushion and the metal seat frame with 1 bolt (7/16 x 1 inch) and 1 locknut (7/16 inch).

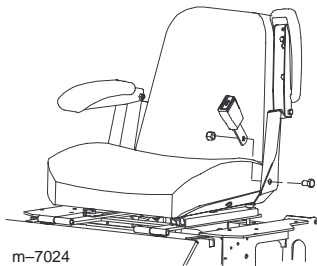

2. Install the long seat belt strap between the cushion and the metal seat frame with 1 bolt (7/16 x 1 inch) and 1 locknut (7/16 inch).

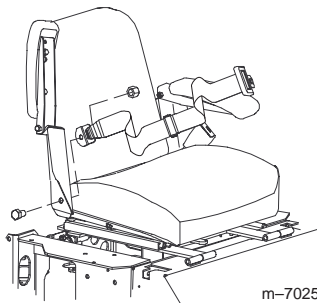
**Step****8****Installing the Roll Over Protection System (ROPS)****Parts needed for this step:**

Qty.	Part
1	Roll bar, right section
1	Roll bar, left section
1	Roll bar, center section
8	Bolt, 3/8 x 1 inch
8	Curved washer
8	Flange nut, 3/8 inch
2	Bolt, 1/2 x 3-1/4 inches
2	Flange nut, 1/2 inch
2	Lanyard

## Procedure

1. Loosely install the right and left roll bar sections to the frame, using 8 bolts (3/8 x 1 inch), 8 curved washers, and 8 flange nuts (3/8 inch).

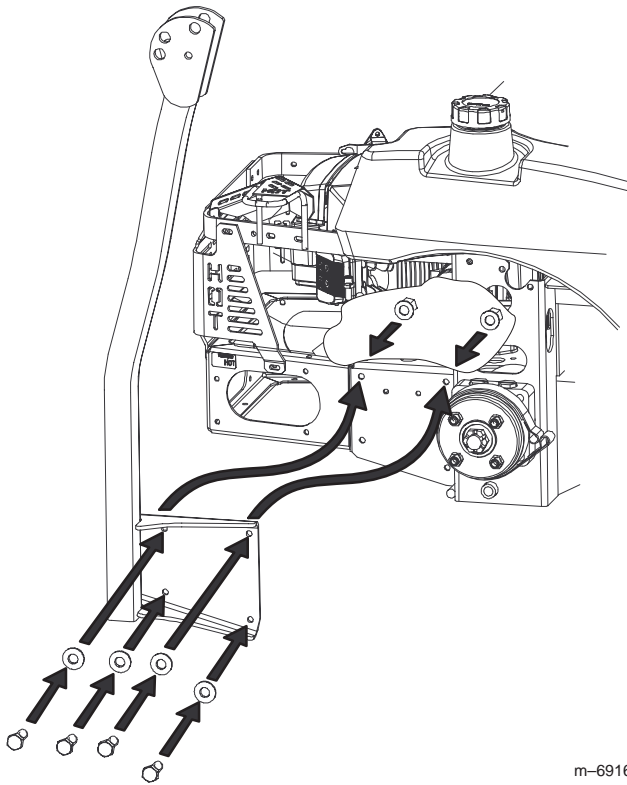

m-6916

2. Install the lanyard clips onto the 2 bolts (1/2 x 3-1/4 inches).

**Note:** Make sure the bent tab points toward the head of the bolt.

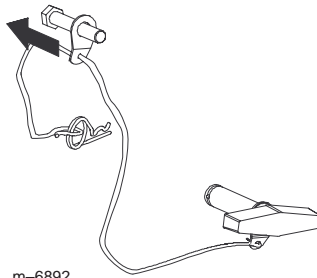

m-6892

3. Lightly oil the ends of the center roll bar section.

4. Loosely install the center roll bar section, using 2 bolts (1/2 x 3-1/4 inches) and 2 flange nuts (1/2 inch).

**Note:** Make sure the bolts are installed from the outside of the roll bar.

**Note:** Make sure the lanyard tabs are install as shown and point forward.

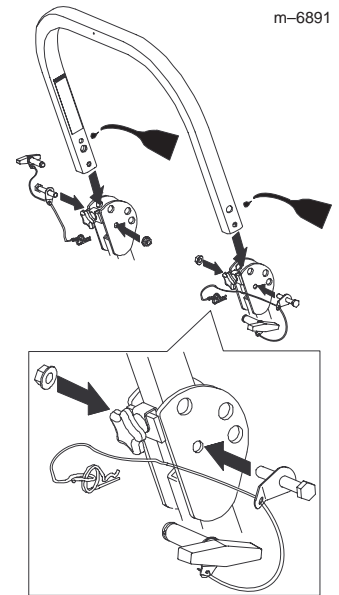

m-6891

5. Raise the roll bar into the upright position and secure it with the pins and hairpin cotter pins fastened to the lanyards.

6. Torque all lower fasteners, attached to the machine frame, to 30 ft-lb.

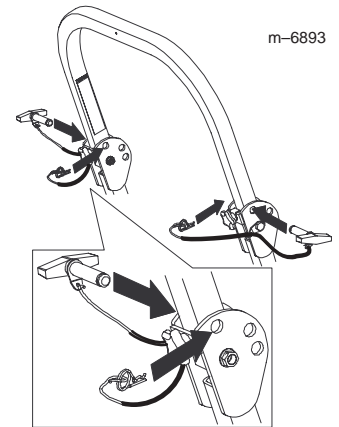

m-6893

7. Tighten the center roll bar bolts (1/2 x 3-1/4 inches) so the roll bar rotates freely with some resistance.

**Note:** No more than one thread should be exposed outside the nut.

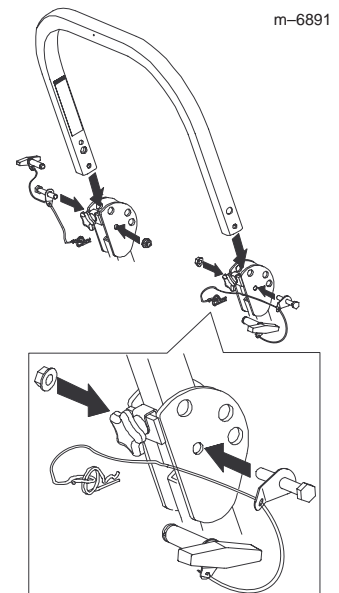

m-6891

8. Tighten the front handles against the center roll bar ends.

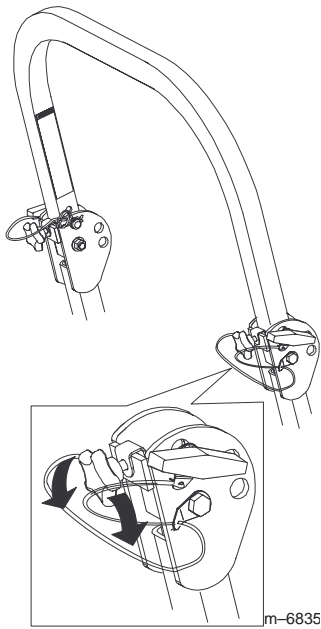

## Step

# 9

## Installing the Decals

### Parts needed for this step:

Qty.	Part
1	Domestic footrest decal
1	International footrest decal
1	International ROPS decal

## Installing the Footrest Decal on Domestic and International Machines

1. Install the footrest decal onto the footrest as shown.

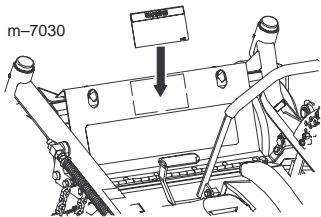

## Installing the ROPS Decal on International Machines Only

1. Install the international ROPS decal over the existing domestic decal on the inside of the ROPS.

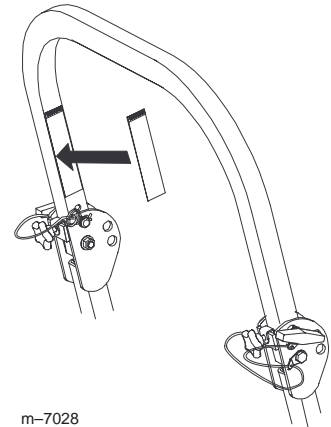

## Step

# 10

## Installing the Drive Wheels

### Parts needed for this step:

Qty.	Part
2	Rear wheels

### Procedure

1. Mount the wheels with the valve stem to the outside and secure them with the nuts previously removed in Step 1.
2. Torque the nuts to 95 ft-lb (128 N·m).

