



## Chute Ring Kit

### For Power Shift and Power Throw XL Snowthrowers

Part No. 108-7308

Form No. 3352-971

## Installation Instructions

1. Remove the chute assembly by removing the chute retainers, chute retainer plates, screws, and locknuts (Fig. 1).

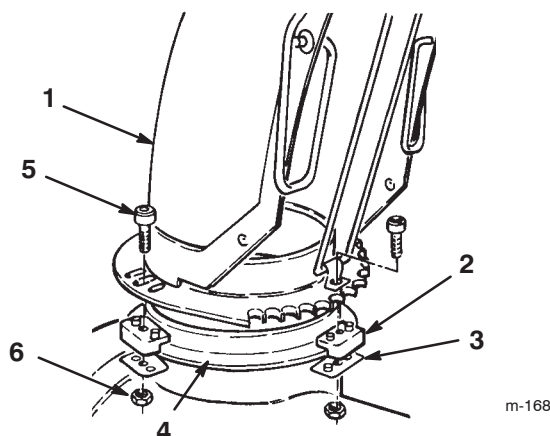

Figure 1

- |                             |                |
|-----------------------------|----------------|
| 1. Discharge chute          | 4. Chute ring  |
| 2. Chute retainer (3)       | 5. Screw (3)   |
| 3. Chute retainer plate (3) | 6. Locknut (3) |

2. Remove the worm gear, gear bracket, chute gear rod, carriage bolt, flat washer, and locknut (Fig. 2).

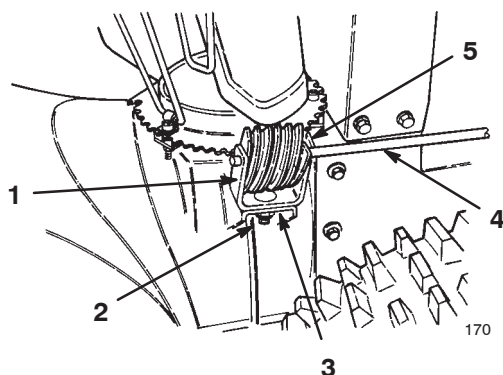

Figure 2

- |  |                    |
|--|--------------------|
| 1. Gear bracket                            | 3. Mounting flange |
| 2. Carriage bolt, flat washer, and locknut | 4. Chute gear rod  |
|  | 5. Worm gear       |

3. Chisel the weld and the remaining chute ring from the chute opening of the auger housing.
4. Grind the surface clean of excess weld and paint the surface.
5. Slide the new chute ring onto the chute opening and position it so that it is 1-1/4 inches (3.2 cm) from the top of the chute opening (Fig. 3).

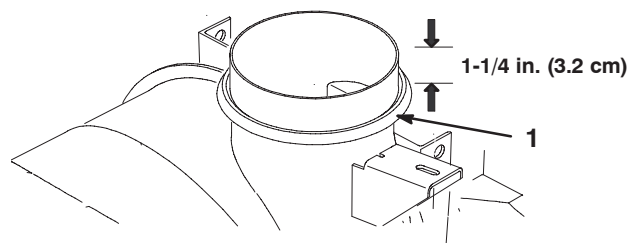

Figure 3

1. Chute ring

6. Weld the chute ring to the chute with 4 fillet welds (1/8-inch) that are 1 inch long and 90 degrees apart.
7. Grind or scrape any weld splatter or excess weld from the chute ring to allow the chute and retainers to freely rotate.
8. Paint the areas where you removed any paint.

## Installing the Discharge Chute

1. Apply a light coat of low-temperature grease to the chute ring (Fig. 4).

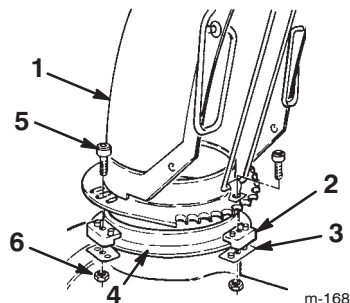

**Figure 4**

- |                             |                |
|-----------------------------|----------------|
| 1. Discharge chute          | 4. Chute ring  |
| 2. Chute retainer (3)       | 5. Screw (3)   |
| 3. Chute retainer plate (3) | 6. Locknut (3) |

2. Set the discharge chute (open side forward) onto the discharge opening so that the chute retainers are on the chute ring (Fig. 4).  
**Note:** Ensure that the chute retainer guide pins are in the holes in the chute gear.
3. Tighten the screw and the locknut on the left side to position the chute retainer against the chute retainer plate and to secure the discharge chute to the chute ring (Fig. 4).
4. Push the other chute retainers toward the discharge chute (slotted) and tighten the screws (Fig. 4).
5. Ensure that the chute rotates freely on the chute ring. If the chute binds, move the right-hand retainer outward (Fig. 4).

## Installing the Chute Control Worm Gear

1. Insert the 1-inch (2.5 centimeters) carriage bolt into the mounting hole of the gear bracket (Fig. 2).

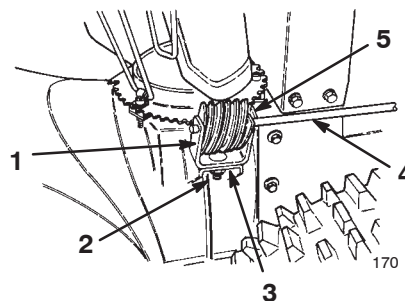

**Figure 5**

- |  |                    |
|--|--------------------|
| 1. Gear bracket                            | 3. Mounting flange |
| 2. Carriage bolt, flat washer, and locknut | 4. Chute gear rod  |
|  | 5. Worm gear       |

2. Position the worm gear into the bracket, align the holes, and insert the chute gear rod through the bracket and the gear (Fig. 2).
3. Loosely mount the worm gear and the bracket to the mounting flange with a carriage bolt, a flat washer, and a locknut (Fig. 2).
4. Slide the worm gear into the teeth of the chute gear and tighten the locknut.
5. Operate the chute control. If the chute control binds, apply a light coat of grease to the worm gear and move it slightly outward if it binds; move it slightly inward if it is too loose.