

19" FLYMO

MODEL NOS. 17000—500001 & UP

OPERATING AND SAFETY INSTRUCTIONS

Before you read this manual, or assemble, adjust and operate this mower, read these important safety precautions.

BEFORE STARTING —

1. Thoroughly inspect the area where the equipment is to be used and remove all stones, wire, bones, pieces of metal or other foreign objects.
2. Wipe up any gasoline spilled, and avoid spilling on hot engine.
3. Know how to stop equipment and engine quickly.

DURING OPERATION —

4. NEVER have children or pets near the equipment while engine is running.
5. NEVER leave equipment unattended while engine is running.
6. NEVER fill gasoline tank while engine is running.
7. NEVER remove any foreign objects next to or in the path of the equipment while engine is running.
8. NEVER put hands or feet under or in rotating parts or hidden areas, using special caution to keep hands and feet out of and away from cutter elements, belts, pulleys, gears, etc. while engine is running.
9. NEVER work on equipment while engine is running.
10. NEVER operate equipment in wet grass.
11. NEVER operate equipment when dark or hard to see.
12. NEVER operate equipment when barefooted or wearing open sandals.
13. NEVER remove blade or belt guards while engine is running.

MISCELLANEOUS —

14. Disconnect spark plug wire before working on equipment.
15. Maintain a solid and firm footing while mowing.
16. Never run engine indoors.
17. Read manual thoroughly.

These safety suggestions are recommended by Outdoor Power Equipment Institute and Toro Manufacturing Corp.



OWNER'S OPERATING AND INSTRUCTION MANUAL



TO THE TORO OWNER . . .

You have acquired an exceptional unit which will give you a new concept in mowing equipment and will provide many seasons of service . . . a quality product supported by Toro's many years of conscientious and dependable service.

This Owner's Manual is provided to assist you in setting up, operating and maintaining your Flymo mower. Read this manual carefully. It contains important instructions and recommendations for use that will enable you to realize Flymo's maximum capabilities. Save this manual and refer to it often.

In an effort to make improvements available to Toro owners as quickly as possible, minor changes are incorporated into Toro's products from time to time that do not become immediately shown in the Owner's Operating Manual. If such a change apparently has been made in your unit, which is not reflected in your manual, see your Toro distributor or his authorized Toro service dealer for information and parts numbers.

INDEX

Specifications	Page 3
Setting Up Instructions	3
Fuel	4
Starting Instructions	4
Height of Cut Adjustment	5
Carrying Your Flymo	5
Mowing Tips	5
Stopping Instructions	6
Operating Tips and Precautions	6
Mowing Pattern	6
Storage	7
Cutter Blade	7
Carburetor Instructions	8
Air Filter Service Instructions	9
Schematic Drawing and Parts List	10

Warranty

The Manufacturer warrants each new piece of equipment sold to be free of defects in material and workmanship. For one year from the purchase date of consumer line equipment or 45 days if sold for commercial use, Toro Manufacturing Corporation will repair or replace for the original purchaser, free of charge, through any Authorized Service Dealer, any part or parts found at our factory in Minneapolis, Minnesota, to be defective under normal use and service. All institutional equipment is warranted for ninety (90) days from the purchase date.

This Warranty does not obligate the Manufacturer to bear the cost of transportation charges in con-

nection with the replacement or repair of defective parts -- nor shall it apply to a machine upon which repairs or alterations have been made, unless authorized by the manufacturer.

This Warranty does not include nor cover standard accessories produced by other manufacturers. Such accessories have separate warranties by their respective manufacturers . . . and repair or exchange will be made on the basis of such warranties, and the policies authorized by them shall be adhered to.

This Warranty is in lieu of all other warranties expressed or implied.

SPECIFICATIONS

ENGINE: Easy starting 2½ h.p., 2 cycle engine, recoil starter, 1 qt. fuel

FAN: Injection molded nylon with press fitted die cast zinc hub

DIMENSIONS: Wall Storage – Length 61"; Width 24"; Height 12"

CUTTER BLADE: 19" long hardened and drawn alloy steel

HEIGHT OF CUT: Approx. ¾" and 1-1/4"

HOUSING: Fiberglass-Polyester

WEIGHT: 30 pounds

WIDTH OF CUT: 19"

SETTING UP INSTRUCTIONS

Unpack your Flymo with care to avoid damaging the unit or misplacing the loose items. Inspect the unpacked items carefully to make sure no damage occurred during shipment. Remove the mower and all loose items from the carton.

Attach the handle to the mower as follows:

1. Place the lower handle onto bracket pins "C" of the main frame and fasten with cotter pins "D" on each side. (See illustration)
2. Next, connect the upper and lower handle halves together with attaching bolts and nuts ("A" and "B") contained in the loose parts bag.
3. Place the handle splice "E" over the two sections as illustrated and secure with screws "F".

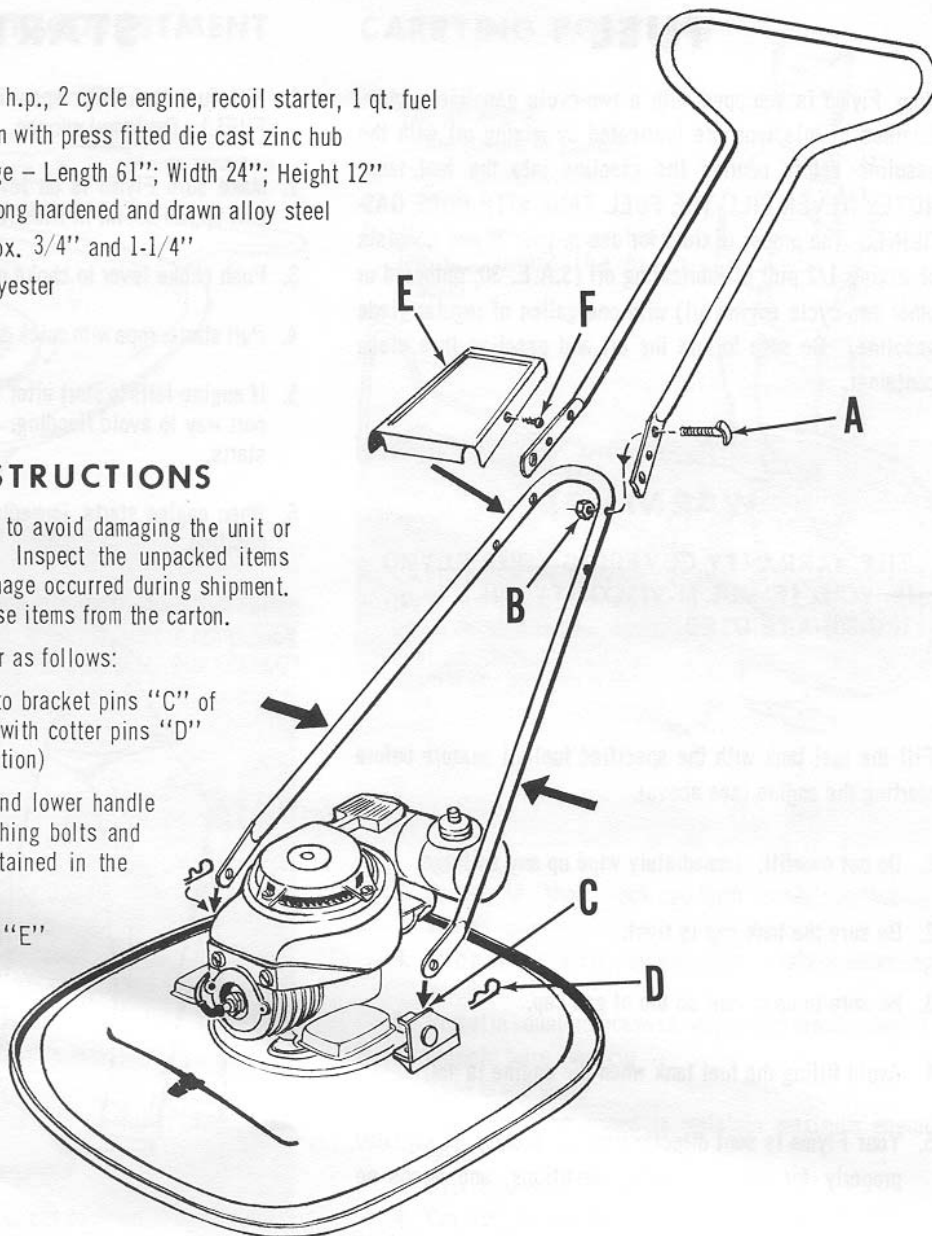

FUEL

Your Flymo is equipped with a two-cycle gasoline engine. Engines of this type are lubricated by mixing oil with the gasoline before pouring the gasoline into the fuel tank. NOTE: NEVER FILL THE FUEL TANK WITH PURE GASOLINE. The proper mixture for use in your Flymo consists of mixing 1/2 pint of lubricating oil (S.A.E. 30, outboard or other two-cycle engine oil) with one gallon of regular grade gasoline. Be sure to mix the oil and gasoline in a clean container.

WARNING!

THE WARRANTY COVERING YOUR FLYMO IS VOID IF MULTI-VISCOSITY OILS (e.g., 10W-30) ARE USED.

Fill the fuel tank with the specified fuel-oil mixture before starting the engine (see above).

1. Do not overfill. Immediately wipe up any spillage.
2. Be sure the tank cap is tight.
3. Be sure to open vent on top of gas cap.
4. Avoid filling the fuel tank when the engine is hot.
5. Your Flymo is sent directly from the factory, is adjusted properly for normal mowing conditions, and needs no alterations.

STARTING

1. Fill fuel tank with specified fuel-oil mixture (refer to FUEL). Replace tank cap.
2. Make sure Flymo is on level surface. (If in grass, tip unit up, as shown in illustration below.)
3. Push choke lever to choke position.
4. Pull starter rope with quick steady strokes to start engine.
5. If engine fails to start after four or five pulls, open choke part way to avoid flooding. Pull starter rope until engine starts.
6. When engine starts, immediately push choke lever to run position.

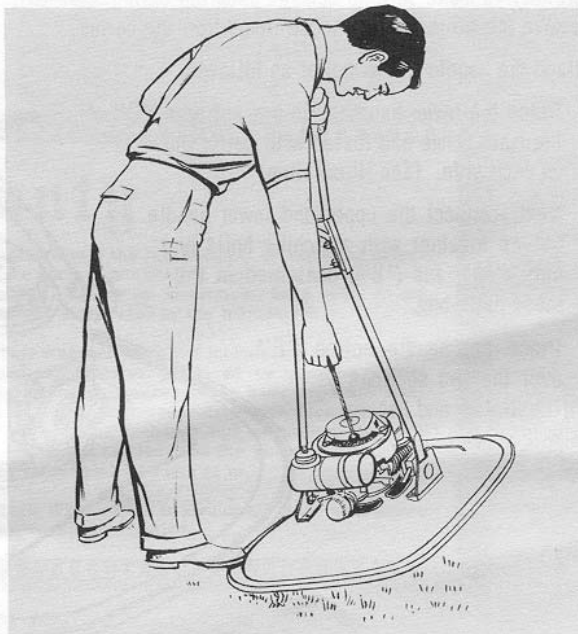

HEIGHT OF CUT ADJUSTMENT

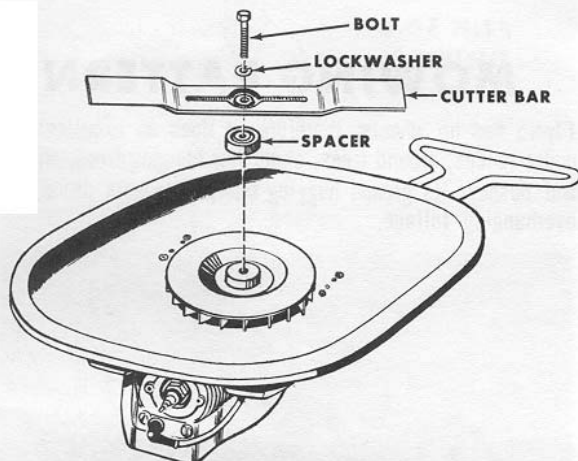

Your Flymo comes from the factory with the height of cut set at 3/4" with spacer installed. When the spacer is removed, height of cut becomes 1-1/4". **BE SURE TO DISCONNECT SPARK PLUG WIRE** when changing height of cut.

CARRYING POSITION

- Shut off engine
- Lower handle to ground
- Close adjustable vent on fuel cap
- With one hand, grasp a handle leg just behind the pivot bracket

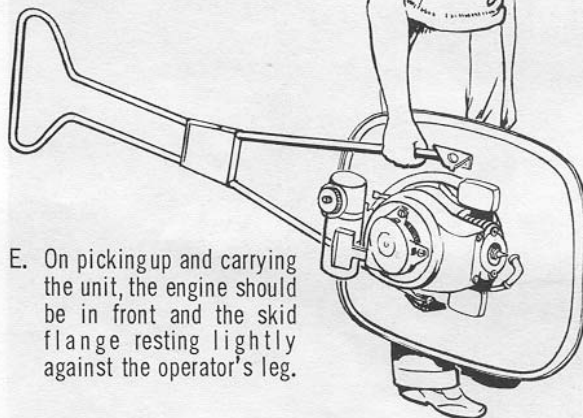

- On picking up and carrying the unit, the engine should be in front and the skid flange resting lightly against the operator's leg.

MOWING TIPS

- To eliminate engine stalling and/or improve floatation
 - Keep the cutter blade sharp
 - Reduce walking (ground) speed
 - Reduce pushing angle (the angle the handle makes with respect to the ground)
 - Pull mower backwards; this may be a necessity for cutting high grass.
 - Remove blade spacer to attain a higher height of cut
- To minimize windrowing
 - Cut more frequently
 - Cut at a higher height of cut position
 - Propel in short back-and-forth amply-overlapping swaths
 - Propel in short, side-to-side, amply-overlapping swaths
 - Propel in counterclockwise, amply-overlapping swaths
- To promote more even cut
 - Keep blade sharp
 - Reduce ground speed to maintain maximum engine speed
 - Overlap swaths
 - Cut more frequently

STOPPING

To stop the engine, push the choke lever back to the stop position, as indicated on the decal in photo below.



OPERATING TIPS AND PRECAUTIONS

1. It is good practice to keep areas requiring mowing free of stones, toys and other foreign objects.
2. Avoid spilling gasoline on the engine while it is hot. Wipe up any spilled fuel immediately.
3. Never attempt to adjust the cutter blade while the engine is running.
4. Use only the fuel-oil mixture specified under "FUEL" in this manual.

5. DISCONNECT SPARK PLUG WHEN WORKING ON CUTTER BAR.

MOWING PATTERN

Flymo has no wheels; therefore, it does an excellent job under fences, around trees, under low hanging trees, shrubs and bushes. Its ground hugging design prevents damage to overhanging foliage.

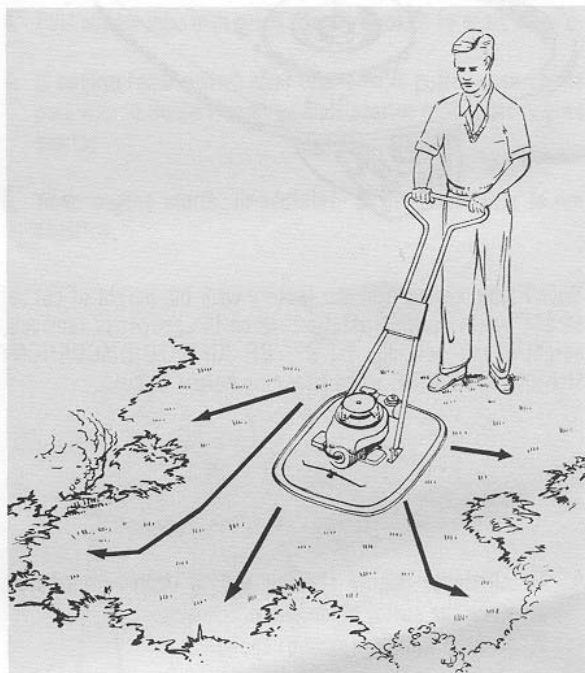

As a mower for slopes and terraces, Flymo is an outstanding performer. Its floatation and light weight make it easier to handle than conventional mowers and prevents scalping the lawn.

Flymo is a totally new concept in lawn maintenance. It utilizes many of the good features of ordinary rotary mowers

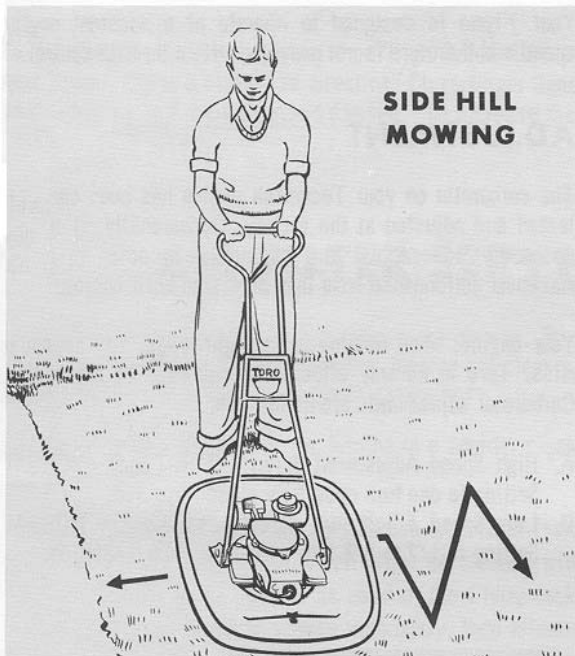

2. Disconnect the spark plug wire.
3. Close vent on top of gas cap.

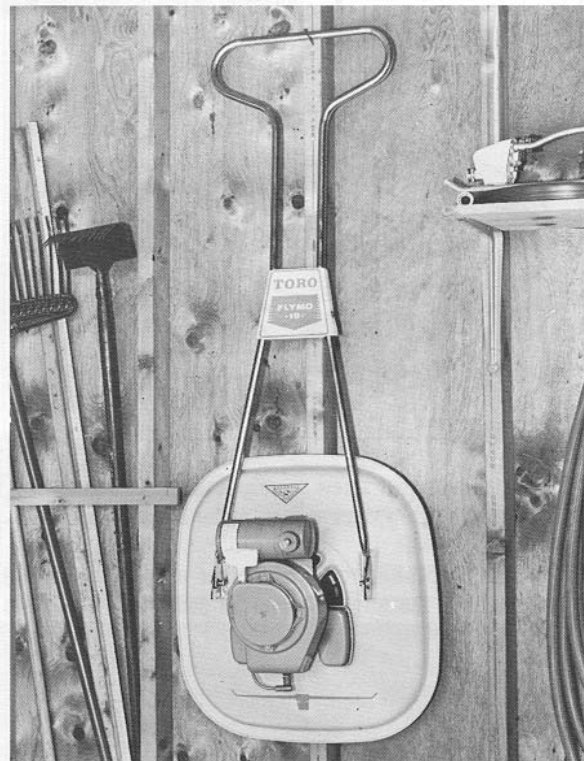

and contributes a number of new ones. The unit can be operated by pushing, pulling, side-angling up and down on slopes. Flymo hovers 1/4 inch above the turf, nudging objects away from the housing unit rather than riding over them. The housing is completely enclosed so that no foreign objects can be picked up. It floats on air!

STORAGE

Flymo is lightweight and can be easily carried with one hand. When transporting the machine, carry as shown in the illustration on page 5. Its light weight also makes it convenient and easy to store on a wall where it is out of the way.

For storing, do the following:

1. Raise handle by pulling handle up when mower is on flat surface.

CUTTER BLADE

The cutter blade is 19" long, made of hardened and drawn alloy steel. The cutter bar is fastened to the unit in the following order: spacer, cutter bar, lockwasher and bolt (see illustration on page 8). Follow the instructions below for sharpening and balancing the cutter blade.

1. To remove cutter bar:
 - a. Disconnect spark plug end wire

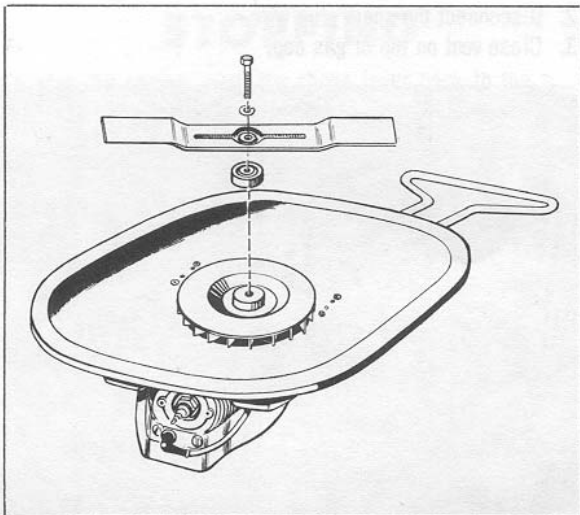

- b. Turn cutter bar screw sharply counter clockwise
- c. Remove screw, lockwasher, cutter bar and spacer

- 2. Sharpen the cutting ends of the bar with a 10 inch file to as close to the original bevel as possible. Keep blade ends razor sharp.
- 3. Balance the blade on the Toro blade balancer. The same amount should be taken off each end of bar.

CARBURETOR

FUEL MIXTURE

Mix in a clean container, 1/2 pint of Toro 2-cycle engine oil per gallon of regular gasoline. This mixture assures positive lubrication. Warranty void if multi-viscosity (10W-30) oils are used.

Your Flymo is designed to operate at a constant engine speed and therefore is not provided with a throttle control.

ADJUSTMENT

The carburetor on your Tecumseh engine has been carefully tested and adjusted at the factory. Occasionally, it may be necessary to readjust the carburetor in order to obtain maximum performance from this precision-built engine.

Your engine, when running under light loads, may appear to miss. This in no way affects the operation of the engine. Carburetor adjustments are as follows:

- A. High Speed Adjustment Screw - (Full Load) - NORMAL Setting is one turn open from closed position.
- B. Low Speed Adjustment Screw - (No Load) - NORMAL Setting is 1/2 to 5/8 turn open from closed position.

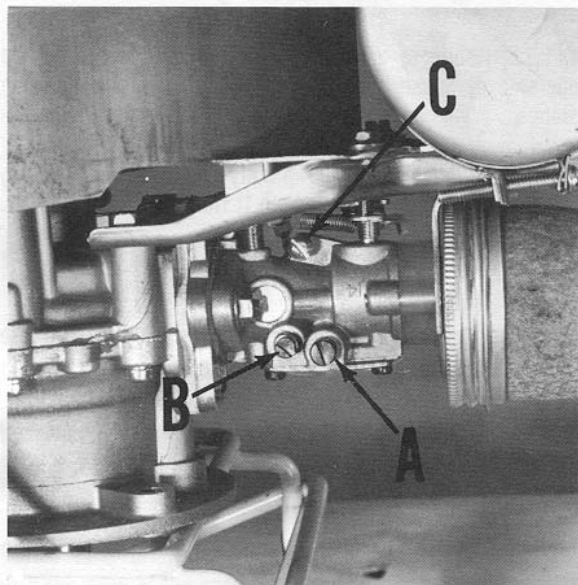

To decrease the fuel supply, turn the "High Speed Adjustment Screw" (A) in a clockwise direction. Close finger tight only -- forcing will cause serious damage. To increase the

fuel supply, turn the "High Speed Adjustment Screw" (A) in a counterclockwise direction.

AIR FILTER SERVICE INSTRUCTIONS

1. Lift up on retaining clip and remove pre-cleaner. Remove any dirt accumulation by either tapping pre-cleaner to loosen dirt or washing out with garden hose.
2. Remove air filter element by turning in a counter clockwise direction.
3. It is recommended that the nylon mesh type filter (next to carburetor) and the inner felt filter be cleaned with the 2 cycle gas-oil mixture as used in the Flymo tank. The 2 filters should be shaken vigorously, then allowed to dry from 5 to 10 minutes. This is necessary to insure proper engine speed.
4. Outer air cleaner (Biscuit-type) filter element should also be cleaned as outlined in step 2.
5. Be sure to replace filters as they were removed from the air cleaner. See photo at right for proper positioning.
6. After all items have been cleaned, re-assemble in reverse order.

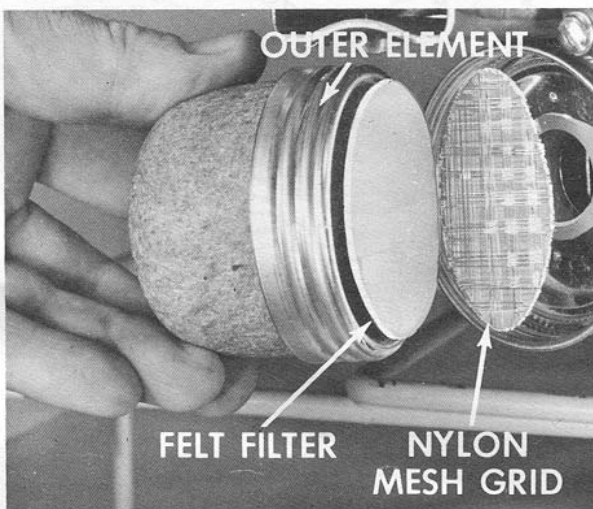
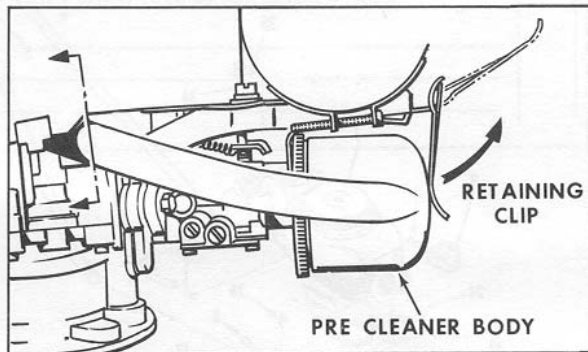

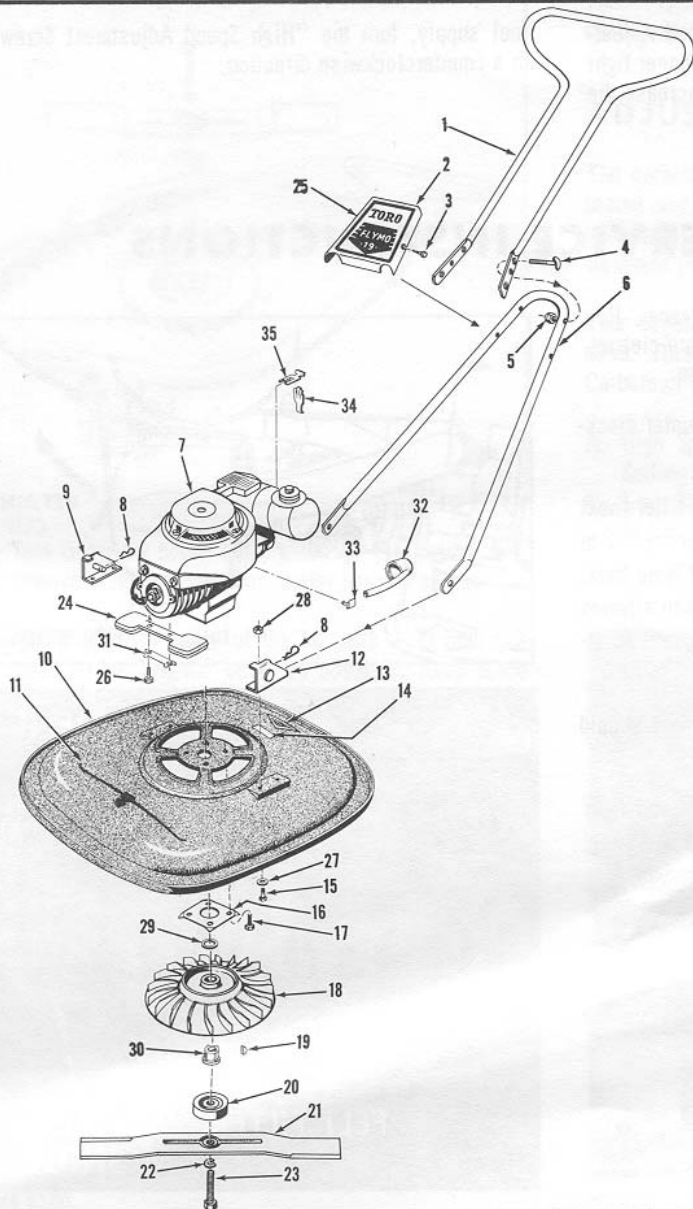

Ref. No.	Part No.	Description	No. Used
1	3-7708	Handle, Upper	1
2	3-7707	Plate, Cover	1
3	32104-75	Screw	2
4	3-2654	Screw, Handle	4
5	32149-2	Nut	4
6	3-7711	Handle, Lower	1
7	221-249	Engine	1
8	3290-250	Cotter, Hairpin	2
9	3-7744	Bracket, Handle	1
10	3-7715	Housing	1
11	3-7765	Decal	1
12	3-7745	Bracket, Handle	1
13	5-1423	Decal, A.S.A.	1
14	3-7756	Decal	1
15	329-3	Screw	4
16	3-7752	Plate, Locking	1
17	322-4	Screw	4
18	3-7748	Fan Assembly	1
19	3257-3	Key	1
20	3-7753	Spacer	1
21	5-1225	Blade	1
22	3253-26	Lockwasher	1
23	3-7754	Screw, Special	1
24	3-8296	Muffler	1
25	3-7763	Decal	1
26	3-8297	Screw	2
27	3256-2	Washer	4
28	3296-13	Stop Nut	4
29	32151-10	Ring, Retaining (Use on machines starting with 500001 & up)	1
29	32151-9	Ring, Retaining (Use on machines starting with 514535 & up)	1
30	3-7751	Hub	1
31	3-8393	Lock Clip	1
32	5-1220	Pre Cleaner Body	1
33	2412-27	Clamp	1
34	5-1331	Retainer Clip	1
35	5-1330	Clip, Pivot	1



Manufacturing Corporation

Minneapolis, Minnesota 55420 U.S.A.

For Local Service...

...on your TORO equipment consult the yellow business section of your telephone directory. . . .



If No Local Service...

... is available, cut out this coupon on the dotted line and paste to a postcard. TORO will send you a list of Authorized Service Dealers. Address your card to:



TORO Manufacturing Corp.
300 West 82nd Street
Minneapolis 20, Minnesota

GENTLEMEN:

Please mail me one copy of TORO National Service Directory

NAME _____

STREET _____ R.R. NO. _____

CITY _____ ZONE _____ STATE _____

Throws 1/2 ton of snow a minute!

LIGHTWEIGHT, MANEUVERABLE, COMPACT, EASY TO USE

SNOW PUP[†] AND SNOW HUSKY[†]

BY
TORO[®]



Use as a scoop or push type snow thrower. Clears walks and drives in minutes. Ideal for hard-to-clean steps, porches, patios and under stalled cars and trucks. Throws heavy snow 15 feet in any of 7 directions with finger tip throw adjustment. Clears all kinds of snow — heavy or light — wet or dry.

TORO MANUFACTURING CORP.
MINNEAPOLIS, MINNESOTA 55420 — U.S.A.

[†]Exclusive mark of Toro Manufacturing Corp.