



# Hitch Kit

## Z100 and Z400 Series Z Master Mowers

Part No. 99-8924

Form No. 3352-996

### Installation Instructions

## Loose Parts

**Note:** Use the chart below to identify parts for assembly.

DESCRIPTION	QTY.	USE
Hitch	1	Installing the hitch
Bolt, 5/16 x 1 inch	4	
Locknut	4	
Bolt, 5/16 x 2 inch	4	

## Installing the Hitch

1. Disengage the PTO and set the parking brake.
2. Stop the engine, remove the key, and wait for all moving parts to stop before leaving the operating position.
3. Remove any existing hardware in the bottom four holes in the rear bumper (Fig. 1 and Fig. 2).
4. To install the hitch on a tractor with a rear counterweight, align the holes and tighten the locknuts and bolts (5/16 x 2 inch) (Fig. 1).
5. To install the hitch on a tractor with a heat shield, align the holes and tighten the locknuts and bolts (5/16 x 1 inch) (Fig. 2).
6. Torque the bolts to 200 in-lbs (22.6 N-m).



### Warning



**Components around engine will be hot if the engine has been running. Touching hot components can cause burns.**

- **Do not touch engine components when hot.**
- **Allow the machine to cool before performing maintenance.**

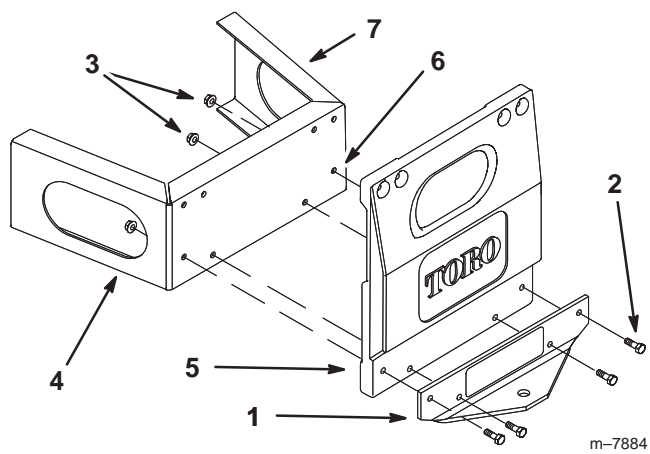

**Figure 1**

- |                        |                  |
|------------------------|------------------|
| 1. Hitch               | 5. Counterweight |
| 2. Bolt, 5/16 x 2 inch | 6. Bottom holes  |
| 3. Locknut             | 7. Rear bumper   |
| 4. Machine frame       |                  |

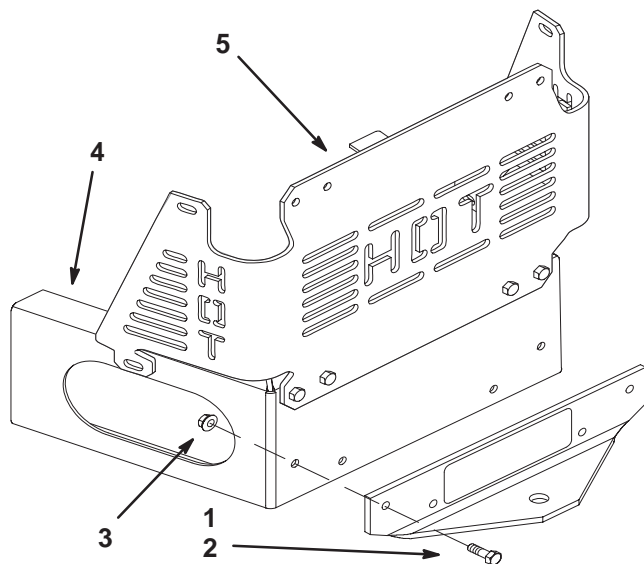

**Figure 2**

- |                        |                  |
|------------------------|------------------|
| 1. Hitch               | 4. Machine frame |
| 2. Bolt, 5/16 x 1 inch | 5. Heat shield   |
| 3. Locknut             |                  |