



# Deflector Kit for 44in Mid-Size Mowers

Part No. 107-4268

Form No. 3353-264

## Installation Instructions

### Loose Parts

**Note:** Use the chart below to identify parts for assembly.

DESCRIPTION	QTY.	USE
Rubber grass deflector	1	Installing the new grass deflector
Small spacer, 3/4 inch	1	
Medium spacer, 1-3/8 inch	1	
Large spacer, 4-7/8 inch	1	
Nut, 5/16 inch	1	
Bolt	1	

The following instructions are for installing a rubber deflector onto a 44 inch Mid-Size mower with metal grass deflector.

### Removing the Existing Grass Deflector

1. Remove the tension on the spring by unhooking the spring (Fig. 1).
2. Remove the locknut, bolt, spring and spacer holding the deflector to the pivot brackets (Fig. 1). Save the spring.
3. Remove the grass deflector.

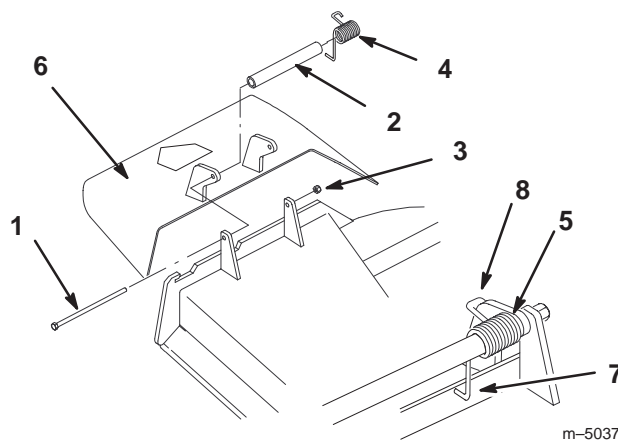

Figure 1

- |                     |                                                                   |
|---------------------|-------------------------------------------------------------------|
| 1. Bolt             | 6. Grass Deflector                                                |
| 2. Spacer           | 7. L end of spring, place behind deck edge before installing bolt |
| 3. Locknut          | 8. J hook end of spring                                           |
| 4. Spring           |                                                                   |
| 5. Spring installed |                                                                   |

# Installing the New Grass Deflector



## Warning



An uncovered discharge opening could allow the lawn mower to throw objects in the operator's or bystander's direction and result in serious injury. Also, contact with the blade could occur.

Never operate the lawn mower unless you install a cover plate, a mulch plate, or a grass chute and catcher.

1. Install the new bolt through the grass deflector and through the small spacer (3/4 inch) (Fig. 2).
2. Install the bolt through the front pivot post on the mower deck and install the large spacer (4-7/8 inch) (Fig. 2).
3. Install the spring onto the large spacer (Fig. 2).
4. Place the **L** end of spring behind deck edge (Fig. 1).

**Note:** Make sure the **L** end of spring is installed behind deck edge before installing the bolt as shown in Figure 1.

5. Install the bolt through the deflector and the medium spacer (1-3/8 inch) (Fig. 2).
6. Install the bolt through the rear pivot post on the mower deck and secure it with a locknut (5/16 inch) (Fig. 2).
7. Place the **J** hook end of spring around grass deflector (Fig. 1).

**Important** The grass deflector must be able to rotate. Lift the deflector up to the full open position and ensure that it rotates into the full down position.

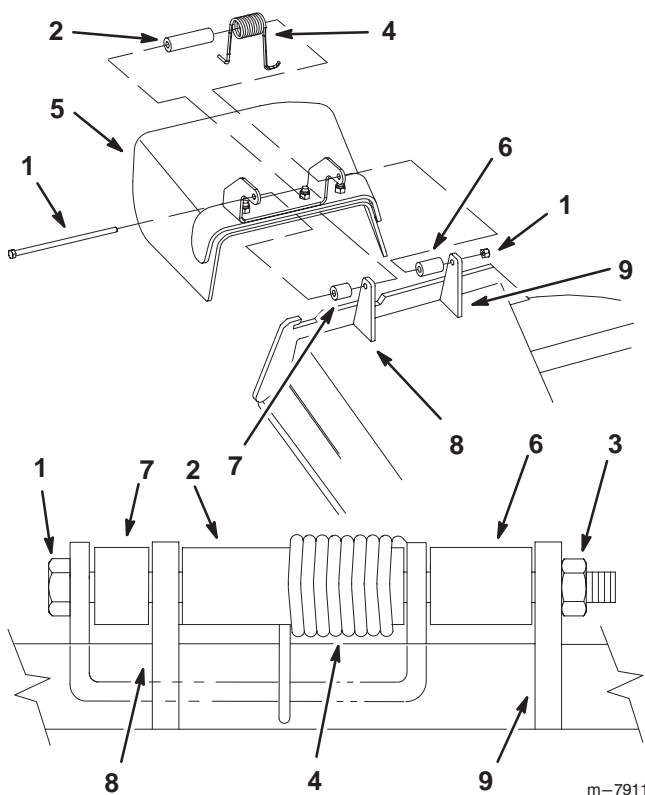

**Figure 2**

- |                             |                              |
|-----------------------------|------------------------------|
| 1. Bolt                     | 6. Medium Spacer, 1-3/8 inch |
| 2. Large Spacer, 4-7/8 inch | 7. Small Spacer, 3/4 inch    |
| 3. Locknut, 5/16 inch       | 8. Front pivot post          |
| 4. Spring                   | 9. Rear pivot post           |
| 5. Grass Deflector          |                              |