



Auxiliary Power Unit Kit for Heavy Duty Workman

Model No. 07401

Model No. 07402

Installation Instructions

Installation

Loose Parts

Use the chart below to verify that all parts have been shipped.

Step	Description	Qty.	Use
1	No parts required	—	Disassemble the components.
2	Drive shaft w/pulley Locknut Long spacers Cap screws Flat washers	1 1 2 4 4	Assemble the components.

Step

1

Disassembling the Components

No Parts Required

Procedure

1. Remove the 1/3 bed, if the machine is so equipped. Raise the full bed and secure it with the safety support.
2. Remove the 2 cap screws, washers, and spacers securing the front drive shaft coupling to the engine pulley.
3. Remove the 2 cap screws, washers, and spacers securing the rear drive shaft coupling to the jack shaft assembly.

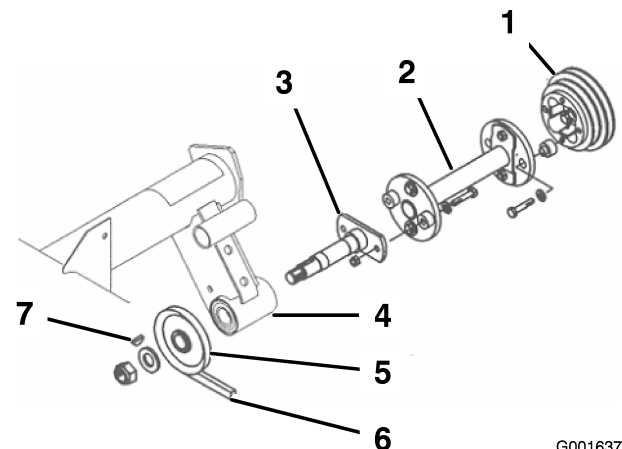

G001637

Figure 1

1. Engine pulley
 2. Drive shaft
 3. Jack shaft assembly
 4. Jack shaft support
 5. Jack shaft drive pulley
 6. Hydraulic pump drive belt
 7. Woodruff key
4. Loosen the idler pulley tensioning the hydraulic pump drive belt and remove the belt from the jackshaft drive pulley.
 5. Remove the locknut and washer securing the jack shaft drive pulley to the jack shaft. Retain the washer for re-installation.

6. Remove the pulley from the jackshaft. Retain the pulley for re-installation with the kit unless a generator kit is to be installed.
7. Remove the Woodruff key from the drive jack shaft. Retain the key for reinstallation.
8. Slide the jackshaft out of the jackshaft support.

Important: Use caution when removing the jack shaft so the bearings in the jack shaft support are not damaged. If the bearings are damaged they must be replaced.

9. Clean the inside bore of each bearing to remove any rust that may have formed. Apply a light coat of oil to the bearing bores to ease reassembly.

Step 2

Assembling the Components

Parts needed for this step:

1	Drive shaft w/pulley
1	Locknut
2	Long spacers
4	Cap screws
4	Flat washers

Procedure

1. Apply a light coat of oil or Never Seeze to the shaft of the new drive shaft w/pulley.
2. Insert the new drive shaft w/pulley into the jackshaft support bearings.

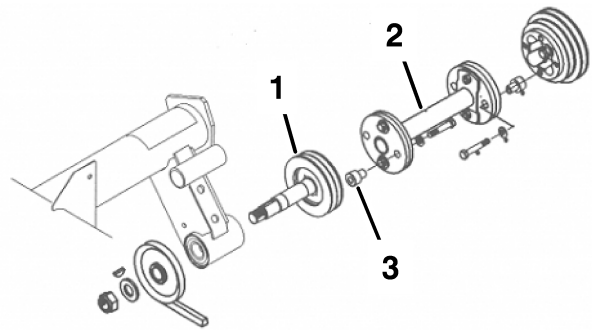

G001638

Figure 2

1. Drive shaft w/pulley
2. Drive shaft
3. Spacer

Note: The bearing spacer between the jack shaft bearings in the jack shaft support may have to be held in place when inserting the drive shaft.

Note: Do not pound the drive shaft into the bearings. The drive shaft should slide into place with manual force or wiggling.

3. Reinstall the old key to the new drive shaft.
4. Reinstall the old pulley to the drive shaft or install the new generator drive pulley, if required.
5. Secure the pulley to the drive shaft with the previously removed flat washer and the new locknut.
6. Install the 2 long spacers into the drive shaft couplers on each end of the new drive shaft.
7. Place the drive belts onto the drive shaft pulley for the installation of the kit for which the Auxiliary Power Unit (APU) is being installed.

Note: Do not operate the vehicle with the belts installed on the APU drive without them being installed on the driven pulley of another attachment or severe damage to the vehicle is possible and could cause serious injury.

8. Secure the drive shaft couplings to the engine pulley and drive shaft pulley with 4 cap screws (5/16 x 1-3/4 inches) and flatwashers.

Note: On machines with serial numbers greater than 210000001, use 2 cap screws (M8 x 1.25 x 45) to secure the drive shaft coupling to the engine pulley.

9. Reinstall the hydraulic pump drive belt to the jackshaft pulley and adjust the idler pulley to achieve the correct belt tension.