



Footswitch Upgrade Kit

For Multi-Pro 5600 Turf Sprayer

Model No. 110-5076

Installation Instructions

Installation

Loose Parts

Use the chart below to verify that all parts have been shipped.

Step	Description	Qty.	Use
1	No parts required	–	Prepare the machine.
2	No parts required	–	Remove the foot switch.
3	Floor switch Wiring harness Hex-head screw (1/4 inch) Lock washer (1/4 inch) Nut (1/4 inch) Wire tie	1 1 2 2 2 4	Install the floor switch.

Step

1

Preparing the Machine

No Parts Required

Procedure

1. Park the sprayer on a flat surface, lower the booms, set the parking brake, stop the engine, and remove the key.
2. Disconnect battery negative cable.

Step

2

Removing the Foot Switch

No Parts Required

Procedure

1. Disconnect Sprayer Foot Switch connector under floor pan.
2. Remove the retaining nut and remove the sprayer foot switch from the floor pan. Discard the foot switch.
3. Remove the bolt securing the left side of the front hood to the floor pan to allow the existing floor switch wiring to be brought above the floor pan (Figure 1).

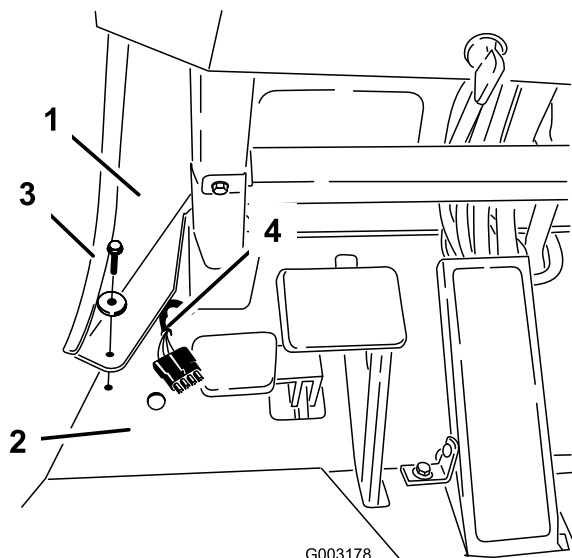

Figure 1

1. Front hood, left side
2. Floor pan
3. Bolt
4. Existing floor switch wiring

4. After the wiring is above the floor pan reinstall the front hood and secure it with the cover bolt.

Step 3

Installing the Floor Switch

Parts needed for this step:

1	Floor switch
1	Wiring harness
2	Hex-head screw (1/4 inch)
2	Lock washer (1/4 inch)
2	Nut (1/4 inch)
4	Wire tie

Procedure

1. Place the new floor switch in the area as shown in Figure 2, near the old switch location, and use the switch to mark locations for drilling holes.
2. Remove the new switch and drill two 1/4 inch holes in the floor pan at drill points marked in the previous step.
3. Mount the new floor switch using the two hex-head screws (1/4 inch), two lock washers

(1/4 inch) and two nuts (1/4 inch) provided in loose parts (Figure 2).

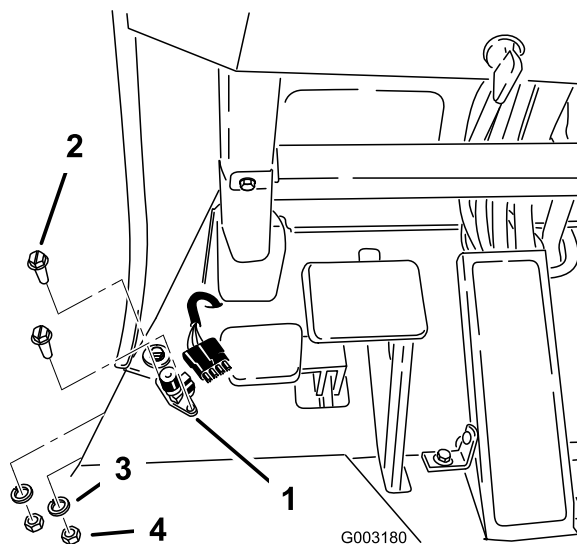

Figure 2

1. New floor switch
2. Hex head screw (1/4 inch)
3. Lock washer (1/4 inch)
4. Nut (1/4 inch)

4. Connect the three prong connector on the new wiring harness to the three prongs on the floor switch.
5. Connect the old floor switch connector to the matching connector on the new wiring harness (Figure 3).

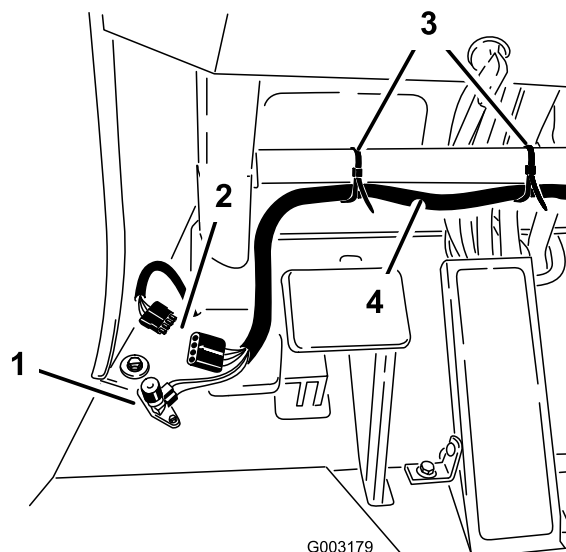

Figure 3

1. New floor switch, connected to wiring harness
2. Old wiring harness, connecting to new wiring harness
3. Wire ties
4. New wiring harness and relays, secured to frame

6. Use wire ties to secure the relays and harness to the frame under the dash as shown in (Figure 3).
7. Reconnect the battery.
8. Test for proper floor switch function.



Count on it.