



Replacement Pulley Kit

For Z593-D Z Master® Models 74264, 74264TE, 74265 and 74265TE

Model No. 110-3944

Model No. 110-3945

Installation Instructions

This kit is for installing a DFS bagger onto a Z593-D Z Master.

Note: Before removing the pulley, make sure the gearbox drive pulley does not have 4 holes around the center hole.

Step

1

Replacing the Gearbox Drive Pulley

Parts needed for this step:

1	Pulley
1	Square key
2	Set screw

Procedure

1. Remove the mower belt from the gearbox pulley assembly (Figure 1).
2. Remove the 2 set screws, square key, and gearbox pulley from the gearbox.
3. Install the bagger drive pulley to the new gearbox pulley with 3 bolts ($3/8 \times 1-3/4$ inches), 3 spacers, and 3 flange nuts ($3/8$ inch) (Figure 1). This hardware is supplied with the bagger.
4. Install the gearbox pulley and bagger drive pulley to the gearbox with 2 set screws and a square key (Figure 1). The pulley center hub needs to be flush with the end of the gearbox shaft.
5. Install the mower belt back onto the gearbox pulley (Figure 1).

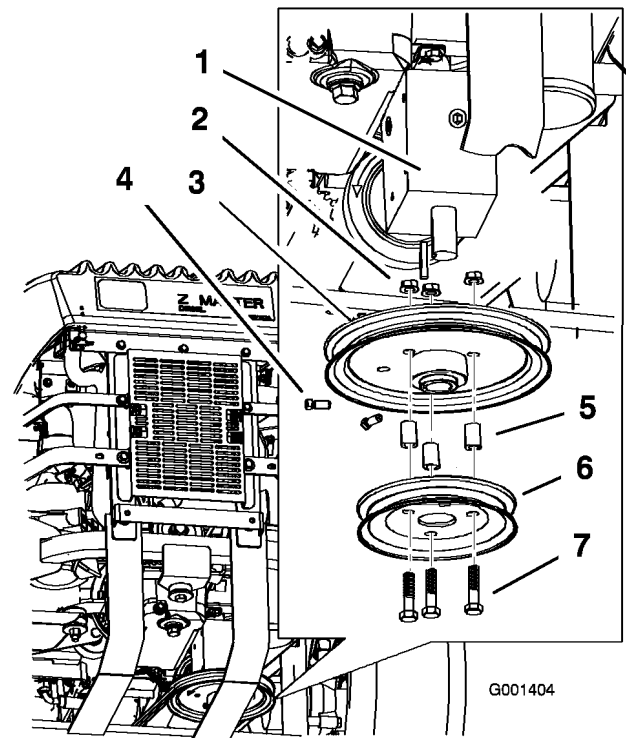

Figure 1

- | | |
|---------------------------|----------------------------------|
| 1. Gearbox | 5. Spacer |
| 2. Flange nut, $3/8$ inch | 6. Bagger drive pulley |
| 3. Gearbox drive pulley | 7. Bolt, $1/2 \times 1-3/4$ inch |
| 4. Set screw | |



Count on it.