



Rear Weight Kit

Groundsmaster® Traction Units

Part No. 24-5780

Form No. 3355-352 Rev. A

Installation Instructions

Groundsmaster 200 Series

1. Mount a weight to the rear of the traction unit with (2) 1/2-13 x 2-1/4" lg. capscrews, lockwashers and nuts (Fig. 1).
2. Mount the remaining weight to the mounted weight with (2) 1/2-13 x 3-1/2" lg. capscrews, lockwashers, nuts and (4) flatwashers.

Note: Retain any remaining fasteners for future mounting applications.

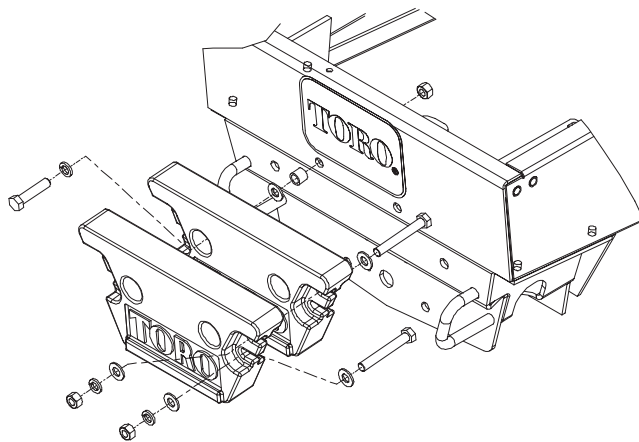

Figure 1

Groundsmaster 300 Series

1. Mount a weight to the rear of the traction unit with (2) 1/2-13 x 2-3/4" lg. capscrews, lockwashers, flatwashers and spacers (Fig. 1). The flatwasher and spacer are to be positioned between the weight and the chassis with the flatwasher against the weight.

Note: The (2) nuts are not required on the Groundsmaster 300 series traction units if tapped holes are provided in the axle support casting.

2. Mount the remaining weight to the mounted weight with (2) 1/2-13 x 3-1/2" lg. capscrews, lockwashers, nuts and (4) flatwashers.

Note: Retain any remaining fasteners for future mounting applications.

Groundsmaster 3280D/3320

2 Wheel Drive

1. Remove the (2) center capscrews, washers and lockwashers securing the standard rear weight to the rear frame (Fig. 2).

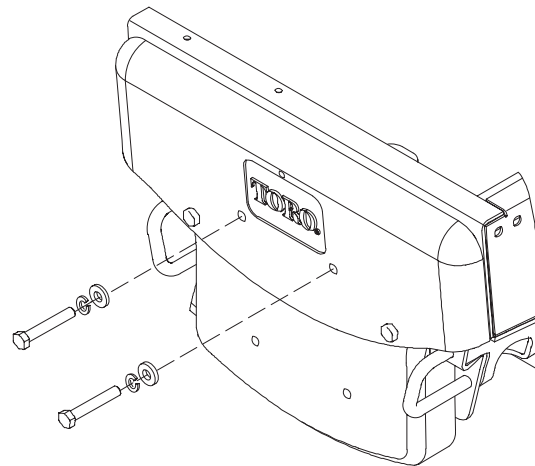

Figure 2

2. Using the vacated mounting holes in the weight, mount the weight to the standard rear weight with (2) 1/2-13 x 4-1/2" capscrews and lockwashers (Fig. 3).

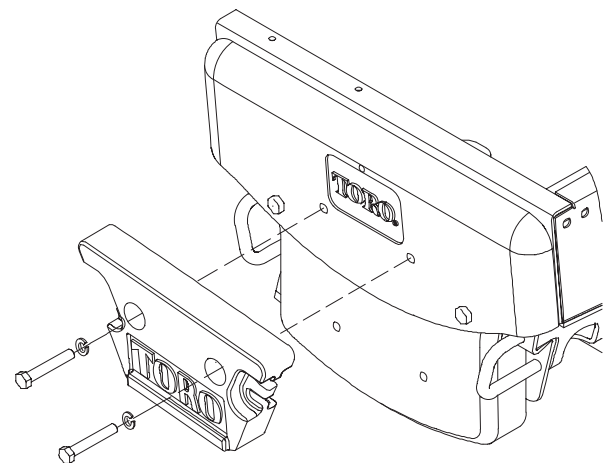

Figure 3

3. Use the lower set of tapped mounting holes in the standard weight to mount the remaining weight (Fig. 4). Use (2) 1/2-13 x 1-1/2" lg. capscrews (not provided) and lockwashers to mount the weight.

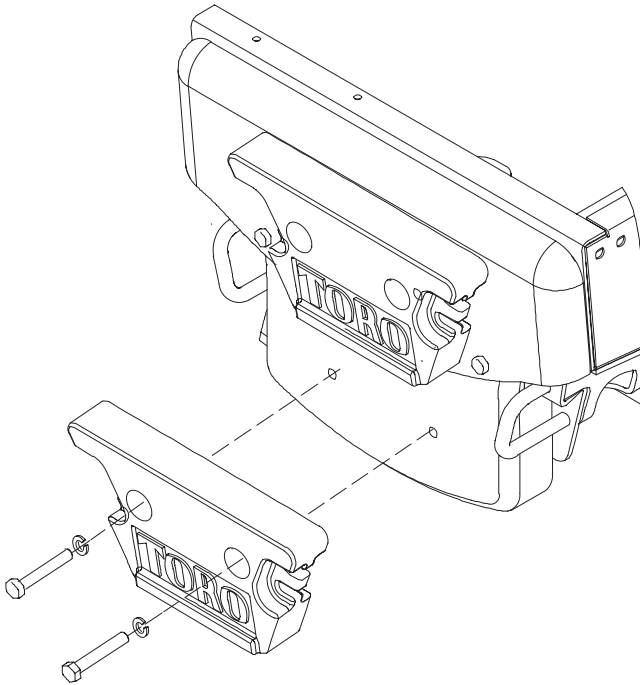

Figure 4

Important Mount only one weight in the lower set of holes on the standard weight. If additional weights are required, mount them to the upper weight.

Note: Retain any remaining fasteners for future mounting applications.

4 Wheel Drive

1. Mount the weight to the rear bumper with (2) 1/2-13 x 2-1/4" capscrews, lockwashers and nuts (Fig. 5).

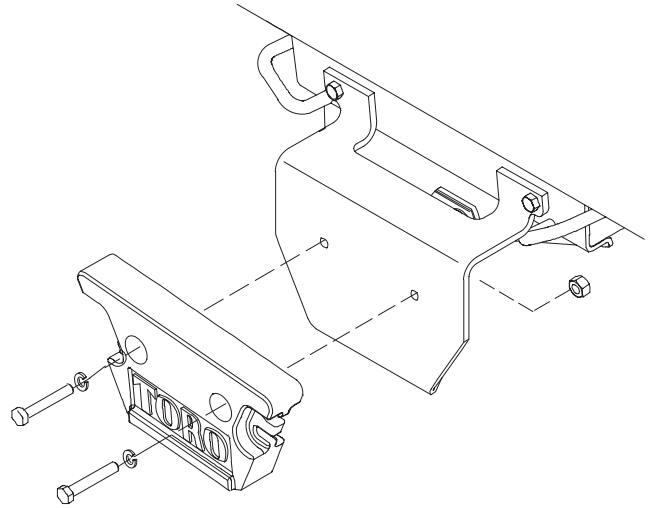

Figure 5

-
2. Mount the remaining weight to the mounted weight with (2) 1/2-13 x 3-1/2" lg. capscrews, lockwashers, nuts and (4) flatwashers.

Note: Retain any remaining fasteners for future mounting applications.