



# 53cm Recycler<sup>®</sup> Lawn Mower

Model No. 20793—Serial No. 260000001 and Up

Model No. 20795—Serial No. 260000001 and Up

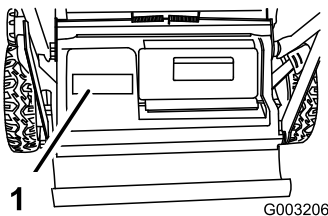
## Operator's Manual

## Introduction

Read this information carefully to learn how to operate and maintain your product properly and to avoid injury and product damage. You are responsible for operating the product properly and safely.

You may contact Toro directly at [www.Toro.com](http://www.Toro.com) for product and accessory information, help finding a dealer, or to register your product.

Whenever you need service, genuine Toro parts, or additional information, contact an Authorized Service Dealer or Toro Customer Service and have the model and serial numbers of your product ready. Figure 1 identifies the location of the model and serial numbers on the product.



**Figure 1**

1. Model and serial number plate

Write the product model and serial numbers in the space below:

|                         |
|-------------------------|
| <b>Model No.</b> _____  |
| <b>Serial No.</b> _____ |

This manual identifies potential hazards and has safety messages identified by the safety alert symbol (Figure 2), which signals a hazard that may cause serious injury or death if you do not follow the recommended precautions.



**Figure 2**

1. Safety alert symbol

This manual uses two words to highlight information.

**Important** calls attention to special mechanical information and **Note** emphasizes general information worthy of special attention.

For models with stated engine horsepower, the gross horsepower of the engine was laboratory rated by the engine manufacturer in accordance with SAE J1940. As configured to meet safety, emission, and operating requirements, the actual engine horsepower on this class of lawn mower will be significantly lower.

## Safety

**Improperly using or maintaining this mower can result in injury. To reduce the potential for injury, comply with these safety instructions.**

Toro designed and tested this mower for reasonably safe service; however, failure to comply with the following instructions may result in personal injury.

**To ensure maximum safety, best performance, and to gain knowledge of the product, it is essential that you and any other operator of the mower read and understand the contents of this manual before the engine is ever started. Pay particular attention to the safety alert symbol (Figure 2) which means Caution, Warning, or Danger—"personal safety instruction." Read and understand the instruction because it has to do with safety. Failure to comply with the instruction may result in personal injury.**

## General Lawn Mower Safety

The following instructions have been adapted from the ISO standard 5395.

This cutting machine is capable of amputating hands and feet and throwing objects. Failure to observe the following safety instructions could result in serious injury or death.

## Training

- Read the instructions carefully. Be familiar with the controls and the proper use of the equipment.
- Never allow children or people unfamiliar with these instructions to use the mower. Local regulations can restrict the age of the operator.

- Keep in mind that the operator or user is responsible for accidents or hazards occurring to other people or their property.
- Understand explanations for all pictograms used on the mower or in the instructions.

## Gasoline

**WARNING**-Gasoline is highly flammable. Take the following precautions.

- Store fuel in containers specifically designed for this purpose.
- Refuel outdoors only and do not smoke while refueling.
- Add fuel before starting the engine. Never remove the cap of the fuel tank or add gasoline while the engine is running or when the engine is hot.
- If gasoline is spilled, do not attempt to start the engine but move the mower away from the area of spillage and avoid creating any source of ignition until gasoline vapors have dissipated.
- Replace all fuel tank and container caps securely.

## Preparation

- While mowing, always wear substantial footwear and long trousers. Do not operate the equipment when barefoot or wearing open sandals.
- Thoroughly inspect the area where the equipment is to be used and remove all stones, sticks, wires, bones and other foreign objects.
- Before using, always visually inspect to see that guards, and safety devices, such as deflectors and/or grass catchers, are in place and working correctly.
- Before using, always visually inspect to see that the blades, blade bolts and cutter assembly are not worn or damaged. Replace worn or damaged blades and bolts in sets to preserve balance.

## Starting

- Disengage all blade and drive clutches and shift into neutral before starting the engine.
- Do not tilt mower when starting the engine or switching on the motor, unless the mower has to be tilted for starting. In this case, do not tilt it more than absolutely necessary and lift only the part, which is away from the operator.
- Start the engine or switch on the motor carefully according to instructions and with feet well away from the blade(s) and not in front of the discharge chute.

## Operation

- Never mow while people, especially children, or pets are nearby.
- Mow only in daylight or in good artificial light.

- Stay alert for holes in the terrain and other hidden hazards.
- Do not put hands or feet near or under rotating parts. Keep clear of the discharge opening at all times.
- Never pick up or carry a lawn mower while the engine is running.
- Use extreme caution when reversing or pulling a pedestrian controlled lawn mower towards you.
- Walk, never run.
- Slopes:
  - Do not mow excessively steep slopes.
  - Exercise extreme caution when on slopes.
  - Mow across the face of slopes, never up and down and exercise extreme caution when changing direction on slopes.
  - Always be sure of your footing on slopes.
- Use low throttle settings when engaging the traction-clutch, especially in high gears. Reduce speed on slopes and in sharp turns to prevent overturning or loss of control.
- Stop the blade if the lawn mower has to be tilted for transportation when crossing surfaces other than grass and when transporting the lawn mower to and from the area to be mowed.
- Do not operate the engine in a confined space where dangerous carbon monoxide fumes can collect.
- Stop the engine
  - whenever you leave the lawn mower.
  - before refueling.
  - before removing the grass catcher.
  - before making height adjustment unless adjustment can be made from the operator's position.
- Stop the engine and disconnect the spark-plug wire.
  - before clearing blockages or unclogging chute.
  - before checking, cleaning or working on the lawn mower.
  - after striking a foreign object, inspect the lawn mower for damage and make repairs before restarting and operating the lawn mower.
  - if lawn mower starts to vibrate abnormally (check immediately).
- Watch out for traffic when crossing or near roadways.

## Maintenance and Storage

- Keep all nuts, bolts and screws tight to be sure the equipment is in safe working condition.
- Do not use pressure cleaning equipment on machine.

- Never store the equipment with gasoline in the tank and inside a building where fumes can reach an open flame or spark.
- Allow the engine to cool before storing in any enclosure.
- To reduce the fire hazard, keep the engine, silencer, battery compartment and gasoline storage are free of grass, leaves, or excessive grease.
- Check grass catcher components and the discharge guard frequently and replace with manufacturer's recommended parts, when necessary.
- Replace worn or damaged parts for safety.
- Replace faulty silencers.
- If the fuel tank has to be drained, do this out-doors.
- Do not change the engine governor settings or overspeed the engine. Operating an engine at excessive speed can increase the hazard of personal injury.
- On multibladed lawn mowers, take care as rotating one blade may cause others to rotate.
- Be careful during adjustment of the lawn mower to prevent entrapment of the fingers between moving blades and fixed parts of the lawn mower.
- **To ensure the best performance and safety, purchase only genuine Toro replacement parts and accessories. Do not use will fit parts and accessories; they may cause a safety hazard.**

## Sound Pressure

This unit has an equivalent continuous A-weighted sound pressure level at the operator ear of 89 dBA, based on measurements of identical machines per EN 11094 and EN 836.

## Sound Power

This unit has an equivalent continuous A-weighted sound power level of 98 dBA, based on measurements of identical machines per EN 11094.

## Vibration, Hand/arm

This unit does not exceed a hand/arm vibration level of 7.0 m/s<sup>2</sup>, based on measurements of identical machines per EN 1033.

## Safety and Instructional Decals

**Important:** Safety and instruction decals are located near areas of potential danger. Replace damaged decals.

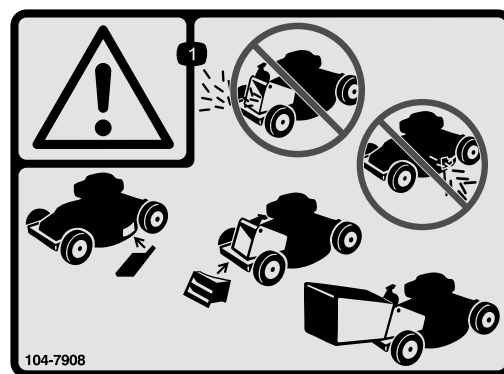


**Manufacturer's Mark**

1. Indicates the blade is identified as a part from the original machine manufacturer.



**94-8072**



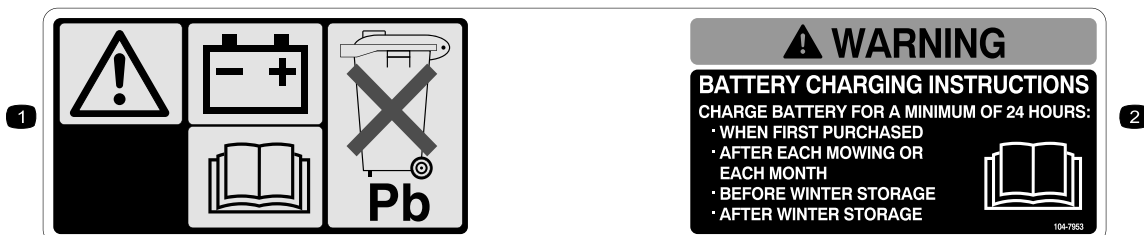
**104-7908**

1. Warning—do not operate the mower without the rear discharge plug or bag in place; do not operate the mower without the side discharge cover or deflector in place.



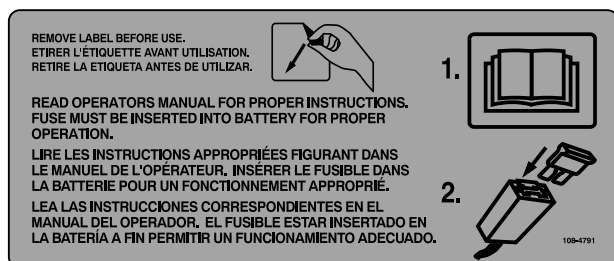
**104-7909**

1. Warning—read the *Operator's Manual*.
2. Thrown object hazard—keep bystanders a safe distance from the machine.
3. Thrown object hazard, mower—keep the deflector in place.
4. Cutting/dismemberment hazard of hand or foot, mower blade—stay away from moving parts.
5. Cutting/dismemberment hazard of hand or foot, mower blade—do not operate up and down slopes; operate side to side on slopes; stop the engine before leaving the operating position; and look behind you when backing.

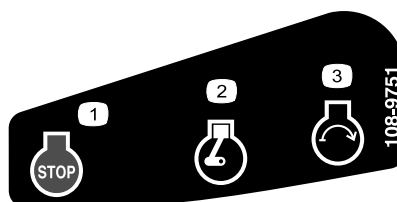


**104-7953 (model 20795 only)**

1. Warning—read the *Operator's Manual* for information on charging the battery; contains lead; do not discard.
2. Read the *Operator's Manual*.



**108-4791 (model 20795 only)**



**108-9751**

1. Engine—stop
2. Engine—run
3. Engine—start

# Setup

**Important:** Remove and discard the protective plastic sheet that covers the engine.

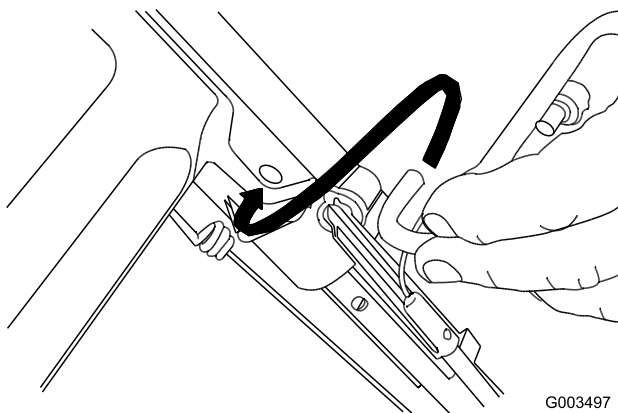
## 1. Unfolding the Handle



**Folding or unfolding the handle improperly can damage the cables, causing an unsafe operating condition.**

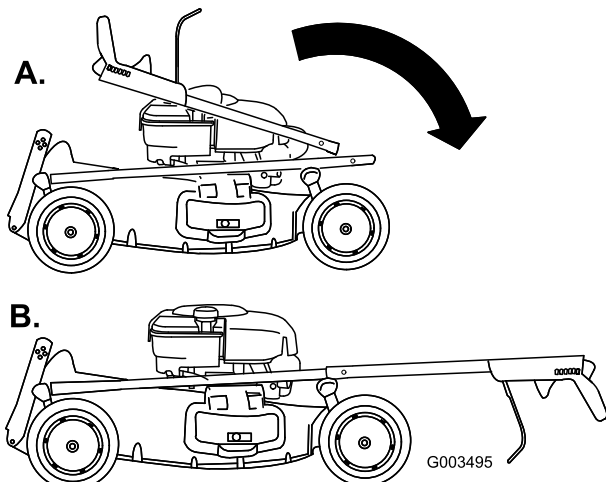
- Do not damage the cables when folding or unfolding the handle.
- If a cable is damaged, contact an Authorized Service Dealer.

1. Install the blade control bar into the upper handle (Figure 3).



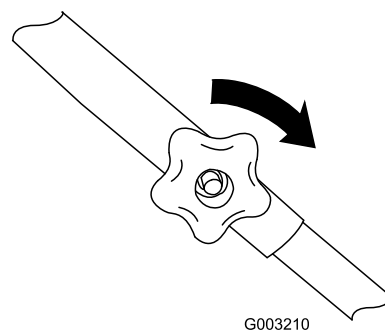
**Figure 3**

2. Remove the upper handle knobs and bolts from the loose parts bag.
3. Carefully move the upper handle forward and place the ends over the lower handle so they are in line and nest together (Figure 4).



**Figure 4**

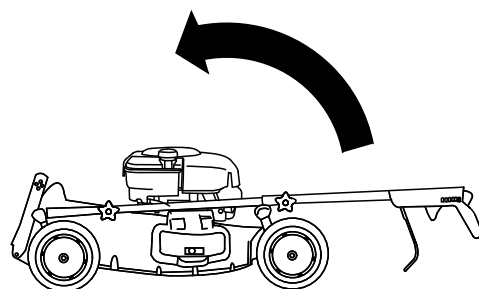
4. Install the bolts and upper handle knobs with the knobs on the outside of the handle, tightening the knobs as tight as you can (Figure 5).



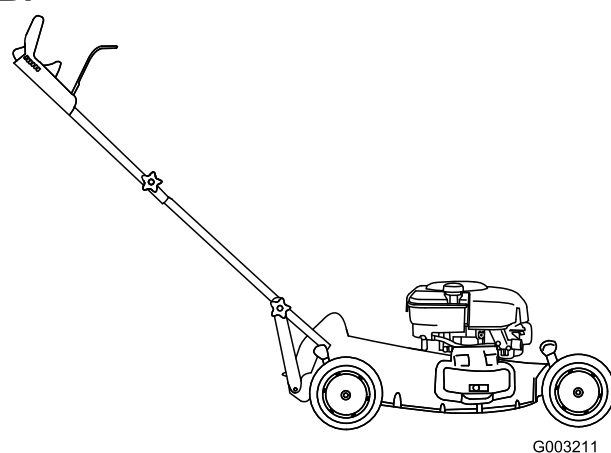
**Figure 5**

5. Rotate the handle rearward (Figure 6).

**A.**

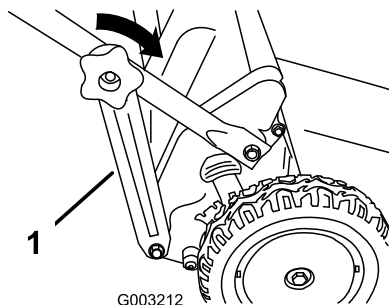


**B.**



**Figure 6**

6. Attach the handle brackets (Figure 7) to the lower handle sides.

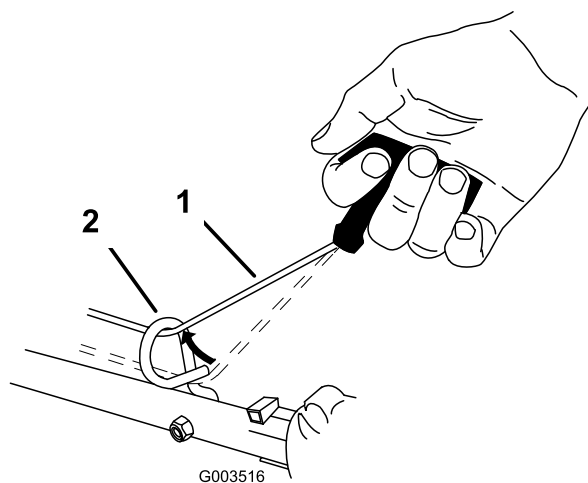


**Figure 7**

1. Handle bracket (2)

## 2. Installing the Starter Rope

Pull the starter rope through the rope guide on the handle (Figure 8).



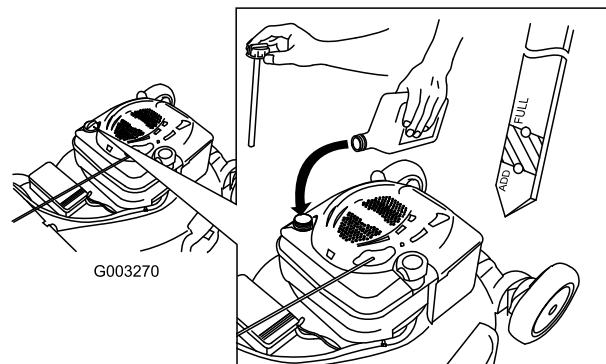
**Figure 8**

1. Starter rope                      2. Rope guide

## 3. Filling the Engine with Oil

Your mower does not come with oil in the engine.

1. Remove the dipstick (Figure 9).



**Figure 9**

2. **Slowly** pour oil into the oil fill tube until the oil level reaches the Full line on the dipstick (Figure 9). **Do not overfill.** (Max. fill: 20 oz. (0.59 l), type: SAE 30W

detergent oil with an API service classification of SF, SG, SH, SJ, SL, or higher.)

3. Install the dipstick securely.

**Important:** Change the engine oil after the first 5 operating hours; change it yearly thereafter. Refer to Changing the Engine Oil.

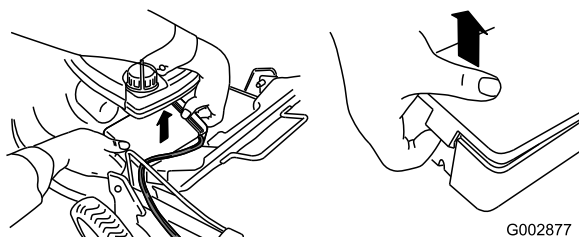
## 4. Installing the Fuse

Model 20795 only

Your mower comes with a 40-amp fuse that protects the electric starter.

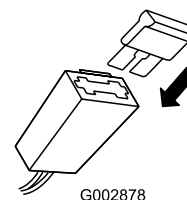
**Important:** You cannot start the mower with the electric starter or charge the battery unless you install the fuse.

1. Unclip both ends of the battery cover and remove it (Figure 10).



**Figure 10**

2. Install the fuse in the fuse holder (Figure 11).



**Figure 11**

**Note:** Your mower comes with a fuse in the your owner's packet and another fuse in the battery box.

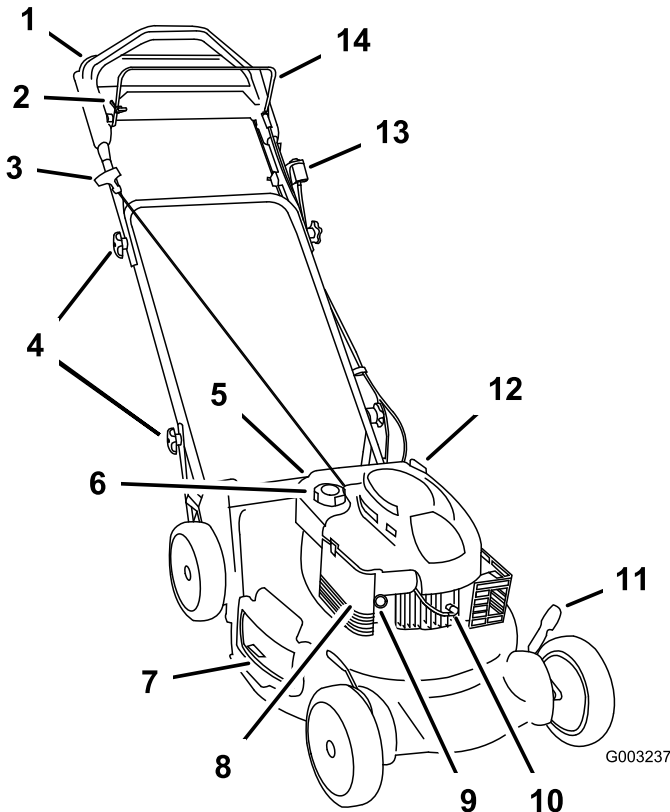
3. Install the battery cover.

## 5. Charging the Battery

Model 20795 only

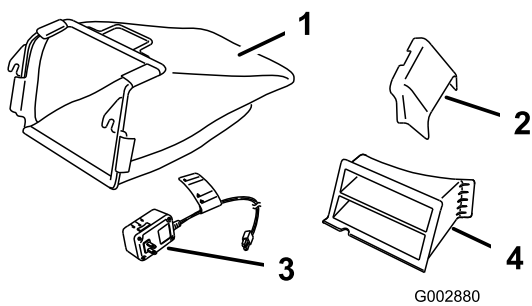
Refer to Charging the Battery in the Maintenance section.

# Product Overview



**Figure 12**

- |                               |  |
|-------------------------------|--|
| 1. Upper handle               | 8. Air filter  |
| 2. Control bar lock           | 9. Primer  |
| 3. Recoil start handle        | 10. Spark plug   |
| 4. Handle knobs (4)           | 11. Cutting height lever (4)   |
| 5. Battery (model 20795 only) | 12. Oil fill/Dipstick  |
| 6. Fuel tank cap              | 13. Ignition toggle switch (model 20793 only) or electric starter (model 20795 only) |
| 7. Side discharge             | 14. Blade control bar  |



**Figure 13**

- |                         |                                       |
|-------------------------|---------------------------------------|
| 1. Grass bag            | 3. Battery charger (model 20795 only) |
| 2. Side discharge chute | 4. Rear discharge plug (installed)    |

# Operation

## Filling the Fuel Tank

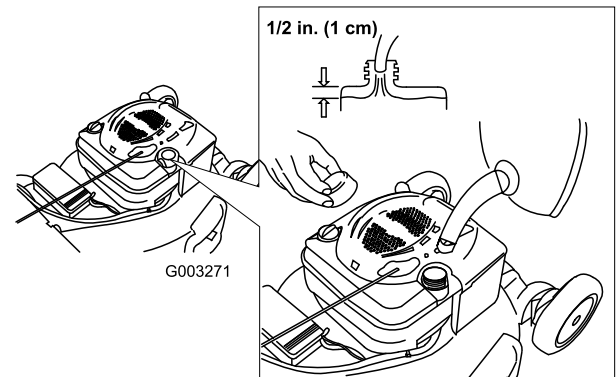


Gasoline is extremely flammable and explosive. A fire or explosion from gasoline can burn you and others.

- To prevent a static charge from igniting the gasoline, place the container and/or mower directly on the ground before filling, not in a vehicle or on an object.
- Fill the tank outdoors when the engine is cold. Wipe up spills.
- Do not handle gasoline when smoking or around an open flame or sparks.
- Store gasoline in an approved fuel container, out of the reach of children.

Fill the fuel tank with fresh unleaded regular gasoline from a major name-brand service station (Figure 14).

**Important:** To reduce starting problems, add fuel stabilizer to the fuel all season, mixing it with gasoline less than 30 days old.

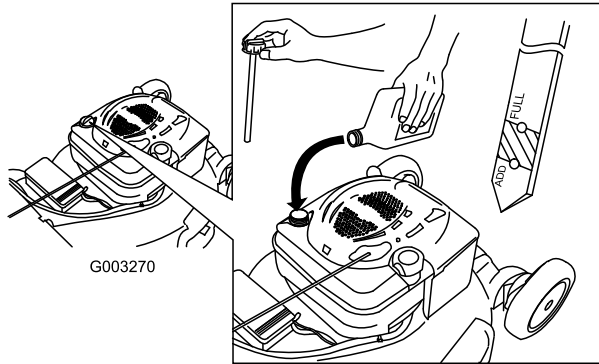


**Figure 14**



## Checking the Engine Oil Level

1. Remove the dipstick, wipe it clean, and fully install the dipstick (Figure 15).



**Figure 15**

2. Remove the dipstick and check the oil level (Figure 15). If the oil level is below the Add mark on the dipstick, **slowly** pour oil into the oil fill tube to raise the oil level to the Full mark on the dipstick. **Do not overfill.** (Max. fill: 20 oz. (0.59 l), type: SAE 30W detergent oil with an API service classification of SF, SG, SH, SJ, SL, or higher.)
3. Install the dipstick.

## Adjusting the Cutting Height



Adjusting the cutting height may bring you into contact with the moving blade, causing serious injury.

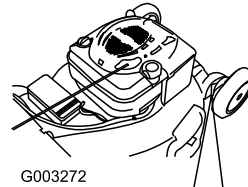
- Stop the engine and wait for all moving parts to stop.
- Do not put your fingers under the housing when adjusting the cutting height.



If the engine has been running, the muffler will be hot and can severely burn you. Keep away from the hot muffler.

Adjust the cutting height as desired. Set all four wheels to the same height.

**Note:** To raise the mower, move all 4 cutting height levers forward; to lower the mower, move them all rearward (Figure 16).

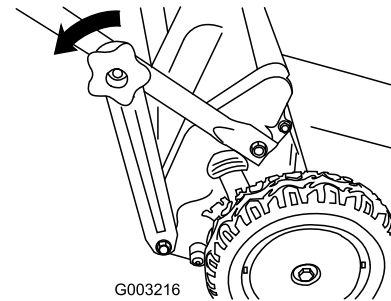


**Figure 16**

## Adjusting the Handle Height

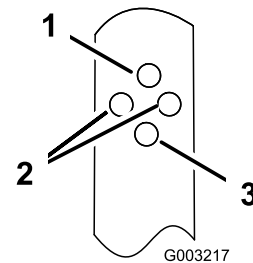
You may raise or lower the handle to a position comfortable for you.

1. Remove the lower handle knobs that attach the handle brackets to the lower handle ends (Figure 17).



**Figure 17**

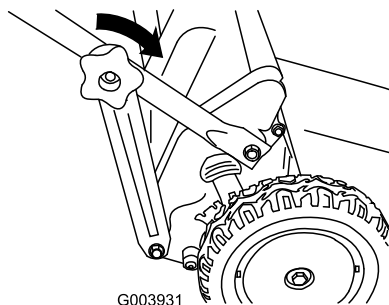
2. Insert the bolt through the hole in each of the handle brackets that sets the handle to the desired position (Figure 18).



**Figure 18**

1. Highest position
  2. Middle position (either hole)
  3. Lowest position
3. Install the lower handle knobs and tighten the knobs as tight as you can by hand (Figure 19).

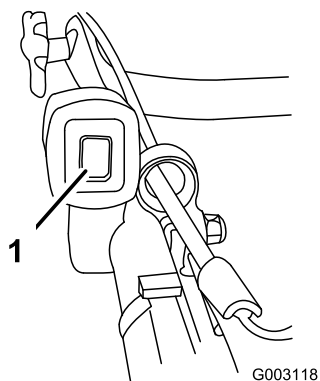




**Figure 19**

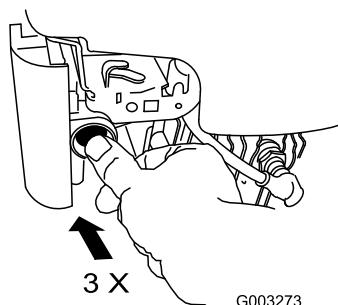
## Starting the Engine (Model 20793)

1. Push the ignition toggle switch to the On (I) position (Figure 20).



**Figure 20**

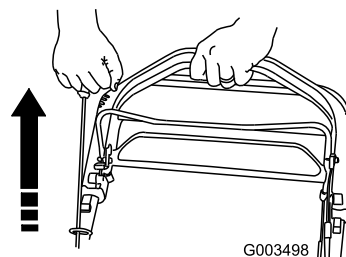
1. Ignition toggle switch
2. Firmly push in the primer 3 times with your thumb, holding the primer in for a second before releasing it each time (Figure 21).



**Figure 21**

**Note:** If the air temperature is below 55°F (13°C), firmly push the primer in 5 times.

3. Pull the recoil starter (Figure 22).



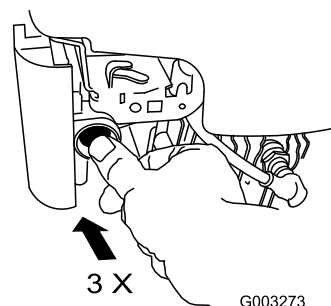
**Figure 22**

4. If the mower does not start in 1 or 2 pulls, press the primer button 1 or 2 times and try starting it again.

**Note:** If the mower still does not start, contact an Authorized Service Dealer.

## Starting the Engine (Model 20795)

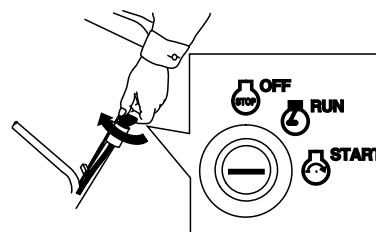
1. Firmly push in the primer 3 times with your thumb, holding the primer in for a second before releasing it each time (Figure 23).



**Figure 23**

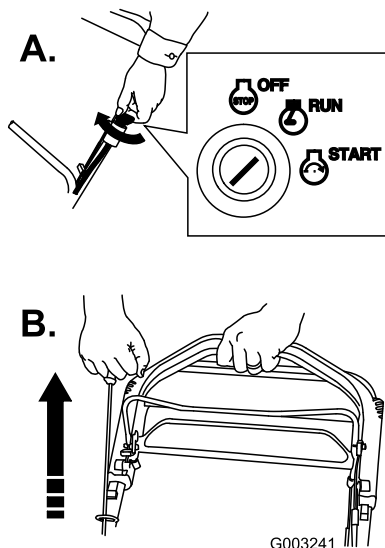
**Note:** If the air temperature is below 55°F (13°C), firmly push the primer in 5 times.

2. Start the engine in one of 2 ways:
  - Turn the ignition key to the Start position; when the engine starts, release the key (Figure 24).



**Figure 24**

- Turn the ignition key to the Run position and pull the recoil starter in the operating position (Figure 25).



**Figure 25**

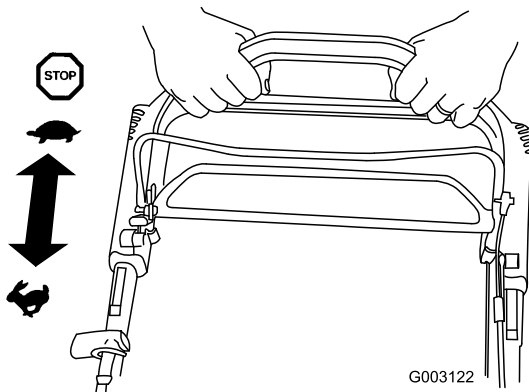
- If the mower does not start in 1 or 2 pulls (or 5 seconds using the electric starter), press the primer button 1 or 2 times and try starting it again.

**Note:** If the mower still does not start, contact an Authorized Service Dealer.

## Using the Self-propel Drive

To operate the self-propel drive, simply walk with your hands on the upper handle and your elbows at your sides, and the mower will automatically keep pace with you (Figure 26).

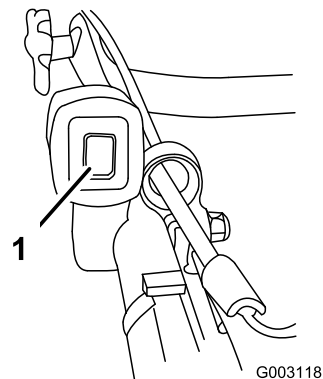
**Note:** You can self-propel the mower with the blade engaged or disengaged.



**Figure 26**

## Stopping the Engine (Model 20793 only)

Push the ignition toggle switch to the Stop position (Figure 27).



**Figure 27**

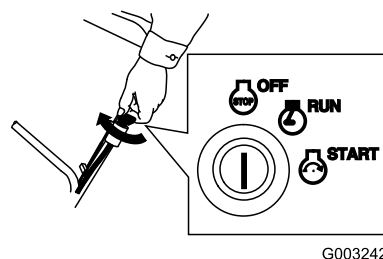
1. Ignition toggle switch

Remove the ignition key when you leave the mower.

**Important:** When you release the blade control bar, both the engine and blade should stop within 3 seconds. If they do not stop properly, stop using your mower immediately and contact an Authorized Service Dealer.

## Stopping the Engine (Model 20795 only)

1. Turn the key to the Off position (Figure 28).



**Figure 28**

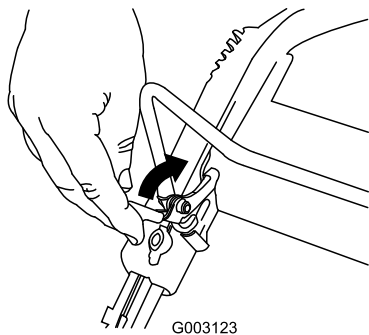
2. Remove the ignition key when you leave the mower.

**Important:** When you release the blade control bar, both the engine and blade should stop within 3 seconds. If they do not stop properly, stop using your mower immediately and contact an Authorized Service Dealer.

## Engaging the Blade

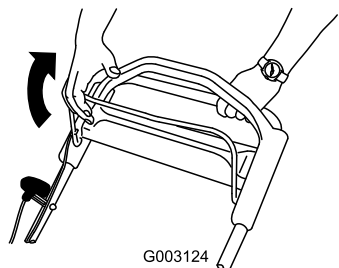
When you start your engine, the blade does not turn. You must engage the blade to mow.

1. Pull the control bar lock back (Figure 29).



**Figure 29**

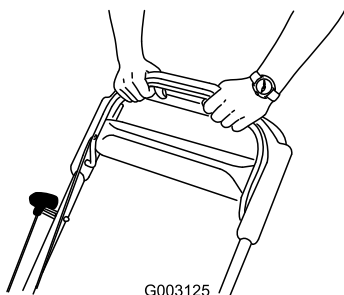
2. Pull the blade control bar to the handle (Figure 30).



**Figure 30**

1. Blade control bar

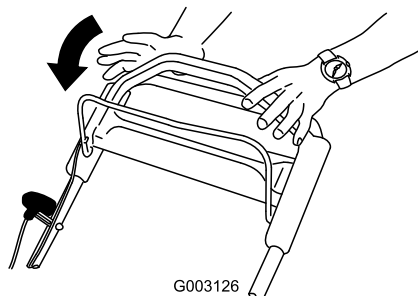
3. Hold the blade control bar against the handle (Figure 31).



**Figure 31**

## Disengaging the Blade

Release the blade control bar (Figure 32).



**Figure 32**

**Important:** When you release the blade control bar, the blade should stop within 3 seconds. If it does not stop properly, stop using your mower immediately and contact an Authorized Service Dealer.

## Checking the Blade Brake Clutch Operation

Check the control bar before each use to ensure that the blade brake clutch system is operating properly.

### Using the Grass Bag

You can use the grass bag to perform an additional test to check the blade brake clutch.

1. Install the empty grass bag on the mower.
2. Start the engine.
3. Engage the blade.

**Note:** The bag should begin to inflate, indicating that the blade is engaged and rotating.

4. Release the blade control bar.

**Note:** If the bag does not immediately deflate, the blade is still rotating. The blade brake clutch may be deteriorating and, if ignored, could result in an unsafe operating condition. Have the mower inspected and serviced by an Authorized Service Dealer.

5. Stop the engine and wait for all moving parts to stop.

### Not Using the Grass Bag

1. Move the mower onto a paved surface in a non-windy area.
2. Set all 4 wheels to the 3-1/4 inch (8 cm) cut setting.
3. Take a half sheet of newspaper and crumple it into a ball small enough to go under the mower housing (about 3 inches or 7.6 cm in diameter).
4. Place the newspaper ball about 5 inches (13 cm) in front of the mower.
5. Start the engine.
6. Engage the blade.
7. Release the blade control bar.
8. Immediately push the mower over the newspaper ball.
9. Stop the engine and wait for all moving parts to stop.
10. Go to the front of the mower and check the newspaper ball.

**Note:** If the newspaper ball did not go under the mower, repeat steps 4 through 10.

11. If the newspaper is unravelled or shredded, the blade did not stop properly, which could result in an unsafe operating condition. Contact an Authorized Service Dealer.

## Recycling the Clippings

Your mower comes from the factory ready to recycle the grass and leaf clippings back into the lawn.

If the side discharge chute is on the mower, remove it and lock the side discharge door (refer to Removing the Side Discharge Chute) before recycling the clippings.

**Important:** Ensure that the rear discharge plug is in place before you recycle the clippings (Figure 33).

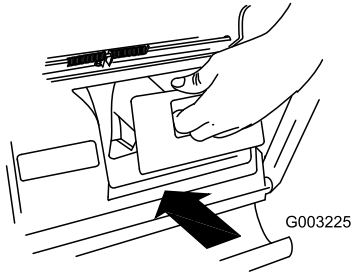


Figure 33

## Bagging the Clippings

Use the grass bag when you want to collect grass and leaf clippings from the lawn.



**A worn grass bag could allow small stones and other similar debris to be thrown in the operator's or bystander's direction and result in serious personal injury or death to the operator or bystanders.**

**Check the grass bag frequently. If it is damaged, install a new Toro replacement bag.**

If the side discharge chute is on the mower, remove it and lock the side discharge door (refer to Removing the Side Discharge Chute) before bagging the clippings.



**The blade is sharp; contacting the blade can result in serious personal injury.**

**Stop the engine and wait for all moving parts to stop before leaving the operating position.**

## Installing the Grass Bag

1. Raise and hold up the rear door (Figure 34).

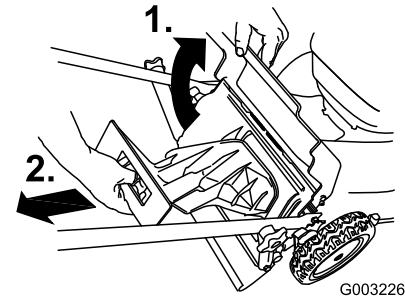


Figure 34

2. Remove the rear discharge plug (Figure 34).
3. Route the starter rope around the lower rope guide (Figure 35).

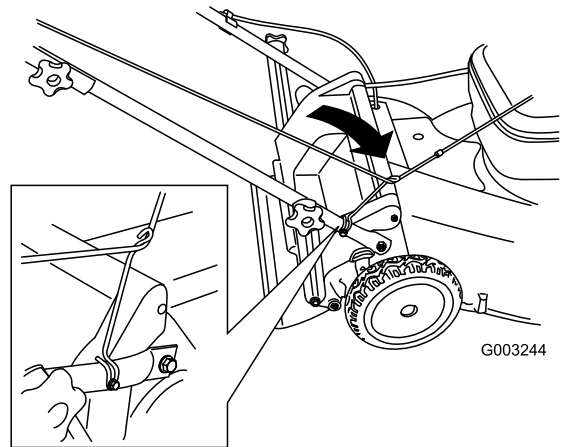
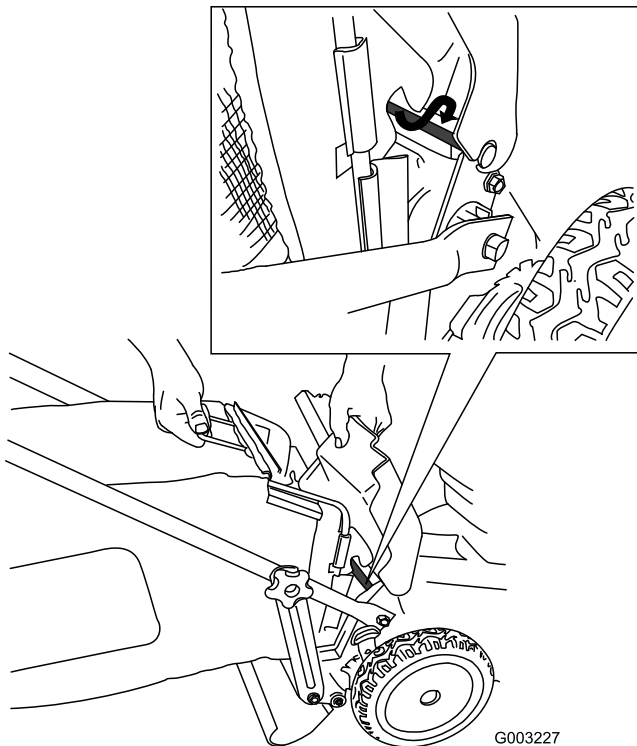


Figure 35

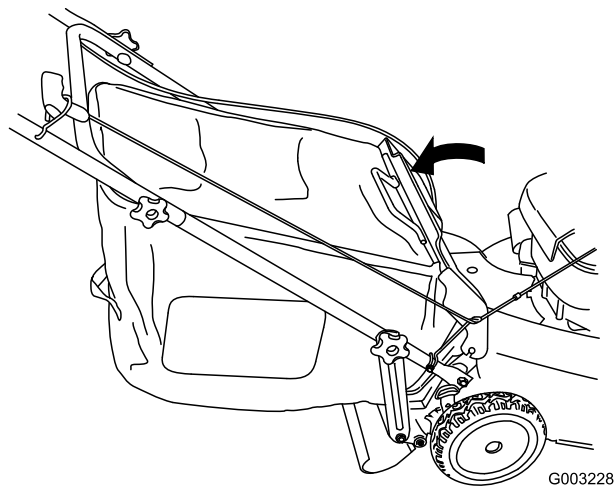
**Note:** The lower rope guide releases the starter rope when you pull the recoil start handle.

4. Install the bag onto the door rod (Figure 36).



**Figure 36**

5. Lower the rear door (Figure 37).



**Figure 37**

## Removing the Grass Bag

To remove the bag, reverse the steps above.

## Side-discharging the Clippings

Use the side discharge for cutting very tall grass.

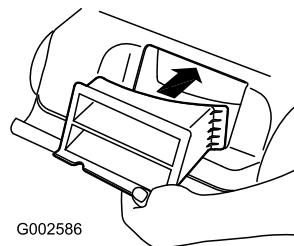
If the bag is on the mower, remove it and insert the rear discharge plug (refer to Removing the Grass Bag) before side-discharging the clippings.

**Important:** Ensure that the rear discharge plug is in place before you side-discharge the clippings (Figure 38).



**The blade is sharp; contacting the blade can result in serious personal injury.**

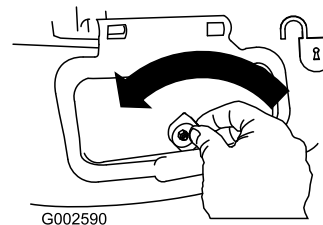
**Stop the engine and wait for all moving parts to stop before leaving the operating position.**



**Figure 38**

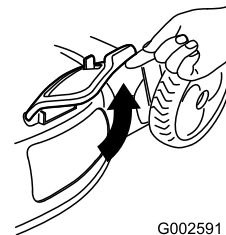
## Installing the Side Discharge Chute

1. Unlock the side discharge door (Figure 39).



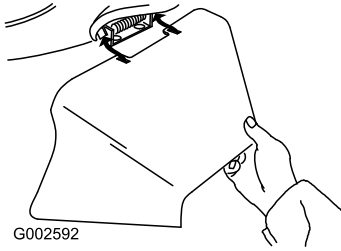
**Figure 39**

2. Lift open the side discharge door (Figure 40).



**Figure 40**

3. Install the side discharge chute and close the door onto the chute (Figure 41).

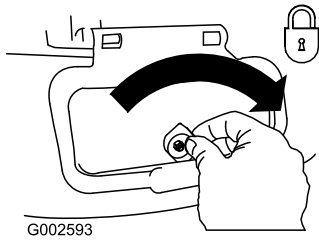


**Figure 41**

## Removing the Side Discharge Chute

To remove the side discharge chute, reverse the steps above.

**Important:** Lock the side discharge door after you close it (Figure 42).



**Figure 42**

## Operating Tips

### General Mowing Tips

- Clear the area of sticks, stones, wire, branches, and other debris that the blade could hit.
- Avoid striking solid objects with the blade. Never deliberately mow over any object.
- If the mower strikes an object or starts to vibrate, immediately stop the engine, disconnect the wire from the spark plug, and examine the mower for damage.
- For best performance, install a new blade before the cutting season begins.
- Replace the blade when necessary with a Toro replacement blade.

### Cutting Grass

- Cut only about a third of the grass blade at a time. Do not cut below the 2-1/4 inch (6 cm) setting unless the grass is sparse or it is late fall when grass growth begins to slow down. Refer to Adjusting the Cutting Height.
- When cutting grass over 6 inches (15 cm) tall, mow at the highest cutting height setting and walk slower; then mow again at a lower setting for the best lawn appearance. If the grass is too long, the mower may plug and cause the engine to stall.
- Mow only dry grass or leaves. Wet grass and leaves tend to clump on the yard and can cause the mower to plug or the engine to stall.



**Wet grass or leaves can cause serious injury if you slip and contact the blade. Mow only in dry conditions.**

- Alternate the mowing direction. This helps disperse the clippings over the lawn for even fertilization.
- If the finished lawn appearance is unsatisfactory, try one or more of the following:
  - Replace the blade or have it sharpened.
  - Walk at a slower pace while mowing.
  - Raise the cutting height on your mower.
  - Cut the grass more frequently.
  - Overlap cutting swaths instead of cutting a full swath with each pass.
  - Set the cutting height on the front wheels one notch lower than the rear wheels. For example, set the front wheels at 2-1/4 inches (6 cm) and the rear wheels at 2-3/4 inches (7 cm).

### Cutting Leaves

- After cutting the lawn, ensure that half of the lawn shows through the cut leaf cover. You may need to make more than one pass over the leaves.
- If there are more than 5 inches (13 cm) of leaves on the lawn, set the front cutting height one or two notches higher than the rear cutting height.
- Slow down your mowing speed if the mower does not cut the leaves finely enough.

# Maintenance

**Note:** Determine the left and right sides of the machine from the normal operating position.

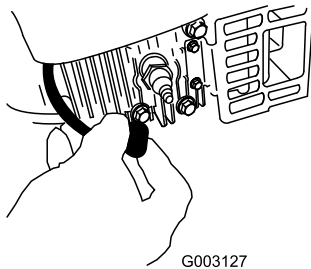
## Recommended Maintenance Schedule(s)

| Maintenance Service Interval      | Maintenance Procedure   |
|-----------------------------------|---|
| After the first 5 operating hours | <ul style="list-style-type: none"><li>• Change the engine oil.</li></ul>  |
| Before each use or daily          | <ul style="list-style-type: none"><li>• Check the engine oil level.</li><li>• Ensure that the engine stops within 3 seconds after releasing the blade control bar.</li><li>• Check the blade brake clutch operation.</li><li>• Clean grass clippings and dirt from under the mower.</li></ul>   |
| Every 25 hours                    | <ul style="list-style-type: none"><li>• Charge the battery (model 20795 only).</li></ul>  |
| Every 50 hours                    | <ul style="list-style-type: none"><li>• Change the engine oil.</li></ul>  |
| Every 100 hours                   | <ul style="list-style-type: none"><li>• Clean the cooling system (refer to your engine owner's manual).</li><li>• Replace the spark plug (refer to your engine owner's manual).</li></ul>   |
| Before storage                    | <ul style="list-style-type: none"><li>• Empty the fuel tank before repairs as directed and before annual storage.</li></ul>   |
| Yearly                            | <ul style="list-style-type: none"><li>• Replace the air filter (more frequently in dusty operating conditions).</li><li>• Check the spark plug (refer to your engine owner's manual).</li><li>• Lubricate the wheel gears.</li><li>• Replace the blade or have it sharpened (more frequently if the edge dulls quickly).</li><li>• Refer to your Engine Operator's Manual for any additional yearly maintenance procedures.</li></ul> |

**Important:** Refer to your Engine Operator's Manual for additional maintenance procedures.

## Preparing for Maintenance

1. Stop the engine and wait for all moving parts to stop.
2. Disconnect the spark plug wire from the spark plug (Figure 43) before performing any maintenance procedure.



**Figure 43**

3. After performing the maintenance procedure(s), connect the spark plug wire to the spark plug.

**Important:** Before tipping the mower to change the oil or replace the blade, allow the fuel tank to run dry through normal usage. If you must tip the mower prior to running out of fuel, use a hand fuel pump to remove the fuel. Always tip the mower onto its side with the air filter up.



**Tipping the mower may cause the fuel to leak. Gasoline is flammable, explosive and can cause personal injury.**

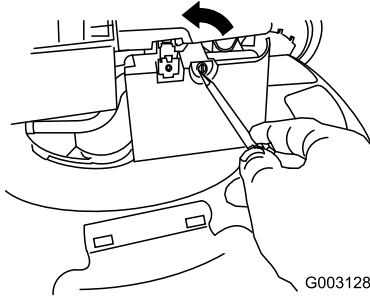
**Run the engine dry or remove the gasoline with a hand pump; never siphon.**



# Replacing the Air Filter

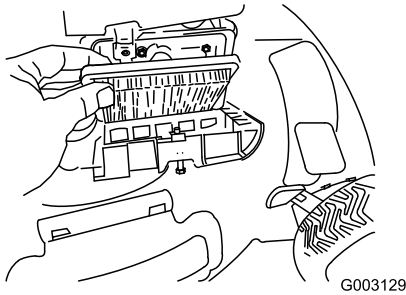
Replace the air filter yearly; replace it more frequently in dusty operating conditions.

1. Perform the pre-maintenance procedures; refer to Preparing for Maintenance.
2. Use a screw driver to open the air filter cover (Figure 44).



**Figure 44**

3. Replace the air filter.
4. Install the cover (Figure 45).



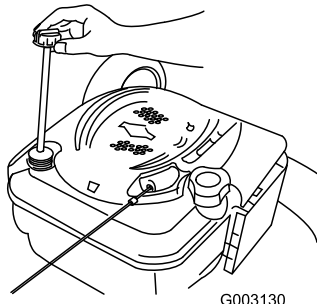
**Figure 45**

# Changing the Engine Oil

Change the engine oil after the first 5 operating hours; change it yearly thereafter.

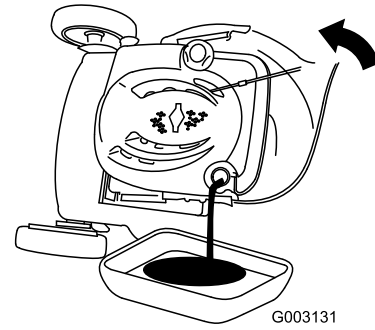
Run the engine a few minutes before changing the oil to warm it. Warm oil flows better and carries more contaminants.

1. Perform the pre-maintenance procedures; refer to Preparing for Maintenance.
2. Remove the dipstick (Figure 46).



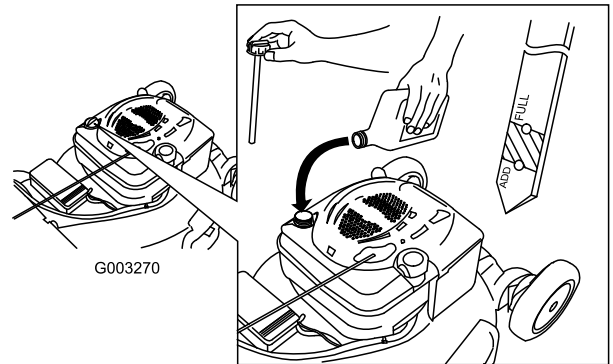
**Figure 46**

3. Tip the mower onto its side, with the air filter up, to drain the used oil out through the oil fill tube (Figure 47).



**Figure 47**

4. **Slowly** pour oil into the oil fill tube until the oil level reaches the Full line on the dipstick (Figure 48). **Do not overfill.** (Max. fill: 20 oz. (0.59 l), type: SAE 30W detergent oil with an API service classification of SF, SG, SH, SJ, SL, or higher.)



**Figure 48**

5. Install the dipstick securely.
6. Dispose of the used oil properly at a local recycling center.

# Charging the Battery

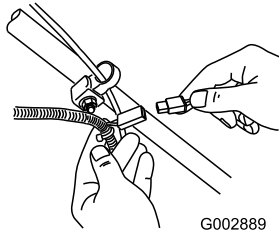
Model 20795 only



**Battery posts, terminals, and related accessories contain lead and lead compounds, chemicals known to the State of California to cause cancer and reproductive harm. Wash hands after handling battery.**

Charge the battery for 24 hours initially, then monthly (every 25 starts) or as needed. Always use the charger in a sheltered area and charge the battery at room temperature (70°F or 22°C) whenever possible.

1. Connect the charger to the mower wire harness located below the ignition key (Figure 49).



**Figure 49**

2. Plug the charger into a wall outlet.

**Note:** When the battery no longer holds a charge, recycle or dispose of the lead-acid battery according to local codes.

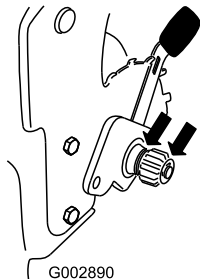
# Replacing the Fuse

Model 20795 only

If the battery does not charge or the engine does not turn with the electric starter, the fuse may be blown. Replace it with a 40-amp plug-in type fuse. Refer to Installing the Fuse.

# Lubricating the Wheel Gears

1. Remove the wheel bolts on the **rear** wheels and remove the rear wheels.
2. Apply a lubricating oil to the inner and outer sides of the gear as shown in Figure 50.



**Figure 50**

3. Install the rear wheels.

# Replacing the Blade

**Important:** You will need a torque wrench to install the blade properly. If you do not have a torque wrench or are uncomfortable performing this procedure, contact an Authorized Service Dealer.

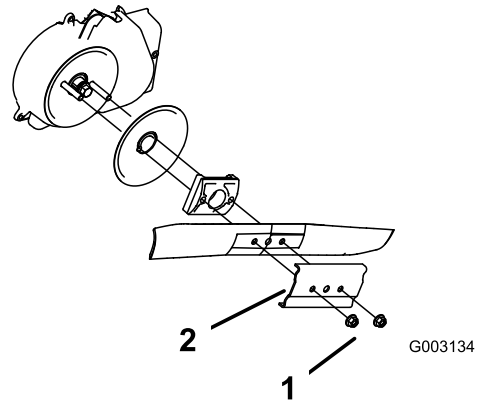
Examine the blade whenever you run out of gasoline. If the blade is damaged or cracked, replace it immediately. If the blade edge is dull or nicked, have it sharpened or replace it.



**The blade is sharp; contacting the blade can result in serious personal injury.**

**Wear gloves when servicing the blade.**

1. Disconnect the spark plug wire from the spark plug. Refer to Preparing for Maintenance.
2. Tip the mower onto its side with the air filter up.
3. Remove the 2 blade nuts and the stiffener (Figure 51).



**Figure 51**

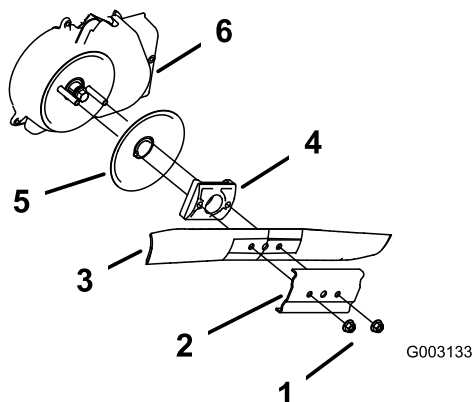
1. Blade nuts
2. Stiffener

4. Remove the blade (Figure 51).
5. Install the new blade (Figure 51).
6. Install the stiffener you previously removed.
7. **Install the blade nuts and torque them to 15 to 27 ft-lb (20 to 37 N·m).**

# Cleaning the Blade Brake Clutch Shield

Clean the blade brake clutch shield yearly to prevent the blade from stalling while you mow.

1. Disconnect the spark plug wire from the spark plug. Refer to Preparing for Maintenance on page 18.
2. Tip the mower onto its side with the air filter up.
3. Remove the 2 blade nuts and the stiffener (Figure 52).



**Figure 52**

- |               |                              |
|---------------|------------------------------|
| 1. Blade nuts | 4. Blade driver              |
| 2. Stiffener  | 5. Disk                      |
| 3. Blade      | 6. Blade brake clutch shield |

4. Remove the blade (Figure 52).
5. Remove the blade driver and disk (Figure 52).
6. Remove the blade brake clutch shield (Figure 52).
7. Brush or blow out debris from the inside of the shield and around all the parts.
8. Install the blade brake clutch shield that you previously removed.
9. Install the blade driver that you previously removed.
10. Install the blade and the stiffener that you previously removed (Figure 52).
11. **Install the blade nuts and torque them to 15 to 27 ft-lb (20 to 37 N·m).**

## Cleaning the Mower

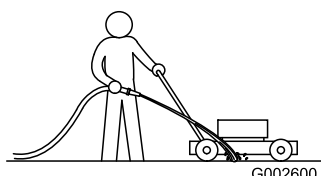


**The mower may dislodge material from under the mower housing.**

- **Wear eye protection.**
- **Stay in the operating position (behind the handle).**
- **Do not allow bystanders in the area.**

1. With the engine running on a flat paved surface, spray a stream of water in front of the **right** rear wheel (Figure 53).

The water will splash into the path of the blade, cleaning out the clippings.



**Figure 53**

2. When no more clippings come out, stop the water and move the mower to a dry area.
3. Run the engine for a few minutes to dry the housing to prevent it from rusting.

## Storage

Store the mower in a cool, clean, dry place.

## Preparing the Mower for Storage



**Gasoline vapors can explode.**

- **Do not store gasoline more than 30 days.**
- **Do not store the mower in an enclosure near an open flame.**
- **Allow the engine to cool before storing it.**

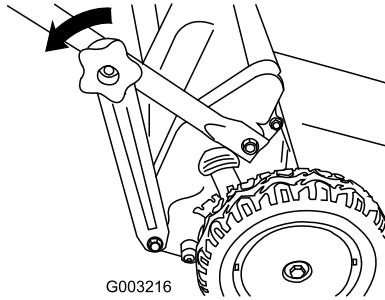
1. On the last refueling of the year, add fuel stabilizer to the fuel as directed by the engine manufacturer.
2. Dispose of any unused fuel properly. Recycle it according to local codes, or use it in your automobile.

**Note:** Old fuel in the fuel tank is the leading cause of hard starting. Do not store fuel without stabilizer more than 30 days, and do not store stabilized fuel more than 90 days.

3. Run the mower until the engine stops from running out of fuel.
4. Prime the engine and start it again.
5. Allow the engine to run until it stops. When you can no longer start the engine, it is sufficiently dry.
6. Disconnect the wire from the spark plug and connect the wire onto the retaining post.
7. Remove the spark plug, add 1 oz. (30 ml) of oil through the spark plug hole, and pull the starter rope slowly several times to distribute oil throughout the cylinder to prevent cylinder corrosion during the off-season.
8. Loosely install the spark plug.
9. Tighten all nuts, bolts, and screws.
10. Model 20795 only: Charge the battery for 72 hours, then unplug the battery charger and store the mower in an unheated area. If you must store the mower in a heated area, you must charge the battery every 90 days.

## Folding the Handle

1. Remove the lower handle knobs (Figure 54).

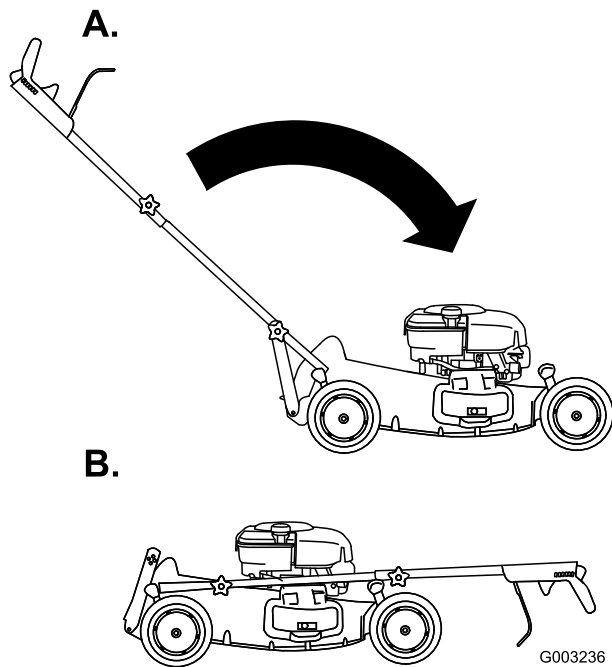


**Figure 54**

**Note:** Attach the lower handle knobs onto the bolts in the handle to prevent losing them.

2. Detach the lower handle brackets from the lower end of both handle sides (Figure 54).
3. Rotate the handle forward (Figure 55).

**Important:** Route the cables to the outside of the handle knobs as you fold the upper handle.



**Figure 55**

4. To unfold the handle, refer to Unfolding the Handle.

## Removing the Mower from Storage

1. Remove the spark plug and spin the engine rapidly using the starter to blow the excess oil from the cylinder.
2. Install the spark plug and tighten it with a torque wrench to 15 ft-lb (20 N·m).
3. Charge the battery (model 20795 only).
4. Connect the wire to the spark plug.











## The Toro Warranty

### Conditions and Products Covered

The Toro® Company and its affiliate, Toro Warranty Company, pursuant to an agreement between them, jointly promises to the original purchaser\* to repair any Toro Product used for normal residential purposes\* if defective in materials or workmanship. The following time periods apply from the date of original purchase:

| Products                    | Warranty Period         |
|-----------------------------|-------------------------|
| Walk Power Mowers           | 2-year limited warranty |
| Rear Engine Riders          | 2-year limited warranty |
| Lawn & Garden Tractors      | 2-year limited warranty |
| Electric Hand Held Products | 2-year limited warranty |
| Snowthrowers                | 2-year limited warranty |
| Consumer Zero Turn          | 2-year limited warranty |

\* "Original purchaser" means use the person who originally purchased Toro products.

\* "Normal residential purposes" means use of the product on the same lot as your home. Use at more than one location is considered commercial use, and the commercial use warranty would apply.

### Limited Warranty for Commercial Use

Toro Consumer Products and attachments used for commercial, institutional, or rental use are warranted against defects in materials or workmanship for the following time periods from the date of original purchase:

| Products                    | Warranty Period |
|-----------------------------|-----------------|
| Walk Power Mowers           | 90 day warranty |
| Rear Engine Riders          | 90 day warranty |
| Lawn & Garden Tractors      | 90 day warranty |
| Electric Hand Held Products | 90 day warranty |
| Snowthrowers                | 90 day warranty |
| Consumer Zero Turn          | 45 day warranty |

### Instructions for Obtaining Warranty Service

If you think that your Toro Product contains a defect in materials or workmanship, follow this procedure:

1. Contact your seller to arrange service of the product. If for any reason it is impossible for you to contact your seller, you may contact any Toro Authorized Distributor to arrange service.
2. Bring the product and your proof of purchase (sales receipt) to your seller or the Service Dealer.

If for any reason you are dissatisfied with the Service Dealer's analysis or with the assistance provided, contact the Toro importer or contact us at:

Customer Care Department, Consumer Division  
Toro Warranty Company  
8111 Lyndale Avenue South  
Bloomington, MN 55420-1196  
Manager: Technical Product Support: 001-952-887-8248

See attached Distributor List

### Owner Responsibilities

You must maintain your Toro Product by following the maintenance procedures described in the operator's manual. Such routine maintenance, whether performed by a dealer or by you, is at your expense.

### Items and Conditions Not Covered

This express warranty does not cover:

- Cost of regular maintenance service or parts, such as filters, fuel, lubricants, tune-up parts, blade sharpening, brake and clutch adjustments.
- Any product or part which has been altered or misused or required replacement or repair due to normal wear, accidents, or lack of proper maintenance.
- Repairs necessary due to improper fuel, contaminants in the fuel system, or failure to properly prepare the fuel system prior to any period of non-use over three months.
- Engine and transmission. These are covered by the appropriate manufacturer's guarantees with separate terms and conditions.

All repairs covered by this warranty must be performed by an Authorized Toro Service Dealer using Toro approved replacement parts.

### General Conditions

The purchaser is covered by the national laws of each country. The rights to which the purchaser is entitled with the support of these laws are not restricted by this warranty.

## International Distributor List—Consumer Products

| <b>Distributor:</b>                 | <b>Country:</b>            | <b>Phone Number:</b> |
|-------------------------------------|----------------------------|----------------------|
| Atlantis Su ve Sulama Sistemleri Lt | Turkey                     | 90 216 344 86 74     |
| Balama Prima Engineering Equip      | Hong Kong                  | 852 2155 2163        |
| B-Ray Corporation                   | Korea                      | 82 32 551 2076       |
| Casco Sales Company                 | Puerto Rico                | 787 788 8383         |
| Ceres S.A                           | Costa Rica                 | 506 239 1138         |
| CSSC Turf Equipment (pvt) Ltd       | Sri Lanka                  | 94 11 2746100        |
| Cyril Johnston & Co                 | Nothern Ireland            | 44 2890 813 121      |
| Equivier                            | Mexico                     | 52 55 539 95444      |
| Femco S.A.                          | Guatemala                  | 502 442 3277         |
| G.Y.K. Company Ltd.                 | Japan                      | 81 726 325 861       |
| Geomechaniki of Athens              | Greece                     | 30 10 935 0054       |
| Guandong Golden Star                | China                      | 86 20 876 51338      |
| Hako Gorund and Garden              | Sweden                     | 46 35 10 0000        |
| Hydroturf Int. Co                   | Dubai United Arab Emirates | 97 14 347 9479       |
| Hydroturf Egypt LLC                 | Egypt                      | 202 519 4308         |
| Ibea S.p.A.                         | Italy                      | 39 0331 853611       |
| Irriamc                             | Portugal                   | 351 21 238 8260      |
| Jean Heybroek b.v.                  | Netherlands                | 31 30 639 4611       |
| Lely (U.K. ) Limited                | United Kingdom             | 44 1480 226 800      |
| Maquiver S.A.                       | Columbia                   | 57 1 236 4079        |
| Maruyama Mfg. Co. Inc.              | Japan                      | 81 3 3252 2285       |
| Metra Kft                           | Hungary                    | 36 1 326 3880        |
| Mountfield a.s.                     | Czech Republic             | 420 255 704 220      |
| Munditol S.A.                       | Argentina                  | 54 11 4 821 9999     |
| Oslinger Turf Equipment SA          | Ecuador                    | 593 4 239 6970       |
| Oy Hako Ground and Garden Ab        | Finland                    | 358 987 00733        |
| Parkland Products Ltd               | New Zealand                | 64 3 34 93760        |
| Prochaska & Cie                     | Austria                    | 43 1 278 5100        |
| RT Cohen 2004 Ltd                   | Israel                     | 972 986 17979        |
| Riversa                             | Spain                      | 34 9 52 83 7500      |
| Roth Motorgerate GmBh & Co          | Germany                    | 49 7144 2050         |
| Sc Svend Carlsen A/S                | Denmark                    | 45 66 109 200        |
| Solvert S.A.S                       | France                     | 33 1 30 81 77 00     |
| Spypros Stavrinides Limited         | Cyprus                     | 357 22 434131        |
| Surge Systems India Limited         | India                      | 91 1 292299901       |
| T-Markt Logistics Ltd               | Hungary                    | 36 26 525 500        |
| Toro Australia                      | Australia                  | 61 3 9580 7355       |
| Toro Europe BVBA                    | Belgium                    | 32 14 562 960        |