



Leveling Blade

For Sand/Infield Pro® 3040 and 5040 Traction Unit

Model No. 108-8496

Installation Instructions

Note: Determine the left and right sides of the machine from the normal operating position.

Installation

Step

1

Installing the Leveling Blade

Parts needed for this step:

4	Carriage bolt (5/16 x 3/4 inch)
6	Locknut (5/16 inch)
21	Bolt (5/16 x 2 inches)
1	Left hand pivot
1	Right hand pivot
1	Tool bar
1	Blade plate
1	Latch
1	Torsion spring
1	Blade lock lever
1	Transport cam
1	Spring clip

the latch and the front of the blade lock lever. Secure the spring and the lever to the stud with a locknut (5/16 inch) (Figure 1). Do not overtighten the nut. The blade lock lever must be able to pivot freely.

- The leveling blade is equipped with an automatic latch. The eccentric on the tool bar may need to be adjusted to force the leveling blade to latch when the teeth are raised. Refer to the Midmount Toolbar System *Operator's Manual* for the adjustment procedure.

Procedure

- Insert the left hand and right hand pivots onto the appropriate end of the tool bar (Figure 1). The pivots are to be positioned so they point toward the front of the machine.
- Mount the blade plate to each pivot with 2 carriage bolts (5/16 x 3/4 inch) and 2 locknuts (5/16 inch) (Figure 1).
- Insert the latch into the right end of the midmount lift tube, align the mounting holes and secure together with a bolt (5/16 x 2 inches) and locknut (5/16 inch). Position the latch and fasteners as shown in Figure 1.
- Insert the torsion spring and the blade lock lever onto the latch stud. The spring must be installed so it forces the lever clockwise. The spring ends are to hook under the bottom of

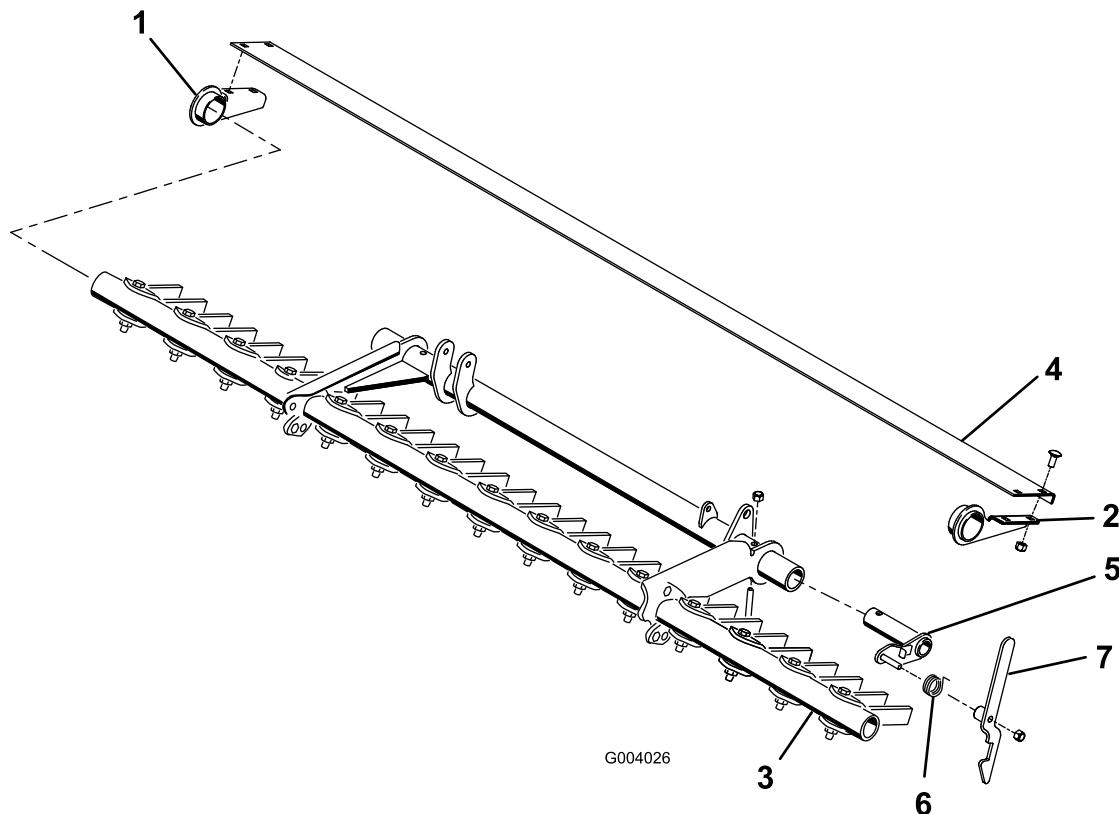

Figure 1

- | | | | |
|---------------------|----------------|-------------------|---------------------|
| 1. Left hand pivot | 3. Tool bar | 5. Latch | 7. Blade lock lever |
| 2. Right hand pivot | 4. Blade plate | 6. Torsion spring | |

Operation



The leveling blade is designed for moving small amounts of material. Misuse may result in damage to the midmount tool bar system or the leveling blade.

- Driving over an 8 inch (203 mm) curb may result in damage to the leveling blade.
- Refer to the Midmount Toolbar System Operator's Manual for additional adjustments and trouble shooting procedures.

- Release the latch to lower the leveling blade from the transport position.
- The additional weight of the leveling blade may require an adjustment to the adjustable rod assembly and assist springs. With the additional force generated from the assist springs, the adjustable rod will need to be readjusted. Refer to the Midmount Toolbar System *Operator's Manual* for adjustment procedure.

Operating Tips

- The leveling blade may be used with the optional scarifier tine bar, weeder tine bar or the spring tine bar.