

# OPERATOR S MANUAL

## Twin Rear Bagger Kit

For FastAttach   Garden Tractors  
with 46" Deck

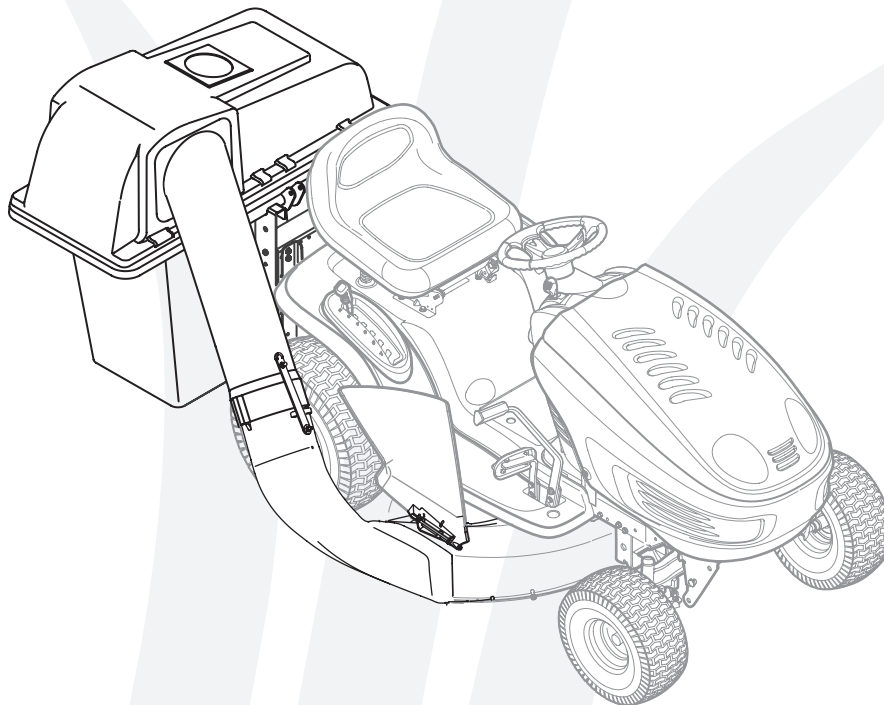

**Models OEM-190-182**

---

### IMPORTANT

**READ SAFETY RULES AND INSTRUCTIONS CAREFULLY BEFORE OPERATION**

---

This Operator's Manual is an important part of your new grass collector. It will help you assemble, prepare and maintain the unit for best performance. Please read and understand what it says.

## Finding and Recording Model Number

### BEFORE YOU START ASSEMBLING YOUR NEW EQUIPMENT,

please locate the model plate and copy the information from it in this Operator's Manual for future reference. The information on the model plate is very important if you need help from our Customer Support Department or your authorized dealer.

You can locate it by looking on the front, left portion of the plastic grass catcher cover as seen below:

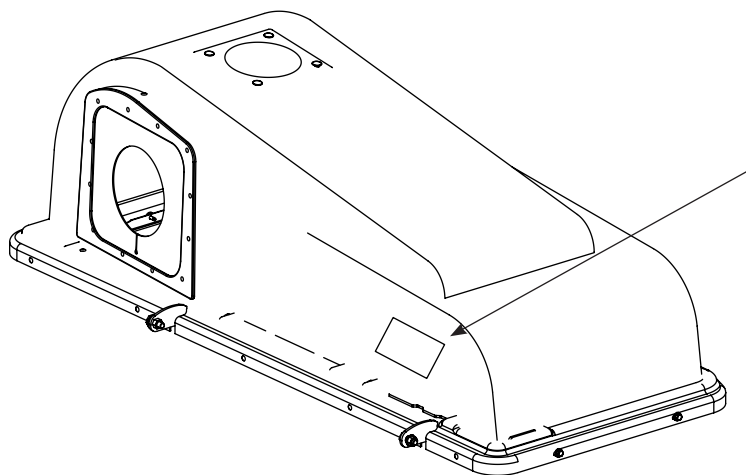

Model Number

Serial Number



MTD LLC  
P.O. BOX 361131  
CLEVELAND, OH 44136  
330-220-4683  
800-800-7310

\*Locate the model plate on your bagger and copy the information from it in the space provided above for future reference.

## Customer Support

Please do **NOT** return the unit to the retailer from which it was purchased, without first contacting Customer Support.

If you have difficulty assembling this product or have any questions regarding the controls, operation, or maintenance of this unit, you can seek help from the experts. Choose from the options below:

- Visit **mtdproducts.com**. Click on the Service & Support menu option.
- Phone a **Customer Support Representative** at 1-800-800-7310.
- Please have your unit's model number and serial number ready when you call. See previous section to locate this information. You will be asked to enter the serial number in order to process your call.

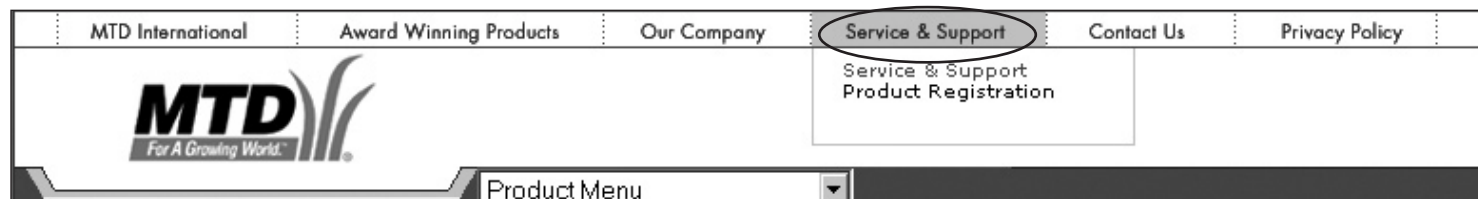

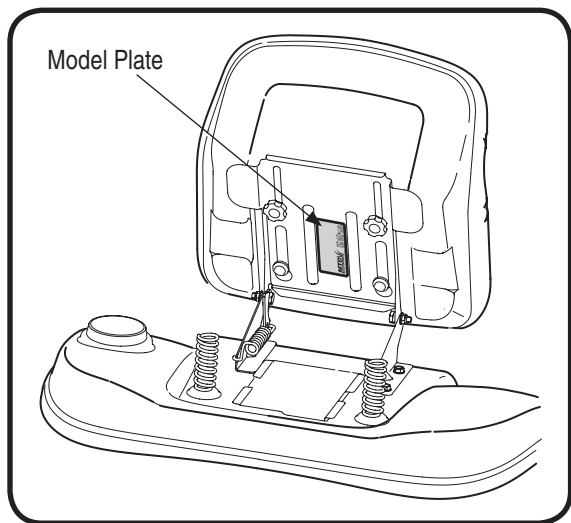

**Figure 1**

## FastAttach™ Twin Bag Grass Collector

The Model OEM-190-182 Twin Bag Grass Collector is a grass collection system designed for use on all MTD 46" cut FastAttach™ compatible lawn tractors (except 2001 MTD/Yard-Man Revolution).

The instructions in this manual are divided into sections. Carefully read all sections and study the illustrations to ensure proper installation and usage of this attachment. Read and observe all WARNING and CAUTION statements. They are included to provide for the protection of the equipment installer and user, and to ensure the prolonged service life of the equipment.

**NOTE:** References to LEFT and RIGHT indicate the left and right sides of the tractor when facing forward in the operator's position. Reference to the FRONT indicates the grille end; to the REAR, the rear end of the tractor.

## Determine The Model of Your Rider

Since this manual is designed for installation of your new bagger on several different rider units, it is important for you to determine which model of rider you have. Therefore you will know which set of instructions in the following pages to follow.

To determine which model of rider you have, you will need to locate the rider's model plate, located under the seat. Simply flip the seat up and locate the model plate, which will consist of an 11 digit/letter model number and a serial number. For ease in this installation and for future use, copy your rider's model number & serial number below now:

Rider Model Number: \_\_\_\_\_

Rider Serial Number: \_\_\_\_\_

The 5<sup>th</sup>, 6<sup>th</sup> & 7<sup>th</sup> numbers from the left in your model number determine your rider's model series. See Figure 2.

When you fill in your model number in the space above, the actual model series number should fall into the gray shaded area.

Now that you have determined what model rider you are attaching this grass bag collection system to, follow the instructions on the following pages according to your model of rider.

# 1

## Rider Model Identification



**NOTE:** References to LEFT and RIGHT indicate the left and right sides of the tractor when facing forward in the operator's position. Reference to the FRONT indicates the grille end; to the REAR, the rear end of the tractor.

### Sample Model Number

1 3 A M 6 1 9 G 0 0 0

Indicates Model Series 600

**Figure 2**

# 2

## Carton Contents



*If you are missing any parts, please do not contact the retailer where you purchased this unit, call MTD directly at 1-330-220-4MTD or toll free at 1-800-800-7310.*

## CONTENTS OF CARTON

Before beginning installation, remove all parts from the carton to make sure everything is present. Carton contents are listed below and shown in Figure 1. Hardware part numbers are shown in parentheses.

One Chute Tube

One Grass Catcher Cover Assembly

One Discharge Chute Assembly

One Mounting Bracket

Two Grass Bag Assemblies

Three Blades

One Support Tube

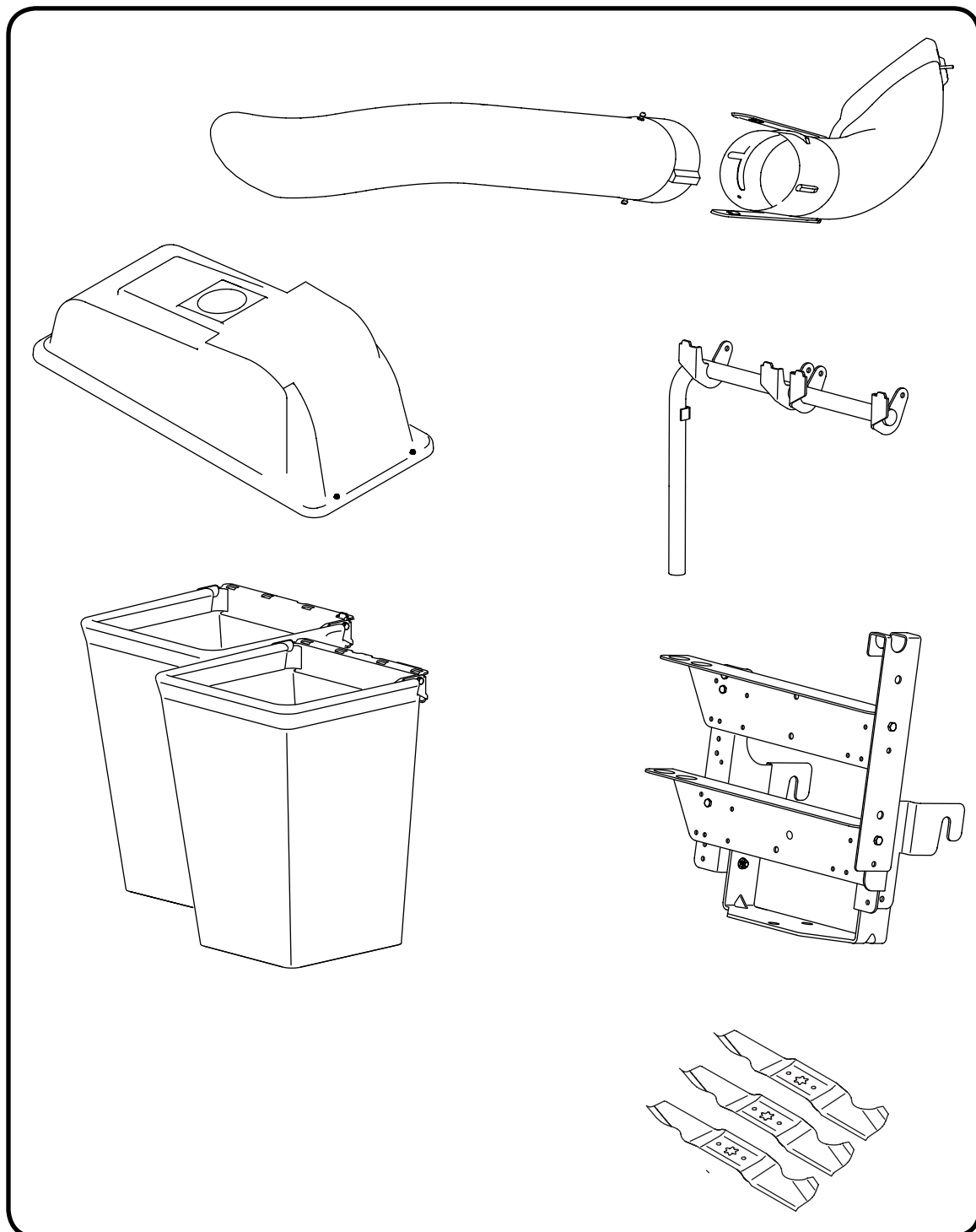

Figure 3

## CONTENTS OF HARDWARE PACK

This grass collector kit is shipped with a hardware pack enclosed. This hardware pack may contain extra parts for installation on a different rider from which you have. Please check your hardware pack against the illustration below in accordance with your model of rider as determined in Section 1 of this manual.

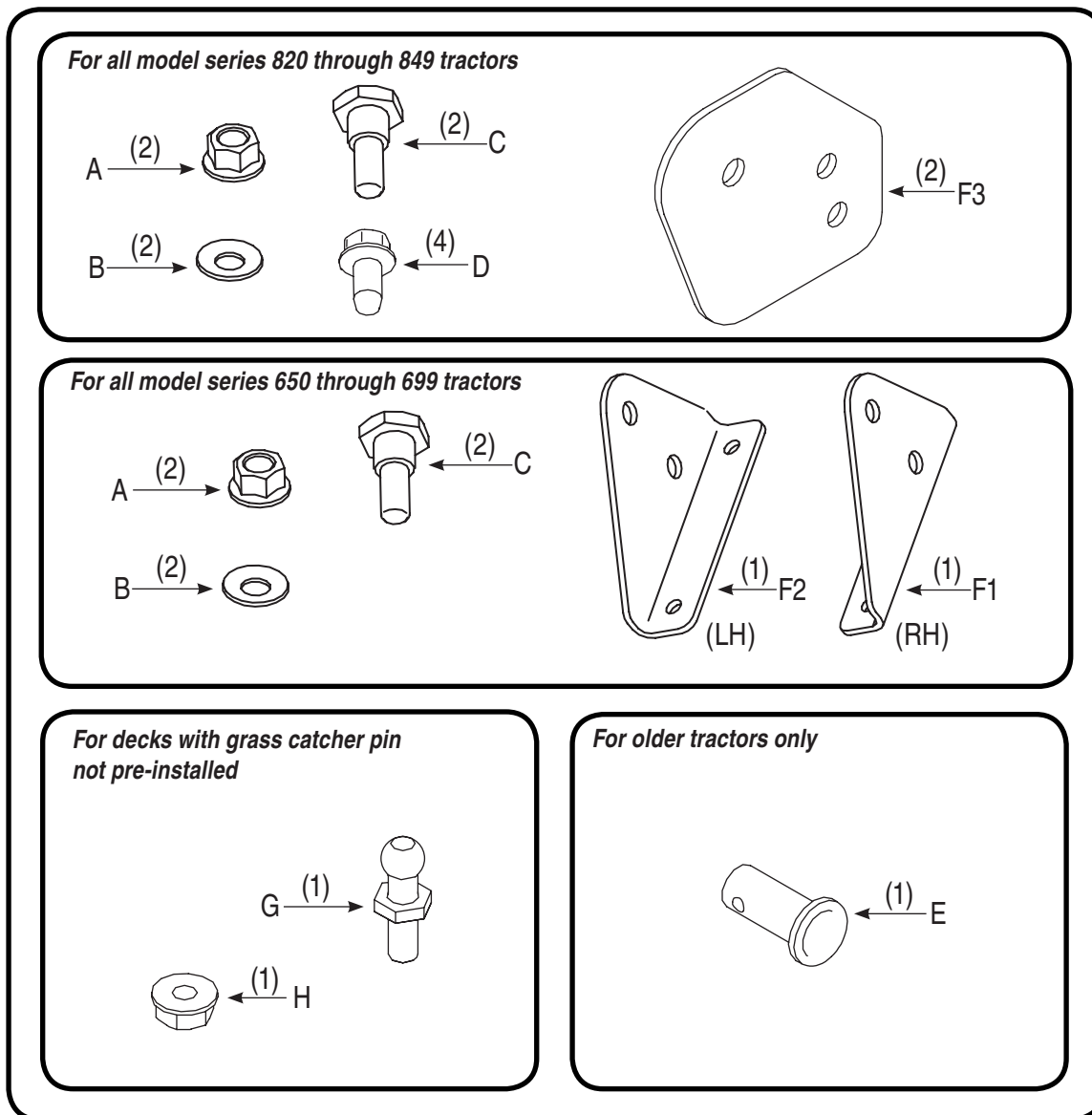

Figure 4

**NOTE:** Each item has been identified in above for ease of assembly, and the letter code assigned here is maintained in assembly instructions.

RH = Right Hand  
 LH = Left Hand

(#) = Quantity

# 2

## Carton Contents



**If you are missing any parts, please do not contact the retailer where you purchased this unit, call MTD directly at 1-330-220-4MTD or toll free at 1-800-800-7310.**

**NOTE:** Each item has been identified in above for ease of assembly, and the letter code assigned here is maintained in assembly instructions.

**RH = Right Hand  
 LH = Left Hand**

# 3

## Attaching Bracket Assembly

Model Series 600 through 619  
through 619



### IMPORTANT:

Before assembly, place the tractor on a firm, level surface, disengage the PTO, stop the tractor engine and set the parking brake.

### NOTE:

There are two holes in the clevis pin. Be sure to insert the hairpin clip in the upper hole to properly secure the bracket assembly to the hitch plate.

## Attaching The Bracket Assembly

Model Series 600 through 619  
Model Series 800 through 819

**IMPORTANT:** Before assembly, place the tractor on a firm, level surface, disengage the PTO, stop the tractor engine and set the parking brake.

1. For convenience, pivot the seat forward and leave it in that position until the grass collector is fully mounted and assembled.
2. Remove the hairpin clip and clevis pin from the rear of the mounting bracket assembly. See Figure 5.
3. Position the hooked ends of the bracket assembly over the shoulder bolts (1). Swing in the bottom of the bracket assembly down and in (2) over the hitch plate and aligning with the hole on the hitch plate. See Figure 5.
4. Reinsert the clevis pin through the aligned holes in both the bracket assembly and the hitch plate and secure with the hairpin clip removed earlier. Refer to Figure 6.

**NOTE:** There are two holes in the clevis pin. Be sure to insert the hairpin clip in the upper hole to properly secure the bracket assembly to the hitch plate.

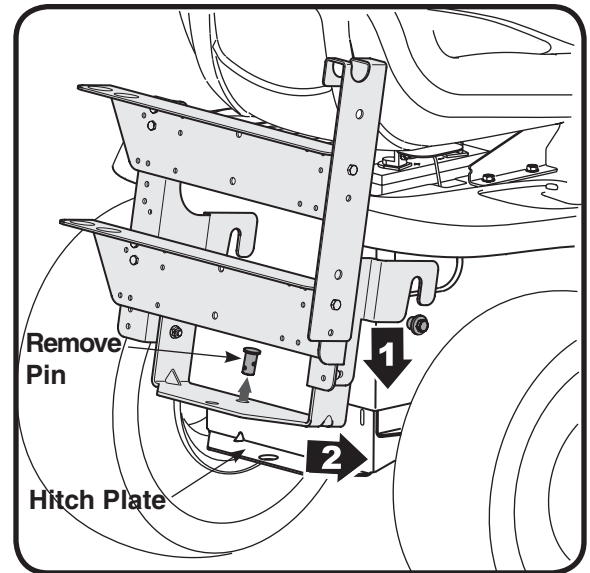

Figure 5

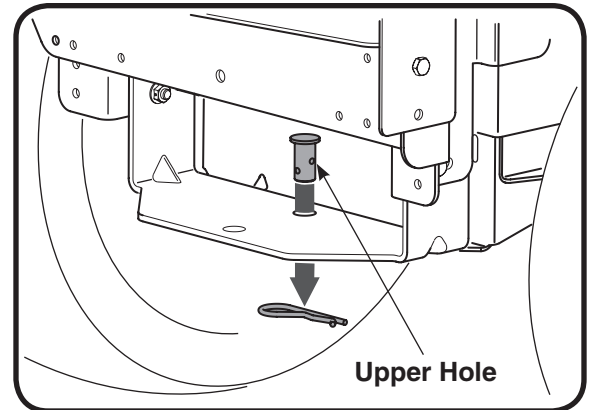

Figure 6

## Model Series 650 through 699

This graphic below coordinates with the instructions for the Model Series 650 through 699, which begin on the next page.

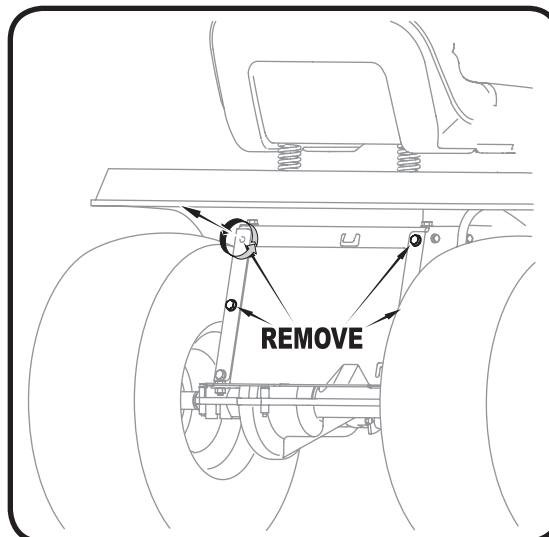

Figure 7

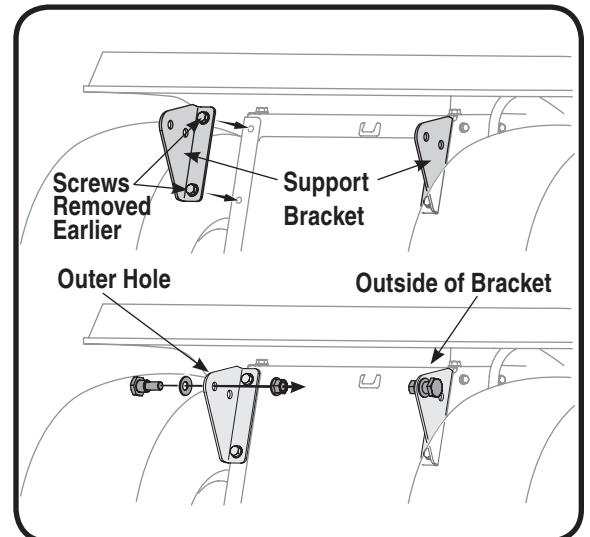

Figure 8



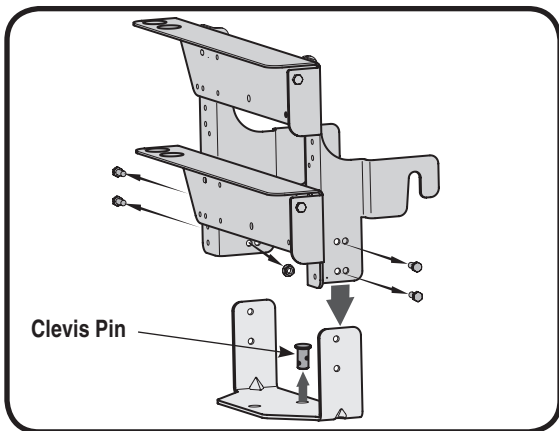

Figure 9

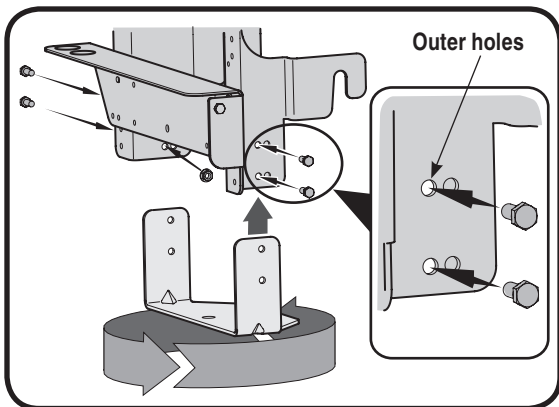

Figure 10

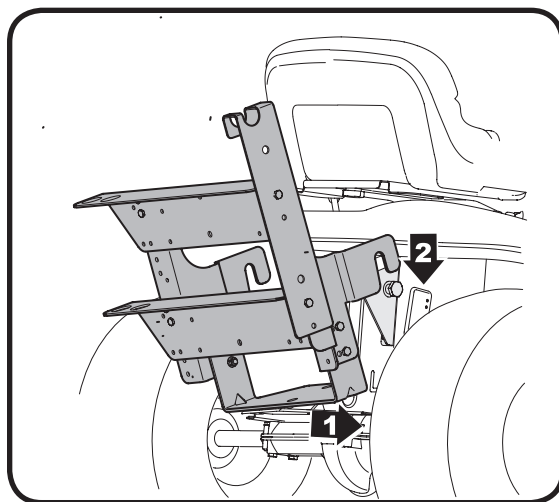

Figure 11

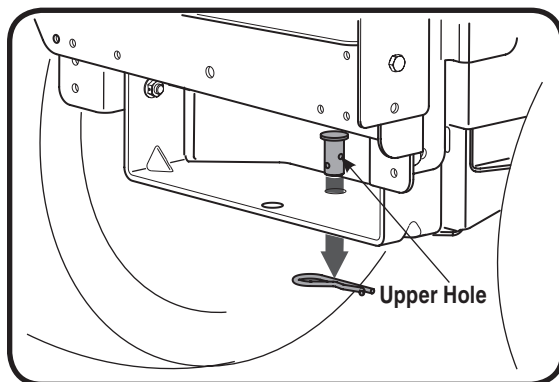

Figure 12

## Assembling Support Brackets

### Model Series 650 through 699

**IMPORTANT:** Before assembly, place the tractor on a firm, level surface, disengage the PTO, stop the tractor engine and set the parking brake.

1. Remove the top four self-tapping screws from the rear of the lawn tractor. See Figure 7 on the previous page.
2. Place the right hand grass catcher support bracket (F1 from Figure 4), in position, with the wide end on top and the narrow end pointing down as shown in Figure 8.
3. Secure the support bracket to the tractor frame with two self-tapping screws earlier removed. Refer to Figure 8. Repeat on the other side using part F2 from Figure 4.

**NOTE:** If the grass collection system is removed for any reason, it is not necessary to remove the support brackets from the tractor.

4. Insert a shoulder bolt (C in Figure 4) through a bell washer, (B in Figure 4) and insert the bolt from the outside of the bracket through the outer hole on the support bracket. Secure with a nut (A in Figure 4). See Figure 8 for details. Repeat on other side.

**NOTE:** The reference above to "the outer hole" means the hole furthest away from the frame.

## Attaching Bracket Assembly

### Model Series 650 through 699

1. Remove the two nuts and bolts on each side of the mounting bracket holding the hitch plate.
2. Rotate the hitch plate 180° from its original position. Re-insert the four bolts through mounting bracket and hitch plate frame and secure with nuts removed earlier. Use the outer holes (furthest from the mounting hooks) on the mounting bracket. See Figure 10.
3. For convenience, pivot the seat forward and leave it in that position until the grass collector is fully mounted and assembled.
4. Remove the hairpin clip and clevis pin from the rear of the mounting bracket assembly. See Figure 9.
5. Position the hooked ends of the mounting bracket assembly to the outside of the support brackets and over the shoulder bolts just installed on both sides of the tractor frame. See Figure 11.
6. Reinsert the clevis pin through the aligned holes in both the bracket assembly and the hitch plate and secure with the hairpin clip removed earlier. See Figure 12 for reference.

**IMPORTANT:** There are two holes in the clevis pin. Be sure to insert the hairpin clip in the upper hole to properly secure the bracket assembly to the hitch plate.

**NOTE:** For some tractor models, this clevis pin is too large. Use a smaller clevis pin (E in Figure 4) in its place with the same hairpin clip.

# 3

## Attaching Support Bracket & Bracket Assembly

Model Series 650 through 699



### IMPORTANT:

Before assembly, place the tractor on a firm, level surface, disengage the PTO, turn off tractor engine and set the parking brake.

### NOTE:

If the grass collection system is removed for any reason, it is not necessary to remove the support brackets from the tractor.

### IMPORTANT:

There are two holes in the clevis pin. Be sure to insert the hairpin clip in the upper hole to properly secure the bracket assembly to the hitch plate.

### NOTE:

For some tractor models, this clevis pin is too large. Use a smaller clevis pin in its place with the same hairpin clip.

# 3

## Attaching Support Bracket & Bracket Assembly

Model Series 820 through 849



### NOTE:

*If the grass collection system is removed for any reason, it is not necessary to remove the support brackets from the tractor.*

### IMPORTANT:

There are two holes in the clevis pin. Be sure to insert the hairpin clip in the upper hole to properly secure the bracket assembly to the hitch plate.

## Assembling Support Brackets

### Model Series 820 through 849

1. Locate the four self-tapping screws supplied in your hardware pack (D from Figure 4). Attach one of the grass catcher support brackets (F3 from Figure 4) using two of the supplied screws in position as shown in Figure 13. Place the other grass catcher support bracket (F3 from Figure 4) in position and secure with the other two screws.
5. Insert a shoulder bolt (C in Figure 4) through a bell washer, (B in Figure 4) and insert the bolt through the remaining hole from the outside of the support bracket. Secure with a nut (A in Figure 4). See Figure 13 for details. Repeat on other side.

**NOTE:** *If the grass collection system is removed for any reason, it is not necessary to remove the support brackets from the tractor.*

## Attaching The Bracket Assembly

1. Remove the two nuts and screws on each side of the mounting bracket holding the hitch plate. See Figure 14.
2. Rotate the hitch plate 180° from its original position. Re-insert the four bolts through mounting bracket and hitch plate frame and secure with nuts removed earlier. Use the inner holes (closest to the mounting hooks) on the mounting bracket. Refer to Figure 15.
3. Remove the hairpin clip and clevis pin from the hitch plate as seen in Figure 14. Save the hardware.
4. Position the hooked ends of the mounting bracket assembly to the outside of the support bracket and over the shoulder bolts on both sides. Refer back to Figure 11 for reference.
5. Reinsert the clevis pin through the aligned holes in both the bracket assembly and the hitch plate and secure with the hairpin clip removed earlier. See Figure 16.

**IMPORTANT:** There are two holes in the clevis pin. Be sure to insert the hairpin clip in the upper hole to properly secure the bracket assembly to the hitch plate.

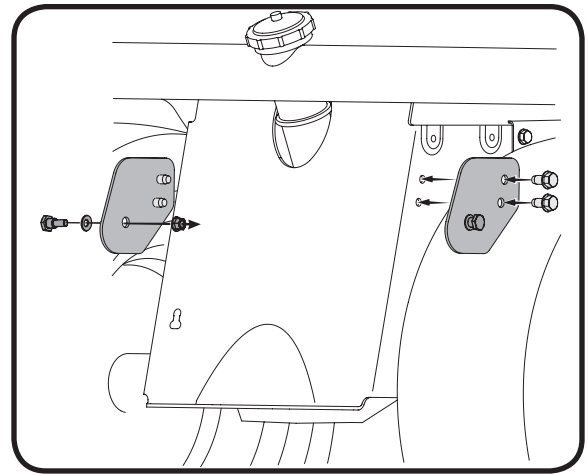

Figure 13

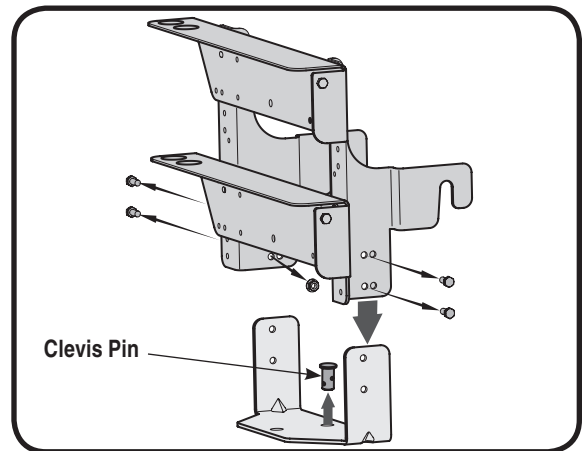

Figure 14

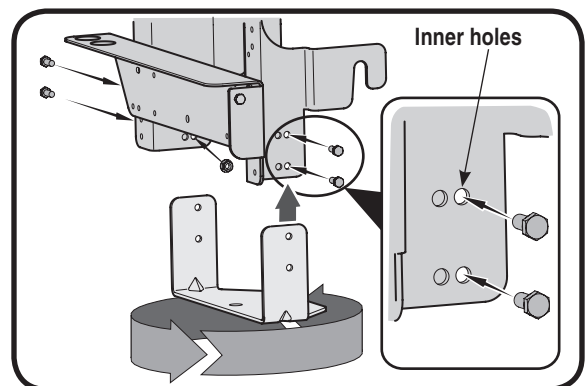

Figure 15

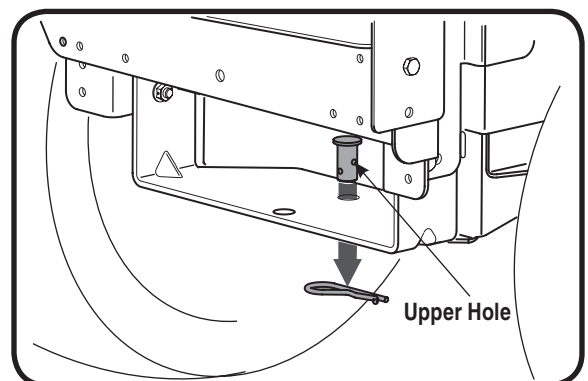

Figure 16



# 4

## Attaching Grass Bags & Grass Bag Cover

All Model Series  
600 through 800



### NOTE:

*Insert the clevis pins from the outside in as shown in the inset images of Figure 20.*

### NOTE:

*It is very important to maintain this order and direction while installing these hardware pieces. After installation, make sure that the grass bag cover pivots on the support tube and opens.*

## Attaching Grass Bags & Grass Bag Cover

1. Place the support tube in position on the rear of unit by sliding the support tube down through the holes in the left side of the bracket assembly. Use the inside hole on the bracket assembly regardless of what size deck your tractor is equipped with. Refer to Figure 17.
2. Attach the grass bags by hooking them onto the grass bag bracket using the slots in the grass bag and the tabs on the grass bag bracket as shown in Figure 18.
3. Place the grass bag cover on top of the grass bags and align the holes on the hinges of the grass bag cover with the corresponding holes on the support tube assembly. See Figure 19.
4. Insert the clevis pin through the hinge on the support tube assembly and then through the grass bag cover. See Figure 20.
5. Secure with belleville washer and hairpin clip with the crown side of the washer going against the hairpin clip. See inset images in Figure 20.
6. Repeat with the second set of hardware through the second hinge of the grass bag and the tube assembly from the opposite direction.

**NOTE:** *Insert the clevis pins from the outside in as shown in the inset images of Figure 20.*

**NOTE:** *It is very important to maintain this order and direction while installing these hardware pieces. After installation, make sure that the grass bag cover pivots on the support tube and opens.*

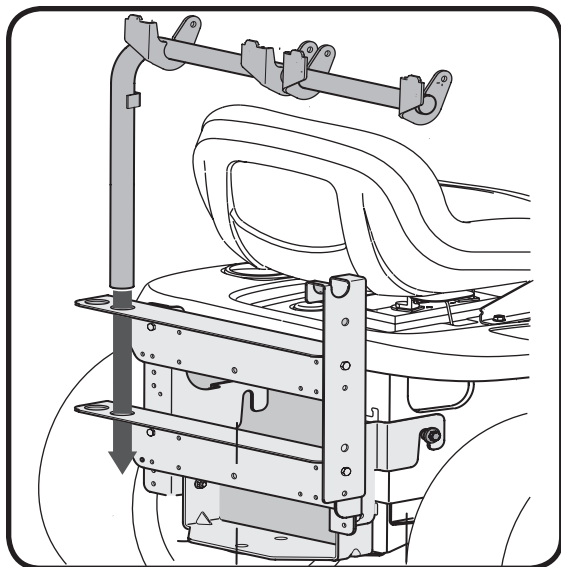

Figure 17

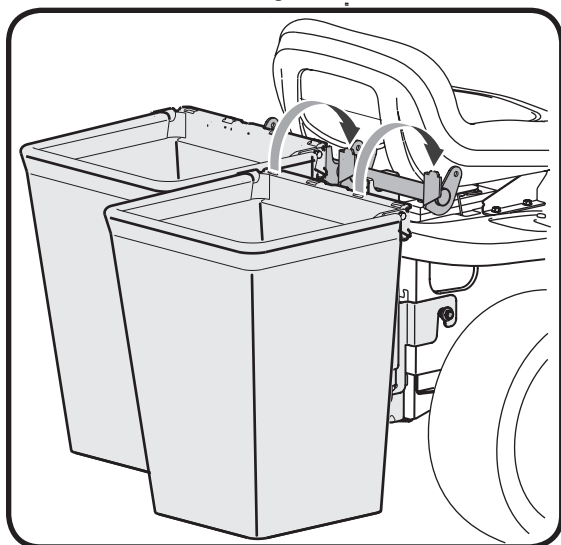

Figure 18

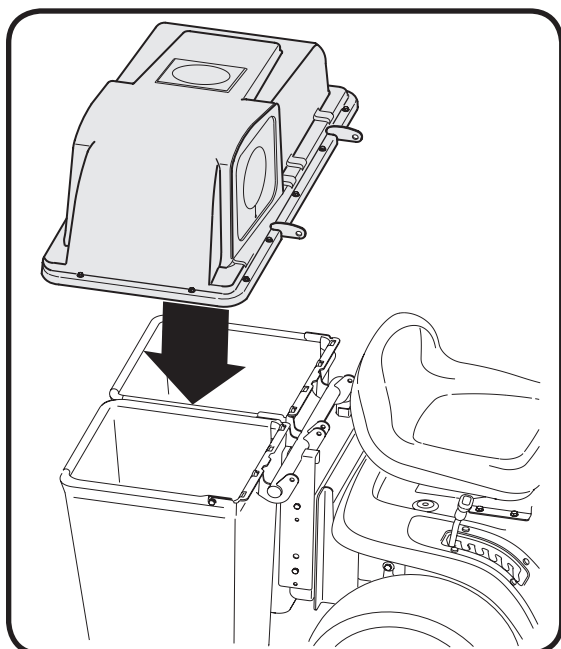

Figure 19

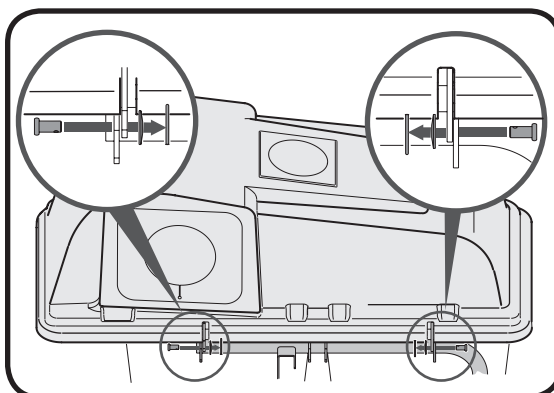

Figure 20

# 5

## Attaching Discharge Chute

All 600 Model Series  
600 through 699



### NOTE:

*The hex flange nut has a normal (right-handed) thread pattern. Do NOT attempt to force the nut in the incorrect direction. Doing so may damage the nut and create a safety hazard.*

### NOTE:

*The retainer strap is fitted at position B on the discharge chute. However, on older models of tractors, you will have to change the position of the strap depending on the location of the grass catcher pin on the deck. Remove the retainer strap from position B on the discharge chute to position A or C corresponding to the position of the grass catcher pin at A, B or C on the deck. See Figure 24.*

## Attaching The Blades

1. Remove the blades from your tractor's cutting deck as follows.
2. Remove the cutting deck from beneath the tractor, (refer to Deck Removal in the MAINTENANCE section of your tractor's operator's manual for detailed instructions) then gently flip the deck over to expose its underside.
3. Place a block of wood between the center deck housing baffle and the cutting blade to act as a stabilizer, keeping the blades from turning when you loosen the hex flange nuts.
4. Use a 15/16" wrench to remove the hex flange nut that secures the blade to the spindle assembly.

**NOTE:** *The hex flange nut has a normal (right-handed) thread pattern. Do NOT attempt to force the nut in the incorrect direction. Doing so may damage the nut and create a safety hazard.*

5. Install the new blades packed with the bagger. Be sure to install the blade with the side of the blade marked "Bottom" (or with a part number stamped in it) facing the ground when the rider is in the operating position.
6. Mount the SMALLER of the three blades to the CENTER spindle. The remaining two blades are interchangeable. See Figure 21.
7. Use a torque wrench to tighten the blade spindle hex flange nut to between 70 and 90 foot-pounds.
8. Remount the cutting deck.

## Attaching Discharge Chute

*All 600 & 800 Model Series*

1. **On older models:** Some older models may have a clip already installed on the deck (See Figure 22) next to the discharge chute opening. If this is the case, the clip must be removed and a grass catcher pin, which is included in your hardware pack, installed. To remove clip, simply remove the lock nut, spring washer and hex bolt that secure it. See Figure 23A.
2. **Installing Grass Catcher Pin:** A grass catcher pin (G in Figure 4) and nut (H in Figure 4) have been supplied in the hardware pack. Attach pin to the deck in place of the clip just removed. Some units may not have clip but will have an open hole for pin installation. Follow Figure 23B for order of assembly. Make sure to secure the pin tightly.

**NOTE:** *The retainer strap is fitted at position A on the discharge chute. However, on older models of tractors, you will have to change the position of the strap depending on the location of the grass catcher pin on the deck. Remove the retainer strap from position A on the discharge chute to position B or C corresponding to the position of the grass catcher pin at A, B or C on the deck. See Figure 24.*

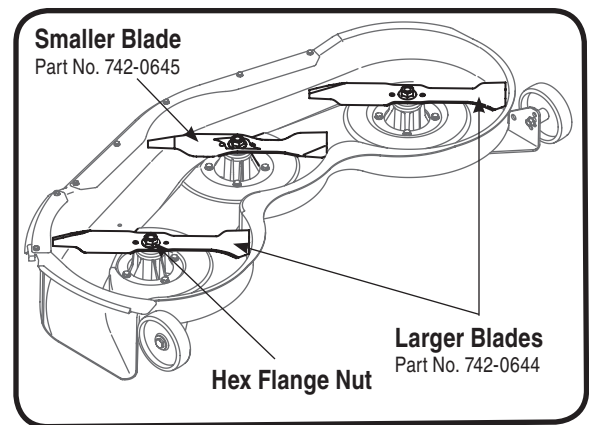

Figure 21

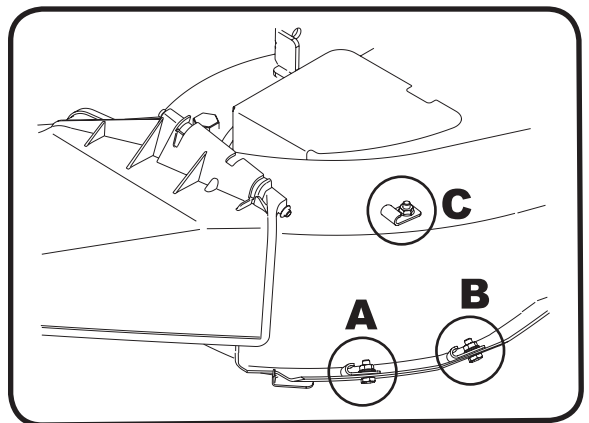

Figure 22

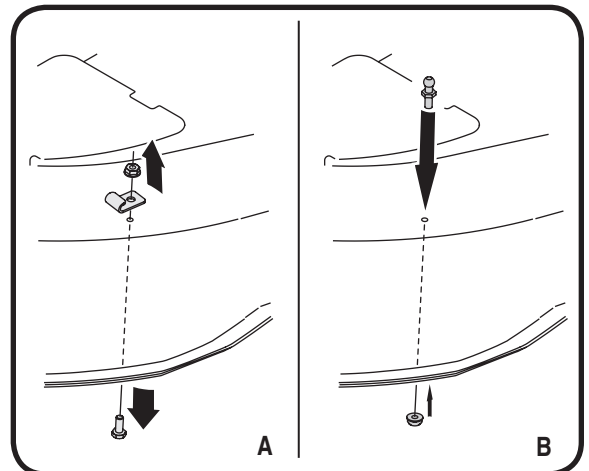

Figure 23

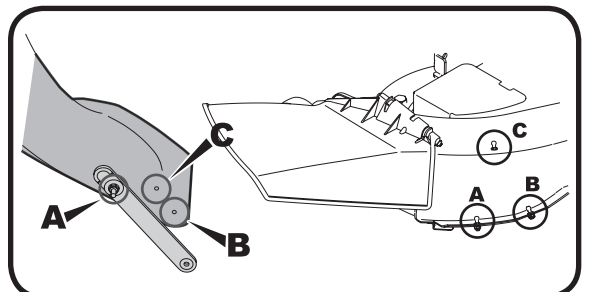

Figure 24

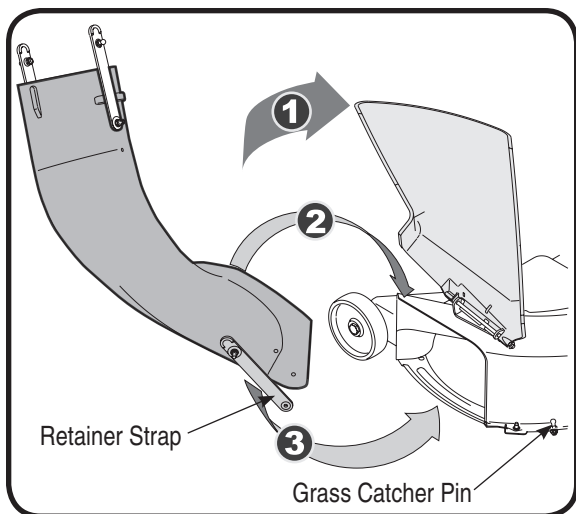

Figure 25

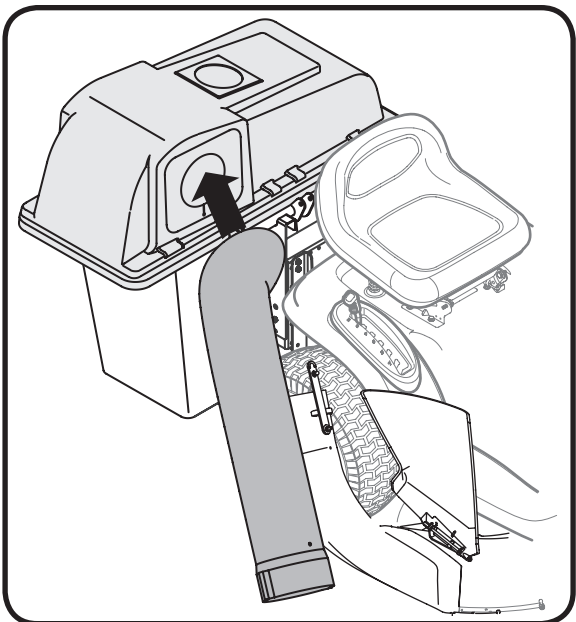

Figure 26

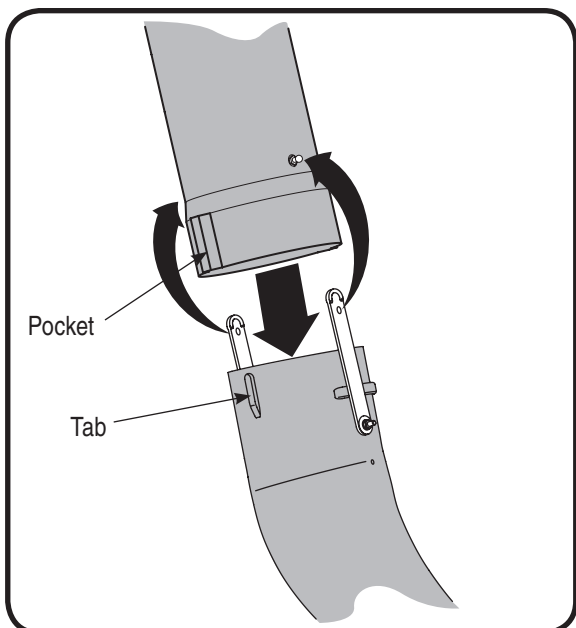

Figure 27

3. Raise the deck to its highest position.
4. Raise the chute deflector on the deck and hold it while you position the discharge chute over the chute opening. See Figure 25.
5. Place the top rear edge of the discharge chute over the top rear edge of the chute opening.
6. Push down on the discharge chute so that its front bottom edge rolls around the bottom of the deck, then slide the chute forward to the stop on the deck.
7. Lock the discharge chute in position by hooking the retainer strap over the grass catcher pin on the deck. See Figure 25.
8. Insert the curved end of chute tube into the hole in the grass bag cover. See Figure 26.
9. Place the lower end of the chute tube over the discharge chute so that the tabs on the discharge chute fits into the pockets on the chute tube. See Figure 27.
10. Secure by hooking the two retainer straps of the discharge chute to the pins on the chute tube. See Figure 27.

## Bagger Usage

*All Models - 600 through 800*

**NOTE:** When both grass bags are full, place the tractor on a firm, level surface, disengage the PTO, turn the tractor engine off and set the parking brake.

1. Flip Seat up.
2. Lift up grass bag cover. Do not remove the chute tube assembly from the tractor.
3. Remove the grass bags by lifting these up and moving the bags away from the support tube assembly.
4. Empty the grass clippings at a proper disposal sight, use the handle at the bottom of each grass bag. Holding the bag firmly, empty the contents
5. Replace grass bags, close lid, flip down seat, restart your tractor and resume cutting your grass.

# 5

## Attaching Discharge Chute

All Model Series



### NOTE:

When both grass bags are full, place the tractor on a firm, level surface, disengage the PTO, turn the tractor engine off and set the parking brake.

# 6

## Part List: Rear Twin Bagger



For parts and/or  
accessories  
please call  
1-800-800-7310, or  
1-330-220-4683.  
[www.mtdproducts.com](http://www.mtdproducts.com)

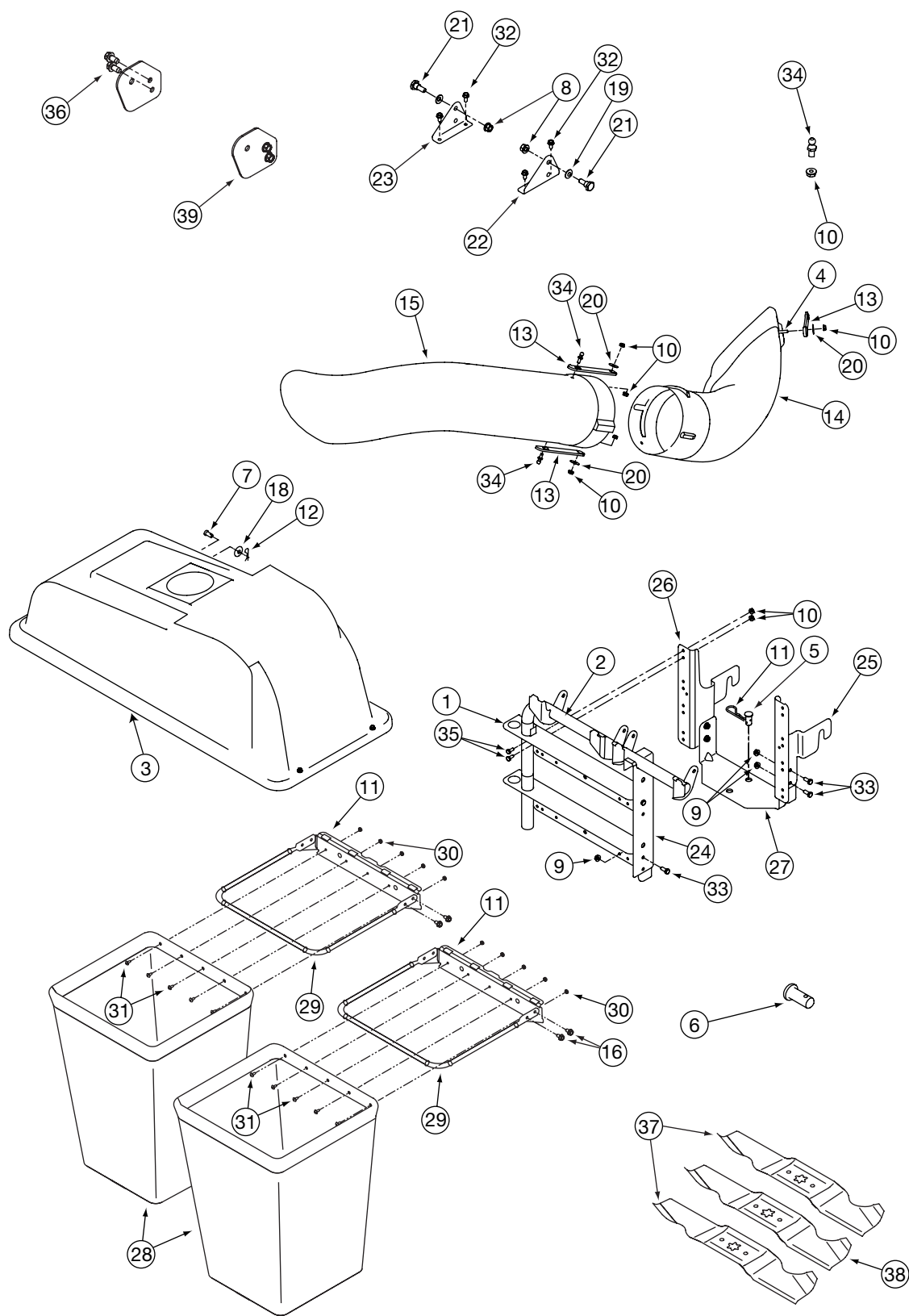

# 6

## Part List: Rear Twin Bagger



*For parts and/or  
accessories  
please call  
1-800-800-7310, or  
1-330-220-4683.  
[www.mtdproducts.com](http://www.mtdproducts.com)*

REF NO.	PART NUMBER	DESCRIPTION	Qty.
1		Support Bracket: Bagger	2
2		Support Tube Assembly	1
3		Grass catcher Cover Assembly	1
4		Screw 1/4-20 x 1	3
5		Clevis Pin	1
6		Clevis Pin (on older model tractors)	1
7		Clevis Pin	2
8		Lock Nut 7/16-20	2
9		Lock Nut 5/16-18	6
10		Hex Flange Lock Nut, 1/4-20	14
11		Hairpin Clip	1
12		Click Pin	2
13		Chute Strap	3
14		Discharge Chute 46	1
15		Catcher Tube	1
16		Self-Tapping Screw 5/16-18	8
17		Bag Hanger Bracket	2
18		Bell Washer	2
19		Bell Washer	2
20		Flat Washer	3
21		Shoulder Screw	2
22		Support Bracket (RH)	1
23		Support Bracket (LH)	1
24		Mounting Bracket	1
25		Catcher Support Bracket (RH)	1
26		Catcher Support Bracket (LH)	1
27		Bracket: Cross Support	1
28		Catcher Bag	2
29		Grass Bag Frame	2
30		Hex Sems Nut, #10-24	10
31		Machine Screw, , #10-24 x .5	10
32		AB Screw 5/16-12	4
33		Hex Screw 5/16-18 x 0.75	6
34		Grass catcher Pin	3
35		Hex Screw 1/4-20 x0.620	8
36		Self-tapping Screw 3/8-16 x 0.75	4
37		Blade 16.28 Lg.	2
38		Blade 14.88 Lg.	1
39		Support Bracket	2
40		Hex Head Screw 1/4-20 x 1	3

---

# 7

## NOTES:

*Use this page to make  
notes and write down  
important information.*



*For parts and/or  
accessories  
please call  
1-800-800-7310, or  
1-330-220-4683.  
[www.mtdproducts.com](http://www.mtdproducts.com)*



---

7

**NOTES:**

*Use this page to make  
notes and write down  
important information.*



*For parts and/or  
accessories  
please call  
1-800-800-7310, or  
1-330-220-4683.  
[www.mtdproducts.com](http://www.mtdproducts.com)*

# MANUFACTURER'S LIMITED WARRANTY FOR



The limited warranty set forth below is given by MTD LLC with respect to new merchandise purchased and used in the United States, its possessions and territories.

"MTD" warrants this product against defects in material and workmanship for a period of two (2) years commencing on the date of original purchase and will, at its option, repair or replace, free of charge, any part found to be defective in materials or workmanship. This limited warranty shall only apply if this product has been operated and maintained in accordance with the Operator's Manual furnished with the product, and has not been subject to misuse, abuse, commercial use, neglect, accident, improper maintenance, alteration, vandalism, theft, fire, water, or damage because of other peril or natural disaster. Damage resulting from the installation or use of any part, accessory or attachment not approved by MTD for use with the product(s) covered by this manual will void your warranty as to any resulting damage.

Normal wear parts are warranted to be free from defects in material and workmanship for a period of thirty (30) days from the date of purchase. Normal wear parts include, but are not limited to items such as: batteries, belts, blades, blade adapters, grass bags, rider deck wheels, seats, snow thrower skid shoes, shave plates, auger spiral rubber and tires.

**HOW TO OBTAIN SERVICE:** Warranty service is available, WITH PROOF OF PURCHASE, through your local authorized service dealer. To locate the dealer in your area, check your Yellow Pages, or contact MTD LLC at P.O. Box 361131, Cleveland, Ohio 44136-0019, or call 1-800-800-7310 or 1-330-220-4683 or log on to our Web site at [www.mtdproducts.com](http://www.mtdproducts.com).

This limited warranty does **not** provide coverage in the following cases:

- a. The engine or component parts thereof. These items may carry a separate manufacturer's warranty. Refer to applicable manufacturer's warranty for terms and conditions.
- b. Log splitter pumps, valves, and cylinders have a separate one year warranty.
- c. Routine maintenance items such as lubricants, filters, blade sharpening, tune-ups, brake adjustments, clutch adjustments, deck adjustments, and normal deterioration of the exterior finish due to use or exposure.
- d. Service completed by someone other than an authorized service dealer.

e. MTD does not extend any warranty for products sold or exported outside of the United States, its possessions and territories, except those sold through MTD's authorized channels of export distribution.

f. Replacement parts that are not genuine MTD parts.

g. Transportation charges and service calls.

**No implied warranty, including any implied warranty of merchantability of fitness for a particular purpose, applies after the applicable period of express written warranty above as to the parts as identified. No other express warranty, whether written or oral, except as mentioned above, given by any person or entity, including a dealer or retailer, with respect to any product, shall bind MTD. During the period of the warranty, the exclusive remedy is repair or replacement of the product as set forth above.**

**The provisions as set forth in this warranty provide the sole and exclusive remedy arising from the sale. MTD shall not be liable for incidental or consequential loss or damage including, without limitation, expenses incurred for substitute or replacement lawn care services or for rental expenses to temporarily replace a warranted product.**

Some states do not allow the exclusion or limitation of incidental or consequential damages, or limitations on how long an implied warranty lasts, so the above exclusions or limitations may not apply to you.

In no event shall recovery of any kind be greater than the amount of the purchase price of the product sold. **Alteration of safety features of the product shall void this warranty.** You assume the risk and liability for loss, damage, or injury to you and your property and/or to others and their property arising out of the misuse or inability to use the product.

This limited warranty shall not extend to anyone other than the original purchaser or to the person for whom it was purchased as a gift.

**HOW STATE LAW RELATES TO THIS WARRANTY:** This limited warranty gives you specific legal rights, and you may also have other rights which vary from state to state.

**IMPORTANT:** Owner must present Original Proof of Purchase to obtain warranty coverage.