



# Z334 or Z340 Z Master® Mowers

Model No. For all Z334 or Z340 International Z Master Mowers

## Setup Instructions

### Loose Parts

Use the chart below to verify that all parts have been shipped.

Step	Description	Qty.	Use
<b>1</b>	No parts required	–	Remove the machine from the crate.
<b>2</b>	Bolt (3/8 x 1 inch) Nut (3/8 inch)	1 1	Install the seat lanyard.
<b>3</b>	Right control lever Left control lever Bolt (3/8 x 1 inch) (2 are assembled) Curved washer (3/8 inch) (2 are assembled)	1 1 4 4	Install the motion control levers.
<b>4</b>	No parts required	–	Adding fuel to the machine.
<b>5</b>	No parts required	–	Charge the battery.
<b>6</b>	Number 2 general purpose lithium base or molybdenum base grease. (Purchase separately.)	1 tube	Check the machine for grease.
<b>7</b>	No parts required	–	Check the engine oil level.
<b>8</b>	No parts required	–	Prepare the side discharge chute.
<b>9</b>	No parts required	–	Check the hydraulic oil.
<b>10</b>	No parts required	–	Check the machine before delivery to the customer.
<b>11</b>	Operator's Manual Parts Catalog Engine Owner's Manual Registration Card Safety Video Key	1 1 1 1 1 2	Delivering the machine to the customer.

## Step

# 1

## Removing the Machine from the Crate

### No Parts Required

#### Procedure

1. Remove the straps holding the machine to the crate.
2. Check the air pressure in the rear tires.  
Pressure: 13 psi (90 kPa)

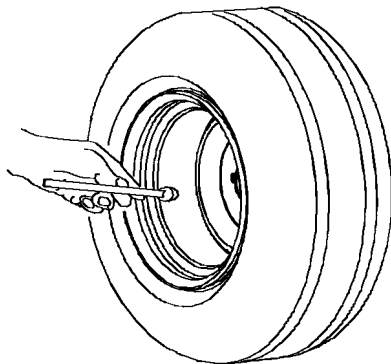

G001055

**Figure 1**

**Note:** There is no valve stem located in the front tires, it is a semi-pneumatic tire and does not need to be checked.

## Step

# 2

## Installing the Seat Lanyard

### Parts needed for this step:

1	Bolt (3/8 x 1 inch)
1	Nut (3/8 inch)

#### Procedure

1. Remove the nut, washer, and bolt from the lanyard.

2. Tilt the seat forward and align the lanyard to the hole in the seat base.
3. Install the lanyard to the seat base with a bolt (3/8 x 1 inch) and nut (3/8 inch).
4. Tilt the seat down.

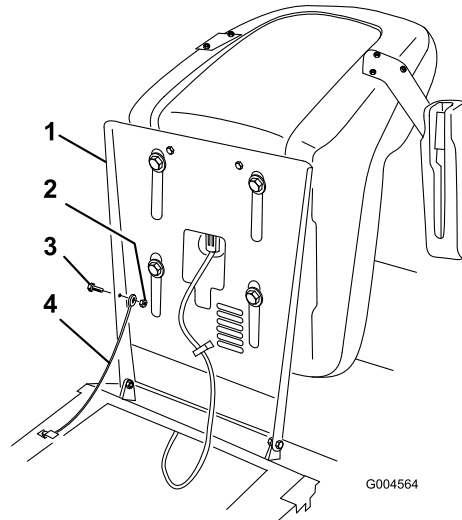

G004564

**Figure 2**

- |                        |                   |
|------------------------|-------------------|
| 1. Seat base           | 3. Nut (3/8 inch) |
| 2. Bolt (3/8 x 1 inch) | 4. Lanyard        |

5. Check the pump drive belt idler arm for grease before installing the seat retainer. Refer to Step 6, Checking the Machine for Grease, on page 4.
6. Install seat retainer bracket to hold down the seat.

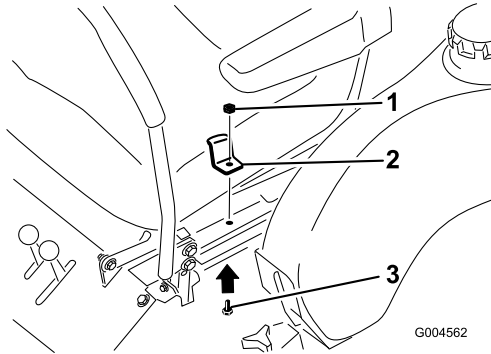

**Figure 3**

1. Nut
2. Seat retainer bracket
3. Bolt

## Step 3

## Installing the Motion Control Levers

### Parts needed for this step:

1	Right control lever
1	Left control lever
4	Bolt (3/8 x 1 inch) (2 are assembled)
4	Curved washer (3/8 inch) (2 are assembled)

### Procedure

**Note:** There are two control lever height options available. Install the control lever in the top two holes for the high position and the bottom two holes for the low position.

1. Remove the bottom bolt (3/8 x 1 inch) and curved washer (3/8 inch) from the motion control lever. Loosen the upper bolt (3/8 x 1 inch) and curved washer (3/8 inch) that are installed in the posts.
2. Position the lever so the bottom hole aligns with the hole in the control arm shaft. Loosely install the control levers to the outside of the posts.
3. Raise the levers to the neutral position and align them by sliding them forward or backward and tighten the bolts.
4. If the ends of the levers hit against each when rotated into the drive position, move them to

the neutral position and carefully bend them outward.

5. Move them back to the drive position and check for clearance.
6. Repeat if necessary.

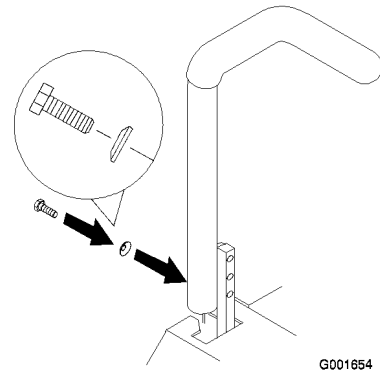

**Figure 4**

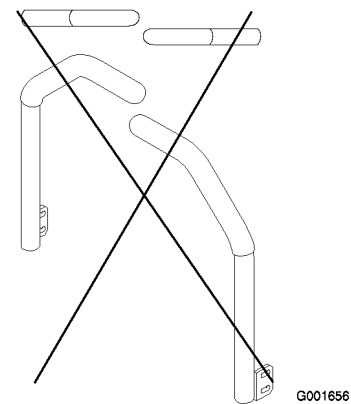
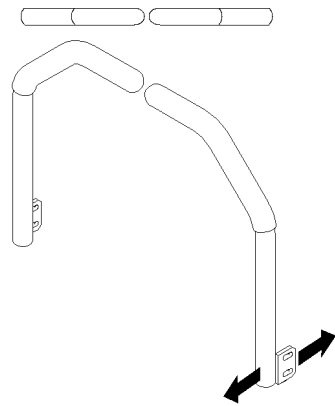

**Figure 5**

## Step

# 4

## Adding Fuel to the Machine

### No Parts Required

### Procedure

**Note:** Make sure both fuel tanks are half full when first starting the machine. This will prevent air getting into the fuel system and causing starting problems.

Add fuel to the machine before starting it. Refer to your *Operator's Manual* for the correct fuel and procedure.

## Step

# 5

## Charging the Battery

### No Parts Required

### Procedure



Charging the battery produces gasses that can explode and cause serious injury.

- Keep cigarettes, sparks and flames away from the battery.
- Make sure the ignition switch is off.
- Ventilate when charging or using the battery in an enclosed space.

**Important:** Do not run the machine with the battery disconnected; electrical damage may occur to the engine.

Charge the battery. Refer to the *Operator's Manual* for instructions.

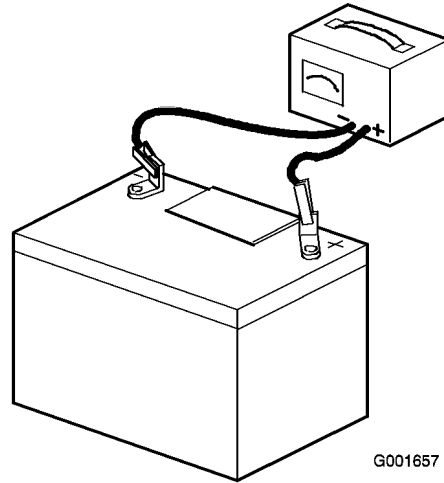

Figure 6

## Step

# 6

## Checking the Machine for Grease

### Parts needed for this step:

1 tube

Number 2 general purpose lithium base or molybdenum base grease. (Purchase separately.)

### Procedure

1. Tilt the seat forward.
2. Check the deck lift pivots for grease.
3. Check the pump drive belt idler arm for grease.

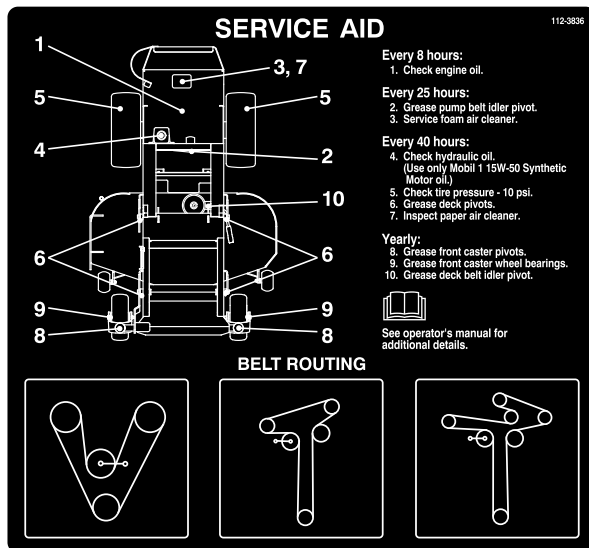

**Figure 7**

G004549



## Checking the Engine Oil Level

### No Parts Required

#### Procedure

Before you start the engine and use the machine, check the oil level in the engine crankcase; refer to Checking Oil Level in *Operator's Manual*.

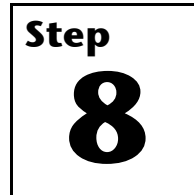

## Preparing the Side Discharge Chute

### No Parts Required

#### Procedure

1. Remove the plastic tie holding the side discharge chute up and lower the chute into place.
2. Check the spring at the discharge chute to ensure proper operation.

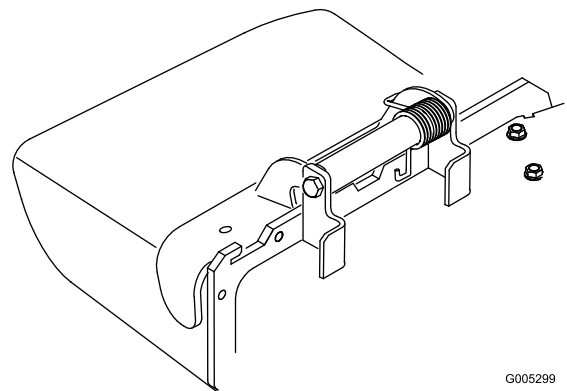

**Figure 8**

G005299



## Checking the Hydraulic Oil

### No Parts Required

#### Procedure

1. Start the engine and drive the machine forward and backward for a few minutes to allow any extra air to purge out of the hydraulic system.
2. Position the machine on a level surface.
3. Disengage the PTO, move the motion control levers to the neutral locked position, and set the parking brake.

4. Stop the engine, remove the key, and wait for all moving parts to stop before leaving the operating position.
5. Check the expansion tank behind the seat and if necessary add hydraulic oil to the cold line on the side of the tank.
6. Replace the tank cap, but do not overtighten.

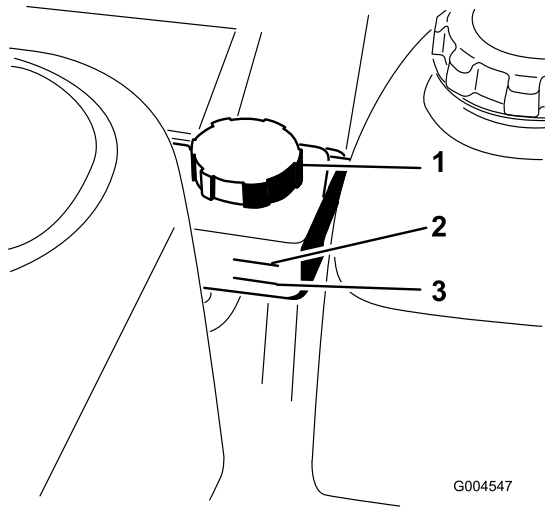

**Figure 9**

- |                         |                          |
|-------------------------|--------------------------|
| 1. Cap                  | 3. Cold fluid level-full |
| 2. Hot fluid level-full |                          |
-

**Step**  
**10**

## Checking the Machine Before Delivery to the Customer

### No Parts Required

### Procedure

Before delivering the machine to the customer, ensure that you perform or have performed the procedures listed in the following table and initial each when finished. Refer to the Operator's Manual for instructions on performing these procedures.

Initial	Check Procedure
	Check the tire pressure.
	Check the level of the mower.
	Check the engine oil level.
	Check the hydraulic fluid level.
	Check the operation of the parking brake.
	Ensure that the machine tracks correctly; refer to the <i>Operator's Manual</i> for the adjustment procedure.
	Check the safety interlock system; refer to the <i>Operator's Manual</i> .
	Ensure that the PTO works.
	Check all fasteners you installed to ensure that they are tight.

When you finish setting up the machine, sign and date in the space provided below:

**Signature:** \_\_\_\_\_ **Date:** \_\_\_\_\_

**Step**

**11**

## **Delivering the Machine to the Customer**

### **Parts needed for this step:**

1	<i>Operator's Manual</i>
1	<i>Parts Catalog</i>
1	<i>Engine Owner's Manual</i>
1	Registration Card
1	Safety Video
2	Key

### **Procedure**

At delivery, complete the items listed in the following table and initial each when finished.

**Model No.** \_\_\_\_\_ **Serial No.** \_\_\_\_\_



Dealer Initial	Customer Initial	Check Procedure
		<p>Show the customer where the following features are located and how they function:</p> <p>Fuel tank caps</p> <p>Oil fill cap/ Oil dipstick</p> <p>Engine oil filter</p> <p>Engine oil drain</p> <p>Fuel filters</p> <p>Air filter</p> <p>Hydraulic fluid reservoir</p> <p>Hydraulic filters</p> <p>Battery</p> <p>Ignition switch</p> <p>Throttle lever</p> <p>Choke lever</p> <p>Power take off switch (PTO)</p> <p>Motion control levers</p> <p>Parking brake</p> <p>Mower height-of-cut</p> <p>Adjustable seat</p> <p>Hydraulic bypass valves</p>
		Refer to the <i>Operator's Manual</i> to point out safety procedures, operation, and maintenance procedures.
		Review the warranty statement as shown in the <i>Operator's Manual</i> .
		Describe the post sale service procedures for your store.
		Assist the customer in filling out and mailing the registration card or register online at <a href="http://www.Toro.com">www.Toro.com</a>
		Make sure that the customer receives the <i>Operator's Manual</i> , <i>Parts Catalog</i> , <i>and Engine Owner's Manual</i> , <i>Set Up Instructions</i> , and safety video.
		Assist the customer in loading the mower.

**Note:** When you, the dealer representative, have finished delivering the machine to the customer, sign and date in the space provide below and keep a copy of this page for dealer records.

**Signature:** \_\_\_\_\_ **Date:** \_\_\_\_\_

**Signature:** \_\_\_\_\_ **Date:** \_\_\_\_\_







**Count on it.**