



# Titan Z4800/5200 Zero-Turn-Radius Riding Mower

Model No. 74812/74814—Serial No. 270000001 and Up

## Addendum

**Note:** Determine the left and right sides of the machine from the normal operating position.

The following procedures for installing and/or replacing the discharge deflector supersede the instructions found in the standard documentation accompanying this machine. Retain these instructions with all other documentation for your machine.

## Installing the Discharge Deflector

### Parts needed for this step:

1	Deflector assembly
1	Rod
1	Spring

### Procedure

1. Position the discharge deflector assembly with the bracket ends between the welded brackets on the deck as shown in Figure 1.
2. Install the spring onto the straight end of the rod. Position the spring on the rod as shown in Figure 1 so the shorter spring end is coming from under the rod before the bend and going over the rod as it returns from the bend.
3. Install the spring and rod assembly through the openings in both the deck brackets and the deflector bracket (Figure 1).

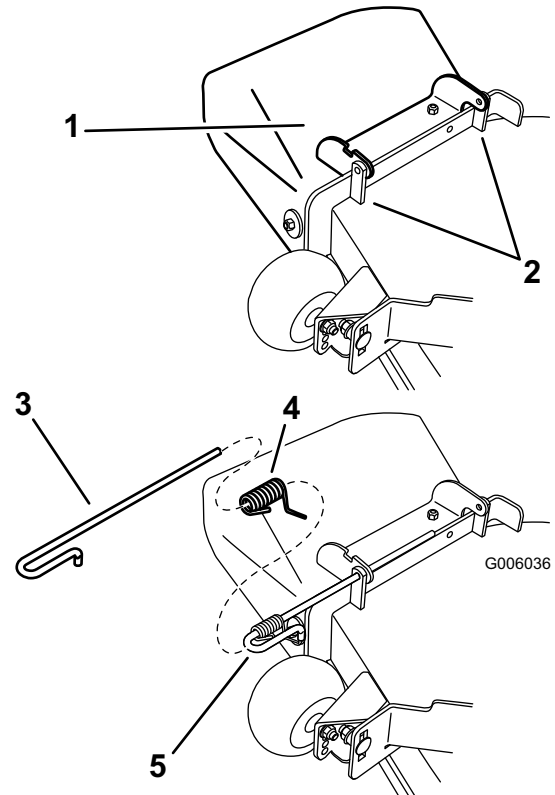
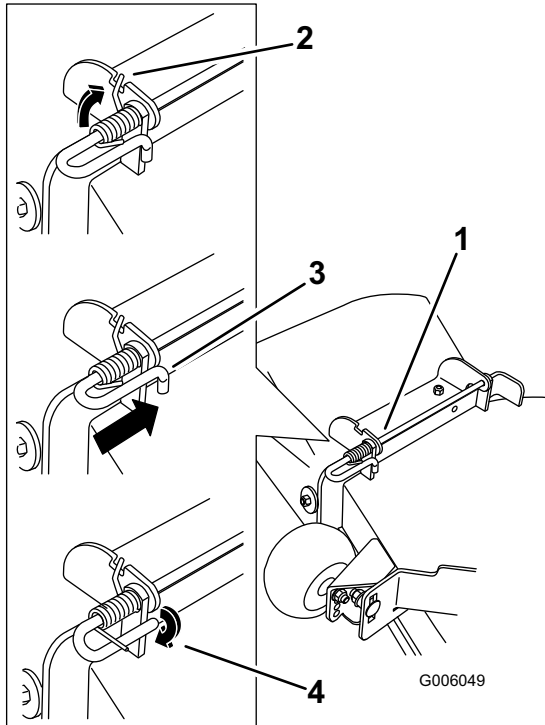

**Figure 1**

- |                       |                                  |
|-----------------------|----------------------------------|
| 1. Deflector assembly | 4. Spring                        |
| 2. Deck brackets      | 5. Spring installed over the rod |
| 3. Rod                |                                  |

**This procedure is continued on the other side of this page.**

4. Lift the long end of the spring and place it into the notch on the deflector assembly bracket (Figure 2).
5. Secure the rod and spring assembly by twisting it so the short end of the rod can be placed behind the front bracket welded to the deck (Figure 2).



**Figure 2**

- |   |   |
|---|---|
| 1. Rod and spring assembly partially installed                              | 3. Rod, short end, moved behind mower bracket |
| 2. Long end of the spring installed into the notch in the deflector bracket | 4. Short end, retained by mower bracket.      |

**Important:** The discharge deflector must be spring loaded in the down position. Lift the deflector up to test that it snaps to the full down position.

## Replacing the Discharge Deflector



An uncovered discharge opening could allow the lawn mower to throw objects in the operator's or bystander's direction and result in serious injury. Also, contact with the blade could occur.

Never operate the lawn mower unless you install a mulch plate, discharge deflector, or grass collection system.

1. Disengage the spring from the notch in the deflector bracket and slide the rod out of the welded deck brackets, spring, and discharge deflector (Figure 1). Remove the damaged or worn discharge deflector.
2. Position the new discharge deflector assembly with the bracket ends between the welded brackets on the deck as shown in Figure 1.
3. Install the spring onto the straight end of the rod. Position the spring on the rod as shown in Figure 1 so the shorter spring end is coming from under the rod before the bend and going over the rod as it returns from the bend.
4. Lift the long end of the spring and place it into the notch on the deflector assembly bracket (Figure 2).
5. Secure the rod and spring assembly by twisting it so the short end of the rod can be placed behind the front bracket welded to the deck (Figure 2).

**Important:** The discharge deflector must be spring loaded in the down position. Lift the deflector up to test that it snaps to the full down position.