



Super and Ultra Blower/Vacuum

Model No. 51593—Serial No. 270000001 and Up

Model No. 51594—Serial No. 270000001 and Up

Addendum

When assembling the vacuum tube, ensure that you lock the two halves together by inserting the supplied fastener through the holes in the vacuum tube, as shown in the following illustration.

Note: You may need to push the connector firmly to ensure that it seats all the way into the vacuum tube.

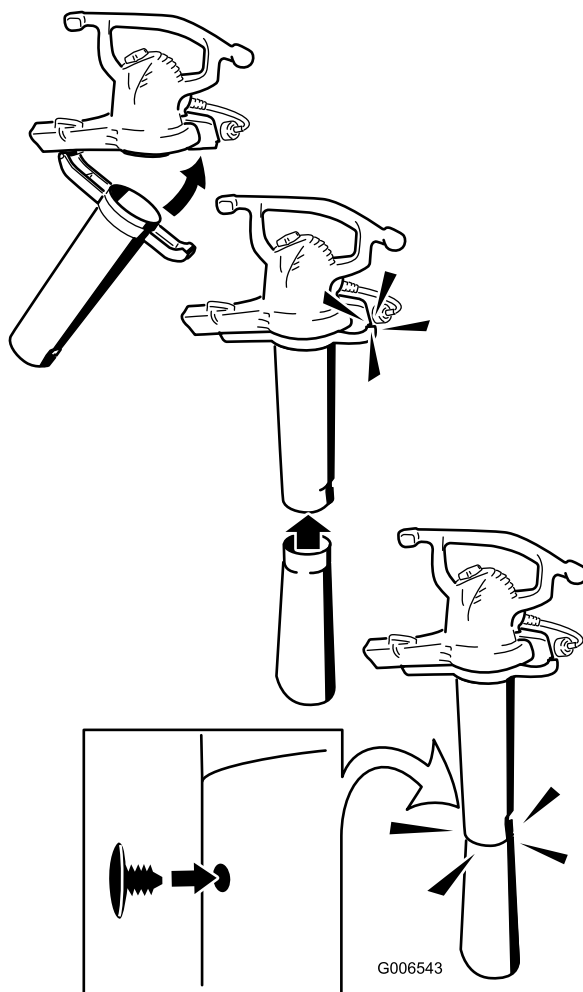



Super a ultra odfukovač a vysavač listí

Model No. 51593—Serial No. 270000001 and Up

Model No. 51594—Serial No. 270000001 and Up

Addendum

Při montáži vakuové trubice spojte obě poloviny tak, že otvory ve vakuové trubici prostrčíte dodanou svorku, jak je znázorněno na obrázku.

Note: Možná budete muset na svorku pevně zatlačit, aby celá zapadla do vakuové trubice.

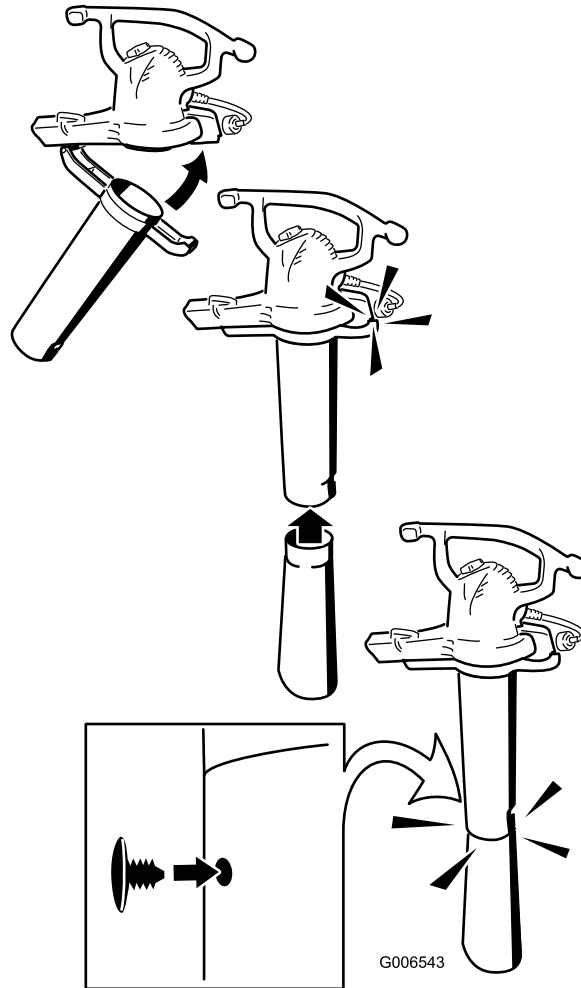



Super and Ultra Blase-/Sauggerät

Model No. 51593—Serial No. 270000001 and Up

Model No. 51594—Serial No. 270000001 and Up

Addendum

Stellen Sie beim Zusammenbau des Saugrohrs sicher, dass die zwei Hälften miteinander arretiert sind. Stecken Sie hierfür die mitgelieferte Befestigung durch die Löcher im Saugrohr, siehe nachfolgendes Bild.

Note: Sie müssen die Befestigung ggf. fest drücken, um sicherzustellen, dass sie ganz im Saugrohr ist.

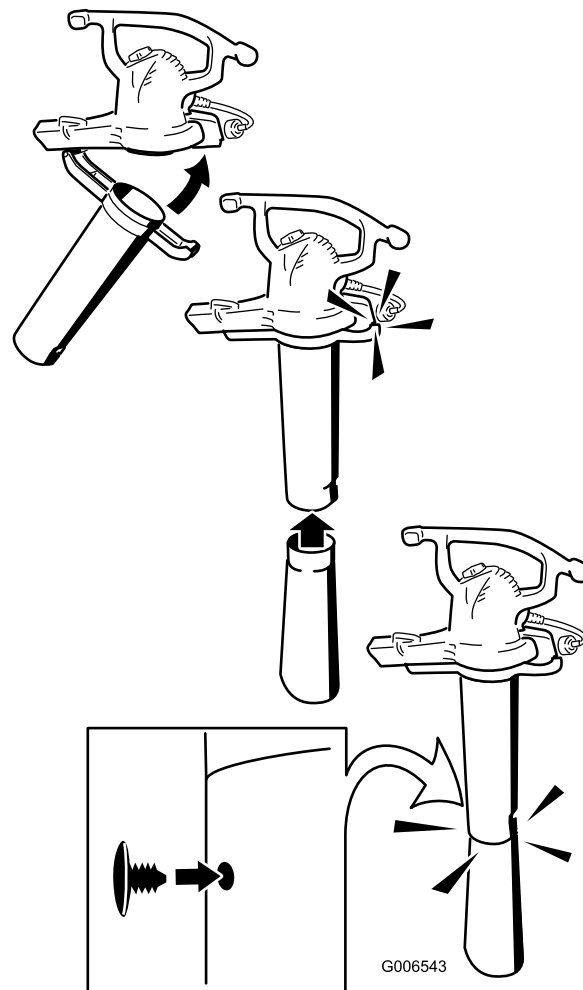



Soplador/Aspirador Super y Ultra

Model No. 51593—Serial No. 270000001 and Up

Model No. 51594—Serial No. 270000001 and Up

Addendum

Al ensamblar el tubo de aspiración, asegúrese de afianzar el ensamble introduciendo la fijación suministrada a través de los orificios del tubo de aspiración, según se muestra en la ilustración siguiente.

Note: Es posible que tenga que empujar firmemente el conector para que encaje bien en el tubo de aspiración.

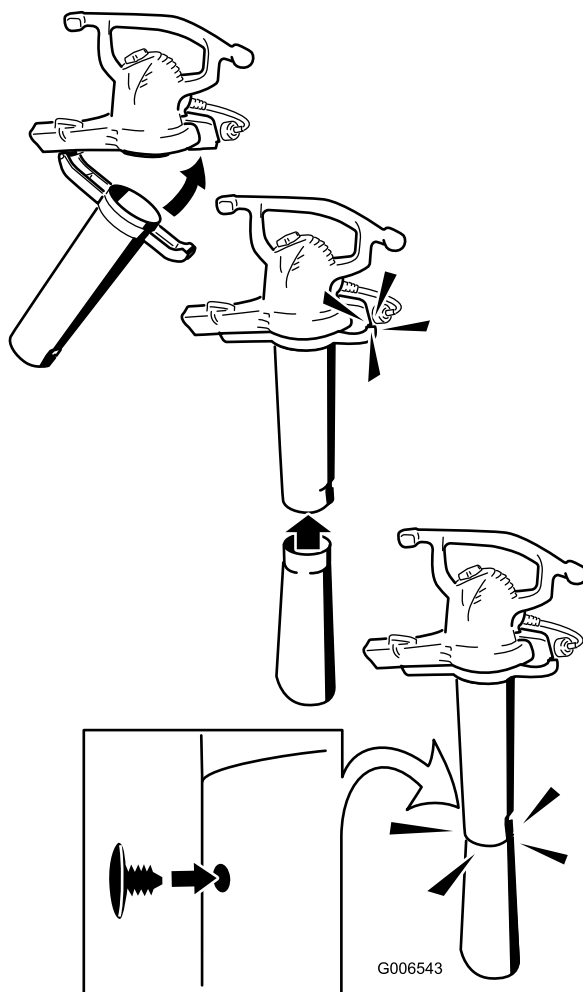



Super- ja Ultra-puhallin/imuri

Model No. 51593—Serial No. 270000001 and Up

Model No. 51594—Serial No. 270000001 and Up

Addendum

Kun asennat imuriputkea, varmista, että lukitset putken puoliskot yhteen asentamalla mukana toimitetun kiinnikkeen putken puoliskoissa olevien aukkojen läpi seuraavan kuvan mukaisesti.

Note: Paina kiinnikettä lujasti, jotta se kiinnittyy imuriputkeen kokonaan kantaa myöten.

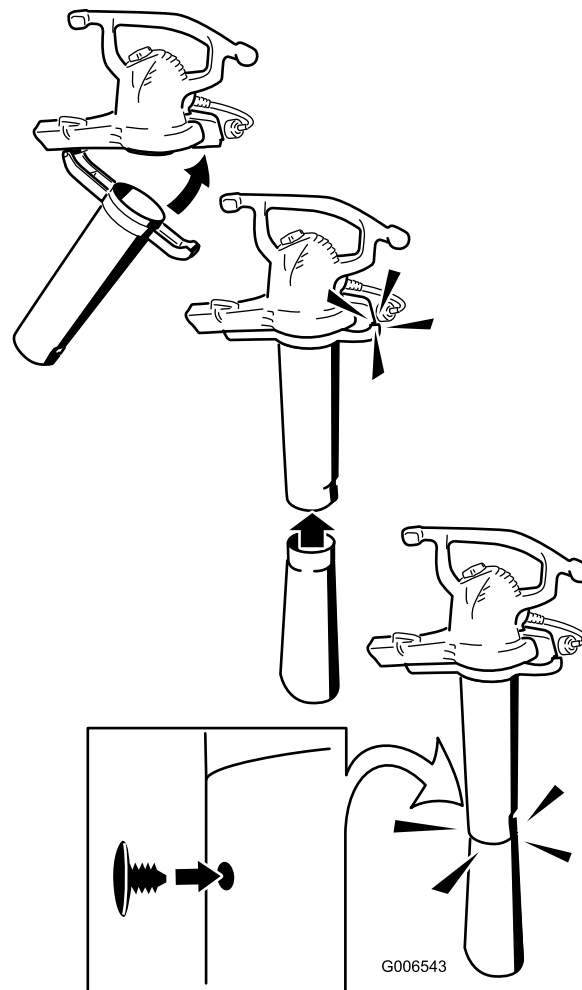



Souffleur/aspirateur Super et Ultra

Model No. 51593—Serial No. 270000001 and Up

Model No. 51594—Serial No. 270000001 and Up

Addendum

Lors du montage du tube d'aspiration, veillez à verrouiller les deux moitiés ensemble en insérant la fixation fournie dans les trous du tube, comme illustré ci-dessous.

Note: Il faut parfois pousser fermement sur l'accouplement pour bien l'enfoncer dans le tube d'aspiration.

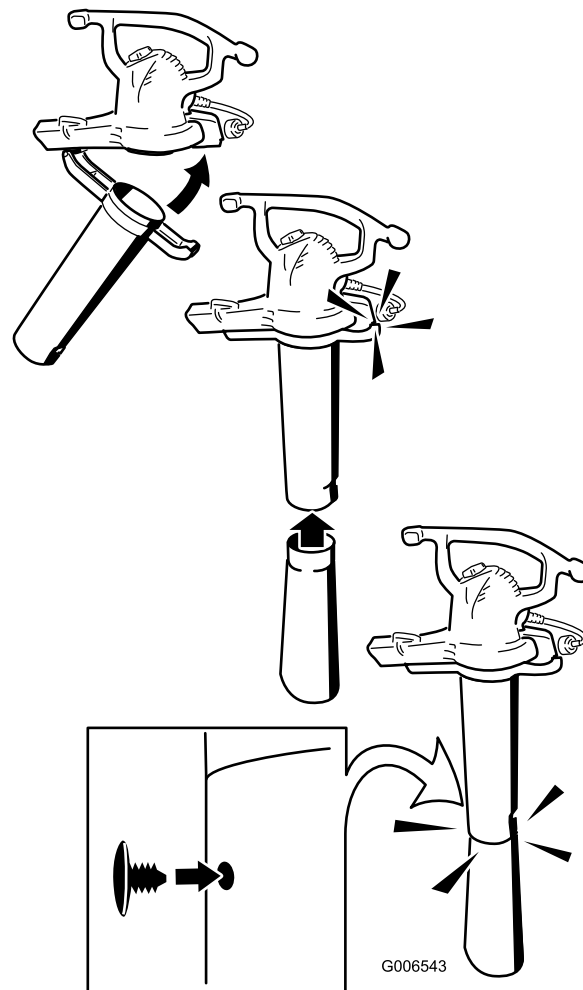



Aspiratore/Soffiatore Super e Ultra

Model No. 51593—Serial No. 270000001 and Up

Model No. 51594—Serial No. 270000001 and Up

Addendum

Durante il montaggio del tubo di aspirazione verificate che le due metà siano bloccate tra di loro, inserendo nei fori del tubo di aspirazione il dispositivo di fissaggio a corredo, come nella seguente illustrazione.

Note: All'occorrenza, premete con forza il connettore in modo da inserirlo a fondo nel tubo di aspirazione.

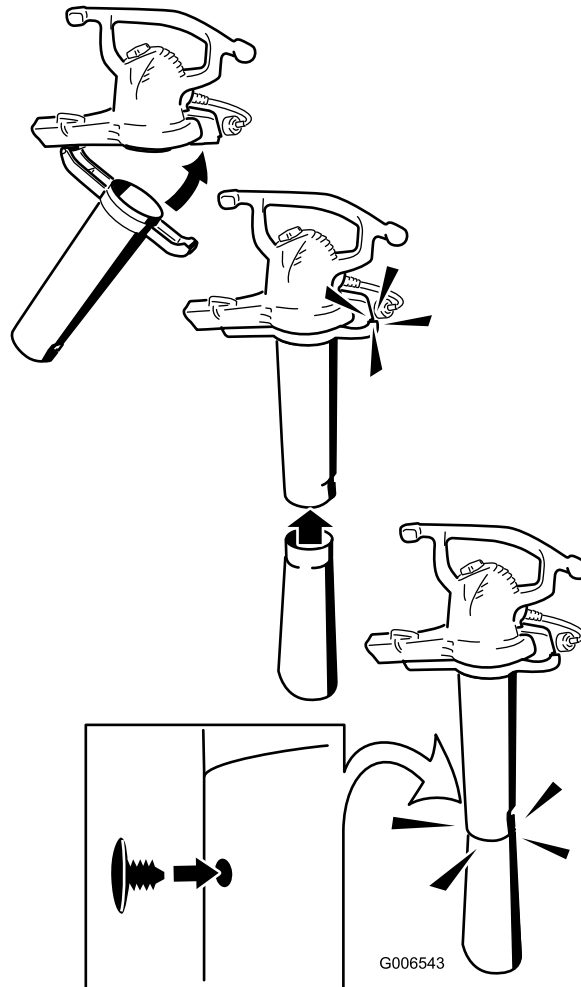



Count on it.