



Trim/Discharge Side Anti-Scalp Roller Kit

48in TURBO FORCE® Floating Mower for Walk-Behind Mower

Model No. 115-1015

Model No. 115-1016

Installation Instructions

Installation

Loose Parts

Use the chart below to verify that all parts have been shipped.

Procedure	Description	Qty.	Use
1	Roller bracket	1	Install the roller bracket.
	Carriage bolt (3/8 x 3/4 inch)	3	
	Flange nut (3/8 inch)	3	
2	Anti-scalp roller	1	Install the anti-scalp roller.
	Bolt (3/8 x 4-1/2 inches)	1	
	Long spacer	1	
	Short spacer	1	
	Flange nut (3/8 inch)	1	

1

Important: Ensure that you install the carriage bolts with the bolt heads on the inside of the mower deck and the nuts on the outside.

Installing the Roller Bracket

Parts needed for this procedure:

1	Roller bracket
3	Carriage bolt (3/8 x 3/4 inch)
3	Flange nut (3/8 inch)

Procedure

- Prepare the installation site as follows:
 - If you are replacing an existing anti-scalp roller, remove the roller, roller bracket, and all fasteners from the mower and discard them.
 - If you are installing the anti-scalp roller for the first time, locate the three holes on the rear trim or discharge side of the mower (depending on which kit you are installing) and remove the three bolts and nuts that are installed in the holes.
- Install the roller bracket to the mower using 3 carriage bolts (3/8 x 3/4 inch) and flange nuts (3/8 inch) (Figure 1).

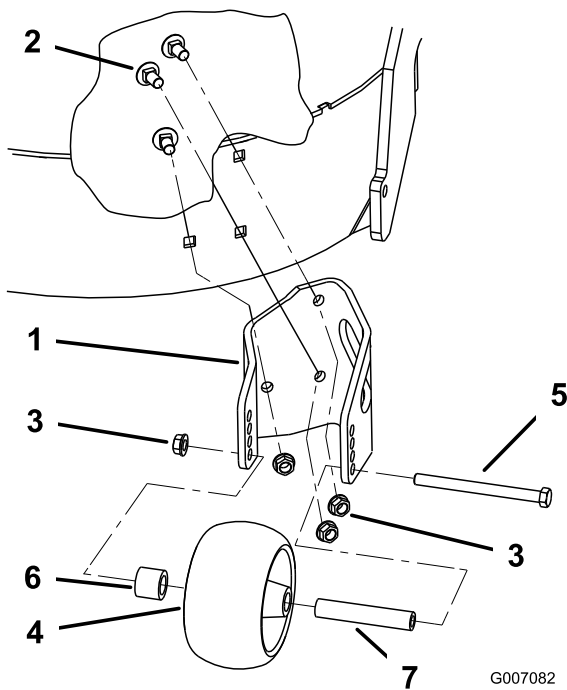

Figure 1

- | | |
|-----------------------------------|------------------------------|
| 1. Roller bracket | 5. Bolt (3/8 x 4-1/2 inches) |
| 2. Carriage bolt (3/8 x 3/4 inch) | 6. Short spacer |
| 3. Flange nut (3/8 inch) | 7. Long spacer |
| 4. Anti-scalp roller | |

2

Installing the Anti-Scalp Roller

Parts needed for this procedure:

1	Anti-scalp roller
1	Bolt (3/8 x 4-1/2 inches)
1	Long spacer
1	Short spacer
1	Flange nut (3/8 inch)

Procedure

1. Slide the long spacer into the anti-scalp roller (Figure 1).
2. Place the short spacer inside the roller hub on the side of the roller with the short hub (Figure 1).
3. Place the roller into the roller bracket and push the bolt (3/8 x 4-1/2 inches) through the bracket, short spacer, and the long spacer/roller assembly at the desired height (Figure 1).

Note: Insert the bolt so that its head is toward the outside of the mower.

4. Secure the roller with a flange nut (3/8 inch) (Figure 1).