

INSTRUCTION SHEET

LIGHT KIT

Parts List:

Item	Part No.	Description	Qty.
1	109-6485-03	Wld, LH Light Mount.....	1
2	109-6489-03	Wld, RH Light Mount.....	1
3	109-6488-03	Tube, Light Mount.....	2
4	103-6300	Light, 35Watt Halogen.....	2
5	321-9	Screw, HH 1/4-20 x 1 1/2	2
6	104-7201	Nut, Nyloc 1/4-20 Flg	2
7	104-8301	Nut, Nyloc 3/8-16 Flg	4
8	3234-12	Screw, HH FLG 3/8-16 x 3/4	4
9	92-8875	Switch, Rocker	1
10	109-6500	Harness, Light Kit.....	1
11*	1-303335	Tie, Cable 7 15/16 (Large)	6
12	109-6708	Guard.....	2
13	3256-78	Washer	2

* Items not shown

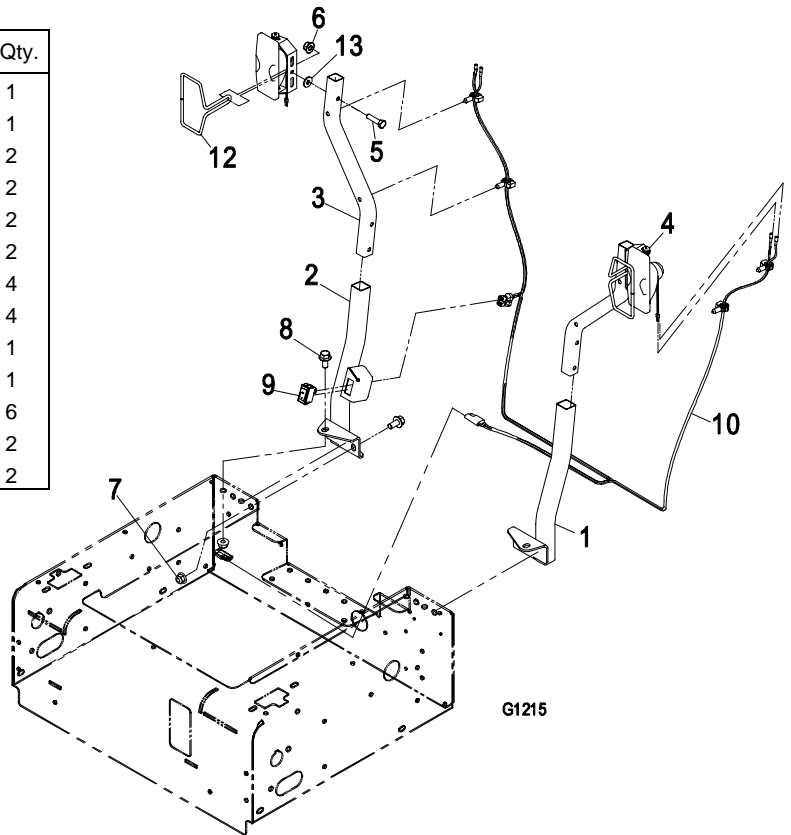



FIGURE 1

Installation Instructions:

(Refer to Figure 1 for all item callouts and hardware)

This **SAFETY ALERT SYMBOL**  is used both in this manual and on the machine to identify important safety messages which must be followed to avoid accidents. This symbol means:

**ATTENTION! BECOME ALERT!
YOUR SAFETY IS INVOLVED!**

 WARNING 	
POTENTIAL HAZARD <ul style="list-style-type: none">◆ While maintenance or adjustments are being made, someone could start the engine.	
WHAT CAN HAPPEN <ul style="list-style-type: none">◆ Accidental starting of the engine could seriously injure you or other bystanders.	
HOW TO AVOID THE HAZARD <ul style="list-style-type: none">◆ Remove the key from the ignition switch and/or pull the wire(s) off the spark plug(s) before you do any maintenance. Also push the wire(s) aside so it does not accidentally contact the spark plug(s).	

1. Tip seat forward.
2. Remove hydro fan cover and hydraulic reservoir cap as shown in Figure 2.

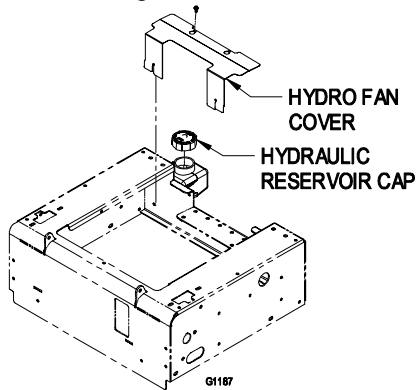

FIGURE 2

Mounting Brackets and Lights

1. Position the RH mount bracket (item 2) on the seat box frame and secure with (2) 3/8-16 x 3/4 screws (item 8) and (2) 3/8-16 nyloc nuts (item 7) as shown in Figure 1.
2. Insert light mount tube (item 3) into the RH mount bracket (item 2). If the mount tube does not slide into the mount bracket, file the inside of the mount bracket and reinsert tube.
3. Position and mount the guard (item 12) and light (item 4) to the light mount tube (item 3) using (1) 1/4-20 x 1 1/4 screw (item 5), (1) washer (item 13), and (1) 1/4-20 nyloc nut (item 6). Rotate the light adjustment bracket left or right to ensure leads on light are facing straight down.
4. Repeat steps 1 through 3 for LH side using items 1, 3, 4, 5, 6, 7, 8, 12, and 13.
5. Replace hydraulic reservoir cap.

Installing Switch

1. Orient the switch (Item 9) so the "on" position points up as shown in Figure 2. Carefully snap the switch into the bracket cutout.
2. Locate the switch, connect the brown wire to the top terminal of the switch and connect white wire to the bottom terminal on the switch.

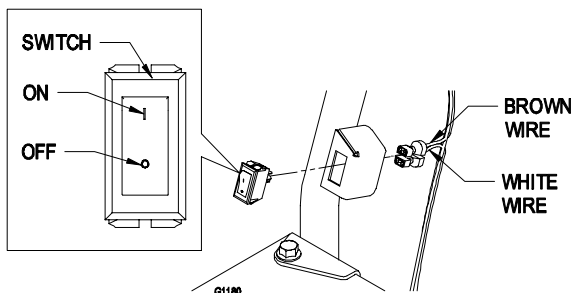

FIGURE 3

Routing Wire Harness

Note: Be sure unit is not running, key is removed from ignition switch, and parking brake is engaged prior to proceeding with the harness installation.

1. On both sides of the machine, route the harness up the light mount brackets and insert harness clips into mount holes on brackets as shown in Figure 1. Be sure the connectors are fully inserted on to the terminals.

Connecting Headlights

1. Connect the black wire on the harness to the black wire on the headlight. Then connect the white wire on the harness to the white wire on the headlight.

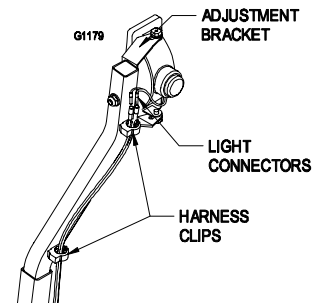

FIGURE 3

Connecting to Tractor Harness

1. Remove the plug from the molded accessory connector located on the right side of the main tractor harness inside the seat box frame as shown in Figure 4.
2. Route bottom light kit harness connector through the seat frame hole and connect to the molded accessory connector on main tractor harness. Zip tie the light kit harness to the tractor harness where shown in Figure 4.

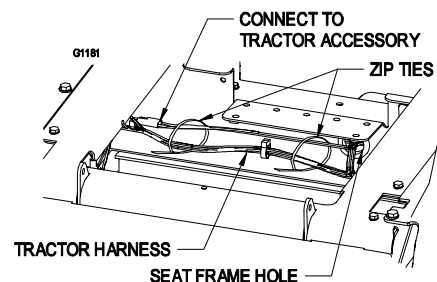

FIGURE 4

3. Reinstall hydro fan cover, tip seat back and put wires back on spark plugs.

Operation

1. Use switch to turn lights on and off.
2. Light switch is operable only if ignition key is turned on.