

48/52 in Mulching Kit for Zero-Turn-Radius Riding Mower

Model No. 79154, 79156

Installation Instructions

Important: Disengage the blade, shut off the engine, wait for all moving parts to stop, engage the parking brake, remove the key, and disconnect the negative battery cable before servicing, cleaning, or making any adjustments to the unit.

Part List:

Item	Description	Qty
1	Wld, Baffle Mulch LH 52 inch.....	1
	Wld, Baffle Mulch LH 48 inch.....	1
2	Bolt, Carriage 5/16-18 x 3/4 inch	6
3	Nut, Nyloc 5/16-18 inch Flg.....	7
4	Blade, Mulch 18.0 52 inch.....	3
	Blade Mulch 16.25 48 inch.....	3

Item	Description	Qty
5	Wld, Baffle Center 52 inch.....	1
	Wld, Baffle Center 48 inch.....	1
6*	Decal, Hole Cover	3
7	Wld, Baffle Mulch RH 52 inch.....	1
	Wld, Baffle Mulch RH 48 inch.....	1
8	Bolt, Carriage 5/16-18 x 2 1/4 inch.....	1
9	Ring, Bolt Retaining.....	5

*Not shown in Figure 1

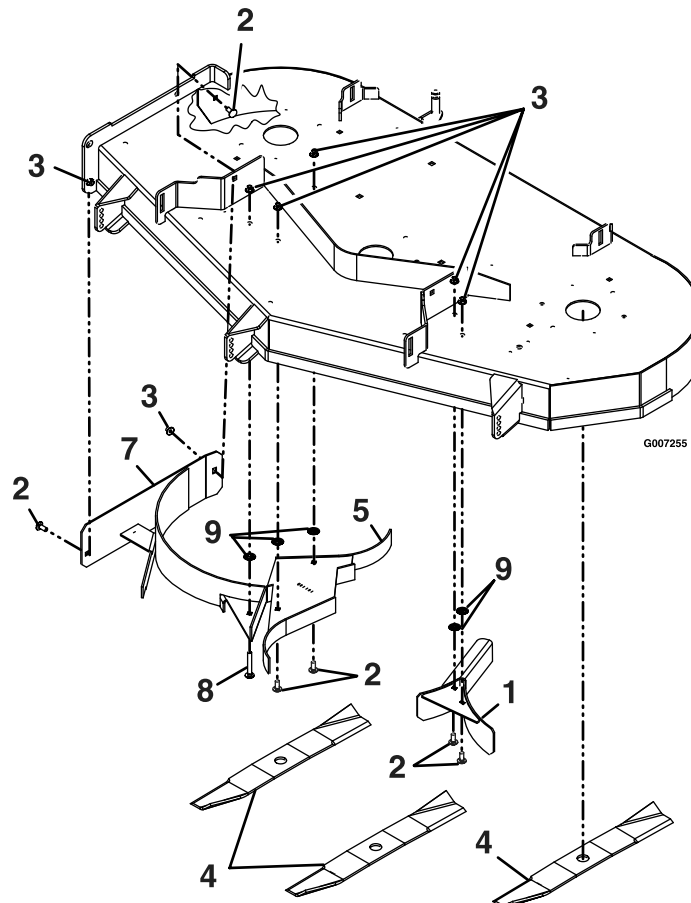





FIGURE 1

Installation Instructions:



(Refer to Figure 1 for all item callouts and hardware)

This **SAFETY ALERT SYMBOL**  is used both in this manual and on the machine to identify important safety messages which must be followed to avoid accidents. This symbol means:

**ATTENTION! BECOME ALERT!
YOUR SAFETY IS INVOLVED!**

 WARNING 
POTENTIAL HAZARD <ul style="list-style-type: none">◆ While maintenance or adjustments are being made, someone could start the engine.
WHAT CAN HAPPEN <ul style="list-style-type: none">◆ Accidental starting of the engine could seriously injure you or other bystanders.
HOW TO AVOID THE HAZARD <ul style="list-style-type: none">◆ Remove the key from the ignition switch and/or pull the wire(s) off the spark plug(s) before you do any maintenance. Also push the wire(s) aside so it does not accidentally contact the spark plug(s).

1. Stop engine, wait for all moving parts to stop, engage parking brake, and remove key.
2. Raise deck to the transport (4 1/2 inch (11.4 cm) cutting height) position. Lift the back end of unit and securely place two jack stands or equivalent support under the crossbar or frame tubes.

 CAUTION 
POTENTIAL HAZARD <ul style="list-style-type: none">◆ Raising the mower for service or maintenance relying solely on mechanical or hydraulic jacks could be dangerous.
WHAT CAN HAPPEN <ul style="list-style-type: none">◆ The mechanical or hydraulic jacks may not be enough support or may malfunction allowing the unit to fall, which could cause injury.
HOW TO AVOID THE HAZARD <ul style="list-style-type: none">◆ DO NOT rely solely on mechanical or hydraulic jacks for support. Use adequate jack stands or equivalent support.

3. Remove discharge chute and mounting hardware. Retain for reuse if the mulch kit is removed.
4. If your mower has been used, scrape underside of mower deck clean.
5. Remove existing blades from unit. Keep hardware to install mulch blades.
6. Remove belt shields on discharge side of 48 inch unit.
7. Remove the existing hole cover decals, discharge baffle, and mounting hardware as shown in Figure 2.

Note: Retain the discharge baffle and hardware for reuse if the mulch kit is removed.

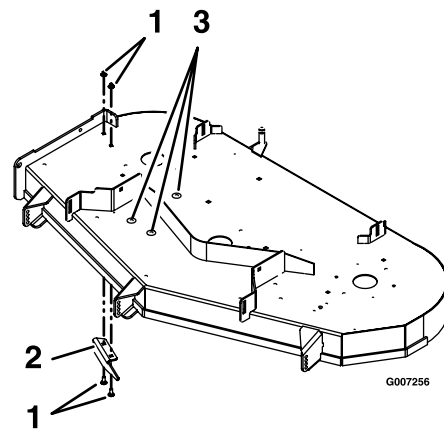

FIGURE 2

1. Discharge baffle mounting hardware
 2. Discharge baffle
 3. Hole cover decals
8. Remove the two 5/16 inch nuts and bolts from the left side of the deck and plug the mounting holes for the discharge baffle as shown in Figure 3.

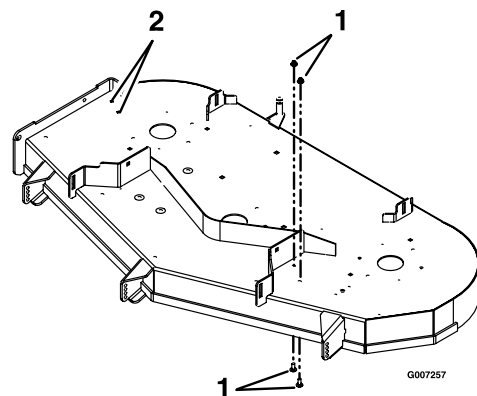



FIGURE 3

1. 5/16 inch nuts and bolts
2. Plug these holes.

9. Install right-hand (item 7), center (item 5), and left-hand (item 1) mulch baffle assemblies using hardware indicated as shown in Figure 1.
10. Install mulch blades using hardware previously removed in step 4. Torque the blade bolts to 45-55 ft-lb (61-75 N-m).

 WARNING 
POTENTIAL HAZARD <ul style="list-style-type: none"> ◆ Incorrect installation of the blade or components used to retain the blade can be dangerous.
WHAT CAN HAPPEN <ul style="list-style-type: none"> ◆ Failure to use all original components and assembled as shown could allow a blade or blade component to be thrown out from under the deck resulting in serious personal injury or death.
HOW TO AVOID THE HAZARD <ul style="list-style-type: none"> ◆ Always install the original blades and blade retaining hardware as shown in the Operator's manual.

Note: Refer to mower operator's manual for blade maintenance.

11. Reinstall belt shield if removed in step 5.
12. Carefully remove jack stands and lower unit to ground. Re-install spark plug cable(s) and ignition key. Your unit has successfully been converted to a mulching mower.

Converting Back to Side Discharge:

1. Safely remove all mulch baffles (items 1, 5, and 7).
2. Replace mulch blades with standard blades.
3. Install discharge baffle and re-locate 5/16 inch bolts as shown in Figures 2 and 3.
4. Install discharge chute.
5. Clean top surface of the deck and affix hole cover decals (item 6) on holes shown in Figure 4.

Note: If hole cover decals are not available, use 5/16 inch diameter hardware to plug the holes. All other open holes in the deck must be plugged with 5/16 inch hardware to prevent sand or other small objects from being thrown up through deck.

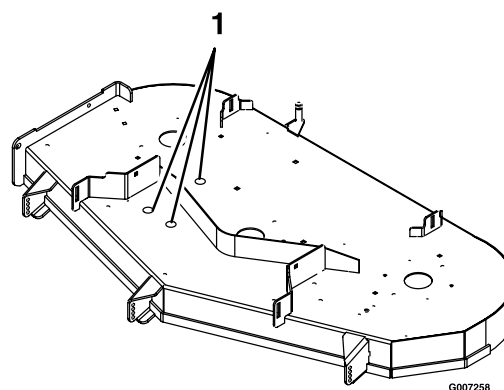

1. Hole cover decals

FIGURE 4

