



G132 and H132 Rear-Engine Riding Mower

Model No. 70185

Model No. 70186

Setup Instructions

Loose Parts

Use the chart below to verify that all parts have been shipped.

Procedure	Description	Qty.	Use
1	Wheels	2	Install the front wheels.
	Flat washers, M16 (3 mm thick)	2	
	Spacers, M16 (1 mm thick)	4	
	Cotter pins	2	
2	Seat	1	Install the seat.
	Screws, M8 x 18 mm	4	
	Flat washers, M9	4	
	Lock washers	4	
3	Socket pin	1	Attach the steering wheel.
4	Engine cover	1	Install the engine cover.
	Screws, M6 x 25 mm	2	
5	Frame	1	Assemble the grass collector.
	Fabric bag with clips	1	
	Handle	1	
	Locknuts, M8	2	
	Washers, M9	4	
6	Z-brackets	2	Install the grass collector.
	Bolts, M6 x 35 mm	2	
	Spacers	2	
	Washers	2	
	Nuts, M6	2	
	Grass collector cover	1	
	Pins	2	
	Full bag lever	1	
7	Bolts, M6 x 20 mm	2	Activate the battery.
	Flat washers, M6.5	4	
	Nuts, M6	2	
8	No parts required	–	Check the oil level.
9	No parts required	–	Fill the fuel tank.
10	No parts required	–	Check the tire pressure.
11	No parts required	–	Test the safety system.

Procedure	Description	Qty.	Use
12	Operator's Manuals (English and French)	2	Read the manual before operating or servicing the mower.
	Engine operator's manual	1	
	Keys	2	
	Spark plug wrench	1	
	Oil drain tube	1	
	Recycler® cover	1	

1

Installing the Front Wheels

Parts needed for this procedure:

2	Wheels
2	Flat washers, M16 (3 mm thick)
4	Spacers, M16 (1 mm thick)
2	Cotter pins

Procedure

- Slide a flat washer (M16, 3mm thick) onto each spindle (Figure 1).

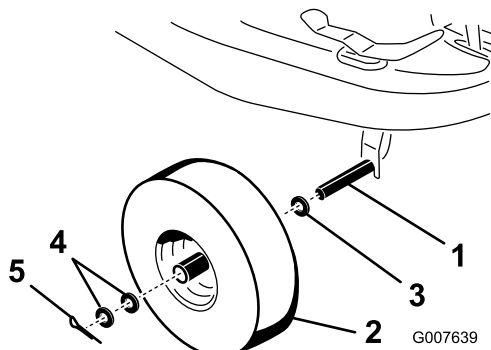

Figure 1

- Spindle
- Wheel
- Flat washer (M16, 3 mm thick)
- Spacers (M16, 1 mm thick)
- Cotter pin

- Mount the wheels and secure each of them with 2 spacers (M16, 1 mm thick) and a cotter pin (Figure 1).
- Grease the wheels.

2

Installing the Seat

Parts needed for this procedure:

1	Seat
4	Screws, M8 x 18 mm
4	Flat washers, M9
4	Lock washers

Procedure

Attach the seat to the support plate with 4 flat washers (M9), lock washers, and screws (M8 x 18 mm) (Figure 2).

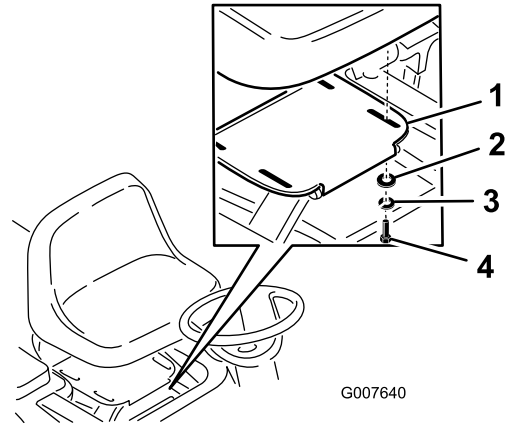

Figure 2

- Seat Support plate
- Flat washer (M9)
- Lock washer
- Screw (M8 x 18 mm)

Note: Before tightening the screws, adjust the seat to a position that is most comfortable for you.

3

Attaching the Steering Wheel

Parts needed for this procedure:

1	Socket pin
---	------------

Procedure

1. Rotate the steering wheel upward until it is aligned with the steering column.
2. Secure the steering wheel with the socket pin (Figure 3).

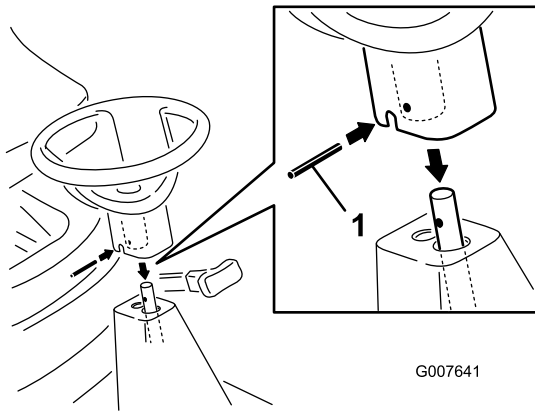

Figure 3

1. Socket pin

4

Installing the Engine Cover

Parts needed for this procedure:

1	Engine cover
2	Screws, M6 x 25 mm

Procedure

1. Slide the tabs on the engine cover into the slots on the body of the tractor (Figure 4).

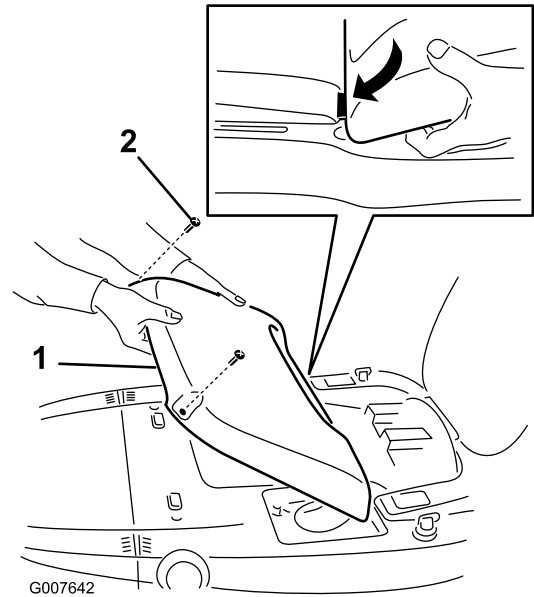

Figure 4

1. Engine cover
2. Screw

2. Secure the cover with 2 screws (M6 x 25 mm) (Figure 4).

5

Assembling the Grass Collector

Parts needed for this procedure:

1	Frame
1	Fabric bag with clips
1	Handle
2	Locknuts, M8
4	Washers, M9

Procedure

1. Slide the bag onto the frame and secure it with the clips (Figure 5).

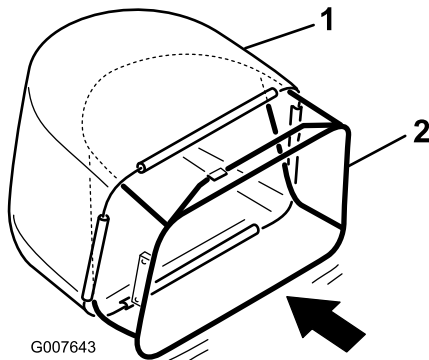

Figure 5

1. Bag
2. Frame

2. Secure the handle to the bag assembly with 4 washers (M9) and 2 locknuts (M8) (Figure 6).

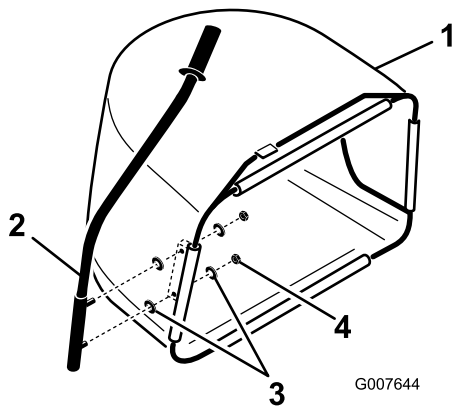

Figure 6

1. Bag assembly
2. Handle
3. Washer (M9)
4. Locknut (M8)

6

Installing the Grass Collector

Parts needed for this procedure:

2	Z-brackets
2	Bolts, M6 x 35 mm
2	Spacers
2	Washers
2	Nuts, M6
1	Grass collector cover
2	Pins
1	Full bag lever

Procedure

1. Reach beneath the rear of the tractor and hold the full bag switch and switch plate while removing the 2 screws on the rear panel (Figure 7).

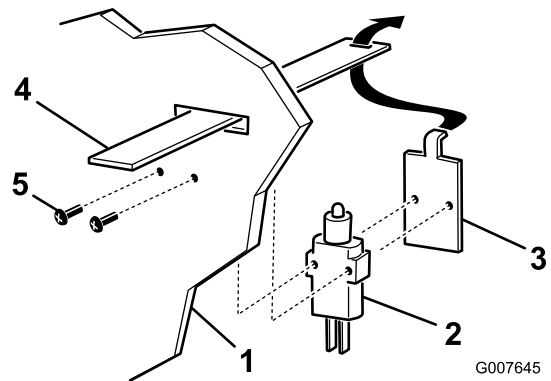

Figure 7

1. Rear panel
2. Switch
3. Switch plate
4. Full bag lever
5. Screw

2. Hold the switch plate against the switch and slide the full bag lever into the rectangular slot on the rear panel.
3. Hook the switch plate onto the lever and secure the switch and switch plate to the rear panel with the 2 screws (Figure 7).
4. Attach the grass collector to the rear of the tractor with 2 bolts (M6 x 16.2 mm), Z-brackets, spacers, washers, and nuts (M6) (Figure 8).

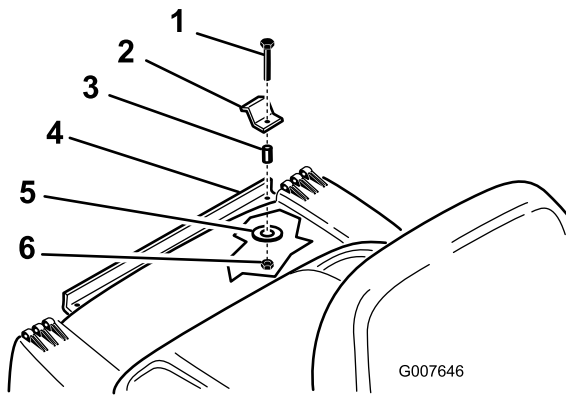

Figure 8

- | | |
|----------------------|--------------------|
| 1. Bolt (M6 x 35 mm) | 4. Grass collector |
| 2. Z-bracket | 5. Washer |
| 3. Spacer | 6. Nut (M6) |

5. Attach the grass collector cover to the tractor with 2 pins (Figure 9).

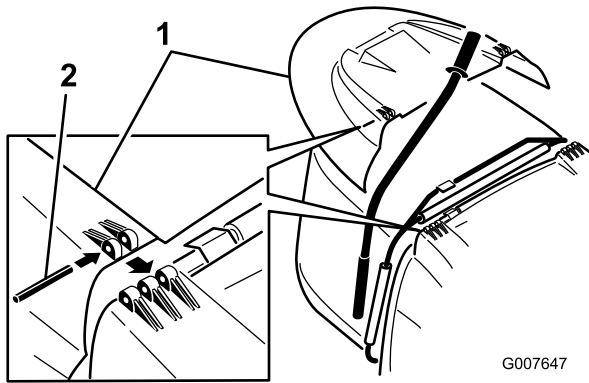

Figure 9

- | | |
|--------------------------|--------|
| 1. Grass collector cover | 2. Pin |
|--------------------------|--------|

7

Activating the Battery

Parts needed for this procedure:

2	Bolts, M6 x 20 mm
4	Flat washers, M6.5
2	Nuts, M6

Procedure

Purchase bulk electrolyte with 1.260 specific gravity from a local battery supply outlet.

Battery electrolyte contains sulfuric acid, a deadly poison that can cause severe burns.

- **Do not drink electrolyte and avoid contact with skin, eyes or clothing. Wear safety glasses to shield your eyes and rubber gloves to protect your hands.**
- **Fill the battery where clean water is always available for flushing the skin.**
- **Follow all instructions and comply with all safety messages on the electrolyte container.**

1. Remove the battery from the tractor and place it on a level surface; refer to Removing the Battery in the Operator's Manual.

Important: Never fill the battery with electrolyte while the battery is installed in the tractor. You could spill electrolyte on other parts and cause corrosion.

2. Clean the top of the battery with a paper towel.
3. Remove the vent caps from the battery (Figure 10).

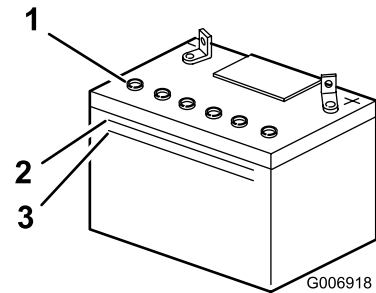

Figure 10

- | | |
|---------------|---------------|
| 1. Vent caps | 3. Lower line |
| 2. Upper line | |

4. Slowly pour electrolyte into each battery cell until the electrolyte level is up to the upper line on the battery case (Figure 10).

Important: Do not overfill the battery because electrolyte (sulfuric acid) can severely corrode and damage the chassis.

5. Wait 5 to 10 minutes after filling the battery cells, then add electrolyte, if necessary, until the electrolyte level is up to the upper line (Figure 10) on the battery case.
6. Install the battery vent caps.
7. Charge the battery for 1 hour at 25 to 30 amps or 6 hours at 4 to 6 amps. **Do not overcharge the battery.**



Charging the battery produces gasses that can explode.

Never smoke near the battery and keep sparks and flames away from battery.

- When the battery is fully charged, unplug the charger from the electrical outlet, then disconnect the charger leads from the battery posts (Figure 11).

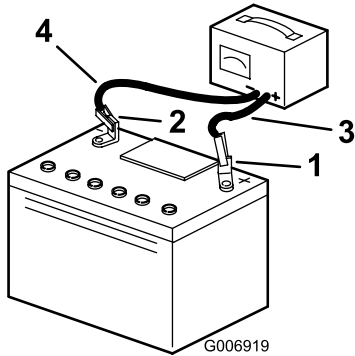

Figure 11

- | | |
|------------------|---------------------------|
| 1. Positive post | 3. Charger red (+) wire |
| 2. Negative post | 4. Charger black (-) wire |

- Install the battery in the tractor and connect the battery cables; refer to Installing the Battery in the Operator's Manual.

8

Checking the Engine Oil Level

No Parts Required

Procedure

Before you start the engine and use the tractor, check the oil level in the engine crankcase; refer to Checking the Oil Level in the Operator's Manual.

9

Filling the Fuel Tank

No Parts Required

Procedure

Add fuel to the fuel tank; refer to Filling the Fuel Tank in the Operator's Manual.

10

Checking the Tire Pressure

No Parts Required

Procedure

Check the front and rear tires for proper inflation; refer to Checking the Tire Pressure in the Operator's Manual.

11

Testing the Safety System

No Parts Required

Procedure

Test the safety interlock system; refer to The Safety Interlock System in the Operator's Manual.

12

Reading the Manual

Parts needed for this procedure:

2	Operator's Manuals (English and French)
1	Engine operator's manual
2	Keys
1	Spark plug wrench
1	Oil drain tube
1	Recycler® cover

Procedure

- Read the Operator's Manual.
- Read the engine owner's manual.
- Use the ignition key to start the engine and the KeyChoice key to operate the mower in reverse (refer to the Operator's Manual).
- Use the spark plug wrench to service the spark plug (refer to the Operator's Manual).
- Use the oil drain tube when you change the engine oil (refer to the Operator's Manual).
- Use the Recycler cover when recycling the grass clippings (refer to the Operator's Manual).



Count on it.