



# Replacement Water Pump Kit and Replacement Fan Clutch Kit

for Groundsmaster 4000 Series Traction Unit

Model No. 115-1561

Model No. 115-1562

## Installation Instructions

This kit is a supplement to the water pump replacement kit and the fan clutch replacement kit. It includes an update spacer that is shorter than the existing spacer on the machine and new, shorter cap screws. A table

below describes when the new spacer and shorter cap screws should be used when replacing the water pump or fan clutch.

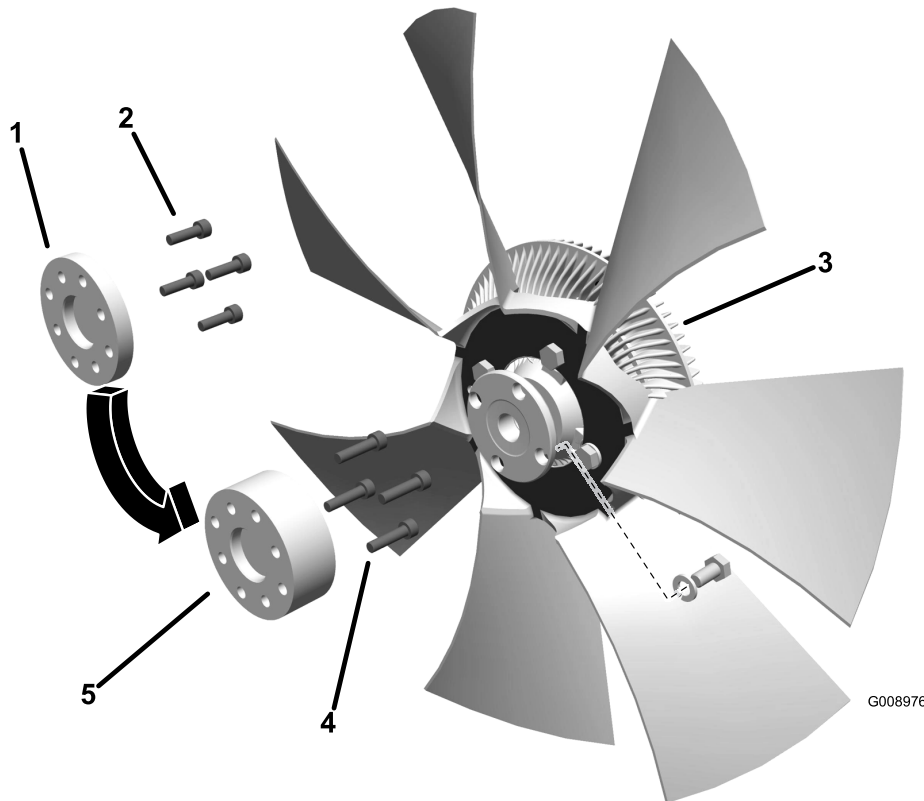

**Figure 1**

- |                               |                         |                                |
|-------------------------------|-------------------------|--------------------------------|
| 1. .50 inch spacer (100-3066) | 3. Fan clutch assembly  | 5. 1.06 inch spacer (105-4509) |
| 2. Cap screws (52-6290)       | 4. Cap screws (48-7850) |                                |

For:	Use:
<b>GM4500 &amp; GM4700</b>	Remove and discard the existing 1.06" long fan spacer (105-4509) and four existing cap screws (48-7850). Install the new .50 inch long fan spacer (100-3066) and four new shorter cap screws (52-6290).
<b>GM4000 &amp; GM4100 <i>without</i> the optional air conditioning kit</b>	The supplied new .50 inch long fan spacer (100-3066) and four new cap screws (52-6290) are the same spacer and cap screws that are currently installed on the machine, replacement is not necessary.
<b>GM4000 &amp; GM4100 <i>with</i> the optional air conditioning kit</b>	<b>DO NOT</b> install the new .50 inch long fan spacer (100-3066) and four new cap screws (52-6290). Use the existing 1.06" long fan spacer (105-4509) and four existing longer cap screws (48-7850).