



# Heavy-Duty Brushguard and Bumper Kit

for Workman MD/MDX/MDE Utility Vehicle

Model No. 07338

## Installation Instructions

### Loose Parts

Use the chart below to verify that all parts have been shipped.

Description	Qty.	Use
Brushguard and Bumper Assembly	1	Install the brushguard and bumper.
Flange Bolt (3/8 x 5 inch)	2	
Bolt (3/8 x 1 inch)	4	
Lock nut (3/8 inch)	6	

### Installing the Brushguard and Bumper

1. Locate the two exposed bolts on the existing front bumper. Remove the bolts and lock nuts and discard. The existing plastic bumper stays in place.

G008825

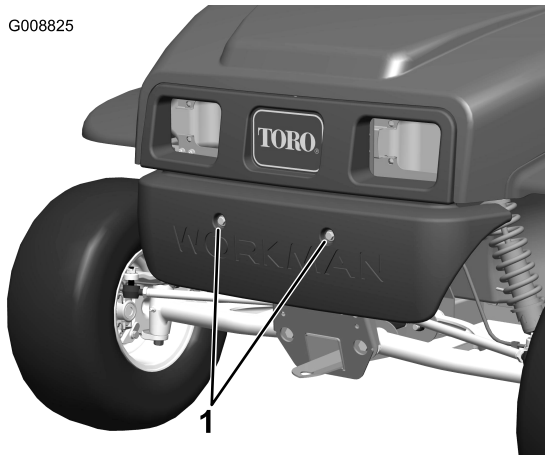

**Figure 1**

1. Front bumper bolts

2. Install the brushguard and bumper assembly to the front mounting plate above the towing tongue and below the exiting plastic bumper (Figure 2).

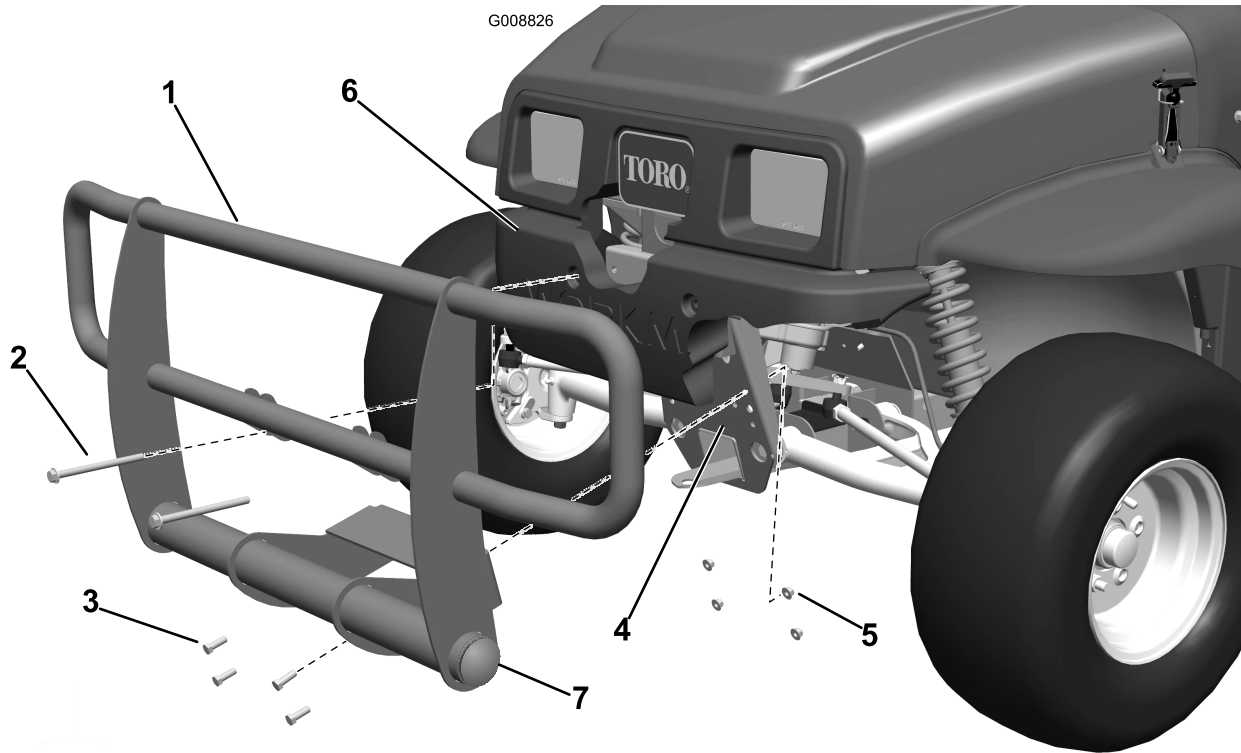

**Figure 2**

- |                               |                        |                        |            |
|-------------------------------|------------------------|------------------------|------------|
| 1. Brushguard and bumper      | 3. Bolt (3/8 x 1 inch) | 5. Lock nut (3/8 inch) | 7. End cap |
| 2. Flange bolt (3/8 x 5 inch) | 4. Mounting plate      | 6. Front bumper        |            |

3. Use four bolts (3/8 x 1 inch) and four lock nuts (3/8 inch) to secure the brushguard and bumper assembly to the mounting plate (Figure 2). Torque the fasteners to 27-33 ft-lb (37-45 N-m).

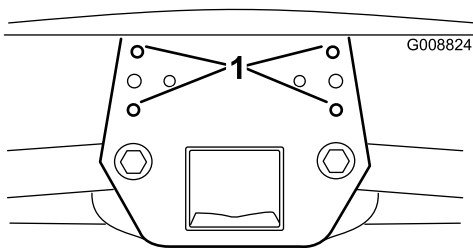

**Figure 3**

1. Mounting holes

4. Install two flange bolts (3/8 x 5 inch) through the brushguard and into the existing plastic bumper at the two open holes (Figure 2). Use two lock nuts to secure the bolts and brushguard to the front of the vehicle at the bumper.