



Lift Arm Protection Kit,

Sand Pro/Infield Pro Attachments 08751, 08753, 08756 and 108-9427

Model No. 115-5607

Installation Instructions

Loose Parts

Use the chart below to verify that all parts have been shipped.

Procedure	Description	Qty.	Use
1	Wear pad	1	
	Tube wear pad	1	
	Clamp	1	
	Screw	2	
	Flange nut	2	
	Installation instructions	1	
	Parts catalog	1	

1

Parts needed for this procedure:

1	Wear pad
1	Tube wear pad
1	Clamp
2	Screw
2	Flange nut
1	Installation instructions
1	Parts catalog

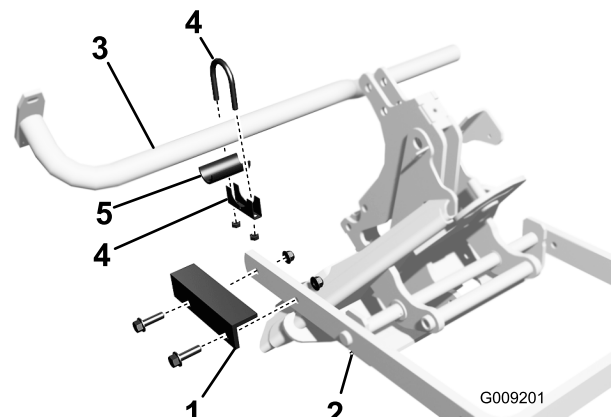

Figure 1

- | | |
|----------------------------------|--------------------|
| 1. Wear pad | 4. Clamp |
| 2. Lift arm bar | 5. Curved wear pad |
| 3. Traction unit rear frame tube | |

Procedure

1. Park the machine on a level surface, lower the attachment and turn the engine off. Remove the key from the ignition switch.
 2. Locate the two holes in the lift arm bar that are directly under the traction unit rear frame tube (Figure 1).
 3. Using the holes provided, mount the wear pad to the lift arm bar with two flange head bolts and flange nuts. Position the wear pad on the lift arm as shown in Figure 1.
 4. Directly above the lift arm, loosely mount the tube wear pad to the under side of the frame tube with the clamp (Figure 1). Offset the clamp on the wear pad so it does not contact the lift arm during operation of the attachment.
- Note:** The tube wear pad is only required if the tube has been damaged from the lift arm bar.
5. Tighten all the nuts.