

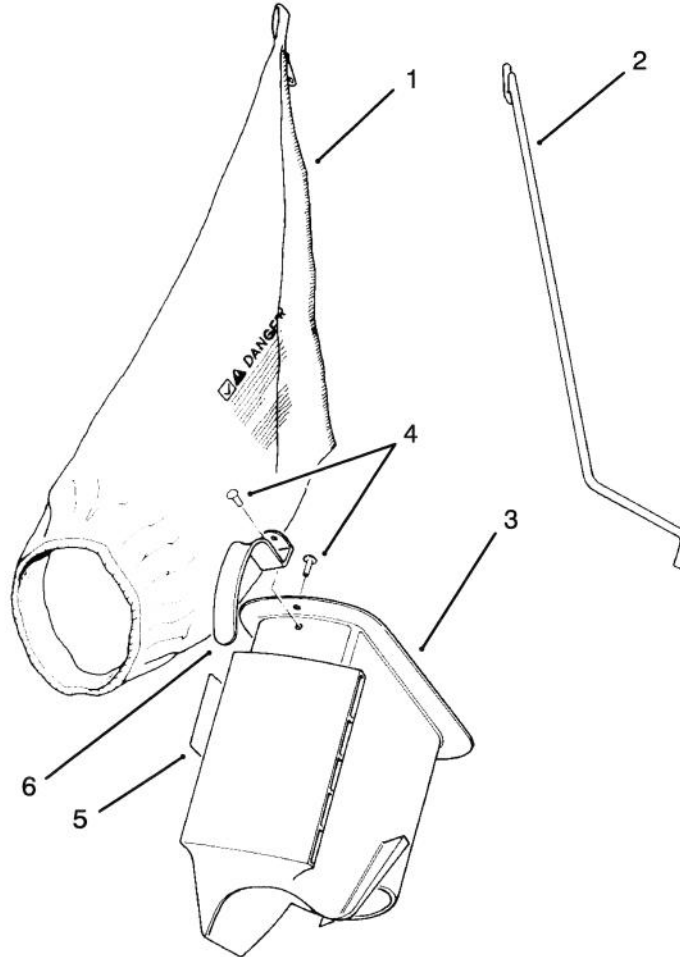

PART NO. 47-6510

PARTS
CATALOG**BAGGING KIT**

C-1597

BAG ASSEMBLY

Ref. No.	Part No.	Description	No. Used	Ref. No.	Part No.	Description	No. Used
1	6-0929	Bag - Grass	1	4	3295-26	Rivet	2
2	47-5830	Rod - Bag	1	5	36-5230	Decal - Bag Chute	1
3	6-1089	Grass Chute Assembly (Incl. Ref. #4 & 6)	1	6	20-4650	Handle - Chute	

PRODUCT CHANGES

In an effort to make improvements available to TORO owners as quickly as possible, minor changes are incorporated into Toro's products from time to time that do not become immediately shown in the Parts Catalog. If such a change has been made in your unit, which is not reflected in your manual, see your TORO Distributor or his Authorized TORO Service Dealer for information and part numbers.

COUNTRIES OTHER THAN THE UNITED STATES OR CANADA

Customers who have purchased TORO products exported from the United States or Canada should contact their Toro Distributor (Dealer) to obtain guarantee policies for your country, province or state. If for any reason you are dissatisfied with your Distributor's

service or have difficulty obtaining guarantee information, contact the TORO importer. If all other remedies fail, you may contact us at The Toro Company.

MAINTENANCE RECORD

[illegible]