



Tier IV Engine Kit

Reelmaster 5400-D/5500-D Traction Unit

Model No. 115-8009

Form No. 3361-326 Rev A

Installation Instructions

Installation

Air Cleaner Hose and Muffler Gasket Installation

When replacing the engine, use the new air cleaner hose, muffler gasket and fasteners included.

Drive Shaft Installation

When replacing the engine, use the new drive shaft and the appropriate fasteners included for your model.

Pulley Installation

When replacing the engine, use the appropriate pulley for your model.

Wire Harness Installation

Wire harness to be replaced on all models with serial numbers prior to 229999999

Fuel Pump Installation

On the model and serial numbers listed below, the fuel pump must also be replaced.

Model Numbers	Serial Numbers
03543 & 03544	90101 thru 210999999
03550 & 03551	200000101 thru 210999999

Note: When replacing a complete engine, a different fuel pump is required. Refer to the Toro Commercial Customer Service Bulletin for Large Reels #03-07, dated January 18, 2005.

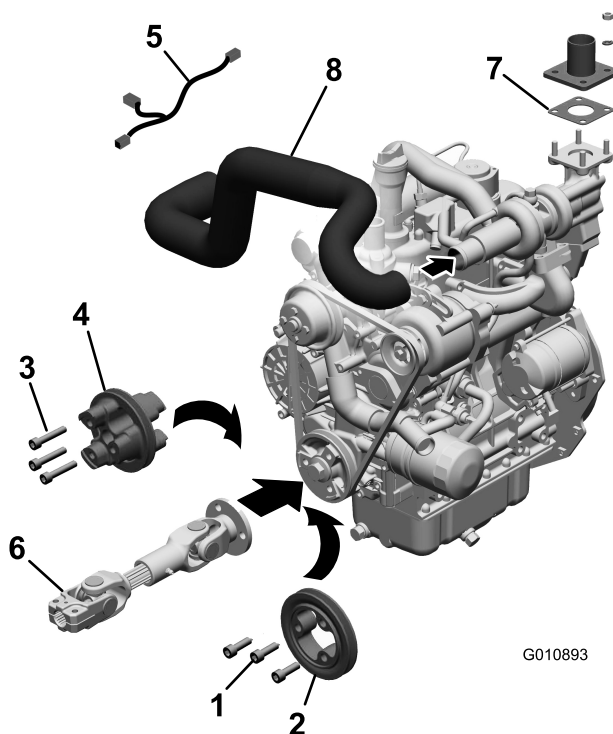

G010893

Figure 1

- | | | |
|---|---|---------------------|
| 1. M10 x 30 socket head screws, Used on Reelmaster Models 03550 and 03551 | 4. Used on Reelmaster Models 03543 and 03544 | 7. Muffler gasket |
| 2. Pulley, Used on Reelmaster Models 03550 and 03551 | 5. Wire harness to be replaced on all models with serial numbers prior to 229999999 | 8. Air cleaner hose |
| 3. M10 x 50 socket head screws, Used on Reelmaster Models 03543 and 03544 | 6. Drive shaft | |