



Model 30823 Debris Blower Mounting Kit for Groundsmaster® 3280-D and 3320 Traction Units

Model No. 115-4929

Form No. 3361-343 Rev A

Installation Instructions

Loose Parts

Use the chart below to verify that all parts have been shipped.

Description	Qty.	Use
Arm	2	Install the debris blower.
Stop	1	
Bolts (7/16 x 3 inches)	10	
Locknut (7/16 inch)	12	
Washer	24	
Bolt (7/16 x 3-1/4 inches)	2	
Drive shaft	1	
Roll pin	1	
Bolt (5/16 x 1-1/2 inches)	2	
Locknut (5/16 inch)	2	

Note: The traction unit must be equipped with the Attachment Frame Kit, Toro Part No. 110-8540 before installing the Debris Blower Mounting Kit.

Installing the Debris Blower

1. Position the machine on a clean, level surface. Lower any implement, stop the engine, apply the parking brake and remove the key from the ignition switch.
2. Loosely install the left arm to the attachment frame using 3 bolts (7/16 x 3 inches), 3 locknuts (7/16 inch), and 6 washers (Figure 1).

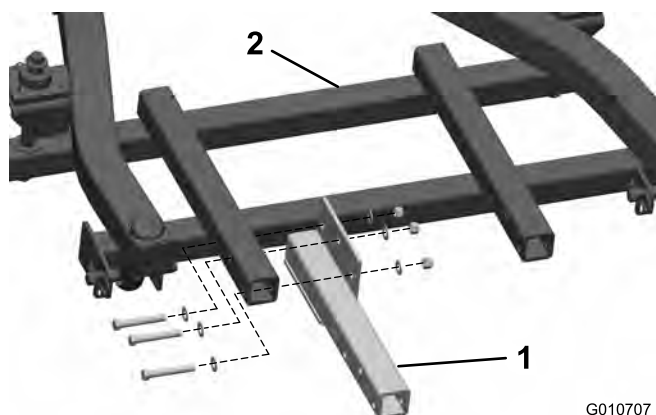

Figure 1

1. Left arm 2. Attachment frame

the stop), 3 locknuts (7/16 inch), and 6 washers (Figure 2).

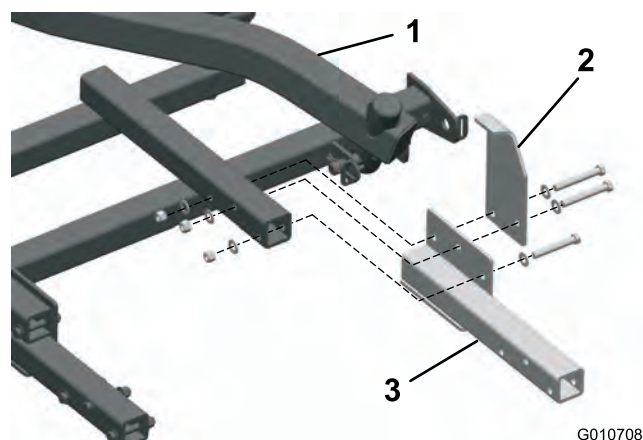

Figure 2

1. Attachment frame 3. Right arm
2. Stop

4. Slide the blower into the attachment frame arms and loosely secure it using 6 bolts (7/16 x 3 inches), 6 locknuts (7/16 inch), and 12 washers (Figure 3).

3. Loosely install the right arm and the stop to the attachment frame using 1 bolt (7/16 x 3 inches), 2 bolts (7/16 x 3-1/4 inches—installed through

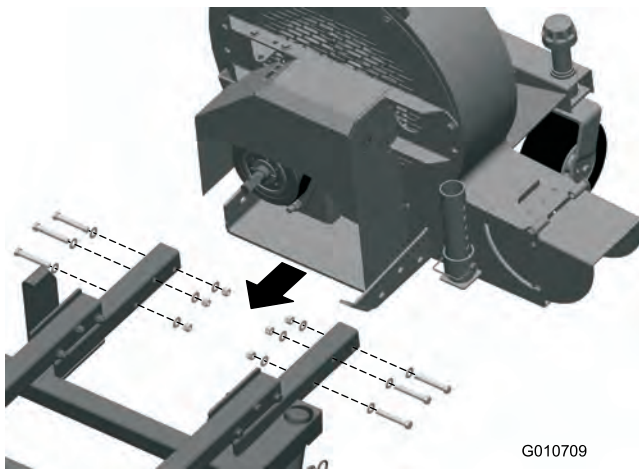

Figure 3

5. Tighten all fasteners securely.
6. Install the shaft onto the traction unit PTO.
7. Install the end of the shaft onto the drive shaft of the blower, securing it with a roll pin and 2 bolts (5/16 x 1-1/2 inches) and locknuts (5/16 inch) (Figure 4). Torque the bolts and nuts to 200 in-lb (22.5 N-m).

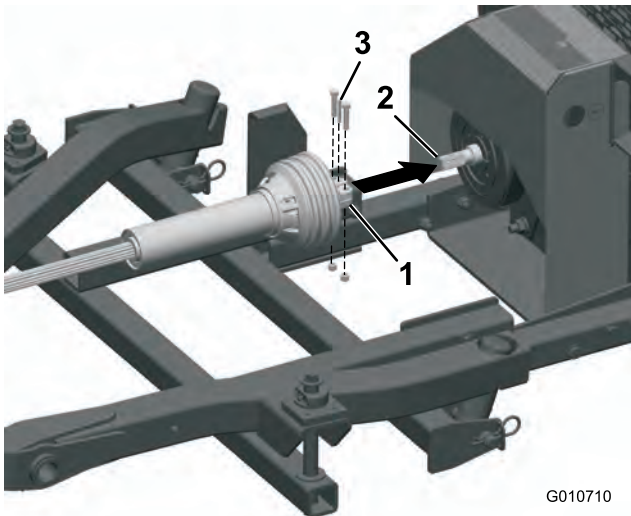

Figure 4

- | | |
|-----------------------|-------------|
| 1. End of the shaft | 3. Roll pin |
| 2. Blower drive shaft | |