



Z Master® Mowers

International Z Master Mowers

Form No. 3361-467 Rev A

Setup Instructions

Loose Parts

Use the chart below to verify that all parts have been shipped.

Procedure	Description	Qty.	Use
1	No parts required	—	Remove parts from the crate.
2	No parts required	—	Check the tire pressure.
3	Rear wheels	2	Install the drive wheels.
4	Roll bar, right section Roll bar, left section Roll bar, center section Bolt, (3/8 x 1 inch) Curved washer Flange nut, (3/8 inch) Bolt, (1/2 x 3–1/4 inch) Flange nut, (1/2 inch)	1 1 1 8 8 8 2 2	Install the Rollover Protection System (ROPS).
5	No parts required	—	Install the seat.
6	Right control lever Left control lever Bolt (3/8 x 1 inch) (2 are assembled) Curved washer (3/8 inch) (2 are assembled)	1 1 4 4	Install the motion control levers.
7	No parts required	—	Adding fuel to the machine.
8	No parts required	—	Charge the battery.
9	Air cleaner cap Hose clamp	1 1	Install the air cleaner cap.
10	Number 2 general purpose lithium base or molybdenum base grease. (Purchase separately.)	1 tube	Check the machine for grease.
11	No parts required	—	Check the engine oil level.
12	No parts required	—	Prepare the side discharge chute.
13	No parts required	—	Check the machine before delivery to the customer.
14	Operator's Manual Engine Owner's Manual Registration Card Operator training material Key	1 1 1 1 2	Delivering the machine to the customer.

1

Removing Parts from the Crate

No Parts Required

Procedure

Remove the tires, the seat and the parts for the ROPS from the shipping crate.

2

Checking the Tire Pressure

No Parts Required

Procedure

Pressure: 13 psi (90 kPa)

Check the air pressure in the tires.

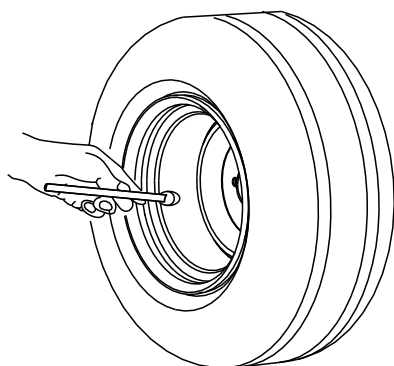

G001055

Figure 1

3

Raising the Machine Up and Installing the Drive Wheels

Parts needed for this procedure:

2	Rear wheels
---	-------------

Procedure

1. Remove the screws holding the right angle retaining plate to the crate.

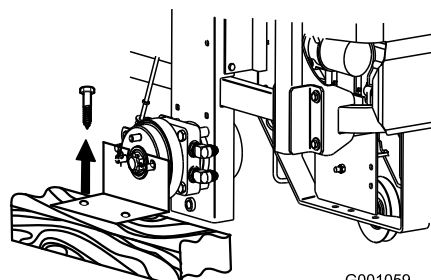

G001059

Figure 2

2. Raise the back of the machine up and support it with jack-stands.

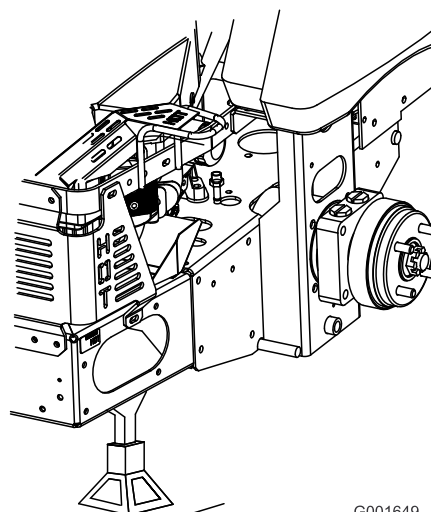

G001649

Figure 3

3. Remove the wheel nuts from both sides of the vehicle and remove the right angle retaining plate. Discard the screws and retaining plate.

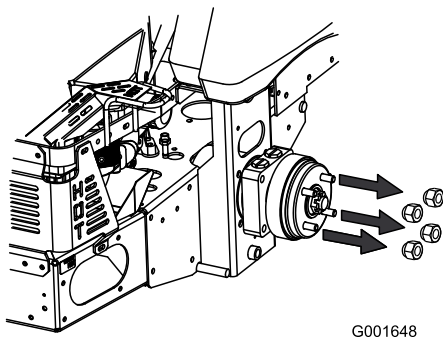

Figure 4

4. Mount the wheels with the valve stem to the outside and secure them with the wheel nuts previously removed.
5. Torque the wheel nuts to 95 ft-lb (128 N·m).
6. Remove the jack-stands.

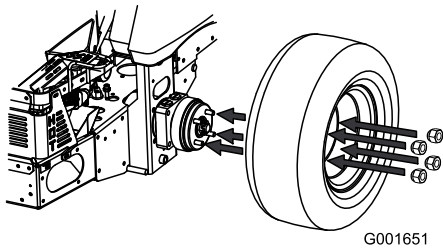

Figure 5

Note: The curve washer cone must be installed toward the bolt head.

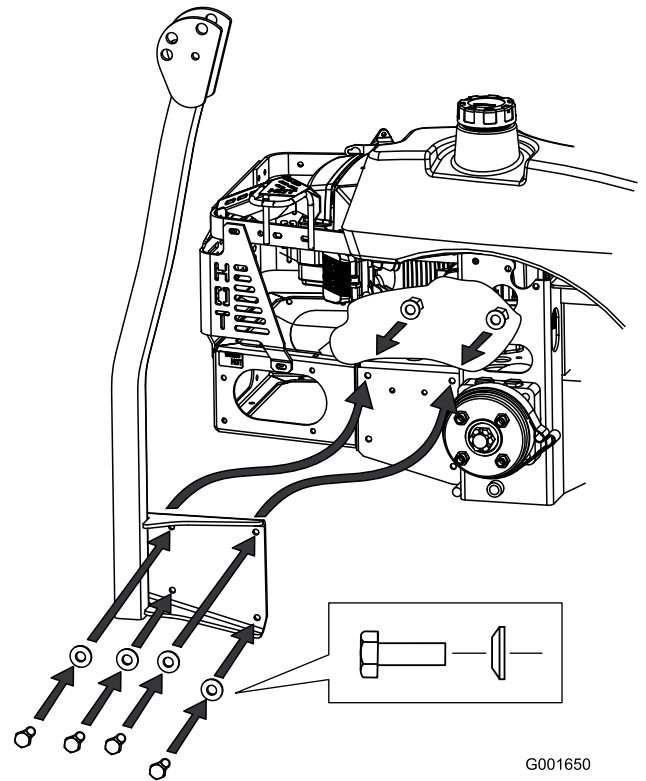

Figure 6

2. Install the lanyard clips onto the long bolts (1/2 x 3-1/4 inch).

Note: Make sure the bent tab points toward the head of the bolt.

4

Installing the Roll Over Protection System

Parts needed for this procedure:

1	Roll bar, right section
1	Roll bar, left section
1	Roll bar, center section
8	Bolt, (3/8 x 1 inch)
8	Curved washer
8	Flange nut, (3/8 inch)
2	Bolt, (1/2 x 3-1/4 inch)
2	Flange nut, (1/2 inch)

Procedure

1. Loosely install the right and left roll bar section to the frame, with 8 bolts (3/8 x 1 inch), 8 curved washers, and 8 flange nuts (3/8 inch).

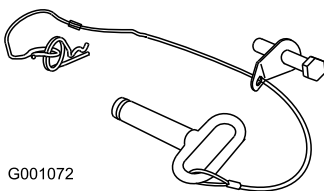

Figure 7

3. Lightly oil the ends of the center roll bar section.
4. Loosely install the center roll bar section using 2 bolts (1/2 x 3-1/4 inch) and 2 flange nuts (1/2 inch).

Note: Make sure the bolts are installed from the outside of the roll bar.

Note: Make sure the lanyard tab is installed as show and points forward.

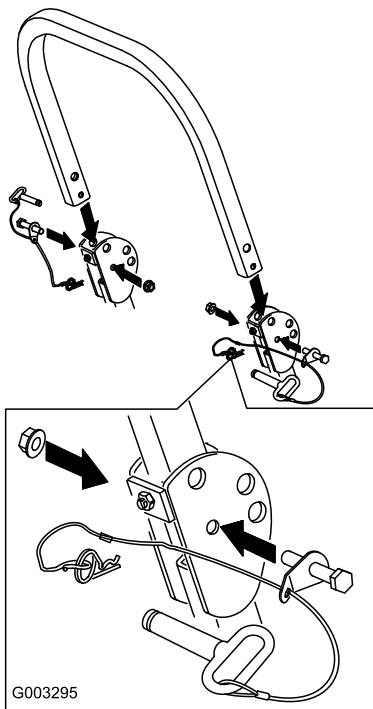

Figure 8

5. Raise the roll bar into the upright position and secure it with the pins and hairpin cotter pins fastened to the lanyards

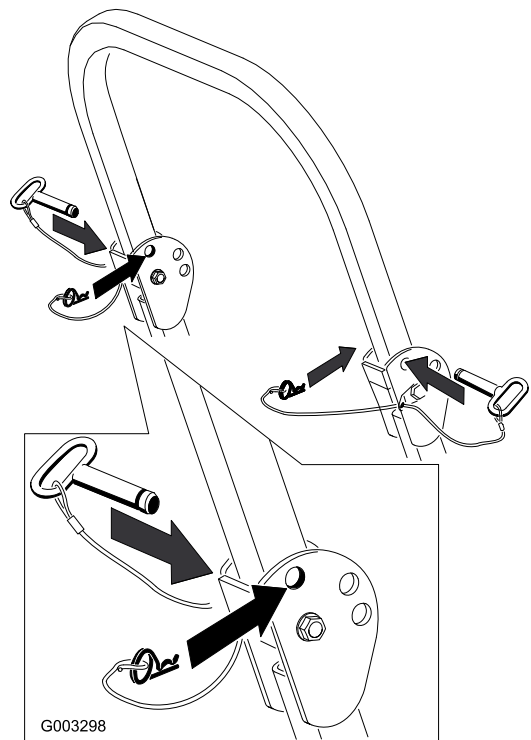

Figure 9

6. Torque all lower fasteners, attached to the machine frame, to 30 ft-lb.
7. Tighten the center roll bar bolts (1/2 x 3-1/4 inch) so it rotates freely with some resistance.

Note: No more than one thread should be exposed outside the nut.

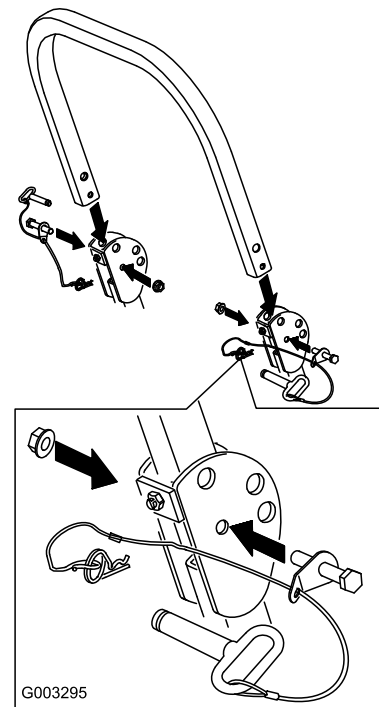

Figure 10

5

Installing the Seat

No Parts Required

Procedure

1. Remove the bolt and nut from the seat frame.
2. Remove the nuts from the studs under the seat.
3. Secure the seat rod to the seat with the bolt and nut.
4. Install the seat to the seat frame with the previously removed nuts.

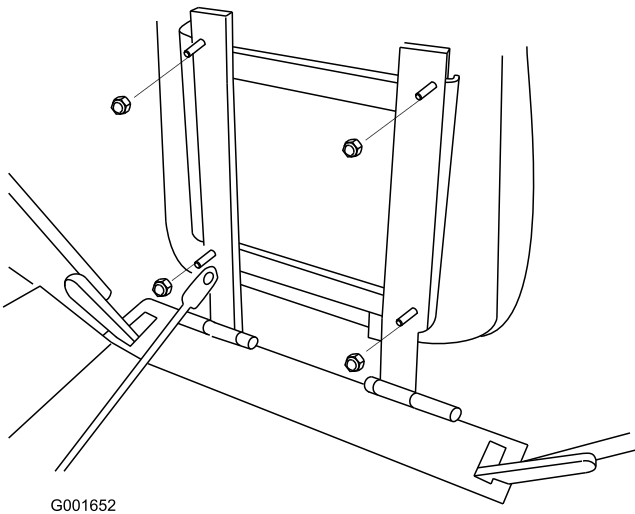

Figure 11

5. Install the seat rod to the seat frame.

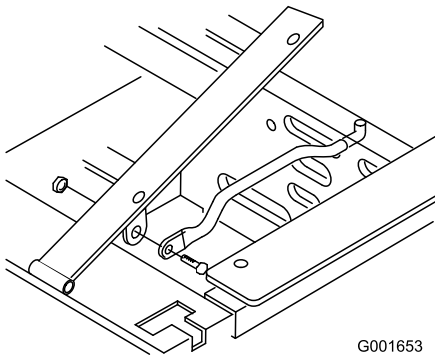

Figure 12

6

Installing the Motion Control Levers

Parts needed for this procedure:

1	Right control lever
1	Left control lever
4	Bolt (3/8 x 1 inch) (2 are assembled)
4	Curved washer (3/8 inch) (2 are assembled)

Procedure

1. Rotate the motion control levers to the upright position.
2. Loosely install the control levers on the outside of the posts, using 4 bolts and 4 curved washers.

Note: Install the control levers in the top and middle holes for the high position or the middle and bottom holes for the low position, as desired.

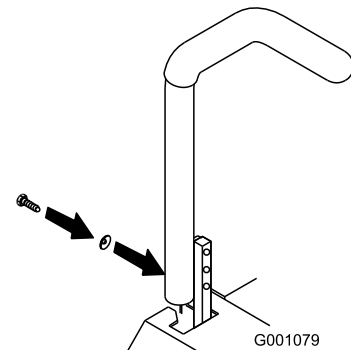

Figure 13

3. Raise the levers and align them together in the neutral position and tighten the bolts.

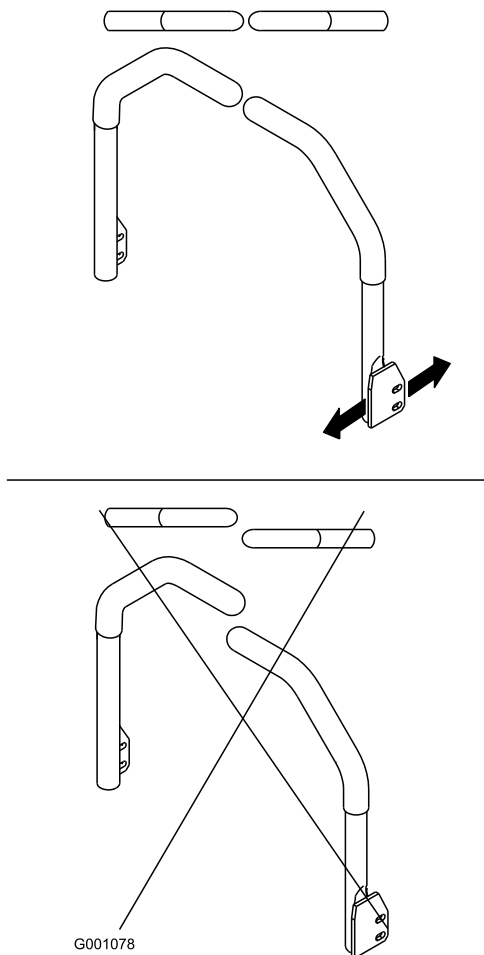

Figure 14

Note: If the machine is not properly tracking, refer to Adjusting the Tracking in your *Operator's Manual*.

7

Adding Fuel to the Machine

No Parts Required

Procedure

Add fuel to the machine before starting it. Refer to your *Operator's Manual* for the correct fuel and procedure.

8

Charging the Battery

No Parts Required

Procedure



Charging the battery produces gasses that can explode and cause serious injury.

- Keep cigarettes, sparks and flames away from the battery.
- Make sure the ignition switch is off.
- Ventilate when charging or using the battery in an enclosed space.

Important: Do not run the machine with the battery disconnected; electrical damage may occur to the engine.

Charge the battery. Refer to the *Operator's Manual* for instructions.

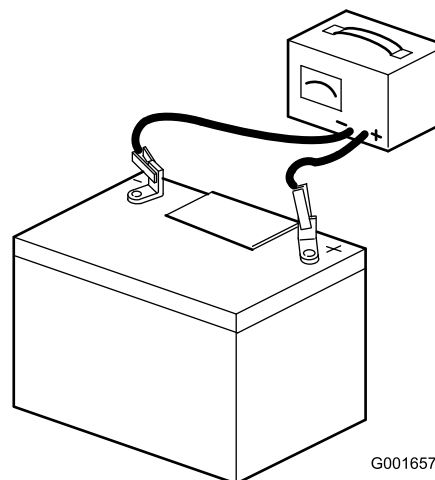

Figure 15

9

Installing the Air Cleaner Cap

Parts needed for this procedure:

1	Air cleaner cap
1	Hose clamp

Procedure

1. Remove the plastic plug.

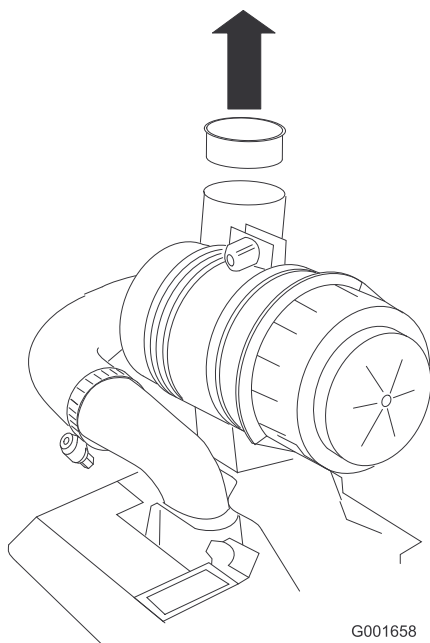

Figure 16

2. Remove the air cleaner cap from the machine.
3. Install the hose clamp onto the air cleaner cap.

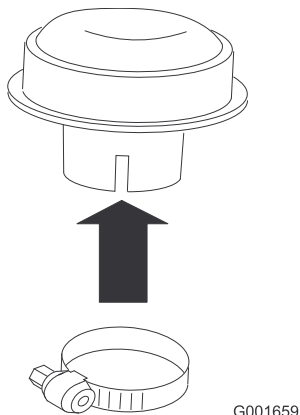

Figure 17

4. Install the air cleaner cap onto the air cleaner and secure it with the hose clamp.

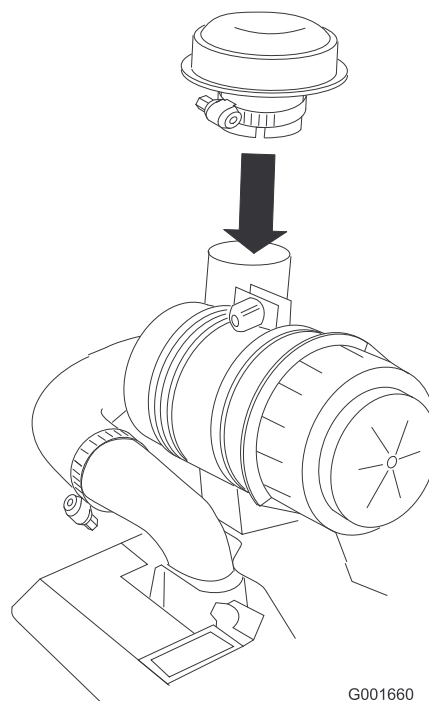

Figure 18

10

Checking the Machine for Grease

Parts needed for this procedure:

1 tube	Number 2 general purpose lithium base or molybdenum base grease. (Purchase separately.)
--------	---

Procedure

1. Check the tensioning arm for grease.
2. Check the grease for the three spindle bearings. If needed, add grease until it comes out of the lower seals.

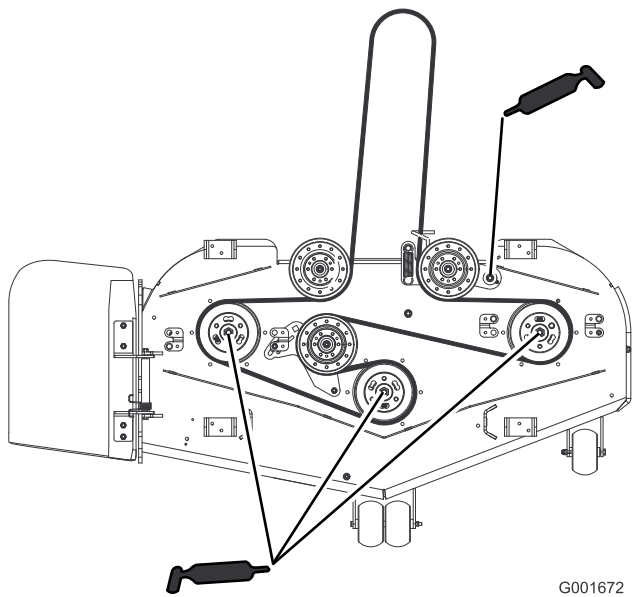

Figure 19

12

Preparing the Side Discharge Chute

No Parts Required

Procedure

Remove the plastic tie holding the side discharge chute up and lower the chute into place.

Check and ensure the spring is installed correctly. The grass deflector must be able to lower down into position. Lift the deflector up to test that it lowers into the full down position.

If needed, refer to Replacing the Grass Deflector in the *Operator's Manual*.

11

Checking the Engine Oil Level

No Parts Required

Procedure

Before you start the engine and use the machine, check the oil level in the engine crankcase; refer to Checking Oil Level in *Operator's Manual*.

13

Checking the Machine Before Delivery to the Customer

No Parts Required

Procedure

Before delivering the machine to the customer, ensure that you perform or have performed the procedures listed in the following table and initial each when finished. Refer to the Operator's Manual for instructions on performing these procedures.

Initial	Check Procedure
	Check the tire pressure.
	Check the level of the mower.
	Check that all mower spindles are greased.
	Check the engine oil level.
	Check the hydraulic fluid level.
	Check ROPS is secure.
	Check the adjustment of the parking brake.
	Ensure that the machine tracks correctly; refer to the <i>Operator's Manual</i> for the adjustment procedure.
	Check the safety interlock system; refer to the <i>Operator's Manual</i> .
	Ensure that the PTO works.
	Check all fasteners you installed to ensure that they are tight.

When you finish setting up the machine, sign and date in the space provided below:

Signature: _____ Date: _____

14

Delivering the Machine to the Customer

Parts needed for this procedure:

1	<i>Operator's Manual</i>
1	<i>Engine Owner's Manual</i>
1	Registration Card
1	Operator training material
2	Key

Procedure

At delivery, complete the items listed in the following table and initial each when finished.

Model No. _____ Serial No. _____

Dealer Initial	Customer Initial	Check Procedure
		<p>Show the customer where the following features are located and how they function:</p> <p>Fuel tank caps</p> <p>Oil fill cap/ Oil dipstick</p> <p>Engine oil filter</p> <p>Engine oil drain</p> <p>Fuel filters</p> <p>Air filter</p> <p>Hydraulic fluid reservoir</p> <p>Hydraulic filter</p> <p>Battery</p> <p>Ignition switch</p> <p>Throttle lever</p> <p>Power take off switch (PTO)</p> <p>Motion control levers</p> <p>Parking brake</p> <p>Mower height-of-cut</p> <p>Adjustable seat</p> <p>Hydraulic bypass valves</p> <p>Rollover Protection System (ROPS)</p> <p>Mower deck flow baffle</p>
		Refer to the <i>Operator's Manual</i> to point out safety procedures, operation, and maintenance procedures.
		Review the warranty statement as shown in the <i>Operator's Manual</i> .
		Describe the post sale service procedures for your store.
		Assist the customer in filling out and mailing the registration card or register online at www.Toro.com
		Make sure that the customer receives the <i>Operator's Manual</i> , <i>Engine Owner's Manual</i> , <i>Set Up Instructions</i> , and operator training material.
		Make sure the customer knows the <i>Parts Catalog</i> is available at www.Toro.com .
		Assist the customer in loading the mower.

Note: When you, the dealer representative, have finished delivering the machine to the customer, sign and date in the space provide below and keep a copy of this page for dealer records.

Signature: _____ **Date:** _____

Signature: _____ **Date:** _____

Notes:



Count on it.