



Replacement Accumulator Kit

Hydroject 3010

Model No. 114-4101

Installation Instructions

Safety

Important: Read and understand the following warnings before attempting to charge or replace a service accumulator.



Charged accumulators contain high pressure nitrogen. Installing improper gases in an accumulator or failing to open the bleed valve before servicing high pressure water components can cause an explosion, dismemberment, or death. Charging requires special tools and precautions.

- Only use nitrogen for accumulator charging.
- Charge accumulators in a well ventilated area.
- Wear eye protection.
- Keep hands and face away from gas valve.
- Slowly open the high pressure water bleed valve before servicing any component connected to the high pressure water system. Opening the high pressure bleed valve allows any trapped water to escape from the system and also allows the accumulator piston to move to the bottom of the accumulator cylinder.
- Do not ship accumulator via air freight.

Safety and Instructional Decals



Safety decals and instructions are easily visible to the operator and are located near any area of potential danger. Replace any decal that is damaged or lost.



108-1316



80-8880

Installation

Replacing the Accumulator

1. Park the aerator on a level surface, engage the parking brake, move the throttle control to SLOW, turn the ignition key to OFF and remove the key.
2. Slowly open the high pressure bleed valve (Figure 1) allowing any pressurized water to escape from the pump, valve and accumulator. Make sure the accumulator is completely discharged.
3. Loosen and remove the 4 bolts securing the accumulator to the main valve (Figure 1).

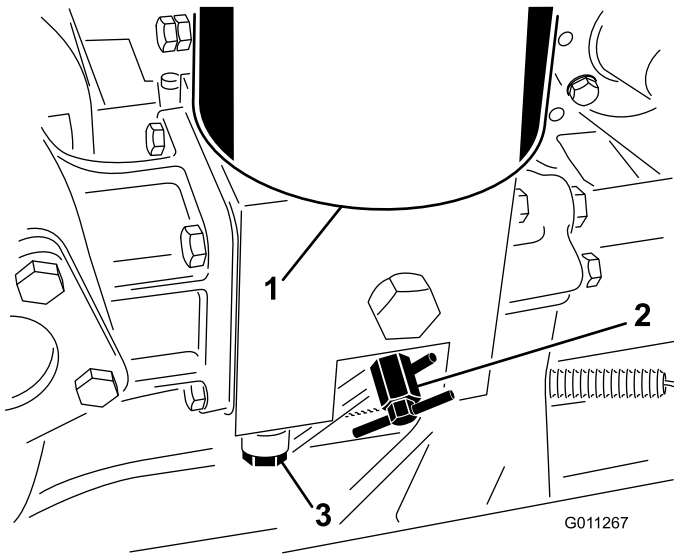

Figure 1

1. Accumulator
2. Bleed valve
3. Mounting bolt

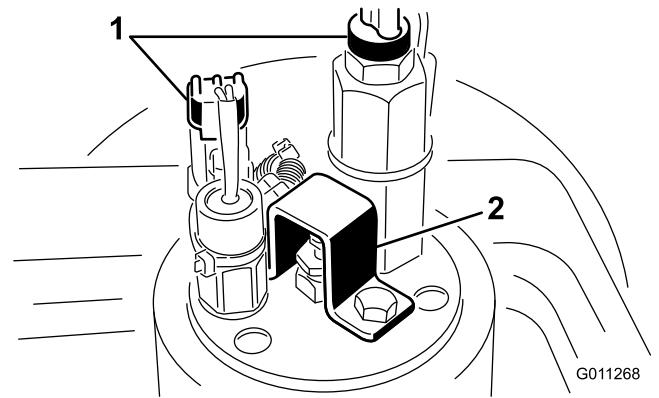

Figure 2

1. Sensor connectors
2. Gas valve guard

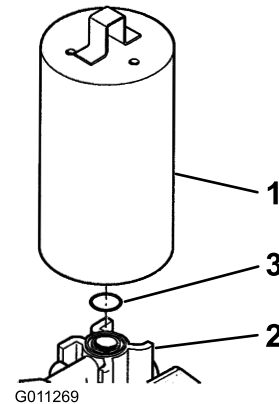

Figure 3

1. Accumulator
2. Valve
3. O-ring

4. Remove the cable ties securing the pressure sensor wires to the side of the accumulator. Unplug the connectors from the pressure sensors on top of the accumulator (Figure 2).
5. Remove the accumulator from the valve. Discard the old accumulator base O-ring seal (Figure 3).

6. Install the new O-ring seal (included) into the groove in the top of the main valve body and carefully lower the new accumulator onto the seal. The accumulator has 2 sets of decals on it and a rectangular mounting hole pattern. Make sure that the decals are facing forward and rearward when mounting the accumulator to the valve and that the decals are securely attached and legible.
7. Mount the accumulator to the valve with 4 new bolts (included). Torque the bolts evenly to 40 ft.-lb. (55 N-m). Plug the wire connectors onto the sensors.
8. Have the accumulator charged by a authorized Toro Distributor.