

Transport Seat Strap Kit for Zero-Turn-Radius Riding Mower

Model No. 117-7251

Installation Instructions

Installation

Loose Parts

Use the chart below to verify that all parts have been shipped.

Description	Qty.	Use
Seat retaining strap	2	Install the transport seat strap.
Bolt (5/16 x 1 inch)	2	
Lock nut (5/16 inch)	2	
Washer	2	
Bolt (1/4 x 2 inch)	2	
Jam nut (1/4 inch)	4	

Note: Determine the left and right sides of the machine from the normal operating position.

Installing the Transport Seat Strap

1. Make sure the motion control levers are locked in the neutral lock position. Lift the seat forward.
2. Remove the rubber caps in the holes at the rear of the seat pan.
3. Install to the strap to the same hole in the rear of the seat pan as shown in Figure 1. Use a bolt (5/16 x 1 inch), washer and lock nut (5/16 inch) to secure the strap to the seat pan. Repeat this step for the opposite side.

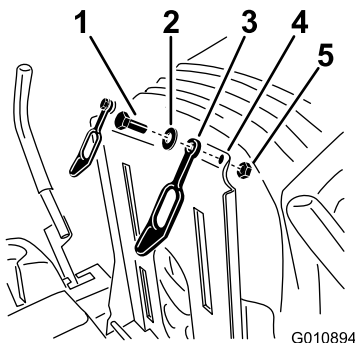

Figure 1

- | | |
|-------------------------|-------------------------------------|
| 1. Bolt (5/16 x 1 inch) | 4. Hole in the rear of the seat pan |
| 2. Washer | 5. Lock nut (5/16 inch) |
| 3. Strap | |

4. Locate the two bolts (1/4 x 2 inch) and four jam nuts (1/4 inch) in loose parts. Assemble a jam nut to each bolt as shown in Figure 2

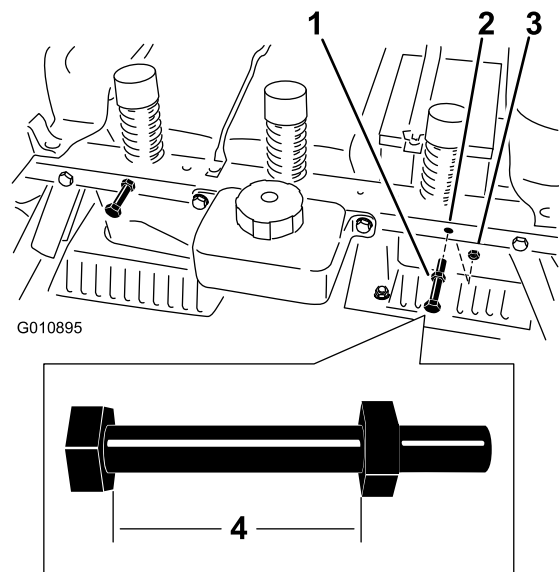

Figure 2

- | | |
|------------------------------|------------------------|
| 1. Bolt and jam nut assembly | 3. Jam nut |
| 2. Hole in the seat frame | 4. 1.33 inches (34 mm) |

5. Install the bolt and jam nut assembly to the holes in the seat frame (Figure 3). Secure it with another jam nut (1/4 inch).

Operation

Securing the Seat

Lower the seat and stretch the strap over the installed bolt and jam nut assembly.

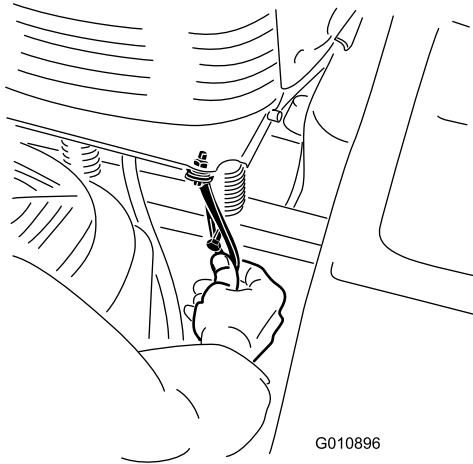

Figure 3