



Rear Lift Kit

for Workman MD/MDX Utility Vehicle

Model No. 07334

Installation Instructions

Safety

Safety and Instructional Decals



Safety decals and instructions are easily visible to the operator and are located near any area of potential danger. Replace any decal that is damaged or lost.



115-7748

1. Warning; crushing hazard of hand or foot—keep bystanders a safe distance from the machine.

Installation

Loose Parts

Use the chart below to verify that all parts have been shipped.

Procedure	Description	Qty.	Use
1	No parts required	–	Prepare the machine
2	Rear lift frame assembly Bolt (3/8 x 1 inch) Flange nut (3/8 inch) Electric actuator assembly Clevis pin, short (MD only) Actuator plate, left (MDX only) Actuator plate, right (MDX only) Bolt (1/2 x 1 inch) (MDX only) Lock nut (1/2 inch) (MDX only) Clevis pin, long (MDX only) Spacer (MDX only) Hair pin	1 4 6 1 1 1 1 2 2 1 2 1	Install the rear lift kit.
3	Switch Fuse, 15A Cable tie	1 1 2	Install the electrical components

1

Preparing the Machine

No Parts Required

Procedure

Note: If a Bed Lift Kit is installed on your vehicle, a Rear Lift Wire Harness Kit, Part No. 115-7823 must be obtained and installed to operate the Rear Lift Kit.

Position the machine on a level surface. Set the parking brake, turn the ignition off, and remove the key.



If you leave the key in the ignition switch, someone could accidentally start the engine and seriously injure you or other bystanders.

Remove the key from the ignition switch before you do any maintenance.

2

Installing the Rear Lift Kit

Parts needed for this procedure:

1	Rear lift frame assembly
4	Bolt (3/8 x 1 inch)
6	Flange nut (3/8 inch)
1	Electric actuator assembly
1	Clevis pin, short (MD only)
1	Actuator plate, left (MDX only)
1	Actuator plate, right (MDX only)
2	Bolt (1/2 x 1 inch) (MDX only)
2	Lock nut (1/2 inch) (MDX only)
1	Clevis pin, long (MDX only)
2	Spacer (MDX only)
1	Hair pin

Installing on the Rear Lift on MD Vehicles

For information on installing the rear lift on MDX vehicles move the next section.

1. Align the holes in the rear lift frame with the holes in the rear and bottom of the vehicle swing arm frame as shown in Figure 1.

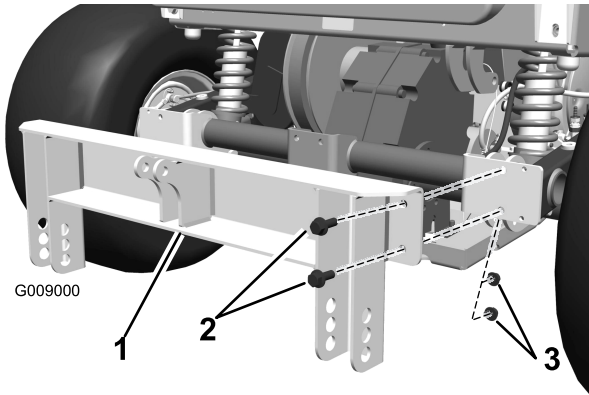

Figure 1

1. Rear lift frame
2. Bolt (3/8 x 1 inch)
3. Flange nut (3/8 inch)

2. Secure the rear lift frame to the rear of the vehicle swing arm frame with four bolts (3/8 x 1 inch) and four flange nuts (3/8 inch) (Figure 1).
3. Secure the actuator to the lift with the clevis pin and hairpin cotter (Figure 2). Position the actuator as shown in Figure 2.

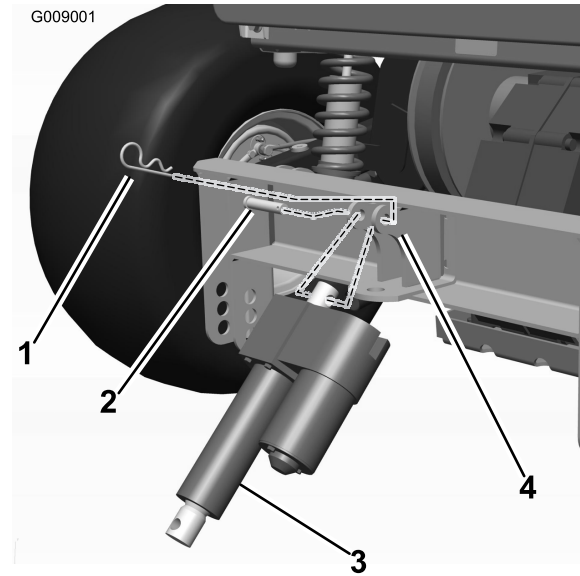

Figure 2

1. Hair pin
2. Clevis pin
3. Electric actuator
4. Rear lift frame

Installing on the Rear Lift on MDX Vehicles

For information on installing the rear lift on MD vehicles refer to the last section.

1. Align the holes in the rear lift frame with the holes in the rear and bottom of the vehicle swing arm frame as shown in Figure 3.

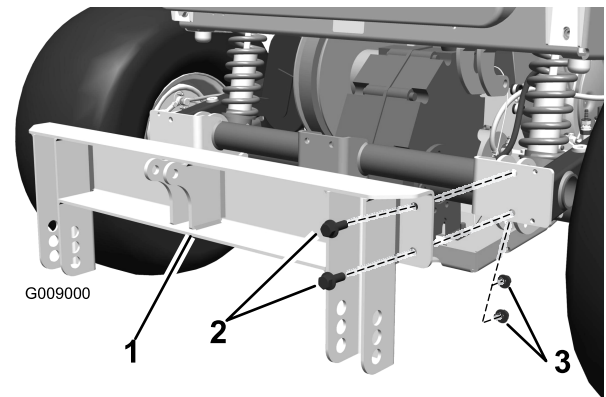

Figure 3

1. Rear lift frame
2. Bolt (3/8 x 1 inch)
3. Flange nut (3/8 inch)

- Secure the rear lift frame to the rear of the vehicle swing arm frame with four bolts (3/8 x 1 inch) and four flange nuts (3/8 inch) (Figure 1).
- Install the left and right actuator plates to the rear lift frame as shown in Figure 4. Secure the plates to the frame with two bolts (1/2 x 1 inch) and two lock nuts (1/2 inch). Torque the fasteners to 75 ft-lb (101 N-m).

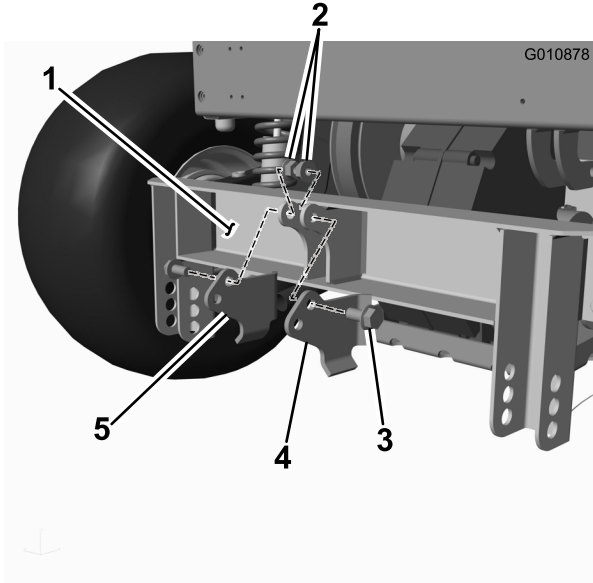

Figure 4

- | | |
|------------------------|-------------------------|
| 1. Rear lift frame | 4. Right actuator plate |
| 2. Lock nut (1/2 inch) | 5. Left actuator plate |
| 3. Bolt (1/2 x 1 inch) | |

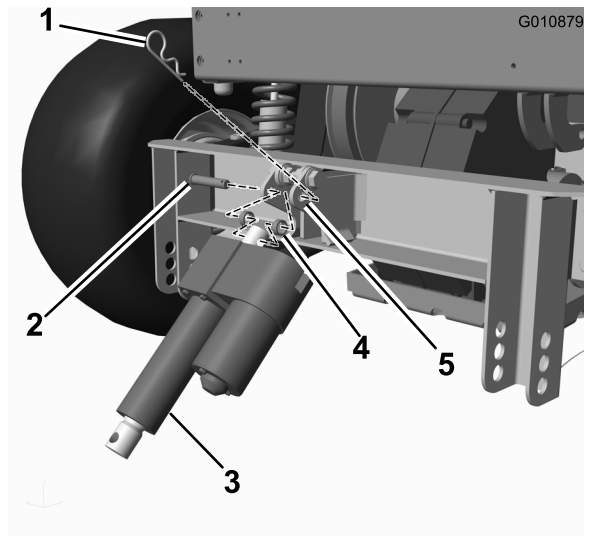

Figure 5

- | | |
|----------------------|--------------------|
| 1. Hair pin | 4. Spacer |
| 2. Clevis pin | 5. Rear lift frame |
| 3. Electric actuator | |

3

Installing the Electrical Components

Parts needed for this procedure:

1	Switch
1	Fuse, 15A
2	Cable tie

Procedure

- Remove the plug from the hole in the right side of the dash (Figure 6).

Note: If the hole in the dash is in use, measure over 1/2 in. (13 mm) and cut another .835 in. x 1.46 in. (21 mm x 38 mm) rectangular hole in the dash. **Make sure not to damage any existing components behind the dash when cutting the hole.**

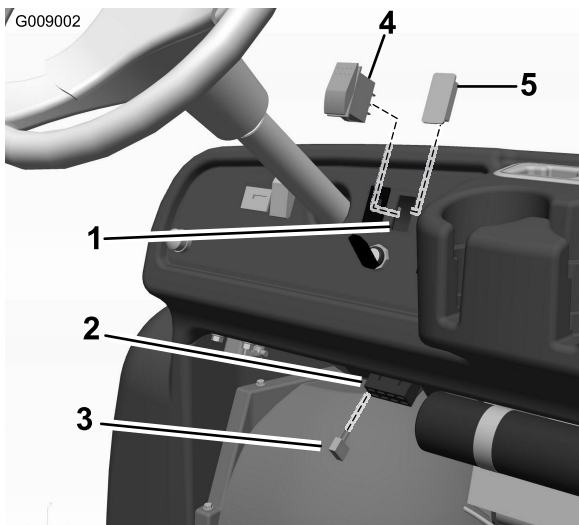

Figure 6

- | | |
|-----------------------------|-------------------|
| 1. Hole, right side of dash | 4. Switch |
| 2. Fuse block, existing | 5. Plug, existing |
| 3. Fuse, 15A | |

-
2. If a Bed Lift Kit is installed on your vehicle, obtain a Rear Lift Wire Harness kit, Part No. 115-7823, and install it according to the kit installation instructions before proceeding.
 3. Insert the switch into the open hole in the dash and the fuse into the open slot in the fuse block (Figure 6).
 4. Plug the main vehicle harness connector in to the back of the switch.
 5. Route the actuator wire harness under the rear lift frame assembly and under the vehicle bed frame to the vehicle harness connector near the electric control cover located on the right, rear portion of the vehicle frame.

Important: Do not route the harness between the vehicle and rear lift frame, as it may get pinched during operation.

6. Plug the harness connector into the vehicle harness connector.
7. Secure the harness to the vehicle with a wire tie.

Notes:

Notes:



Count on it.