



Roll-Over Protection Kit

Groundsmaster 7200 Series Traction Unit

Model No. 117-9179

Form No. 3362-791 Rev A

Installation Instructions

1. Rivet a leaf spring onto the front of each ROPS post (Figure 1).

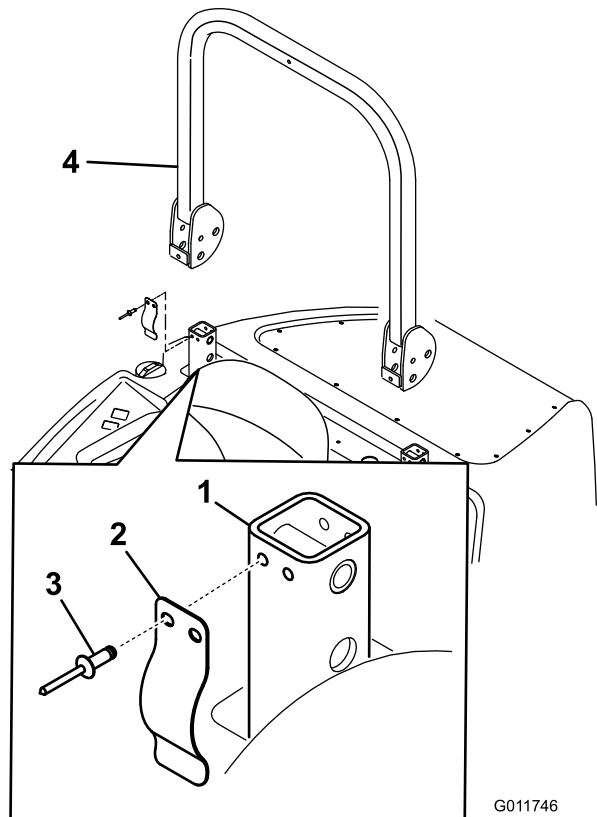

Figure 1

- | | |
|----------------|------------------|
| 1. ROPS post | 3. Rivet (2) |
| 2. Leaf spring | 4. ROPS assembly |

2. Lower the ROPS assembly onto the ROPS posts, positioning as shown in Figure 1.

3. Install the bolt, nut, hair pin cotter and pin securing each ROPS assembly to the ROPS posts (Figure 2). Torque the nut and bolt to 67 to 83 ft-lb (91 to 113 N-m).

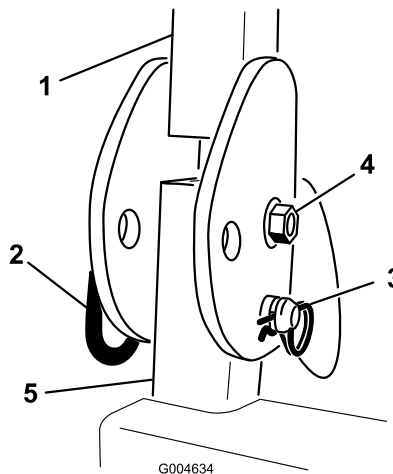

Figure 2

- | | |
|---------------|---------------|
| 1. ROPS | 4. Bolt & nut |
| 2. Pin | 5. ROPS post |
| 3. Cotter pin | |

4. To lower the roll bar, remove the hairpin cottes, push the roll bar forward against the springs, and remove the two pins (Figure 3).

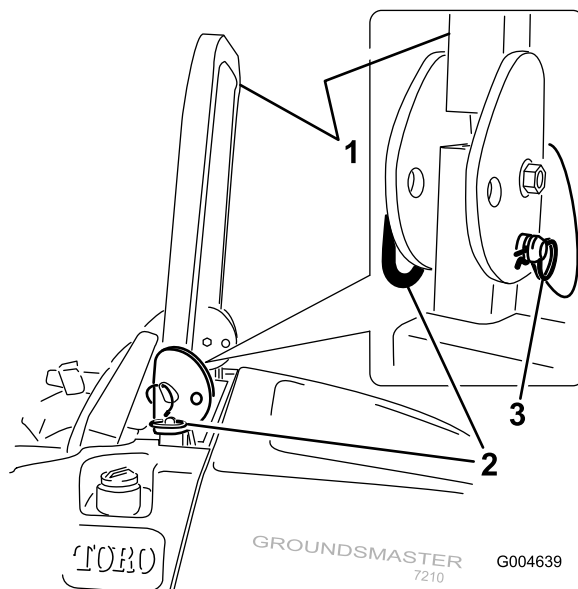

Figure 3

- | | |
|-------------|-------------------|
| 1. Roll bar | 3. Hairpin cotter |
| 2. Pin | |

5. Lower the roll bar to the down position (Figure 4).

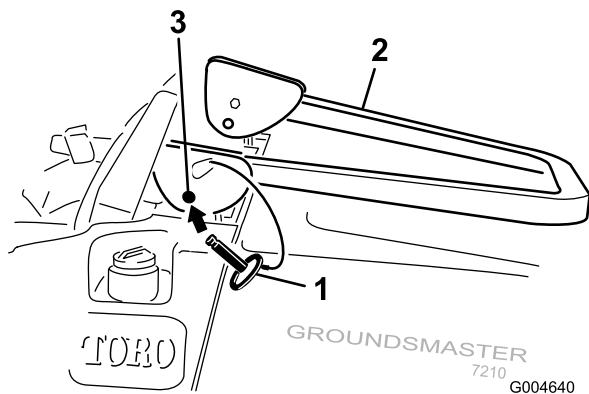

Figure 4

1. Pin
2. Roll bar
3. Mounting hole

6. Install the two pins and secure them with the hairpin cotter pins (Figure 3).
7. To raise the roll bar, remove the hairpin cotter pins and remove the two pins (Figure 3).

Important: Ensure that the rear part of the seat is secured with the seat latch.

8. Raise the roll bar to the upright position and install the two pins and secure them with the hairpin cotter pins (Figure 3).

Important: Always use the seat belt when the roll bar is in the raised and locked position. Do not use the seat belt when the roll bar is in the lowered position.

Operation

Using the Rollover Protection System (ROPS)

⚠ WARNING

To avoid injury or death from rollover: keep the roll bar in the raised locked position and use the seat belt.

Ensure that the rear part of the seat is secured with the seat latch.

⚠ WARNING

There is no rollover protection when the roll bar is in the down position.

- Lower the roll bar only when absolutely necessary.
- Do not wear the seat belt when the roll bar is in the down position.
- Drive slowly and carefully.
- Raise the roll bar as soon as clearance permits.
- Check carefully for overhead clearances (i.e. branches, doorways, electrical wires) before driving under any objects and do not contact them.

Important: Always use the seat belt when the roll bar is in the raised and locked position. Do not use the seat belt when the roll bar is in the lowered position.