



Bagging Blade Kit

DH Series Lawn Tractors, 2003 and After

Model No. 106-8559

Form No. 3329-388 Rev A

Installation Instructions

Removing the Blades

No Parts Required



The blade is sharp; contacting the blade can result in serious personal injury.

Wear cloth or leather gloves when servicing the blade.

1. Remove the mower from the tractor; refer to Removing the Mower in the *Operator's Manual*.
2. Carefully tip the mower over.
3. Remove the blades and all blade mounting hardware. Wedge a block of wood between each blade and the mower to lock the blade while you are removing each blade bolt.

Note: The right blade is held by a left-hand threaded bolt.

4. Inspect all parts and replace any that are worn or damaged.
5. Keep the spacers and washers with the existing blades.
6. Use the keys, shear pins, and blade bolts for installing the bagging blades.

Installing the Bagging Blades

Parts needed for this procedure:

2	Spacer (Part No. 106-6531)
1	Right bagging blade (Part No. 105-8560)
1	Left bagging blade (Part No. 105-8561)

Important: The new spacers are slightly thicker than the existing spacers and are to be used only with the bagging blades.

1. Install the keys, new spacers, shear pins, bagging blades, new blade stiffeners, new washers, and blade bolts (Figure 1).

Note: Install the bagging blades 90° apart to prevent them from contacting each other.

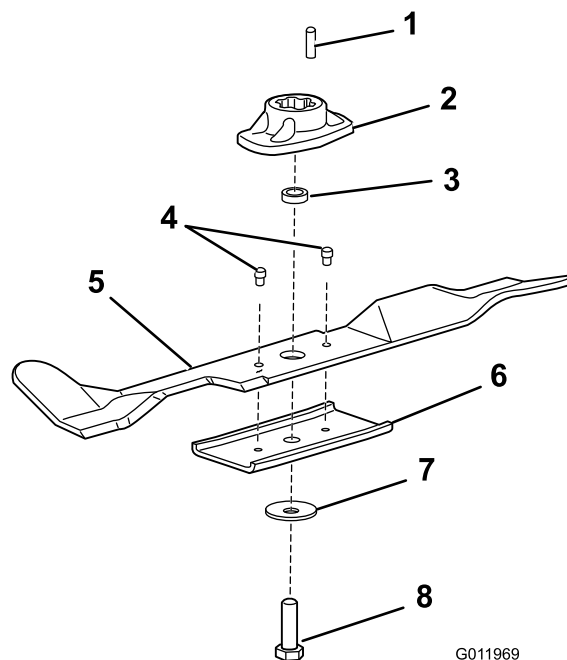

Figure 1

G011969

1. Key
 2. Blade driver
 3. Spacer
 4. Shear pins
 5. Blade
 6. Blade stiffener
 7. Washer
 8. Blade bolt
2. Use a torque wrench to tighten the blade bolt to 37 ft-lb (50 N-m).
 3. Install the mower onto the tractor; refer to Installing the Mower in the *Operator's Manual*.

Note: You should leave the recycling door on the housing. The recycling performance using the bagging blades may decrease because the blades carry more grass in the housing.