



Count on it.

Form No. 3363-851 Rev A

Operator's Manual

38in Twin Bagger

for XL Series Lawn Tractors

Model No. 79103—Serial No. 310000001 and Up



Introduction

Read this information carefully to learn how to operate and maintain your product properly and to avoid injury and product damage. You are responsible for operating the product properly and safely.

You may contact Toro directly at www.Toro.com for product and accessory information, help finding a dealer, or to register your product.

Whenever you need service, genuine Toro parts, or additional information, contact an Authorized Service Dealer or Toro Customer Service and have the model and serial numbers of your product ready. (Figure 1) illustrates the location of the model and serial numbers on the product.

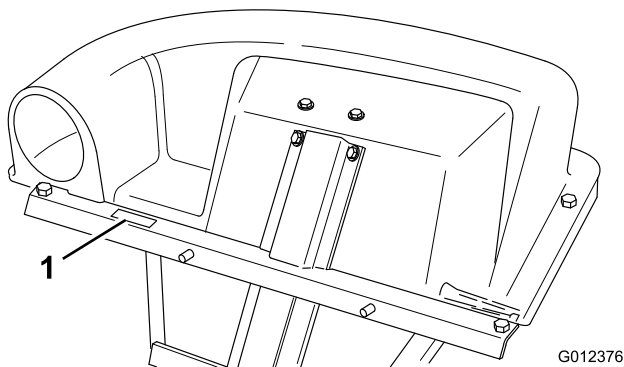

Figure 1

1. Location of the model and serial numbers

Write the numbers in the space provided below:

Model No.	_____
Serial No.	_____

This manual identifies potential hazards and has safety messages identified by the safety alert symbol (Figure 2), which signals a hazard that may cause serious injury or death if you do not follow the recommended precautions.



Figure 2

1. Safety alert symbol

This manual uses 2 words to highlight information. **Important** calls attention to special mechanical

information and **Note** emphasizes general information worthy of special attention.

Contents

Introduction.....	2
Safety	3
Safety and Instructional Decals	3
Setup.....	4
1 Installing the Grass Catcher	5
2 Removing the Grass Catcher	7
Operation.....	8
Emptying the Grass Bags.....	8
Clearing Obstructions from the Grass	
Catcher.....	8
Operating and Bagging Tips	8
Maintenance.....	10
Inspecting the Grass Catcher	10
Inspecting the Mower Blades	10
Caring for the Grass Bags	10
Cleaning the Grass Catcher.....	10
Storage.....	11

Safety

Improper use or maintenance by the operator or owner can result in injury. To reduce the potential for injury, comply with these safety instructions and those in the traction unit *Operator's Manual*. Always pay attention to the safety alert symbol, which means *Caution*, *Warning*, or *Danger*—personal safety instruction. Failure to comply with the instruction may result in personal injury or death.

Safety and Instructional Decals



Safety decals and instructions are easily visible to the operator and are located near any area of potential danger. Replace any decal that is damaged or lost.

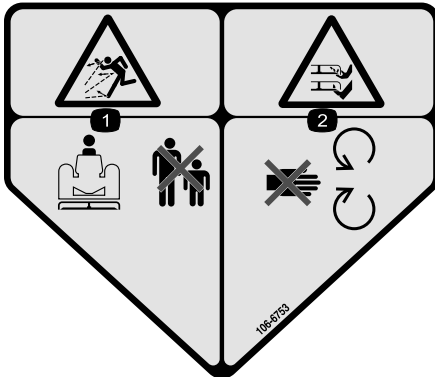

106-6753

1. Thrown object hazard—keep bystanders a safe distance from the machine.
2. Cutting/dismemberment hazard of hand or foot, mower blade—stay away from moving parts.

Setup

Loose Parts

Use the chart below to verify that all parts have been shipped.

Procedure	Description	Qty.	Use
1	Upper mounting bracket	1	Prepare the mower.
	Bolt (5/16 x 1 inch)	8	
	Locknut (5/16 inch)	8	
	Lower extension bracket	1	
	Locknut (5/16 inch)	2	
	Hitch pin	1	
	Bolt (5/16 x 3/4 inch)	1	
	Mounting frame	1	
	Backup plate	1	
	Grass catcher cover	1	
	Washer (5/16 inch)	4	
	Bolt (3/8 x 1 inch)	2	
	Washer (3/8 inch)	2	
	Locknut (3/8 inch)	2	
	Hairpin cotter	2	
	Chute	1	
	Discharge tube	1	
	Locking pin	1	
	Grass bag	2	
2	No parts required	–	Remove the grass catcher.

1

Installing the Grass Catcher

Parts needed for this procedure:

1	Upper mounting bracket
8	Bolt (5/16 x 1 inch)
8	Locknut (5/16 inch)
1	Lower extension bracket
2	Locknut (5/16 inch)
1	Hitch pin
1	Bolt (5/16 x 3/4 inch)
1	Mounting frame
1	Backup plate
1	Grass catcher cover
4	Washer (5/16 inch)
2	Bolt (3/8 x 1 inch)
2	Washer (3/8 inch)
2	Locknut (3/8 inch)
2	Hairpin cotter
1	Chute
1	Discharge tube
1	Locking pin
2	Grass bag

Installing the Upper Mounting Bracket

Install the upper mounting bracket to the rear of the tractor using 2 bolts (5/16 x 1 inch) and 2 locknuts (5/16 inch—18) (Figure 3).

Note: Use the left-most set of holes in the bracket as you are looking at the rear of the tractor.

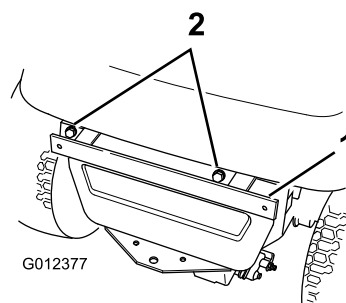

Figure 3

1. Upper mounting bracket
2. Bolts (5/16 x 1 inch)

Installing the Lower Extension Bracket

1. Slide the lower extension bracket onto the mounting pin of the mounting frame (Figure 4).

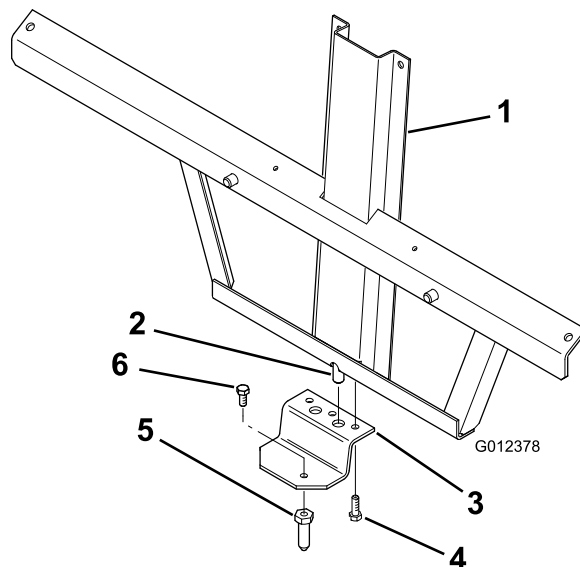

Figure 4

1. Mounting frame
2. Mounting pin
3. Alignment hole
4. Lower extension bracket
5. Bolt (5/16 x 1 inch)
6. Hitch pin
7. Bolt (5/16 x 3/4 inch)

2. Secure the lower extension bracket to the mounting frame using 2 bolts (5/16 x 1 inch) and 2 locknuts (5/16 inch) (Figure 4).
3. Secure the hitch pin in the hole in the lower extension bracket using a bolt (5/16 x 3/4 inch) (Figure 4).

Installing the Mounting Frame

1. Secure the top of the mounting frame to the grass catcher cover using the backup plate, 4 bolts (5/16 x 1 inch), 4 washers (5/16 inch), and 4 locknuts (5/16 inch) (Figure 5).

Note: The washers should be installed against the cover on the outside and the backup plate against the cover on the inside.

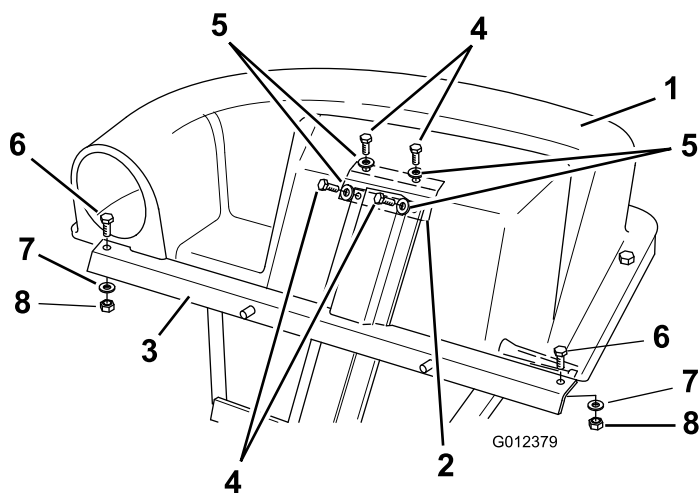

Figure 5

- | | |
|------------------------------------|-------------------------|
| 1. Grass catcher cover | 5. Washer (5/16 inch) |
| 2. Backup plate (inside the cover) | 6. Bolts (3/8 x 1 inch) |
| 3. Mounting frame | 7. Washer (3/8 inch) |
| 4. Bolt (5/16 x 1 inch) | 8. Locknut (3/8 inch) |

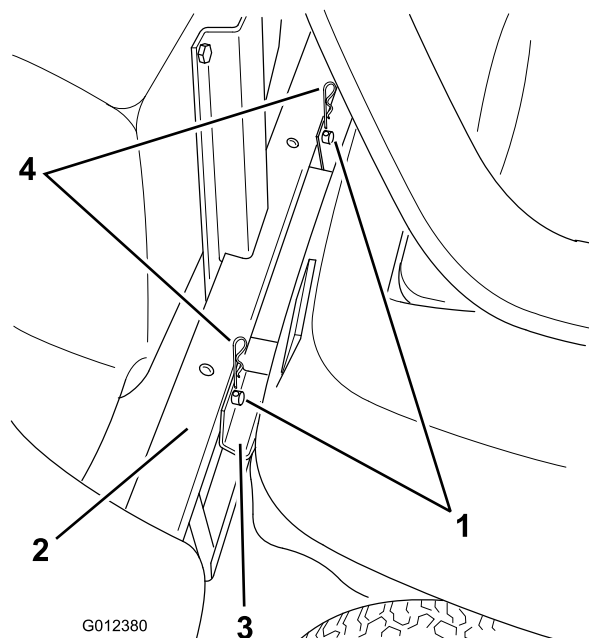

Figure 6

- | | |
|-------------------|---------------------------|
| 1. Mounting pin | 3. Upper mounting bracket |
| 2. Mounting frame | 4. Hairpin cotter |

- Secure the mounting frame with the 2 bolts (3/8 x 1 inch), 2 washers (3/8 inch), and 2 locknuts (3/8 inch) (Figure 5).
- Tighten all fasteners that secure the mounting frame.

Attaching the Grass Catcher to the Tractor

- Insert the hitch pin on the grass catcher into the mounting hole in the tractor hitch.
- Rotate the grass catcher up so that the pins on the mounting frame slide through the holes in the upper mounting bracket on the tractor (Figure 6).

Assembling and Installing the Chute and Discharge Tube

- Lift the mower deflector and remove the mulch plug, if present (Figure 7).

Figure 7

- | | |
|----------------|--------------------|
| 1. Chute | 4. Deflector rod |
| 2. Locking pin | 5. Flexible latch |
| 3. Rear hook | 6. Notched bracket |

- Slide the chute into position with the rear hook around the deflector rod and the front latch aligned, and insert the locking pin (Figure 7).
- Hook the flexible latch on the chute into the notched bracket on the back of the mower (Figure 7).
- Slide the discharge tube into the opening in the grass catcher (Figure 8).

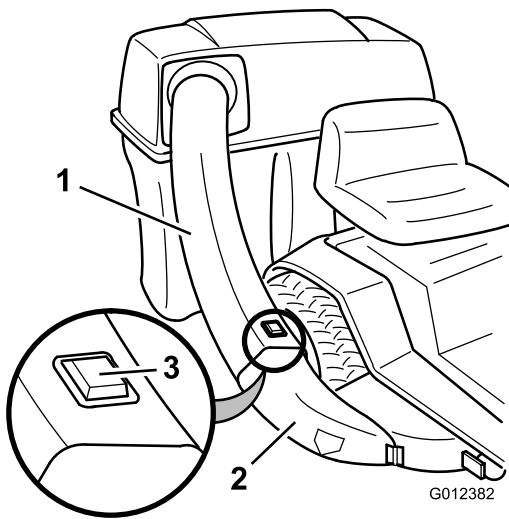

Figure 8

1. Discharge tube
2. Chute
3. Tab

5. Slide the discharge tube over the end of the chute, ensuring that the tab on the chute snaps into the square hole in the discharge tube (Figure 8).

Installing the Grass Bags

1. Slide the grass bag under the grass catcher cover and position the front edge of the bag rod into the screen support bracket on the bag frame (Figure 9).

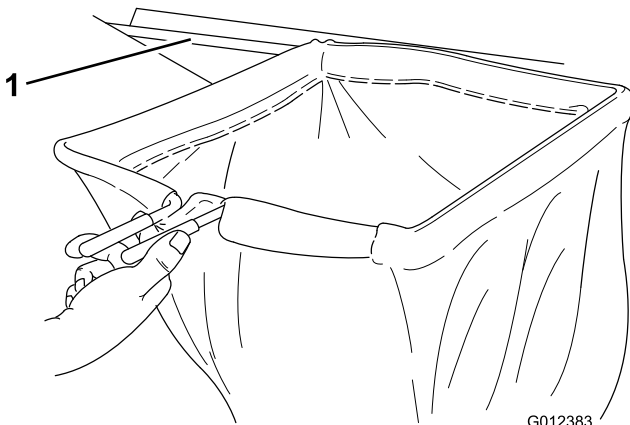

Figure 9

1. Screen support bracket

2. Lift the rear of the bag up to the grass catcher cover. Squeeze the bag handles and allow them to snap into the bag frame brackets (Figure 10).

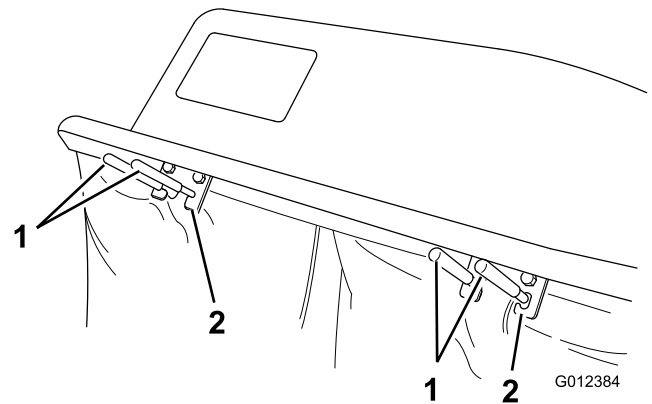

Figure 10

1. Bag handle
2. Bag frame bracket

3. Repeat steps 1 and 2 for the other bag.

2

Removing the Grass Catcher

No Parts Required

Procedure

⚠ DANGER

Operating the tractor and mower with the discharge tube removed exposes you and others to thrown debris and blade contact, potentially causing severe injury or death.

Always operate the mower with the complete grass catcher mounted in place or use the mower to side discharge, ensuring that the spring-loaded grass deflector is in the down position.

1. Push on the tab on the chute and pull the discharge tube free from the chute and grass catcher (Figure 8).
2. Release the flexible latch and remove the locking pin that secures the chute to the mower (Figure 7).
3. Pull the chute out of the mower (Figure 7).
4. Remove the hairpin cotters that secure the grass basket to the upper mounting bracket on the mower (Figure 6).
5. Rock the grass basket backward, then pull it free of the mower hitch.
6. Store all grass catcher parts in a convenient place.

Operation

⚠ CAUTION

To avoid personal injury, do the following:

- Become familiar with all operating and safety instructions in the *Operator's Manual* for your tractor and mower before using the attachment.
- Do not remove the discharge tube, bags, bagger top, or the blower while the engine is running.
- Always shut the engine off before clearing an obstruction from the vacuum bagging system.
- Do not perform maintenance or repairs while the engine is running.

Emptying the Grass Bags

Be careful when lifting or handling a grass bag that is full. To empty the grass bags, do the following steps:

1. Stop the tractor, set the parking brake, and disengage the power take-off (PTO) by pushing the PTO control to the Off position.

Note: This stops the mower blades.

2. Stop the engine and wait for all moving parts to stop before leaving the operating position.
3. Squeeze the bag handles and swing it down from the bag frame bracket.
4. Compress the debris into the bags. Use both hands to pull the bag out from under the grass catcher cover.
5. Empty the grass bag.
6. Repeat steps 4 and 5 for the other bag.
7. Slide the grass bag under the grass catcher cover and position the front edge of the bag rod into the screen support bracket on the bag frame (Figure 9).
8. Lift the rear of the bag up to the grass catcher cover. Squeeze the bag handles and allow them to snap into the bag frame brackets (Figure 10).
9. Repeat steps 7 and 8 for the other bag.

Clearing Obstructions from the Grass Catcher

1. Stop the tractor, set the parking brake, and disengage the power take-off (PTO) by pushing the PTO control to the Off position.

Note: This stops the mower blades.

2. Stop the engine and wait for all moving parts to stop before leaving the operating position.

3. Check the grass bags and empty them if they are full.
4. Remove and separate the discharge tube and chute from the grass catcher cover and mower.

Note: Use a stick to carefully remove and clear the obstruction from the mower, discharge tube, chute, and the grass catcher cover.

5. After removing the obstruction, install the grass catcher and resume operation.

Operating and Bagging Tips

Size

Remember that the tractor is longer and wider with the attachment installed. By turning too sharply in confined places, you may damage the attachment.

Trimming

Always trim with the left side of the mower. Do not trim with the right side of the mower because you could damage the grass catcher's chute and discharge tube.

Cutting Height

Do not set the mower cutting height too low because long grass surrounding the mower can prevent air from getting under the mower and entering the grass catcher. If enough air doesn't get under the mower, the grass catcher will plug.

Cutting Frequency

Cut the grass often, especially when it grows rapidly. you will have to cut your grass twice if it gets excessively long. Refer to Bagging Long Grass.

Cutting Technique

For the best lawn appearance, slightly overlap the mower into the previously cut area. This reduces the load on the engine and the chance of plugging the grass catcher.

Using Bags

Although they are not required, bags may be inserted into each cloth grass bag as a liner to collect clippings and make disposal more convenient (Figure 11). If you use a bag liner, remove the filled grass bag and close the top of the liner. Then pull the liner out the grass bag or turn the bag upside down while holding the handle on the bottom of the grass bag (this allows the liner to slide out).

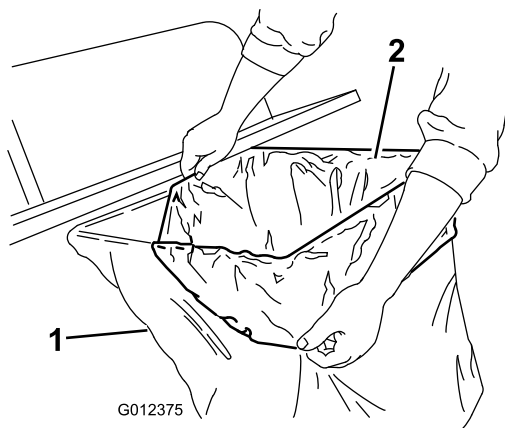

Figure 11

1. Cloth grass bag 2. Bag (liner)

Bagging Wet Grass

Always try to cut grass when it is dry for a neat lawn appearance. If you must cut wet grass, use the conventional side discharge feature of the mower. Several hours later, when the clippings are dry, install the complete catcher and vacuum up the grass clippings.

Signs of Plugging

As you are bagging, a small amount of grass clippings normally blow out the front of the mower. An excessive amount of clipping blow-out indicates that the bags are full or the system is plugged.

Bagging Speed

Most often you will bag with the tractor throttle in the Fast position and drive in first gear, which is the slowest ground speed. However, in extremely dry and dusty grass, you may want to slightly reduce the throttle speed and shift the gear sector to a higher gear to maintain the ground speed of the tractor. The grass catcher may plug if you drive too fast, causing the engine to slow down with the extra work load.

⚠ CAUTION

As the grass bags fill, extra weight is added to the back of the tractor. If you stop and start suddenly on hills, you may lose control of the steering or the tractor may tip over.

- Do not start or stop suddenly when going uphill or downhill.
- Avoid uphill starts.
- If you do stop the tractor when going uphill, disengage the PTO by pushing the PTO control to the Off position, then back down the hill using slow reverse speed.

Do not change seeds or stop on slopes.

Bagging Long Grass

Excessively long grass is heavy and may not be propelled completely into the grass bags. If this happens, the discharge tube may plug. To avoid plugging the grass catcher, mow the grass at a high height-of-cut, then lower the mower to your normal cutting height and repeat the bagging process.

Maintenance

Inspecting the Grass Catcher

Service Interval: After the first 10 hours

Monthly

1. Check the discharge tube, chute, and the grass catcher cover; replace these parts if they are cracked or broken.
2. Tighten all nuts, bolts, and screws.
3. Inspect the grass bags for deterioration.

⚠ DANGER

The grass bag material may tear, wear, and eventually deteriorate, which could allow flying debris or thrown objects to pass through the bags and cause severe injury to you or bystanders.

Frequently inspect the grass bags for holes, rips, wear, and other deterioration. Do not wash the grass bags. If the bag has deteriorated, install new grass bags supplied by the manufacturer of this grass catcher attachment.

underside of the mower, and wash them using water sprayed from a garden hose. Use a mild automotive detergent to remove stubborn dirt.

Important: Do not wash the grass bags. Washing can cause the bags to deteriorate faster.

2. Ensure that you remove matted grass from all parts.
3. After washing, let all parts dry thoroughly.

Inspecting the Mower Blades

1. Inspect the mower blades regularly and whenever a blade strikes a foreign object.
2. If blades are badly worn or damaged, install new blades. Refer to your tractor or the mower *Operator's Manual* for blade maintenance.

Caring for the Grass Bags

Important: Do not wash the grass bags.

To prevent rapid deterioration of the bag material, store the bags so that they dry completely after each use.

⚠ CAUTION

If you store grass clippings in the grass basket, under the right conditions, spontaneous combustion (a fire-generating process that occurs with an external source of ignition) could occur, potentially damaging property and/or injuring you or others.

The grass basket is not a storage container. Do not store grass clippings and debris in the grass basket.

Cleaning the Grass Catcher

1. After each use, remove the inside and outside of the grass catcher cover, discharge tube, chute, and the

Storage

1. Clean the grass catcher; refer to Cleaning the Grass Catcher.
2. Inspect the grass catcher for damage; refer to Inspecting the Grass Catcher.
3. Ensure that the grass bags are empty and thoroughly dry.
4. Store the grass catcher in a clean, dry place, out of direct sunlight to protect the plastic parts and extend the life of the bagger.

Note: If you must store the grass catcher outside, cover it with a weatherproof cover.

Notes:

Notes:

Notes:

International Distributor List

Distributor:	Country:	Phone Number:
Atlantis Su ve Sulama Sistemleri Lt	Turkey	90 216 344 86 74
Balama Prima Engineering Equip.	Hong Kong	852 2155 2163
B-Ray Corporation	Korea	82 32 551 2076
Casco Sales Company	Puerto Rico	787 788 8383
Ceres S.A.	Costa Rica	506 239 1138
CSSC Turf Equipment (pvt) Ltd.	Sri Lanka	94 11 2746100
Cyril Johnston & Co.	Northern Ireland	44 2890 813 121
Equivier	Mexico	52 55 539 95444
Femco S.A.	Guatemala	502 442 3277
G.Y.K. Company Ltd.	Japan	81 726 325 861
Geomechaniki of Athens	Greece	30 10 935 0054
Guandong Golden Star	China	86 20 876 51338
Hako Ground and Garden	Sweden	46 35 10 0000
Hako Ground and Garden	Norway	47 22 90 7760
Hayter Limited (U.K.)	United Kingdom	44 1279 723 444
Hydroturf Int. Co Dubai	United Arab Emirates	97 14 347 9479
Hydroturf Egypt LLC	Egypt	202 519 4308
Ibea S.P.A.	Italy	39 0331 853611
Irriamc	Portugal	351 21 238 8260
Irrigation Products Int'l Pvt Ltd.	India	86 22 83960789
Jean Heybroek b.v.	Netherlands	31 30 639 4611
Lely (U.K.) Limited	United Kingdom	44 1480 226 800
Maquiver S.A.	Colombia	57 1 236 4079
Maruyama Mfg. Co. Inc.	Japan	81 3 3252 2285
Metra Kft	Hungary	36 1 326 3880
Mountfield a.s.	Czech Republic	420 255 704 220
Munditol S.A.	Argentina	54 11 4 821 9999
Oslinger Turf Equipment SA	Ecuador	593 4 239 6970
Oy Hako Ground and Garden Ab	Finland	358 987 00733
Parkland Products Ltd.	New Zealand	64 3 34 93760
Prochaska & Cie	Austria	43 1 278 5100
RT Cohen 2004 Ltd.	Israel	972 986 17979
Riversa	Spain	34 9 52 83 7500
Roth Motorgerate GmBh & Co.	Germany	49 7144 2050
Sc Svend Carlsen A/S	Denmark	45 66 109 200
Solvart S.A.S.	France	33 1 30 81 77 00
Spypros Stavrinides Limited	Cyprus	357 22 434131
Surge Systems India Limited	India	91 1 292299901
T-Markt Logistics Ltd.	Hungary	36 26 525 500
Toro Australia	Australia	61 3 9580 7355
Toro Europe BVBA	Belgium	32 14 562 960



The Toro Warranty

Conditions and Products Covered

The Toro® Company and its affiliate, Toro Warranty Company, pursuant to an agreement between them, jointly promise to repair the Toro Product listed below if used for residential purposes* if defective in materials or workmanship.

The following time periods apply from the date of purchase:

Products	Warranty Period
Walk Power Mowers	2 year limited warranty
Rear Engine Riders	2 year limited warranty
Lawn & Garden Tractors	2 year limited warranty
Electric Hand Held Products	2 year limited warranty
Snowthrowers	2 year limited warranty
Consumer Zero Turn	2 year limited warranty

*Original Purchaser means the person who originally purchased the Toro Product

*Residential purposes means use of the product on the same lot as your home. Use at more than one location, or institutional or rental use, is considered commercial use, and the commercial use warranty would apply.

Limited Warranty for Commercial Use

Toro Consumer Products and attachments used for commercial, institutional, or rental use, are warranted against defects in materials or workmanship for the following time periods from the date of original purchase:

Products	Warranty Period
Walk Power Mowers	90 day warranty
Rear Engine Riders	90 day warranty
Lawn & Garden Tractors	90 day warranty
Electric Hand Held Products	90 day warranty
Snowthrowers	90 day warranty
Consumer Zero Turn	45 day warranty

Instructions for Obtaining Warranty Service

If you think that your Toro Product contains a defect in materials or workmanship, follow this procedure:

1. Contact your seller to arrange service of the product. If for any reason it is impossible for you to contact your seller, you may contact any Toro Authorized Distributor to arrange service.
2. Bring the product and your proof of purchase (sales receipt) to the Service Dealer. If for any reason you are dissatisfied with the Service Dealer's analysis or with the assistance provided, contact us at:

Customer Care Department, Consumer Division
The Toro Company
8111 Lyndale Avenue South
Bloomington, MN 55420-1196
Manager: Technical Product Support: 001-952-887-8248

See attached Distributor List

Owner Responsibilities

You must maintain your Toro Product by following the maintenance procedures described in the *Operator's Manual*. Such routine maintenance, whether performed by a dealer or by you, is at your expense.

Items and Conditions Not Covered

This express warranty does not cover the following:

- Cost of regular maintenance service or wear parts, such as rotor blades (paddles), scraper blades, belts, fuel, lubricants, oil changes, spark plugs, cable/linkage or brake adjustments
- Any product or part which has been altered or misused and requires replacement or repair due to accidents or lack of proper maintenance
- Repairs necessary due to failure to use fresh fuel (less than one month old), or failure to properly prepare the unit prior to any period of non-use over one month
- Engine and transmission. These are covered by the appropriate manufacturer's guarantees with separate terms and conditions

All repairs covered by these warranties must be performed by an Authorized Toro Service Dealer using Toro approved replacement parts.

General Conditions

The purchaser is covered by the national laws of each country. The rights to which the purchaser is entitled with the support of these laws are not restricted by this warranty.