



Count on it.

Operator's Manual

**38in Easy Empty Bagger
for XL Series Lawn Tractors**

Model No. 79117—Serial No. 310000001 and Up

Introduction

Read this information carefully to learn how to operate and maintain your product properly and to avoid injury and product damage. You are responsible for operating the product properly and safely.

You may contact Toro directly at www.Toro.com for product and accessory information, help finding a dealer, or to register your product.

Whenever you need service, genuine Toro parts, or additional information, contact an Authorized Service Dealer or Toro Customer Service and have the model and serial numbers of your product ready. Figure 1 illustrates the location of the model and serial numbers on the product.

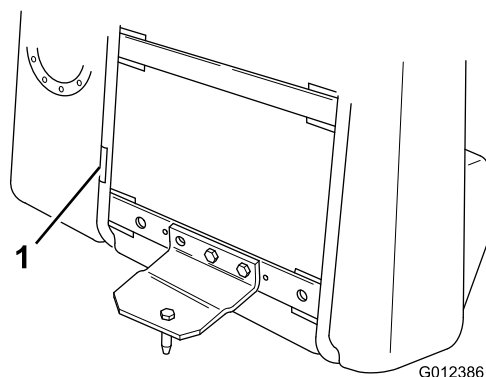

Figure 1

1. Location of the model and serial numbers

Write the numbers in the space provided below:

Model No. _____
Serial No. _____

This manual identifies potential hazards and has safety messages identified by the safety alert symbol (Figure 2), which signals a hazard that may cause serious injury or death if you do not follow the recommended precautions.



Figure 2

1. Safety alert symbol

This manual uses 2 words to highlight information.

Important calls attention to special mechanical

information and **Note** emphasizes general information worthy of special attention.

Contents

Introduction.....	2
Safety	3
Safety and Instructional Decals	3
Setup.....	4
1 Installing the Grass Catcher	5
2 Removing the Grass Catcher	6
Operation.....	7
Emptying the Grass Basket.....	7
Clearing Obstructions from the Grass	
Catcher.....	7
Operating and Bagging Tips	8
Maintenance.....	9
Inspecting the Grass Catcher	9
Inspecting the Mower Blades	9
Cleaning the Grass Catcher.....	9
Storage.....	9

Safety

Improper use or maintenance by the operator or owner can result in injury. To reduce the potential for injury, comply with these safety instructions and those in the traction unit *Operator's Manual*. Always pay attention to the safety alert symbol, which means *Caution*, *Warning*, or *Danger*—personal safety instruction. Failure to comply with the instruction may result in personal injury or death.

Safety and Instructional Decals



Safety decals and instructions are easily visible to the operator and are located near any area of potential danger. Replace any decal that is damaged or lost.

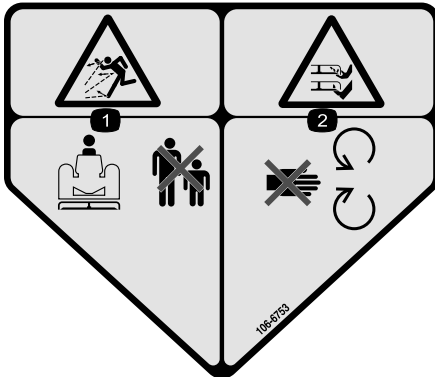

106-6753

1. Thrown object hazard—keep bystanders a safe distance from the machine.
2. Cutting/dismemberment hazard of hand or foot, mower blade—stay away from moving parts.

Setup

Loose Parts

Use the chart below to verify that all parts have been shipped.

Procedure	Description	Qty.	Use
1	Upper mounting bracket	1	Prepare the mower.
	Bolt (5/16 x 1 inch)	4	
	Locknut (5/16 inch—18)	4	
	Hitch plate	1	
	Hitch pin	1	
	Bolt (5/16 x 5/8 inch)	1	
	Grass basket with frame	1	
	Dump handle	1	
	Handle guide	1	
	Bolt (1/4 x 2 inch)	1	
	Locknut (1/4 inch—20)	1	
	Washer (1/4 inch)	1	
	Hairpin cotter	2	
	Chute	1	
	Discharge tube	1	
	Locking pin	1	
2	No parts required	—	Remove the grass catcher.

1

Installing the Grass Catcher

Parts needed for this procedure:

1	Upper mounting bracket
4	Bolt (5/16 x 1 inch)
4	Locknut (5/16 inch—18)
1	Hitch plate
1	Hitch pin
1	Bolt (5/16 x 5/8 inch)
1	Grass basket with frame
1	Dump handle
1	Handle guide
1	Bolt (1/4 x 2 inch)
1	Locknut (1/4 inch—20)
1	Washer (1/4 inch)
2	Hairpin cotter
1	Chute
1	Discharge tube
1	Locking pin

Installing the Upper Mounting Bracket

Install the upper mounting bracket to the rear of the tractor using 2 bolts (5/16 x 1 inch) and 2 locknuts (5/16 inch—18) (Figure 3).

Note: Use the right-most set of holes in the bracket as you are looking at the rear of the tractor.

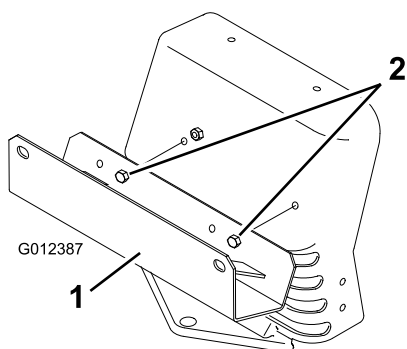

Figure 3

1. Upper mounting bracket 2. Bolts (5/16 x 1 inch)

Installing the Hitch Plate

- Align the holes in the hitch plate tab with the alignment hole on the mounting frame (Figure 4).

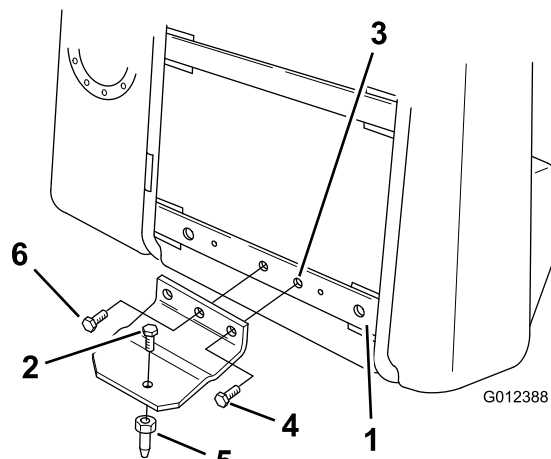

Figure 4

- | | |
|-------------------|---------------------------|
| 1. Mounting frame | 4. Bolt (5/16 x 1 inch) |
| 2. Hitch plate | 5. Hitch pin |
| 3. Alignment hole | 6. Bolt (5/16 x 5/8 inch) |
- Secure the hitch plate to the mounting frame using 2 bolts (5/16 x 1 inch) and 2 locknuts (5/16 inch—18) (Figure 4).
 - Secure the hitch pin in the hole in the hitch plate using a bolt (5/16 x 5/8 inch) (Figure 4).

Assembling and Installing the Grass Basket

- Open the grass basket and slide the dump handle through the hole in the top of the basket and into the handle channel (Figure 5).

Note: Ensure that the handle grip is positioned so that it will point toward the front of the tractor when it is installed.

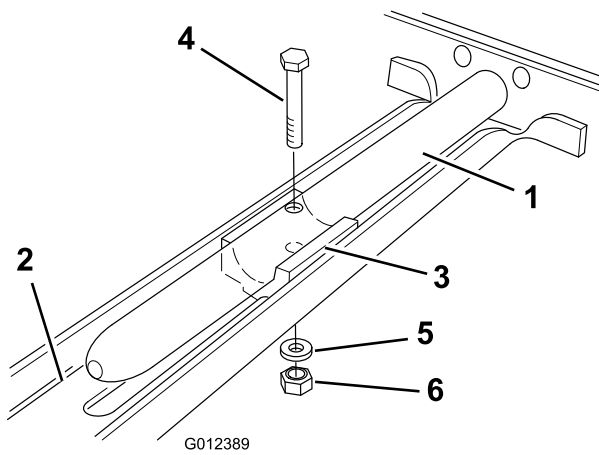

Figure 5

- | | |
|-------------------|---------------------------|
| 1. Dump handle | 4. Bolt (1/4 x 2 inch) |
| 2. Handle channel | 5. Washer (1/4 inch) |
| 3. Handle guide | 6. Locknut (1/4 inch —20) |

2. Lift up on the end of the dump handle, positioning it on the handle guide in the channel with the holes in the handle and guide aligned (Figure 5).
 3. Secure the handle guide and dump handle to the channel with the bolt (1/4 x 2 inch), washer, and locknuts (1/4-20 inch) (Figure 5).
 4. Pull the dump handle up until it stops, then close the grass basket.
- Note:** When the dump handle is pushed in completely, the basket should not be able to open. If the basket opens, either the dump handle is not pushed in far enough or the basket is not fully closed.
5. Push the dump handle down until it stops.

Attaching the Grass Basket to the Tractor

1. Insert the hitch pin on the grass catcher into the mounting hole in the tractor hitch.
2. Rotate the grass catcher up so that the pins on the mounting frame slide through the mounting holes on the tractor, and secure the pins with the hairpin cotters.

Assembling and Installing the Chute and Discharge Tube

1. Lift the mower deflector and slide the front of the chute into the locking position on the mower and insert the locking pin (Figure 6).

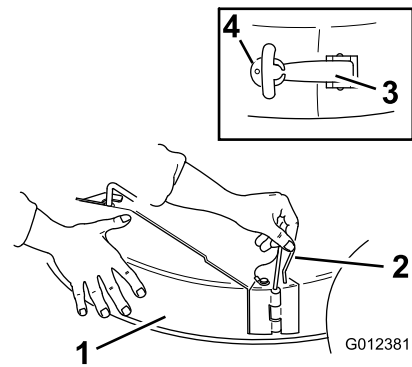

Figure 6

- | | |
|----------------|--------------------|
| 1. Chute | 3. Flexible latch |
| 2. Locking pin | 4. Notched bracket |

2. Hook the flexible latch on the chute into the notched bracket on the back of the mower (Figure 6).
3. Slide the discharge tube into the opening in the grass catcher (Figure 7).

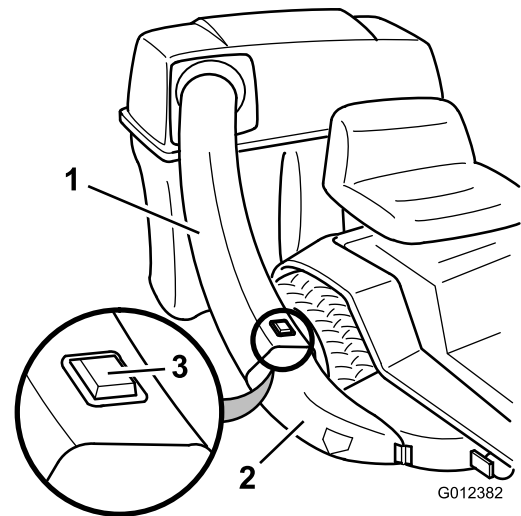

Figure 7

- | | |
|-------------------|--------|
| 1. Discharge tube | 3. Tab |
| 2. Chute | |

4. Slide the discharge tube over the end of the chute, ensuring that the tab on the chute snaps into the square hole in the discharge tube (Figure 7).

2

Removing the Grass Catcher

No Parts Required

Procedure

⚠ DANGER

Operating the tractor and mower with the discharge tube removed exposes you and others to thrown debris and blade contact, potentially causing severe injury or death.

Always operate the mower with the complete grass catcher mounted in place or use the mower to side discharge, ensuring that the spring-loaded grass deflector is in the down position.

1. Push on the tab on the chute and pull the discharge tube free from the chute and grass catcher (Figure 7).
2. Release the flexible latch and remove the locking pin that secures the chute to the mower.
3. Pull the chute out of the mower (Figure 6).
4. Remove the hairpin cotters that secure the grass basket to the upper mounting bracket on the mower.
5. Rock the grass basket backward, then pull it free of the mower hitch.
6. Store all grass catcher parts in a convenient place.

Operation

⚠ CAUTION

To avoid personal injury, do the following:

- Become familiar with all operating and safety instructions in the *Operator's Manual* for your tractor and mower before using the attachment.
- Do not remove the discharge tube, bags, bagger top, or the blower while the engine is running.
- Always shut the engine off before clearing an obstruction from the vacuum bagging system.
- Do not perform maintenance or repairs while the engine is running.

Emptying the Grass Basket

1. Stop the tractor, set the parking brake, and disengage the power take-off (PTO) by pushing the PTO control to the Off position.

Note: This stops the mower blades.

2. Stop the engine and wait for all moving parts to stop.
3. Pull up on the dump handle and swing the grass basket open.
4. Empty the grass basket.
5. Close the grass basket completely and push the dump handle down until it stops.

Note: Ensure that the grass basket will not open.

Clearing Obstructions from the Grass Catcher

1. Stop the tractor, set the parking brake, and disengage the power take-off (PTO) by pushing the PTO control to the Off position.

Note: This stops the mower blades.

2. Stop the engine and wait for all moving parts to stop.
3. Check the grass basket and empty it if it is full.
4. Remove and separate the discharge tube and chute from the grass basket and mower.

Note: Use a stick to carefully remove and clear the obstruction from the mower, discharge tube, chute, and the grass basket.

5. After removing the obstruction, install the grass catcher and resume operation.

Operating and Bagging Tips

Size

Remember that the tractor is longer and wider with the attachment installed. By turning too sharply in confined places, you may damage the attachment.

Trimming

Always trim with the left side of the mower. Do not trim with the right side of the mower because you could damage the bagger blower and discharge tube.

Cutting Height

Do not set the mower cutting height too low because long grass surrounding the mower can prevent air from getting under the mower and entering the grass catcher. If enough air doesn't get under the mower, the bagging system will plug.

Cutting Frequency

Cut the grass often, especially when it grows rapidly. you will have to cut your grass twice if it gets excessively long. Refer to Bagging Long Grass.

Cutting Technique

For the best lawn appearance, slightly overlap the mower into the previously cut area. This reduces the load on the engine and the chance of plugging the grass catcher.

Grass Catching Speed

Most often you will bag with the tractor throttle in the Fast position and drive in first gear, which is the slowest ground speed. However, in extremely dry and dusty grass, you may want to slightly reduce the throttle speed and shift the gear sector to a higher gear to maintain the ground speed of the tractor. The grass catcher may plug if you drive too fast, causing the engine to slow down with the extra work load.

⚠ CAUTION

As the grass bags fill, extra weight is added to the back of the tractor. If you stop and start suddenly on hills, you may lose control of the steering or the tractor may tip over.

- Do not start or stop suddenly when going uphill or downhill.
- Avoid uphill starts.
- If you do stop the tractor when going uphill, disengage the PTO by pushing the PTO control to the Off position, then back down the hill using slow reverse speed.

Do not change seeds or stop on slopes.

Catching Long Grass

Excessively long grass is heavy and may not be propelled completely into the grass basket. If this happens, the discharge tube may plug. To avoid plugging the grass catcher, mow the grass at a high height-of-cut, then lower the mower to your normal cutting height and repeat the process.

Catching Wet Grass

Always try to cut grass when it is dry because your lawn will have a neat appearance. If you must cut wet grass, use the conventional side discharge feature of the mower. Several hours later, when the clippings are dry, install the complete catcher and vacuum up the grass clippings.

Signs of Plugging

As you are bagging, a small amount of grass clippings normally blow out the front of the mower. An excessive amount of clipping blow-out indicates that the bags are full or the system is plugged.

Maintenance

Inspecting the Grass Catcher

Service Interval: After the first 10 hours
Monthly

1. Check the discharge tube, chute, and the grass basket; replace these parts if they are cracked or broken.
2. Tighten all nuts, bolts, and screws.

Inspecting the Mower Blades

1. Inspect the mower blades regularly and whenever a blade strikes a foreign object.
2. If the blades are badly worn or damaged, install new blades. Refer to your tractor or the mower *Operator's Manual* for blade maintenance.

Cleaning the Grass Catcher

1. After each use, remove the inside and outside of the grass basket, discharge tube, chute, and the underside of the mower, and wash them using water sprayed from a garden hose. Use a mild automotive detergent to remove stubborn dirt.

▲ CAUTION

If you store grass clippings in the grass basket, under the right conditions, spontaneous combustion (a fire-generating process that occurs with an external source of ignition) could occur, potentially damaging property and/or injuring you or others.

The grass basket is not a storage container. Do not store grass clippings and debris in the grass basket.

2. Ensure that you remove matted grass from all parts.
3. After washing, let all parts dry thoroughly. Do not wash the grass bags.

Storage

1. Clean the grass catcher; refer to Cleaning the Grass Catcher.
2. Inspect the grass catcher for damage; refer to Inspecting the Grass Catcher.
3. Store the grass catcher in a clean, dry place, out of direct sunlight to protect the plastic parts and extend the life of the bagger.

Note: If you must store the grass catcher outside, cover it with a weatherproof cover.

Notes:

International Distributor List

Distributor:	Country:	Phone Number:
Atlantis Su ve Sulama Sistemleri Lt	Turkey	90 216 344 86 74
Balama Prima Engineering Equip.	Hong Kong	852 2155 2163
B-Ray Corporation	Korea	82 32 551 2076
Casco Sales Company	Puerto Rico	787 788 8383
Ceres S.A.	Costa Rica	506 239 1138
CSSC Turf Equipment (pvt) Ltd.	Sri Lanka	94 11 2746100
Cyril Johnston & Co.	Northern Ireland	44 2890 813 121
Equivier	Mexico	52 55 539 95444
Femco S.A.	Guatemala	502 442 3277
G.Y.K. Company Ltd.	Japan	81 726 325 861
Geomechaniki of Athens	Greece	30 10 935 0054
Guandong Golden Star	China	86 20 876 51338
Hako Ground and Garden	Sweden	46 35 10 0000
Hako Ground and Garden	Norway	47 22 90 7760
Hayter Limited (U.K.)	United Kingdom	44 1279 723 444
Hydroturf Int. Co Dubai	United Arab Emirates	97 14 347 9479
Hydroturf Egypt LLC	Egypt	202 519 4308
Ibea S.P.A.	Italy	39 0331 853611
Irriamc	Portugal	351 21 238 8260
Irrigation Products Int'l Pvt Ltd.	India	86 22 83960789
Jean Heybroek b.v.	Netherlands	31 30 639 4611
Lely (U.K.) Limited	United Kingdom	44 1480 226 800
Maquiver S.A.	Colombia	57 1 236 4079
Maruyama Mfg. Co. Inc.	Japan	81 3 3252 2285
Metra Kft	Hungary	36 1 326 3880
Mountfield a.s.	Czech Republic	420 255 704 220
Munditol S.A.	Argentina	54 11 4 821 9999
Oslinger Turf Equipment SA	Ecuador	593 4 239 6970
Oy Hako Ground and Garden Ab	Finland	358 987 00733
Parkland Products Ltd.	New Zealand	64 3 34 93760
Prochaska & Cie	Austria	43 1 278 5100
RT Cohen 2004 Ltd.	Israel	972 986 17979
Riversa	Spain	34 9 52 83 7500
Roth Motorgerate GmBh & Co.	Germany	49 7144 2050
Sc Svend Carlsen A/S	Denmark	45 66 109 200
Solvvert S.A.S.	France	33 1 30 81 77 00
Spypros Stavrinides Limited	Cyprus	357 22 434131
Surge Systems India Limited	India	91 1 292299901
T-Markt Logistics Ltd.	Hungary	36 26 525 500
Toro Australia	Australia	61 3 9580 7355
Toro Europe BVBA	Belgium	32 14 562 960



The Toro Warranty

Conditions and Products Covered

The Toro® Company and its affiliate, Toro Warranty Company, pursuant to an agreement between them, jointly promise to repair the Toro Product listed below if used for residential purposes* if defective in materials or workmanship.

The following time periods apply from the date of purchase:

Products	Warranty Period
Walk Power Mowers	2 year limited warranty
Rear Engine Riders	2 year limited warranty
Lawn & Garden Tractors	2 year limited warranty
Electric Hand Held Products	2 year limited warranty
Snowthrowers	2 year limited warranty
Consumer Zero Turn	2 year limited warranty

*Original Purchaser means the person who originally purchased the Toro Product

*Residential purposes means use of the product on the same lot as your home. Use at more than one location, or institutional or rental use, is considered commercial use, and the commercial use warranty would apply.

Limited Warranty for Commercial Use

Toro Consumer Products and attachments used for commercial, institutional, or rental use, are warranted against defects in materials or workmanship for the following time periods from the date of original purchase:

Products	Warranty Period
Walk Power Mowers	90 day warranty
Rear Engine Riders	90 day warranty
Lawn & Garden Tractors	90 day warranty
Electric Hand Held Products	90 day warranty
Snowthrowers	90 day warranty
Consumer Zero Turn	45 day warranty

Instructions for Obtaining Warranty Service

If you think that your Toro Product contains a defect in materials or workmanship, follow this procedure:

1. Contact your seller to arrange service of the product. If for any reason it is impossible for you to contact your seller, you may contact any Toro Authorized Distributor to arrange service.
2. Bring the product and your proof of purchase (sales receipt) to the Service Dealer. If for any reason you are dissatisfied with the Service Dealer's analysis or with the assistance provided, contact us at:

Customer Care Department, Consumer Division
The Toro Company
8111 Lyndale Avenue South
Bloomington, MN 55420-1196
Manager: Technical Product Support: 001-952-887-8248

See attached Distributor List

Owner Responsibilities

You must maintain your Toro Product by following the maintenance procedures described in the *Operator's Manual*. Such routine maintenance, whether performed by a dealer or by you, is at your expense.

Items and Conditions Not Covered

This express warranty does not cover the following:

- Cost of regular maintenance service or wear parts, such as rotor blades (paddles), scraper blades, belts, fuel, lubricants, oil changes, spark plugs, cable/linkage or brake adjustments
- Any product or part which has been altered or misused and requires replacement or repair due to accidents or lack of proper maintenance
- Repairs necessary due to failure to use fresh fuel (less than one month old), or failure to properly prepare the unit prior to any period of non-use over one month
- Engine and transmission. These are covered by the appropriate manufacturer's guarantees with separate terms and conditions

All repairs covered by these warranties must be performed by an Authorized Toro Service Dealer using Toro approved replacement parts.

General Conditions

The purchaser is covered by the national laws of each country. The rights to which the purchaser is entitled with the support of these laws are not restricted by this warranty.