

Leaf Bagging Enhancement Kit

Zero-Turn-Radius Riding Mower

Model No. 119-3381

Installation Instructions

Installation

Loose Parts

Use the chart below to verify that all parts have been shipped.

Description	Qty.	Use
Left rubber skirt	1	Install the leaf bagging enhancement kit.
Right rubber skirt	1	
Skirt skid	2	
Carriage bolt, (5/16 x 1 inch)	8	
Lock nut, (5/16 inch)	8	

Installing the Leaf Bagging Enhancement Kit

Note: Determine the left and right sides of the machine from the normal operating position.

Install the kit to the deck as shown in Figure 1. The left rubber skirt is defined by having two arc cuts while the right rubber skirt only has one. Both skirts have notched corners to help orientation. Notched corners are mated in the center of the deck.

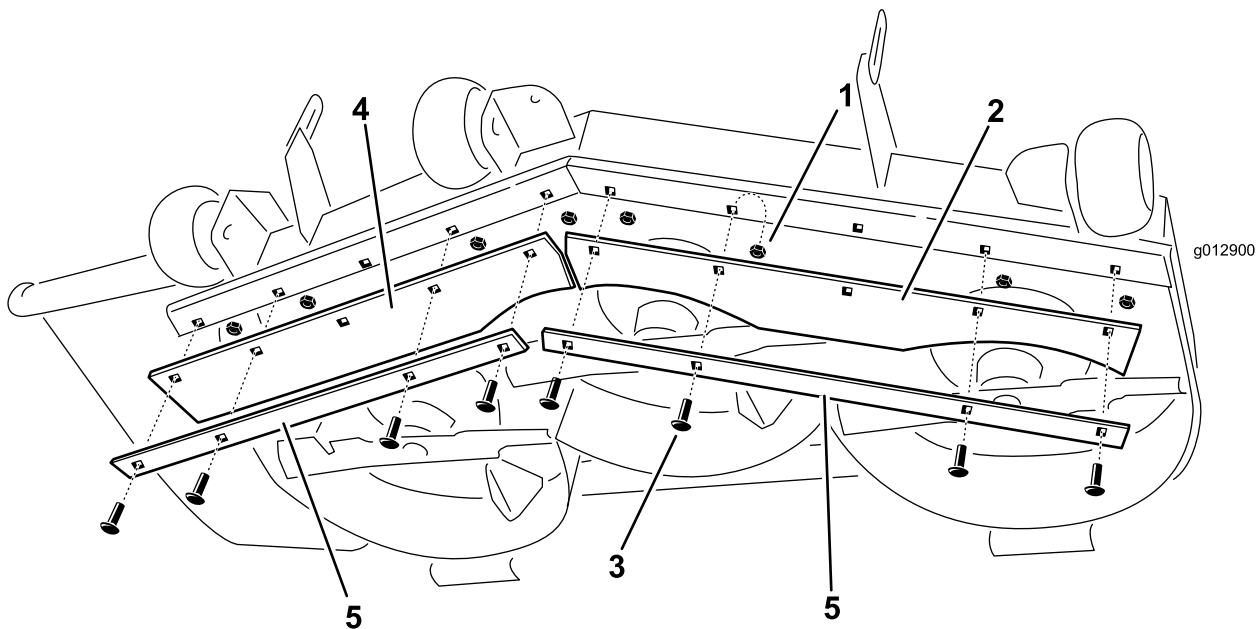

Figure 1

- | | | |
|---|---|---------------|
| 1. Lock nut, (5/16 inch) | 3. Carriage bolt, (5/16 x 1 inch) | 5. Metal skid |
| 2. Left rubber skirt, two arcs cut and notched inner corner | 4. Right rubber skirt, one arc cut and notched inner corner | |