



Breather Kit

2009 and Before Reelmaster 5410/5510 Traction Unit

Model No. 119-6959

Installation Instructions

Installation

1. Position the machine on a clean, flat surface.
2. Lower the cutting units, stop the engine, set the parking brake and remove the key from the ignition switch. Allow the engine to cool.
3. Clean any debris from and around the breather cover on the valve cover (Figure 1).

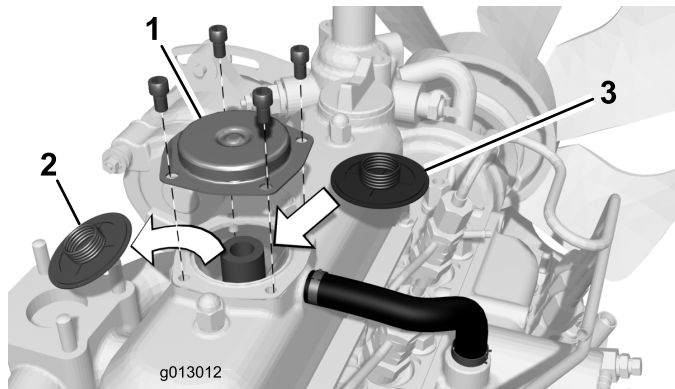

Figure 1

1. Breather cover
2. Old breather valve
3. New breather valve

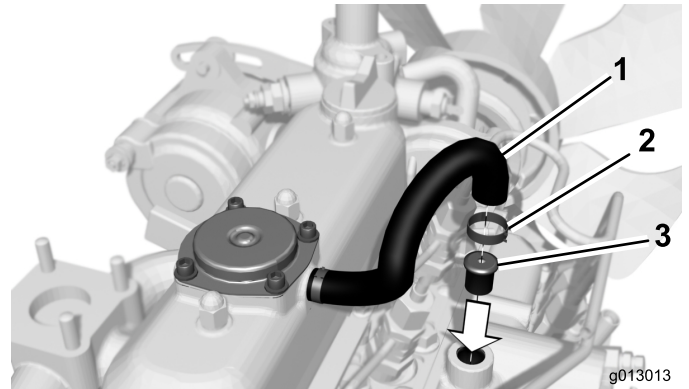

Figure 2

1. Breather tube
2. Hose clamp
3. Intake orifice

4. Remove the (4) screws securing the breather cover to the valve cover (Figure 1). Remove the breather cover.

Important: To prevent contamination from entering the engine, remove any debris from the existing breather valve before removing it from the opening in the valve cover (Figure 1).

5. Remove the existing breather valve from the opening in the valve cover (Figure 1).
6. Install the new breather valve, reinstall the breather cover and secure with the (4) screws previously removed.
7. Remove any debris from and around the area where the breather tube is connected to the breather pipe (Figure 2).

8. Remove the hose clamp securing the breather tube to the breather pipe in the intake manifold (Figure 2). Slide the tube off the pipe.
9. Insert the new intake orifice into the end of the breather pipe (Figure 2).
10. Install the breather tube onto the breather pipe and secure with the hose clamp.