



Count on it.

Operator's Manual

Trench Filler

Compact Utility Loader

Model No. 22472—Serial No. 31000001 and Up

This product complies with all relevant European directives, for details please see the separate product specific Declaration of Conformity (DOC) sheet.

▲ DANGER

There may be buried power, gas, and/or telephone lines in the work area. Shock or explosion may occur if you dig into them.

Have the property or work area marked for buried lines and do not dig in marked areas. Contact your local marking service or utility company to have the property marked (for example, in the United States, call 811 for the nationwide marking service).

Introduction

The trench filler is an attachment designed for use on Toro compact utility loaders to fill trenches dug by a trencher with the loose soil left by the trenching process.

Read this information carefully to learn how to operate and maintain your product properly and to avoid injury and product damage. You are responsible for operating the product properly and safely.

You may contact Toro directly at www.Toro.com for product and accessory information, help finding a dealer, or to register your product.

Whenever you need service, genuine Toro parts, or additional information, contact an Authorized Service Dealer or Toro Customer Service and have the model and serial numbers of your product ready. Figure 1 identifies the location of the model and serial numbers on the product. Write the numbers in the space provided.

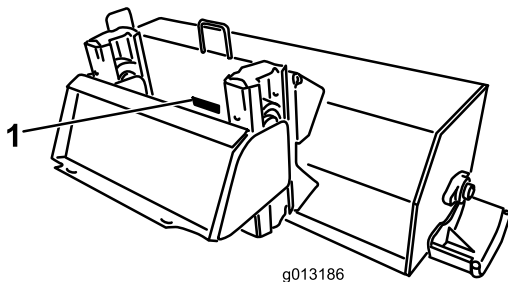

Figure 1

1. Model and serial number location

Model No. _____ Serial No. _____

This manual identifies potential hazards and has safety messages identified by the safety alert symbol (Figure 2), which signals a hazard that may cause serious injury or death if you do not follow the recommended precautions.



Figure 2

1. Safety alert symbol

This manual also uses 2 words to highlight information. **Important** calls attention to special mechanical information and **Note** emphasizes general information worthy of special attention.

Contents

Introduction.....	2
Safety.....	3
General Safety.....	4
Toro Safety.....	4
Stability Ratings.....	5
Safety and Instructional Decals.....	5
Product Overview.....	6
Specifications.....	6
Attachments/Accessories.....	6
Operation.....	7
Filling a Trench.....	7
Transporting the Attachment on a Trailer.....	7
Operating Tips.....	7
Maintenance.....	8
Recommended Maintenance Schedule(s).....	8
Greasing the Auger Bearings.....	8
Adjusting the Skids.....	8
Storage.....	9
Troubleshooting.....	10

Safety

Improper use or maintenance by the operator or owner can result in injury. To reduce the potential for injury, comply with these safety instructions and those in the traction unit *Operator's Manual*. Always pay attention to the safety alert symbol, which means *Caution*, *Warning*, or *Danger*—personal safety instruction. Failure to comply with the instruction may result in personal injury or death.

⚠ DANGER

There may be buried power, gas, and/or telephone lines in the work area. Shock or explosion may occur if you dig into them.

Have the property or work area marked for buried lines and do not dig in marked areas. Contact your local marking service or utility company to have the property marked (for example, in the United States, call 811 for the nationwide marking service).

⚠ DANGER

When the trench filler is in operation, the rollers in the float guide move and can injure hands and feet.

- Stay in the operator's position behind the control panel while operating the trench filler.
- Keep face, hands, feet, and any other part of your body or clothing away from moving parts.

⚠ DANGER

When the trench filler is in operation, the auger can be rotating and cut off or injure hands and feet.

- Before adjusting, cleaning, repairing and inspecting the trench filler, *move the auxiliary hydraulics lever to the off position, stop the engine, and wait for all moving parts to stop*. Remove the key.
- Stay behind the handles while operating the trench filler.
- Keep face, hands, feet, and any other part of your body or clothing away from moving or rotating parts.

⚠ WARNING

When the engine is off, attachments in the raised position can gradually lower. Someone nearby may be pinned or injured by the attachment as it lowers.

Always lower the attachment lift each time you shut off the traction unit.

⚠ WARNING

If you do not fully seat the attachment locking pins in the attachment mount plate holes, the attachment could fall off of the traction unit severely injuring the operator or bystanders.

- Ensure that you fully seat the attachment locking pins through the holes in the attachment mount plate before lifting the attachment.
- Ensure that the attachment mount plate is free of any dirt or debris that may hinder the connection of the traction unit to the attachment.
- Refer to your traction unit *Operator's Manual* for detailed information on safely connecting an attachment to your traction unit.

⚠ WARNING

Hydraulic fluid escaping under pressure can penetrate skin and cause injury.

- Make sure all hydraulic fluid hoses and lines are in good condition and all hydraulic connections and fittings are tight before applying pressure to the hydraulic system.
- Keep your body and hands away from pin hole leaks or nozzles that eject high pressure hydraulic fluid.
- Use cardboard or paper to find hydraulic leaks.
- Safely relieve all pressure in the hydraulic system before performing any work on the hydraulic system.
- Get immediate medical help if fluid is injected into skin.

▲ CAUTION

Hydraulic couplers, hydraulic lines/valves, and hydraulic fluid may be hot and can burn you if you touch them.

- Wear gloves when operating the hydraulic couplers.
- Allow the traction unit to cool before touching hydraulic components.
- Do not touch hydraulic fluid spills.

General Safety

The following instructions have been adapted from the ANSI/OPEI and ISO standards.

Preparation

- Never attempt to make any adjustments while the engine is running, except when specifically recommended by Toro.
- The operation of any powered machine can result in foreign objects being thrown into the eyes. Always wear safety glasses or eye shields during operation or while performing an adjustment or repair.

Operation

- Do not put hands or feet near or under rotating parts.
- Exercise extreme caution when operating on or crossing gravel drives, walks, or roads. Stay alert for hidden hazards or traffic. Do not carry passengers.
- After striking a foreign object, stop the engine, cycle the auxiliary hydraulics lever, disconnect the hydraulic lines, thoroughly inspect the trench filler for any damage, and repair the damage before restarting and operating the trench filler.
- If the unit should start to vibrate abnormally, stop the engine and check immediately for the cause. Vibration is generally a warning of trouble.
- Stop the engine whenever you leave the operating position, before unclogging the auger housing, and when making any repairs, adjustments, or inspections.
- When cleaning, repairing, or inspecting, stop the engine, make certain the auger and all moving parts have stopped, cycle the auxiliary hydraulics lever, and disconnect the hydraulic lines.
- Keep children and pets away.
- Do not overload the machine capacity by attempting to backfill at too fast a rate.

- Never operate the machine at high transport speeds on slippery surfaces. Look behind and use care when moving in reverse.
- Never allow anyone in front of the unit.
- Disengage power to the auger when the trench filler is transported or not in use.
- Never operate the trench filler without good visibility or light.
- Lightning can cause severe injury or death. If lightning is seen or thunder is heard in the area, do not operate the machine; seek shelter.

Maintenance and Storage

- Check fasteners at frequent intervals for proper tightness to be sure the equipment is in safe working condition.
- Always refer to the *Operator's Manual* for important details if the trench filler is to be stored for an extended period.
- Maintain or replace safety and instruction labels, as necessary.

Toro Safety

The following list contains safety information specific to Toro products or other safety information that you must know that is not included in the ANSI or ISO standards.

- **The rotating auger can cut off or injure fingers or hands.** Stay in the operator's position while operating the trench filler. **Keep your face, hands, feet, and any other part of your body or clothing away from moving or rotating parts.**
- Before adjusting, cleaning, repairing, and inspecting the trench filler, **stop the engine, remove the key, and wait for all moving parts to stop.** Also, cycle the auxiliary hydraulics lever and disconnect the hydraulic lines.
- **Before** leaving the operator's position, stop the engine, remove the key, and wait for all moving parts to stop.
- Do not wear loose fitting clothing that could possibly get caught in moving parts.
- If a shield, safety device, or decal is damaged, illegible, or lost, repair or replace it before beginning operation. Also, tighten any loose fasteners.
- Perform only those maintenance instructions described in this manual. Before performing any maintenance, service, or adjustment, stop the engine, remove the key, cycle the auxiliary hydraulics lever, and disconnect the hydraulic lines. If major repairs

are ever needed, contact your Authorized Toro Service Dealer.

- To ensure the best performance and safety, purchase only genuine Toro replacement parts and accessories to keep the Toro all Toro. **Do not use “Will Fit” replacement parts and accessories as they could cause a safety hazard.**
- Always transport the trench filler in a lowered position.



Stability Ratings

To determine the degree of slope you can traverse with the attachment installed on a traction unit, find the stability rating for the hill position you want to travel in the appropriate table below, then find the degree of slope for the same rating and hill position in the Stability Data section of the traction unit *Operator’s Manual*.

⚠ WARNING

Exceeding the maximum recommended slope can cause the traction unit to tip, crushing you or bystanders.

Do not drive the traction unit on a slope steeper than the maximum recommended slope, as determined in the following tables and the traction unit *Operator’s Manual*.

Orientation	Stability Rating
Front Uphill 	C
Rear Uphill 	C
Side Uphill 	B

Safety and Instructional Decals



Safety decals and instructions are easily visible to the operator and are located near any area of potential danger. Replace any decal that is damaged or lost.

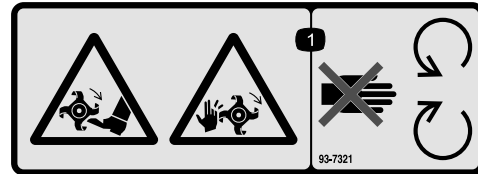

93-7321

1. Cutting/dismemberment hazard of hands and feet, rotating knives—stay away from moving parts.

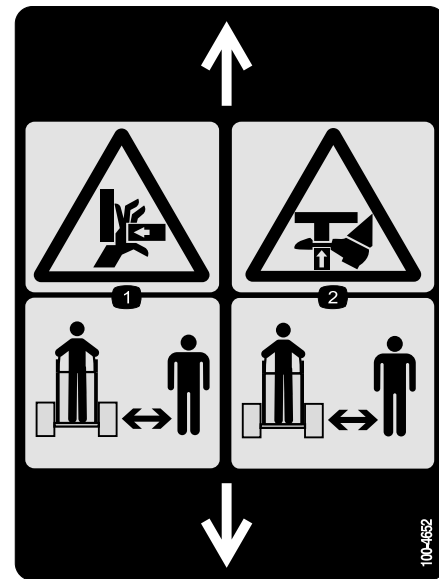

100-4652

1. Crushing hazard of hand—keep bystanders a safe distance from the machine.
2. Crushing hazard of foot—keep bystanders a safe distance from the machine.



100-4708

1. Thrown object hazard—keep bystanders a safe distance from the traction unit.

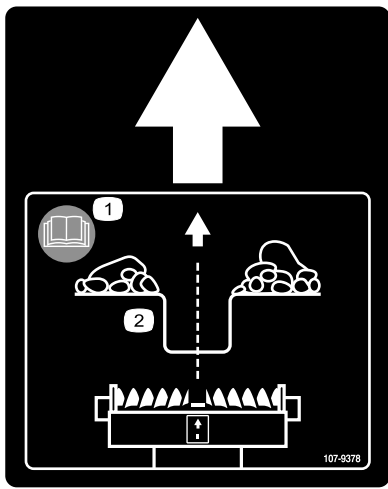

107-9378

1. For more information read the *Operator's Manual*.
2. Keep the center arrow on the trench filler attachment decal centered over the trench when operating.

Product Overview

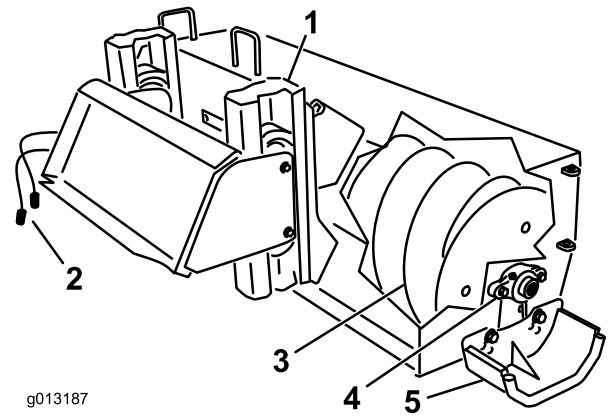

g013187

Figure 3

- | | |
|--------------------|-------------|
| 1. Float guide | 4. Bearing |
| 2. Hydraulic lines | 5. Skid (2) |
| 3. Auger | |

Specifications

Note: Specifications and design are subject to change without notice.

Width	62 inches (157 cm)
Length	31 inches (79 cm)
Height	22 inches (56 cm)
Weight	410 lbs (186 Kg)
Working width	48 inches (122 cm)

Attachments/Accessories

A selection of Toro approved attachments and accessories are available for use with the machine to enhance and expand its capabilities. Contact your Authorized Service Dealer or Distributor or go to www.Toro.com for a list of all approved attachments and accessories.

Operation

Refer to your traction unit *Operator's Manual* for more information on installing and removing attachments on your traction unit.

Important: Always use the traction unit to lift and move the attachment.

Filling a Trench

1. Start the engine.
2. Pull the auxiliary hydraulics lever to the reference bar to engage the trench filler.
3. Slowly lower the trench filler to the ground so that the auger is just above the ground.
4. For best results, start with the float rollers centered in the float guide.
5. Slowly move the traction unit forward to fill the trench.

Note: If you move too fast, the trench filler will stall. If it stalls, raise it slightly, slowly drive rearward, then resume moving forward.

6. When finished, stop the trench filler by releasing the auxiliary hydraulics lever.

Transporting the Attachment on a Trailer

1. Place the attachment on a trailer or truck capable of carrying it.
2. Securely tie the attachment to the trailer or truck using tie straps appropriate for the weight of the attachment and for highway use.

Operating Tips

- Clean the area of trash, branches, and rocks before trench filling to prevent equipment damage.
- For best trench filling, center the unit over the trench (Figure 4).

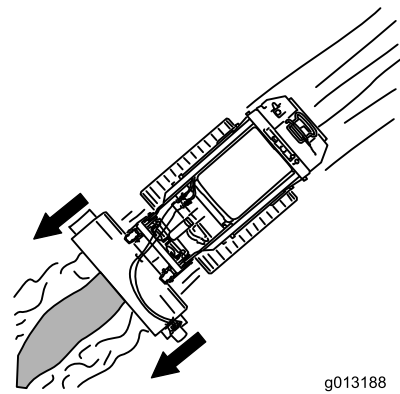

Figure 4

g013188

- Always begin trench filling with the slowest ground speed possible. Increase the speed if conditions permit.
- Always use full throttle (maximum engine speed) when trench filling.
- Never transport the trench filler with the loader arms raised.
- When trench filling, the auger should just clear the original ground surface to obtain maximum soil deposit into the trench.
- Periodically check to ensure that the rollers on the trench filler float are operating properly.
- When finished, compact the material over the trench to prepare it for grading.

Maintenance

Recommended Maintenance Schedule(s)

Maintenance Service Interval	Maintenance Procedure
Before each use or daily	<ul style="list-style-type: none">• Check the bolts and nuts securing the auger.
Every 200 hours	<ul style="list-style-type: none">• Grease the auger bearings.
Yearly or before storage	<ul style="list-style-type: none">• Adjust the skids as needed.• Paint chipped surfaces.

⚠ CAUTION

If you leave the key in the ignition switch, someone could start the engine. Accidental starting of the engine could seriously injure you or other bystanders.

Remove the key from the ignition switch before you do any maintenance.

Greasing the Auger Bearings

Service Interval: Every 200 hours

Grease the fitting immediately after every washing.

Grease Type: General-purpose grease

1. Stop the engine and remove the key.
2. Clean the grease fittings with a rag (Figure 5).

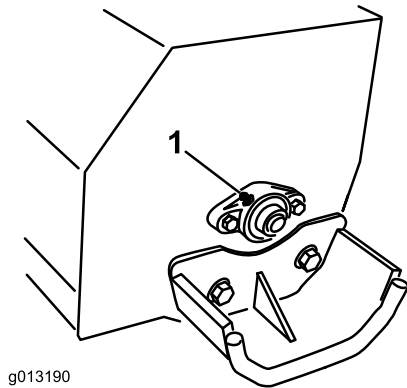

Figure 5

1. Grease fitting

3. Connect a grease gun to the fitting.
4. Pump grease into the fitting until grease begins to ooze out of the bearings.
5. Wipe up any excess grease.

Adjusting the Skids

Service Interval: Yearly or before storage

The distance between the auger blade and the ground is controlled by skids on each side of the housing. The

height can be adjusted so the auger fighting will not catch on uneven surfaces.

1. Lower the attachment until it is just above the ground, then stop the engine.
2. Remove the bolts that secure the skids to the housing (Figure 6).

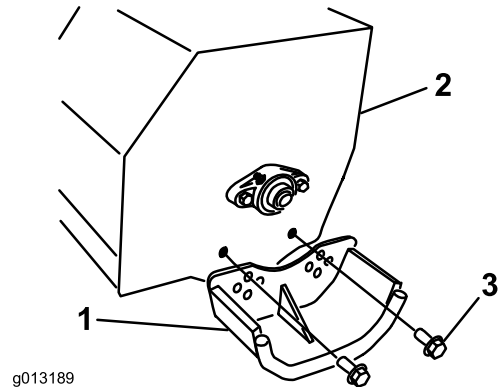

Figure 6

1. Skid
2. Housing
3. Bolts (install the bolt heads on the outside)

3. Position the skids equally on both sides and secure them with the bolts (Figure 6).

Storage

1. Before long term storage, wash the attachment with mild detergent and water to remove dirt and grime.
2. Grease the auger bearings.
3. Check and tighten all bolts, nuts, and screws. Repair or replace any damaged or worn part.
4. Ensure that all hydraulic couplers are connected together to prevent contamination of the hydraulic system.
5. Paint all scratched or bare metal surfaces. Paint is available from your Authorized Service Dealer.
6. Store the attachment in a clean, dry garage or storage area. Cover it to protect it and keep it clean.

Troubleshooting

Problem	Possible Cause	Corrective Action
The attachment does not operate.	<ol style="list-style-type: none"><li data-bbox="586 212 1031 268">1. A hydraulic coupler is not completely connected<li data-bbox="586 279 1031 310">2. A hydraulic coupler is damaged.<li data-bbox="586 338 1031 394">3. There is an obstruction in a hydraulic hose.<li data-bbox="586 405 1031 436">4. A hydraulic hose is kinked.<li data-bbox="586 447 1031 483">5. The auxiliary valve on the traction unit is not opening.	<ol style="list-style-type: none"><li data-bbox="1063 212 1511 243">1. Check and tighten all couplers.<li data-bbox="1063 279 1511 336">2. Check the couplers and replace any that are damaged.<li data-bbox="1063 346 1511 378">3. Find and remove the obstruction.<li data-bbox="1063 405 1511 436">4. Replace the kinked hose<li data-bbox="1063 447 1511 478">5. Repair the valve.

Notes:



Toro Compact Utility Equipment Warranty

A One-Year Limited Warranty

CUE Products

Conditions and Products Covered

The Toro® Company and its affiliate, Toro Warranty Company, pursuant to an agreement between them, jointly warrant your Toro Compact Utility Equipment ("Product") to be free from defects in materials or workmanship. The following time periods apply from the date of purchase:

Products	Warranty Period
Loaders, Trenchers and Attachments	1 year or 1000 operating hours, whichever occurs first
Kohler Engines	3 years
All other Engines	2 years

Where a warrantable condition exists, we will repair the Product at no cost to you including diagnosis, labor, and parts.

Instructions for Obtaining Warranty Service

If you think that your Toro Product contains a defect in materials or workmanship, follow this procedure:

1. Contact any Authorized Toro Compact Utility Equipment (CUE) Service Dealer to arrange service at their dealership. To locate a dealer convenient to you, access our website at www.Toro.com. You may also call our Toro Customer Care Department toll free at 888-865-5676 (U.S. customers) or 888-865-5691 (Canadian customers).
2. Bring the product and your proof of purchase (sales receipt) to the Service Dealer.
3. If for any reason you are dissatisfied with the Service Dealer's analysis or with the assistance provided, contact us at:

LCB Customer Care Department
 Toro Warranty Company
 8111 Lyndale Avenue South
 Bloomington, MN 55420-1196
 Toll Free: 888-865-5676 (U.S. customers)
 Toll Free: 888-865-5691 (Canada customers)

Owner Responsibilities

You must maintain your Toro Product by following the maintenance procedures described in the *Operator's Manual*. Such routine maintenance, whether performed by a dealer or by you, is at your expense. Parts scheduled for replacement as required maintenance ("Maintenance Parts"), are warranted for the period of time up to the scheduled replacement time for that part. Failure to perform required maintenance and adjustments can be grounds for disallowing a warranty claim.

Items and Conditions Not Covered

Not all product failures or malfunctions that occur during the warranty period are defects in materials or workmanship. This express warranty does not cover the following:

- Product failures which result from the use of non-Toro replacement parts, or from installation and use of add-on, modified, or unapproved accessories
- Product failures which result from failure to perform required maintenance and/or adjustments
- Product failures which result from operating the Product in an abusive, negligent or reckless manner
- Parts subject to consumption through use unless found to be defective. Examples of parts which are consumed, or used up, during normal Product operation include, but are not limited to, digging teeth, tines, spark plugs, tires, tracks, filters, chains, etc.
- Failures caused by outside influence. Items considered to be outside influence include, but are not limited to, weather, storage practices, contamination, use of unapproved coolants, lubricants, additives, or chemicals, etc.
- Normal "wear and tear" items. Normal "wear and tear" includes, but is not limited to, worn painted surfaces, scratched decals or windows, etc.
- Any component covered by a separate manufacturer's warranty
- Pickup and delivery charges

General Conditions

Repair by an Authorized Toro Compact Utility Equipment (CUE) Service Dealer is your sole remedy under this warranty.

Neither The Toro® Company nor Toro Warranty Company is liable for indirect, incidental or consequential damages in connection with the use of the Toro Products covered by this warranty, including any cost or expense of providing substitute equipment or service during reasonable periods of malfunction or non-use pending completion of repairs under this warranty. All implied warranties of merchantability and fitness for use are limited to the duration of this express warranty. Some states do not allow exclusions of incidental or consequential damages, or limitations on how long an implied warranty lasts, so the above exclusions and limitations may not apply to you.

This warranty gives you specific legal rights, and you may also have other rights which vary from state to state.

Except for the engine warranty coverage and the Emissions warranty referenced below, if applicable, there is no other express warranty. The Emissions Control System on your Product may be covered by a separate warranty meeting requirements established by the U.S. Environmental Protection Agency (EPA) or the California Air Resources Board (CARB). The hour limitations set forth above do not apply to the Emissions Control System Warranty. Refer to the California Emission Control Warranty Statement supplied with your Product or contained in the engine manufacturer's documentation for details.

Countries Other than the United States or Canada

Customers who have purchased Toro products exported from the United States or Canada should contact their Toro Distributor (Dealer) to obtain guarantee policies for your country, province, or state. If for any reason you are dissatisfied with your Distributor's service or have difficulty obtaining guarantee information, contact the Toro importer. If all other remedies fail, you may contact us at Toro Warranty Company.