



# Coolant Tank Kit

## Z Master® Riding Mowers

Model No. 117-0940

Form No. 3364-997 Rev A

### Installation Instructions

**Note:** Determine the left and right sides of the machine from the normal operating position.

## Installation

### Loose Parts

Use the chart below to verify that all parts have been shipped.

Procedure	Description	Qty.	Use
<b>1</b>	Cap assembly	1	Install the hose coolant tank.
	Plastic tie	1	
<b>2</b>	Section of plastic covering	1	Install the fan wire protection for Kubota Powered Mowers Only.
	Plastic tie	2	

# 1

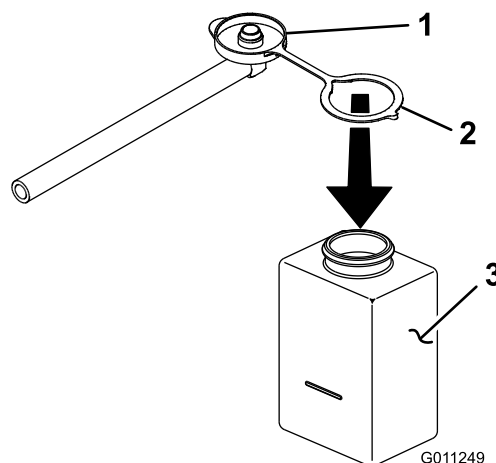
## Installing the Hose and Coolant Tank

### Parts needed for this procedure:

1	Cap assembly
1	Plastic tie

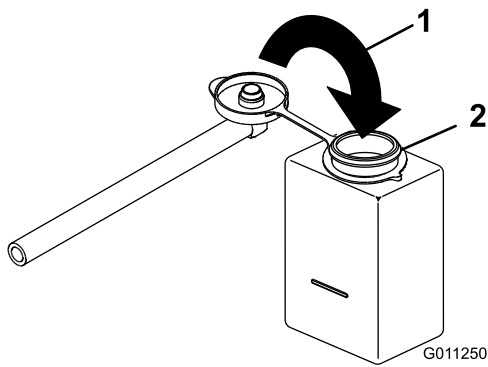
### Procedure

1. Position the machine on a level surface, stop the engine, and set the parking brake.
2. Unlatch the seat and lift it up.
3. Thoroughly clean mower and the area around the coolant tank before installing this kit.
4. Remove the existing coolant tank cap and discard.
5. With the hose assembly upside down, slide the retainer ring over the neck of the coolant bottle. Ensure the new cap and hose assembly is upside down when installing the retainer ring (Figure 1).



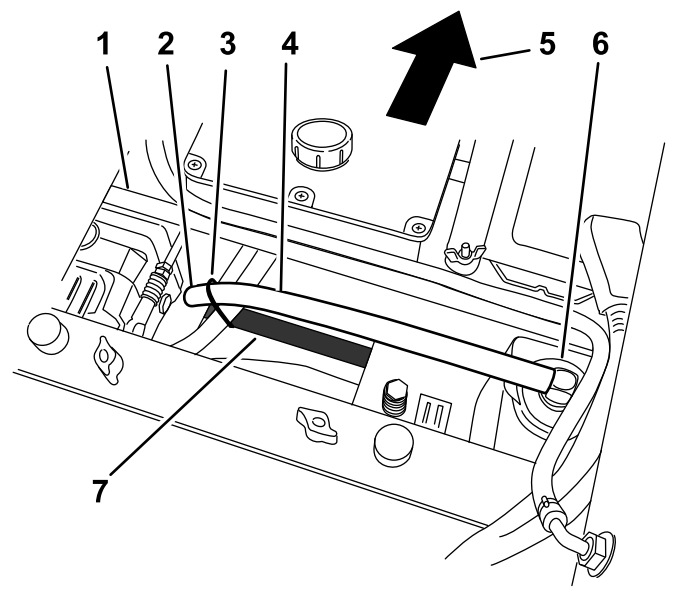
**Figure 1**

1. Cap with retainer ring (upside down to install retainer ring)
  2. Retainer ring
  3. Coolant tank
6. Fold the cap over and snap it onto the bottle (Figure 2). Ensure the cap snaps on tight and seals the coolant bottle.

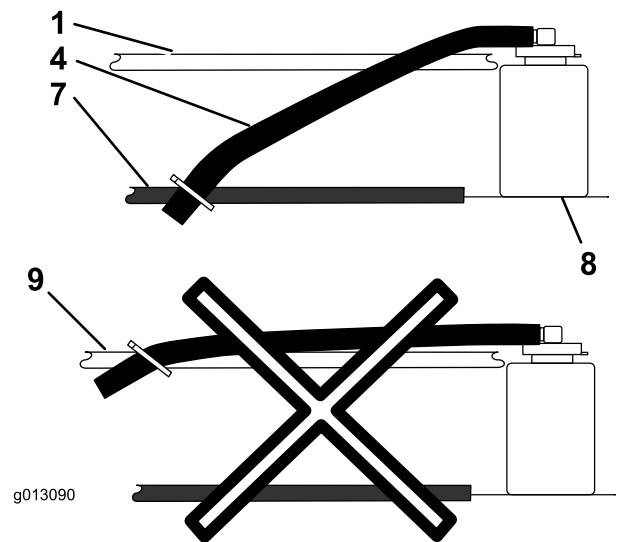


**Figure 2**

1. Fold the cap over
2. Bottle neck with retainer ring



7. Attach the end of the hose to the lower cross bar with a plastic tie. Ensure the hose is not kinked and the end of the hose points down (Figure 3).



**Figure 3**

1. Upper cross bar (**Do Not** use)
2. Ensure the hose end points down
3. Plastic tie
4. Hose (ensure it is not kinked)
5. Front of machine
6. New coolant tank cap
7. Lower cross bar (attach hose here)
8. Side view of the tank and hose
9. **Do Not** connect hose to upper cross bar

8. If needed, add a 50/50 mix of extended life antifreeze/Dex-Cool® and water to the coolant tank up to the indicator line. Refer to Servicing the Cooling System in the *Operator's Manual*.

# 2

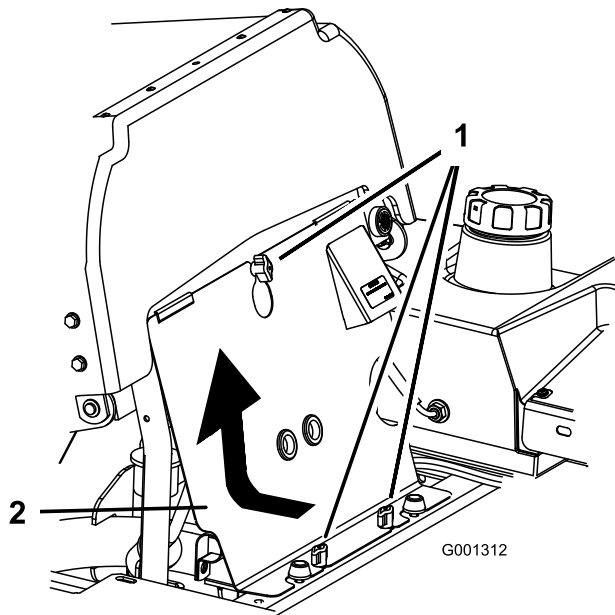
## Installing the Fan Wire Protection for Kubota Powered Mowers Only

### Parts needed for this procedure:

1	Section of plastic covering
2	Plastic tie

### Procedure

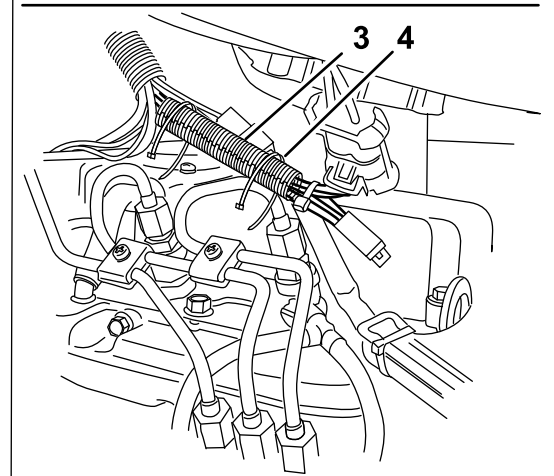
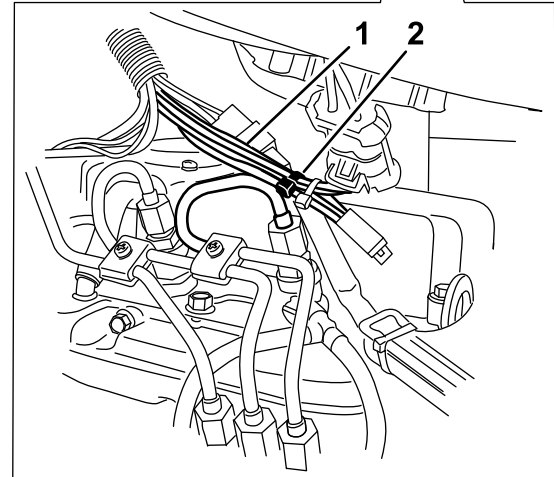
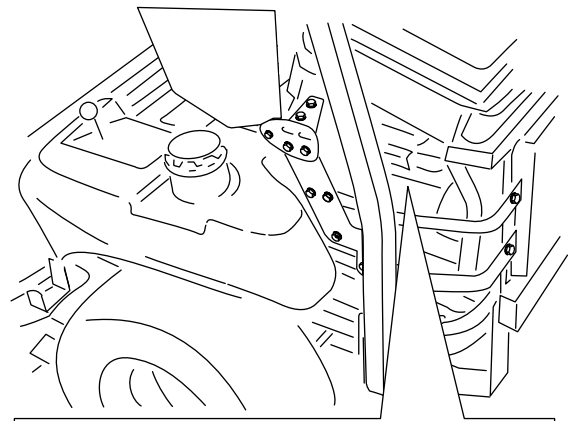
1. Remove the front engine panel (Figure 4).



**Figure 4**

1. Knob
2. Front engine panel

2. Remove the existing plastic tie securing the wires before installing the plastic cover. Refer to Figure 5.
3. Install the plastic cover over the wire lead coming off the wire harness to the fan. Ensure it is the lead coming off of the wire harness. Secure it with 2 plastic ties (Figure 5).



G011744

**Figure 5**

1. Wirelead from the wire harness
2. Remove this existing plastic tie
3. Plastic covering
4. New plastic tie

4. Install the front engine panel.



**Count on it.**