

# **LAWN-BOY®**

Trademark

## **24 Volt Electric WPM**

Model No.10120 – 6900001 & Up

---

# **Parts Catalog**

## ORDERING REPLACEMENT PARTS

To order replacement parts, please supply: the part number, the quantity, and the description of each part desired.

## Contents

Description	Page	Description	Page
Deck, Liner and Wheel Assembly .....	1	Wire Diagram and Side Discharge Chute .....	5
Motor, Batteries and Blade Assembly .....	2		
Cover, Mulch Plug and Panel Assembly .....	3		
Handle and Controls Assembly .....	4	<b>Note:</b>	

## Accessories

Description	Model / Parts No.	Description	Model / Parts No.
-------------	-------------------	-------------	-------------------

## Part Description Abbreviations

Part descriptions in this catalog may include the following abbreviations.

Abbreviation	Meaning	Abbreviation	Meaning
AR .....	as required	HWHTF .....	hex washer head thread forming
ASM .....	assembly	INC .....	incorporated
CARR .....	carriage	LH .....	left hand
DEG .....	degrees	PH .....	pan head
FH .....	flat head	PPH .....	Phillips pan head
GA .....	gauge	PTO .....	power take off
HF .....	hex flange	RH .....	right hand
HFV .....	hex flange washer	SFH .....	slotted fillister head
HH .....	hex head	SH .....	square head
HHF .....	hex head flange	SHWH .....	slotted hex washer head
HHST .....	hex head self tapping	SPH .....	slotted pan head
HJ .....	hex jam	STD .....	standard
HOC .....	height-of-cut	TAP .....	self tapping
HS .....	hex socket	TH .....	truss head
HSBH .....	hex socket button head	TTH .....	Torx truss head
HSFH .....	hex socket flat head	WH .....	wing head
HSH .....	hex socket head		
HWH .....	hex washer head		

## Important Format Explanations

This catalog uses special formats to convey information in illustrations and parts lists. Specifically, one format is used in conjunction with service assemblies and another with quantities associated with reference numbers.

## Service Assemblies

Parts within service assemblies have reference numbers in the form  $X:Y$ .  $X$  is the reference number of the service assembly and  $Y$  is a sequential number unique to each part within the service assembly.

For example, a wheel assembly might be identified by reference number 6, the tire by 6:1, the valve by 6:2, and the wheel by 6:3. When you order the assembly identified by reference number 6, you receive all parts identified by reference numbers 6:1, 6:2, and 6:3. However, you may also order any part individually.

Reference numbers of this type appear in part lists and as callouts in illustrations.

## Reference Numbers with Quantities

Illustrations may have a quantity in parentheses next to a reference number, in the form  $X (Y)$ .  $X$  is the reference number.  $Y$  in parentheses is the quantity of the part identified by the reference number.

For example, the illustration callout 4 (2) indicates that two parts are used in that instance.









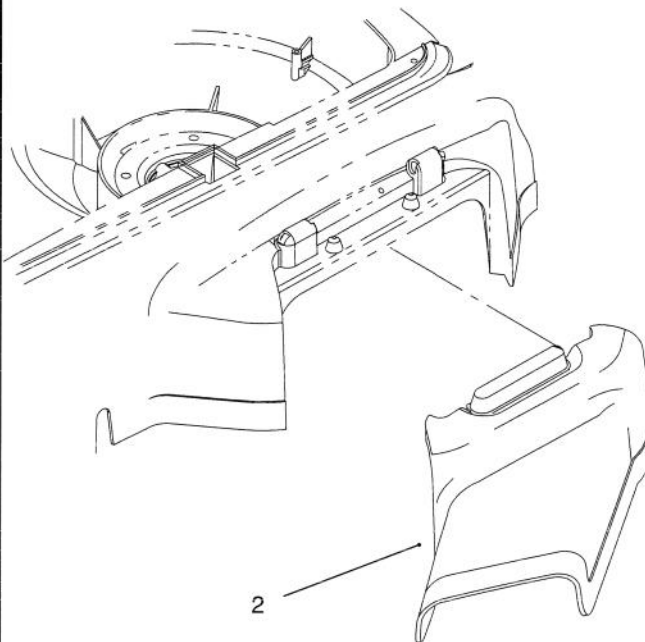
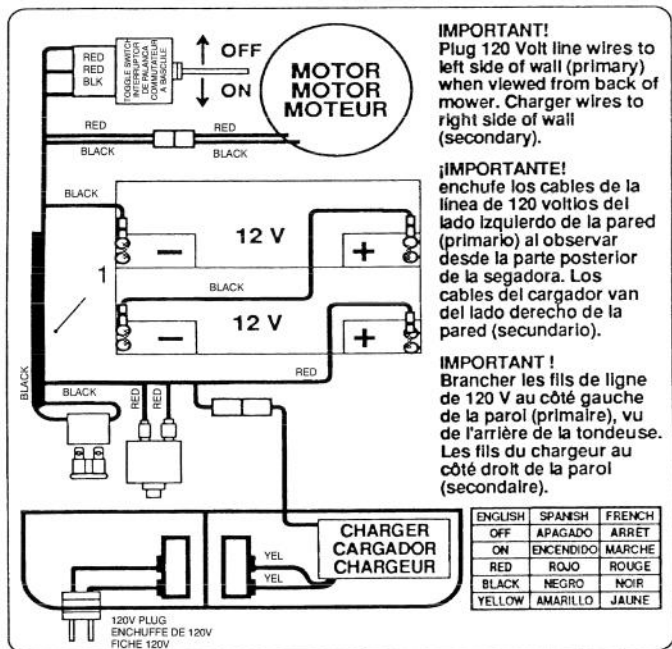

Sheet No.: 6

## Wire Diagram and Side Discharge Chute

Ref. No.	Part No.	Qty.	Description
1	94-1195	1	Harness-Wire
2	93-3963	1	Chute-Side Discharge

Ref. No.	Part No.	Qty.	Description

# Toro Part Number Index

Part No.	Page No.	Ref. No.	Qty.	Description
610358	1	4	4	Nut-Lock
17-3249	4	*	1	Loose Part Kit
19-4050	4	7	2	Knob
40-1940	1	6	4	Washer
49-2040	2	8	4	Screw-HWH
92-1008	1	2	2	Knob-Height Adjust
92-1057	1	15	4	Bolt-Shoulder
92-2260	4	2	2	Screw-Handle
92-8615	3	10	1	Applique-Shroud
93-3332	1	10	1	Transformer
93-3340	2	3	1	Fan
93-3341	2	4	1	Bushing
93-3342	2	2	1	Washer
93-3343	1	11	2	Housing-Transformer
93-3344	3	4	1	Housing-Plug
93-3345	3	14	1	Clamp-Switch
93-3346	3	17	1	Cover-Lever
93-3950	3	1	1	Key
93-3952	1	5	2	Axle
93-3953	2	5	1	Blade
93-3955	1	12	1	Plate-HOC
93-3958	5	1	1	ASM-Battery Wire
93-3963	5	3	1	Chute-Side Discharge
93-3965	4	9	1	Cover-Bail
93-3967	4	14	1	Cam
93-3968	4	16	1	Slide
93-3969	4	11	1	Housing-Bail
93-3970	3	15	1	Switch-Toggle
93-3971	4	3	1	Handle-Upper
93-3972	4	6	1	Handle-Lower
93-3975	3	11	1	Bracket-Cable
93-3976	1	16	1	Trailing Shield
93-3977	4	10	1	Bail
93-3978	4	4	1	Cable-Control
93-3981	3	3	1	ASM-Plug
93-3982	3	5	1	Circuit Breaker
93-3985	1	9	11	Screw-PPH
93-3986	2	13	1	Screw-PPH
93-3986	3	22	4	Screw-PPH
93-3986	4	1	2	Screw-PPH
93-3987	2	10	1	Bolt-Blade
93-3990	3	20	1	Pin-Hinge
93-3994	3	19	1	Spring-Torsion
93-3999	3	16	1	Spring-Switch
94-1154	4	13	1	Spring-Bail
94-1163	3	18	1	Mulch Plug-Inside
94-1164	3	21	1	Mulch Plug-Outside
94-1180	2	6	1	ASM-Strap
94-1191	4	15	1	Nut-Push
94-1194	3	12	2	Clamp-Cable
94-1195	5	2	1	Harness-Wire
94-1197	2	12	3	Tape-Foam
94-1199	1	7	2	ASM-Wheel
94-3850	1	14	2	ASM-Wheel
94-3851	4	12	1	Spring-Slide
94-3857	3	9	1	Decal-Cover
94-3868	4	17	1	Washer-Flat
94-3870	1	3	1	ASM-Rear HOC Lever
94-3871	1	13	1	ASM-Front HOC Lever
94-3881	3	2	1	ASM-Panel
94-3887	2	11	2	Battery Set
94-3896	1	1	1	Deck

\*Not Illustrated

# Toro Part Number Index (cont.)

<b>Part No.</b>	<b>Page No.</b>	<b>Ref. No.</b>	<b>Qty.</b>	<b>Description</b>
94-3897	1	8	1	ASM-Liner
94-4496	2	15	2	Screw-PH
94-4496	3	6	11	Screw-PH
94-4496	4	18	1	Screw-PH
94-6916	3	8	1	ASM-Cover
94-6918	2	1	1	Motor
94-6920	3	7	1	ASM-Charger
94-6961	3	13	5	Screw-PH
94-7340	2	14	1	Strap-Battery 24v
94-7407	4	19	1	Support-Cable
94-7409	4	21	1	Clip-Cable
321-48	4	8	1	Screw-HH
3256-2	4	20	1	Washer-Flat
3290-340	2	9	1	Washer-Spring
3296-8	4	5	1	Nut-Lock
32144-8	2	7	1	Screw-PPH



