



Replacement Throttle Cable Kit

Sand Pro® 3040/5040 Traction Unit

Model No. 119-7188

Installation Instructions

Installing the new Throttle Cable

Note: Ensure the throttle cable does not get kinked or bent. Avoid kinks or bends by ensuring the cable does not make sharp corners.

1. Remove the three bolts holding the control panel to the machine and remove the control panel (Figure 1).
2. Remove the two bolts holding the existing throttle cable lever to the control panel. Save these bolts (Figure 1).

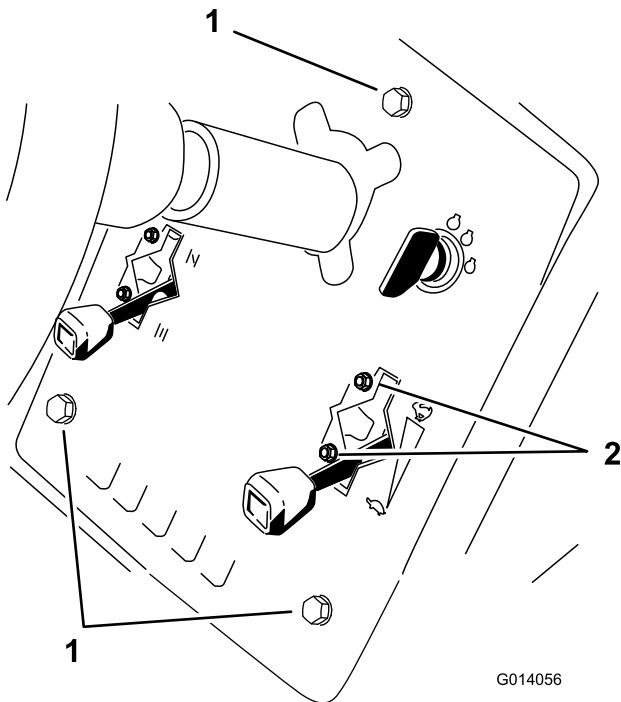

Figure 1

1. Control panel bolts
2. Throttle cable bolts

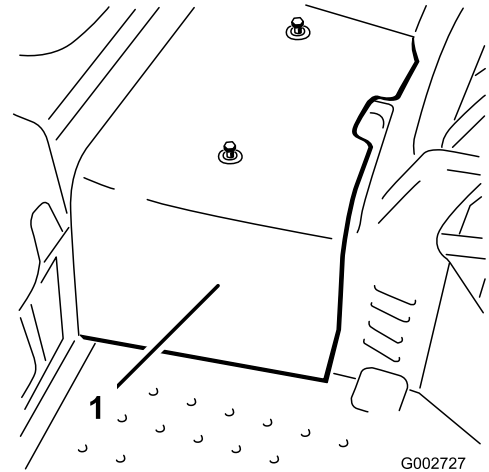
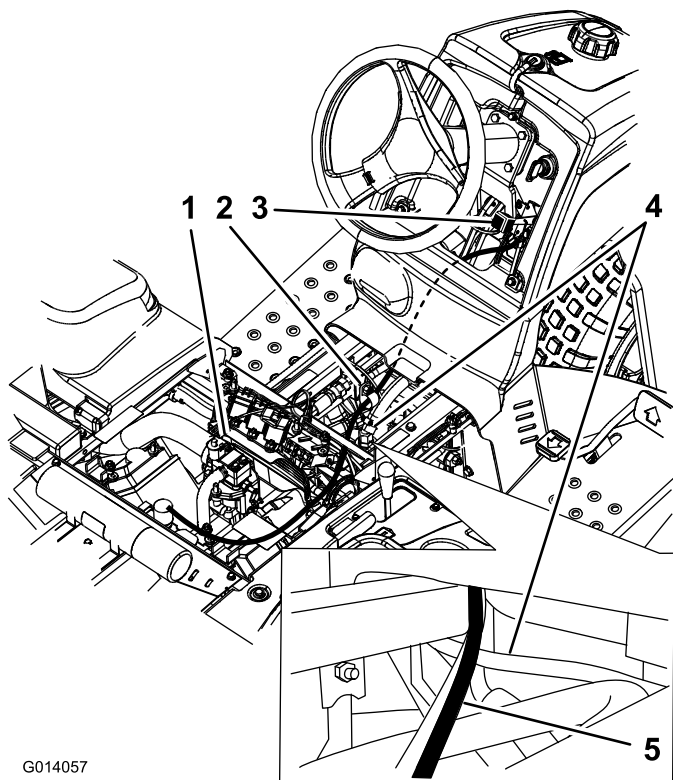

Figure 2

1. Center shroud

4. Pivot the seat upward.
5. Remove throttle cable from the engine swivel, engine clamp and R-clamp under the center shroud.
6. Route the cable down the center of the control panel, through the R-clamp, over the hydraulic hoses, back to the engine and through the engine clamp (Figure 3).

3. Loosen the 2 screws securing the center shroud to the machine and remove the shroud (Figure 2).



G014057

Figure 3

- | | |
|-------------------|---|
| 1. Engine | 4. Hydraulic hoses and hardlines |
| 2. R-clamp | 5. Front view of throttle cable and hydraulic hardlines |
| 3. Throttle lever | |

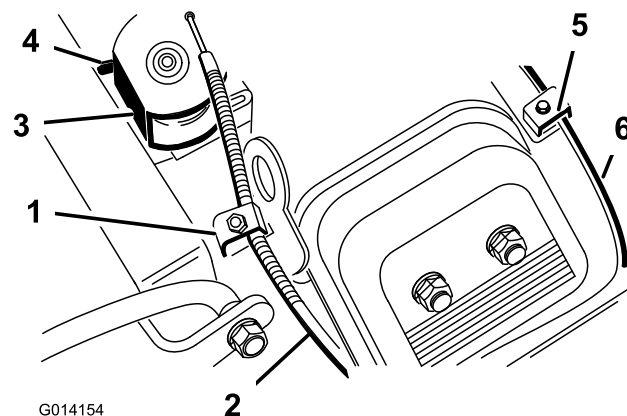

G014154

Figure 4

- | | |
|--------------------------------|-----------------------------|
| 1. Throttle casing clamp screw | 4. Stop |
| 2. Throttle cable | 5. Choke casing clamp screw |
| 3. Swivel | 6. Choke cable |

3. Move the remote throttle control lever forward to the Fast position.
4. Pull firmly on the throttle cable until the back of the swivel contacts the stop (Figure 4).
5. Tighten the cable clamp screw and check the engine RPM setting:
 - High Idle: 3400 + 50
 - Low Idle: 1750 + 100

7. Connect the throttle cable to the engine swivel (Figure 4).
8. Install the new throttle cable to the control panel with the previously removed bolts.

Adjusting the Throttle Control

Proper throttle operation is dependent upon proper adjustment of the throttle control. Before adjusting the carburetor, ensure that the throttle control is operating properly.

1. Pivot the seat upward.
2. Loosen the cable clamp screw securing the cable to the engine (Figure 4).