



Deluxe Suspension Seat Kit

Z100, Z200, Z400 and Z500 Series Z Master® Mowers

Model No. 78530 or 107-1891

Installation Instructions

Installation

Loose Parts

Use the chart below to verify that all parts have been shipped.

Procedure	Description	Qty.	Use
1	No parts required	–	Remove the seat.
2	Bolt (7/16 x 1 inch)	2	Install the seat belt.
3	Deluxe suspension seat	1	Install the seat.
	Spacer (2 holes for Z200/Z500 Series)	2	
	Spacer (3 holes for Z100/Z400 Series)	2	
4	Wire harness	1	Install the wire harness.
	Plastic ties	5	
5	No parts required	–	Test the safety interlock system.
6	Decal	1	Install the decal.

1

Removing the Seat

No Parts Required

Procedure

1. Unlatch the seat and tip the seat forward.
2. Remove the nuts holding the seat to the mounting frame (Figure 1). Retain the nuts.
3. Remove the seat from the frame and set it aside.

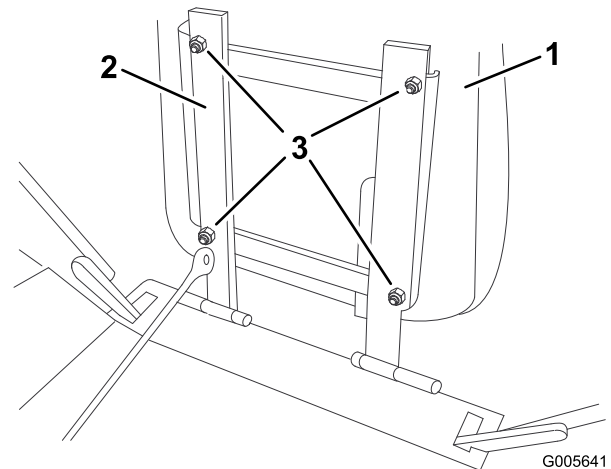

Figure 1

- | | |
|---------------|--------|
| 1. Seat | 3. Nut |
| 2. Seat frame | |

2

Installing the Seat Belt

Parts needed for this procedure:

2	Bolt (7/16 x 1 inch)
---	----------------------

Procedure

⚠ WARNING

Serious injury or death can happen when the seat belt is used without a roll bar installed.

Do not install the seat belt without a roll bar installed.

If you do not have a rollbar, contact an Authorized Service dealer to obtain the correct Roll Over Protection System (ROPS).

⚠ WARNING

To avoid injury or death from rollover: keep the roll bar in the raised locked position and use the seat belt.

Ensure that the rear part of the seat is secured with the seat latch.

The deluxe suspension seat does not come equipped with seat belt restraints. If you are installing the deluxe seat on a machine with a Roll Over Protection System (ROPS), the existing seat belt restraints must be transferred from the old seat.

Do not install and use the seat belt without a roll bar installed. Contact an Authorized Service dealer to obtain the correct Roll Over Protection System (ROPS).

1. Remove the seat belt retractor and receiver from the standard seat by removing the nut and bolt securing the belt assemblies to the seat (Figure 2).

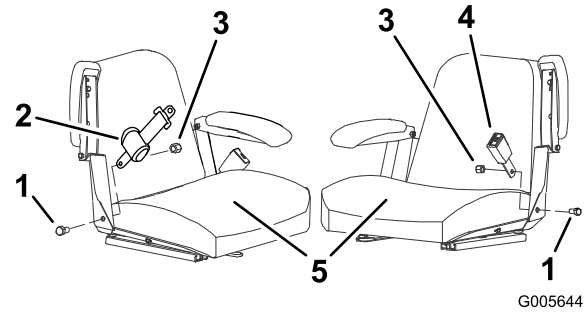

Figure 2

1. Bolt
2. Seat belt retractor
3. Nut
4. Seat belt receiver
5. Seat

2. Install the seat belt retractor and receiver to the deluxe seat using the 2 bolts (7/16 x 1 inch) (Figure 5 & Figure 3).

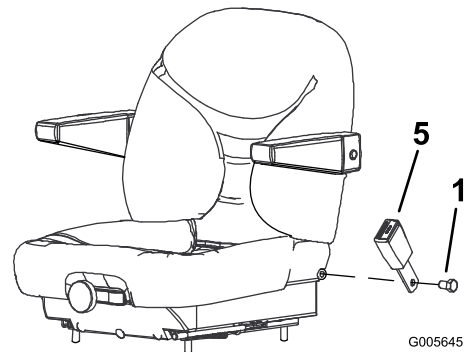
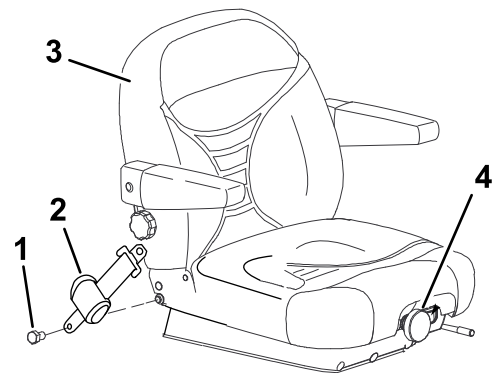

Figure 3

1. Bolt, (7/16 x 1 inch)
2. Seat belt retractor
3. Nut
4. Suspension adjustment knob
5. Seat belt receiver

3

Installing the Seat

Parts needed for this procedure:

1	Deluxe suspension seat
2	Spacer (2 holes for Z200/Z500 Series)
2	Spacer (3 holes for Z100/Z400 Series)

Procedure

1. Place the spacers on the seat mounting frame with the bent ends facing up. **The slot in the spacer is installed to the back of the seat** (Figure 4).

Note: Z Master 100 or 400 Series models are installed with spacers that have 3 holes. Z Master 200 or 500 Series models are installed with spacers that have 2 holes (Figure 4).

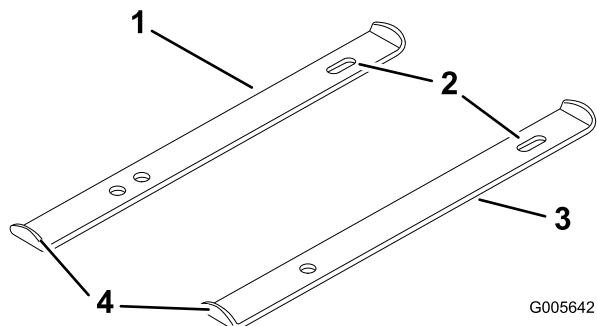

Figure 4

- | | |
|--|--|
| 1. Spacer—3 holes for Z100 or Z400 series models | 3. Spacer—2 holes for Z200 or Z500 series models |
| 2. Slot—install to back of seat | 4. Bent ends |

2. Remove the packing covers guarding the seat track studs.
3. Position the new seat with the seat track studs in the spacers and seat mounting frame (Figure 5).

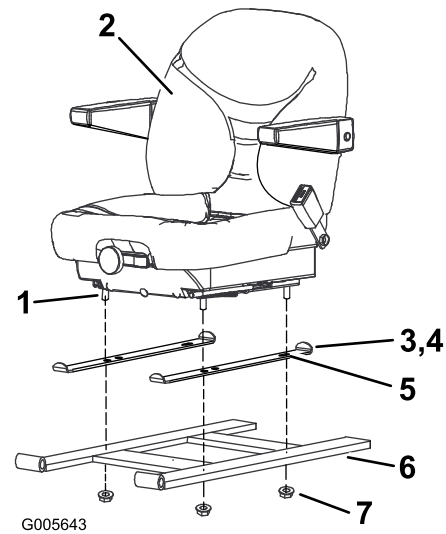

Figure 5

- | | |
|--|------------------------|
| 1. Seat track studs | 5. Slot |
| 2. Seat | 6. Seat mounting frame |
| 3. Spacer (2 holes for Z200 or Z500 series shown) | 7. Nut |
| 4. Spacer (3 holes for Z100 or Z400 series models) | |

Note: If the seat mounting frame has two sets of mounting holes, use the front set of mounting holes.

4. Secure the seat to the seat tracks with the nuts removed previously (Figure 5).

4

Installing the Wire Harness

Parts needed for this procedure:

1	Wire harness
5	Plastic ties

Procedure

1. Locate and disconnect the wire harness connectors that are attached to old seat switch (Figure 7).

Note: Ensure the old switch is removed from the machine.

2. Remove the existing seat switch, bolt, spring, switch bracket, and nuts (Figure 7).

⚠ WARNING

If the safety interlock switches are both connected the machine could operate unexpectedly causing personal injury.

- Ensure the old switch is removed from the machine.
 - Ensure the new harness is connected to the new seat switch in the seat.
 - Check the operation of the interlock switches daily and replace any damaged switches before operating the machine.
3. If your machine has a single connector from the old switch, remove the plastic tie holding the wire harness to the frame near the seat switch (Figure 7). Reconnect the other existing wires to machine frame.
 4. Plug the single connector end of the new wire harness into the connector that was removed from the old seat switch (Figure 7).
 5. If your machine has two leads from the old switch, fold over the wire leads and secure them with a plastic tie cable (Figure 6). Do not use these wire leads.
 6. If your machine has two leads from the old switch, locate the single connector in the main harness near the control panel. Plug the new harness into the single connector from the main harness (Figure 6).

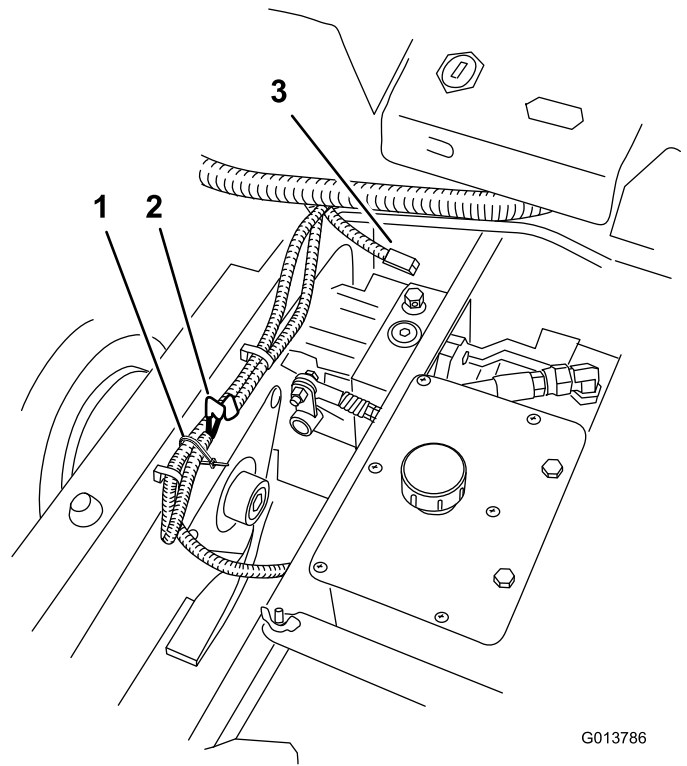

G013786

Figure 6

Kubota powered machine shown

- | | |
|---------------------------------------|---|
| 1. Plastic tie cable | 3. Single connector from main harness (only on machines with two connectors from old switch). |
| 2. Two wire leads from the old switch | |
-
7. Position the wire harness along the seat hold-up rod, over to the seat mounting frame and up to the new switch, located under seat (Figure 7).
 8. Attach the two connectors of the new wire harness into the new seat switch (Figure 7).
 9. Move seat to the furthest rear position. Use the three plastic ties to attach the wire harness to seat hold up rod and seat mounting frame (Figure 7).
 10. Carefully lower the seat down and ensure the harness does not get pinched. If it does, reposition the plastic ties.

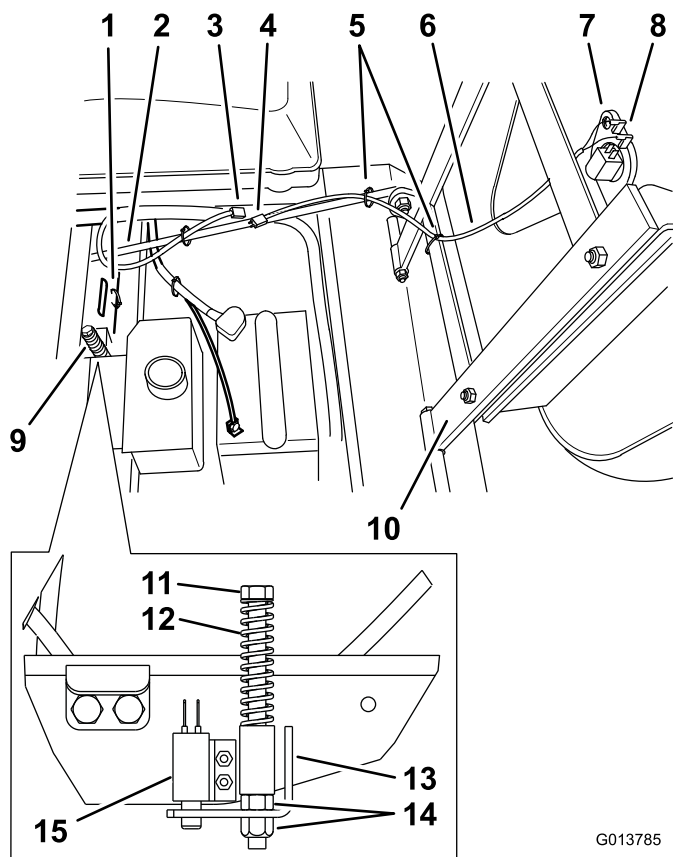

Figure 7

- | | |
|--|-------------------------------------|
| 1. Remove existing plastic tie and replace when done | 9. Old seat switch bracket assembly |
| 2. Seat hold-up rod | 10. Seat mounting frame |
| 3. Single connector from old seat switch | 11. Bolt |
| 4. Single connector on new harness | 12. Spring |
| 5. Plastic ties | 13. Switch bracket |
| 6. New wire harness | 14. Nuts |
| 7. New seat switch | 15. Old seat switch (remove) |
| 8. Two connectors from new harness | |

5

Testing the Safety Interlock System

No Parts Required

Procedure

⚠ WARNING

If safety interlock switches are disconnected or damaged the machine could operate unexpectedly causing personal injury.

- **Do not tamper with the interlock switches.**
- **Check the operation of the interlock switches daily and replace any damaged switches before operating the machine.**

The safety interlock system is designed to prevent the engine from starting unless:

- The parking brake is engaged.
- The power take off (PTO) is disengaged.
- The motion control levers are in the neutral locked position.

The safety interlock system also is designed to stop the engine when the traction controls are moved from the locked position with the parking brake engaged or if you rise from the seat when the PTO is engaged.

Test the safety interlock system before you use the machine each time. If the safety system does not operate as described below, have an Authorized Service Dealer repair the safety system immediately.

1. Sitting on the seat, engage the parking brake and move the PTO to on. Try starting the engine; the engine should not crank.
2. Sitting on the seat, engage the parking brake and move the PTO to off. Move either motion control lever (out of neutral locked position). Try starting the engine; the engine should not crank. Repeat for other control lever.
3. Sitting on the seat, engage the parking brake, move the PTO switch to off and move the motion control levers to neutral lock position. Now start the engine. While the engine is running, release the parking brake, engage the PTO and rise slightly from the seat; the engine should stop.
4. Sitting on the seat, engage the parking brake, move the PTO switch to off and move the motion control

levers to neutral lock position. Now start the engine. While the engine is running, center either motion control and move (forward or reverse); the engine should stop. Repeat for other motion control.

5. Sitting on the seat, disengage the parking brake, move the PTO switch to off and move the motion control levers to neutral lock position. Try starting the engine; the engine should not crank.

6

Installing the Decal

Parts needed for this procedure:

1	Decal
---	-------

Procedure

Remove the backing off the decal and place the decal on the back of the seat as shown in Figure 8.

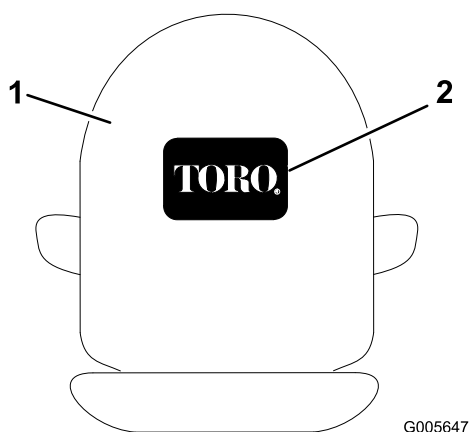

Figure 8

1. Back of seat

2. Decal

Operation

Adjusting the Suspension Seat

Use the adjustment knob and weight gauge located in the front of the seat to adjust the seat suspension to the weight of the operator Figure 3.

Notes:



Count on it.