



Heat Shield Kit

Multi-Pro® 5800 Turf Sprayer

Model No. 41601

Installation Instructions

⚠ CAUTION

Engine components will be hot if the machine has been running. If you contact or come near any hot components, you may be burned.

Allow the machine to cool before installing this kit.

Loose Parts

Use the chart below to verify that all parts have been shipped.

Procedure	Description	Qty.	Use
1	Muffler heat shield	1	Install the muffler heat shield.
	U-nut (5/16 inch)	4	
	Hex head flange bolt (5/16 x 3/4 inch)	2	
	Hex washer head, self-tapping bolt (5/16 x 3/4 inch)	2	
2	Rear engine heat shield	1	Install the rear engine heat shield.
	Heat shield strap	2	
	Plastic plug	6	
	Hex head flange bolt (5/16 x 3/4 inch)	2	
	Flat washer	2	
	Carriage bolt	1	
	Hex head bolt (5/16 x 2-1/2 inch)	1	
	Hex head bolt (5/16 x 1-1/4 inch)	2	
	Flange nut (5/16 inch)	4	
3	Tailpipe heat shield	1	Install the tailpipe heat shield.
	Hex head flange bolt (5/16 x 3/4 inch)	3	
	Hex flange nut	3	

1

Installing the Muffler Heat Shield

Parts needed for this procedure:

1	Muffler heat shield
4	U-nut (5/16 inch)
2	Hex head flange bolt (5/16 x 3/4 inch)
2	Hex washer head, self-tapping bolt (5/16 x 3/4 inch)

Procedure

1. Attach the 4 U-nuts to the muffler heat shield (Figure 1).

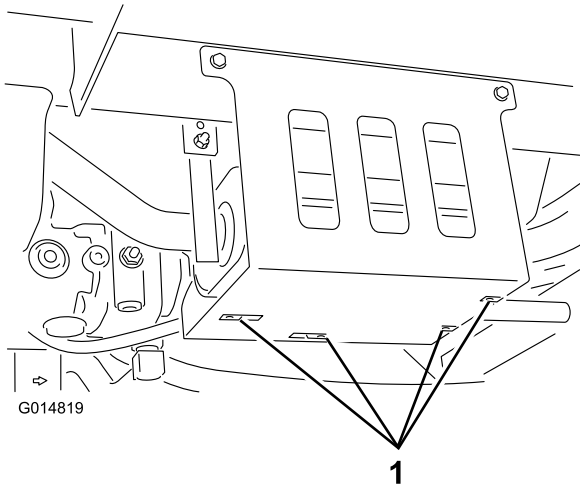

Figure 1

1. U-nuts

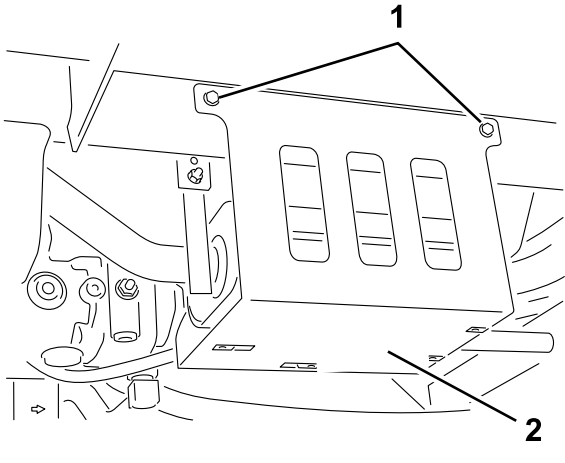

Figure 2

1. Self-tapping bolts
2. Muffler heat shield
3. Muffler heat shield (opposite view)
4. Hex head bolts and hex flange nuts
5. Cross member

2. Attach the muffler heat shield to the frame and the cross member with 2 self-tapping bolts and 2 hex head bolts and hex flange nuts (Figure 2).

2

Installing the Rear Engine Heat Shield

Parts needed for this procedure:

1	Rear engine heat shield
2	Heat shield strap
6	Plastic plug
2	Hex head flange bolt (5/16 x 3/4 inch)
2	Flat washer
1	Carriage bolt
1	Hex head bolt (5/16 x 2-1/2 inch)
2	Hex head bolt (5/16 x 1-1/4 inch)
4	Flange nut (5/16 inch)

Procedure

1. Insert the heat shield straps into the slots in the rear engine heat shield (Figure 3), and secure the straps to the shield with 6 plastic plugs.

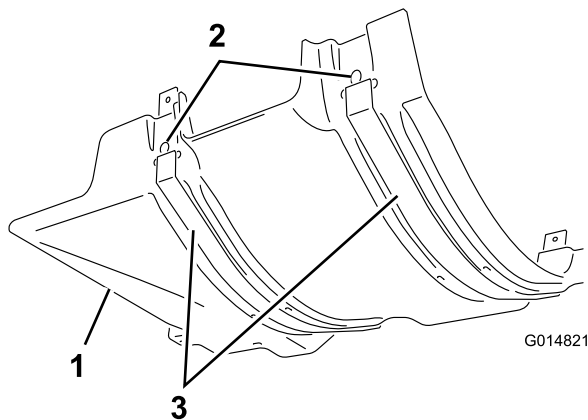

Figure 3

1. Rear engine heat shield
2. Plastic plugs (6)
3. Heat shield straps

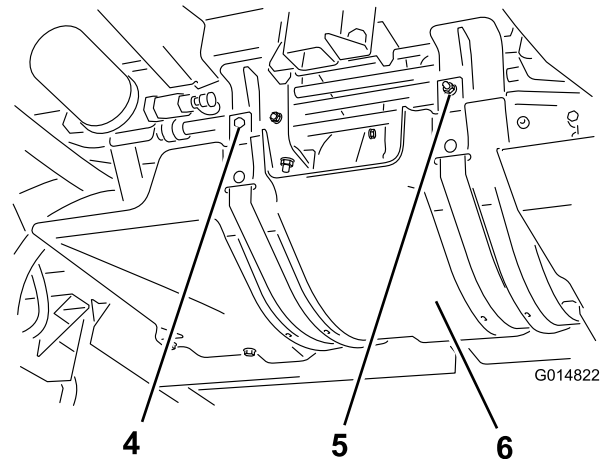
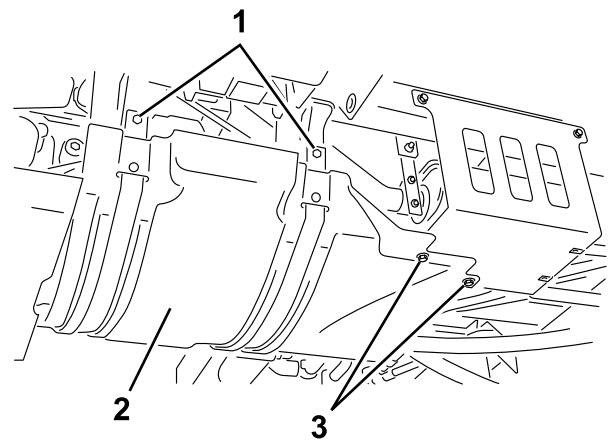

Figure 4

1. Hex head flange bolts (5/16 x 1-1/4 inch) and hex flange nuts
2. Rear engine heat shield
3. Hex head flange bolt (5/16 x 3/4 inch) and flat washer
4. Hex head bolt (5/16 x 2-1/2 inch) and flange nut
5. Carriage bolt and flange nut
6. Rear engine heat shield (opposite view)

Note: These bolts replace existing bolts in the machine (Figure 4).

Note: Turn the hydraulic hose fittings, if necessary, so that the hoses do not come into contact with the shield.

Note: Install the plastic plugs from the outside of the shield inward.

2. Attach the heat shield and straps to the motor mounts with 2 hex head bolts (5/16 x 1-1/4 inch), a carriage bolt, a hex head bolt (5/16 x 2-1/2 inch), and 4 flange nuts as shown in Figure 4.

3

Installing the Tailpipe Heat Shield

Parts needed for this procedure:

1	Tailpipe heat shield
3	Hex head flange bolt (5/16 x 3/4 inch)
3	Hex flange nut

Procedure

Attach the tailpipe heat shield to the muffler heat shield and the tank bracket and step as shown in Figure 5.

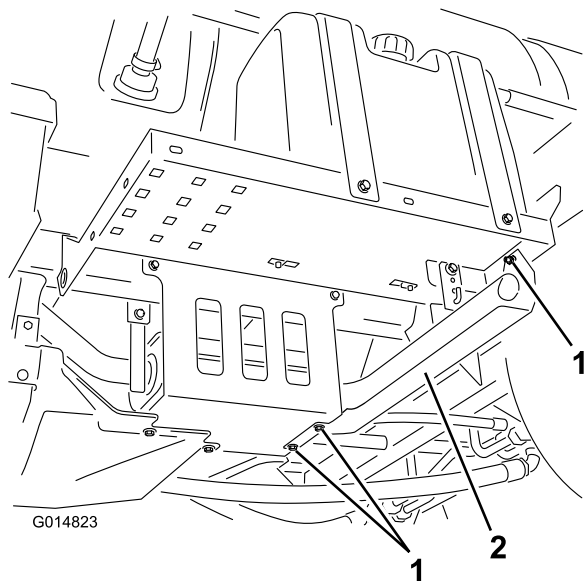

Figure 5

1. Hex head flange bolts and hex flange nuts 2. Tailpipe heat shield