



# Replacement Blade Kit

2007 and After TimeCutter® Riding Mowers with 50in Mowers

Model No. 79016

## Installation Instructions

### Loose Parts

Use the chart below to verify that all parts have been shipped.

Description	Qty.	Use
No parts required	–	Remove the blades.
Blades	3	Install the blades.

### Removing the Blades

Hold the blade end using a rag or thickly-padded glove. Remove the blade bolt, curved washer, blade stiffener and blade from the spindle shaft (Figure 1).

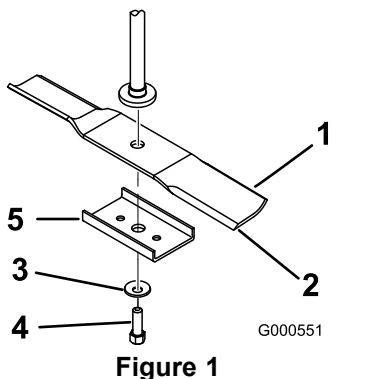

- 1. Sail area of blade
- 2. Blade
- 3. Curved washer
- 4. Blade bolt
- 5. Blade Stiffener

Retain the blade stiffener for use with blades that require it. The replacement blades within this kit have a different design which does not require the stiffener. (Figure 2)

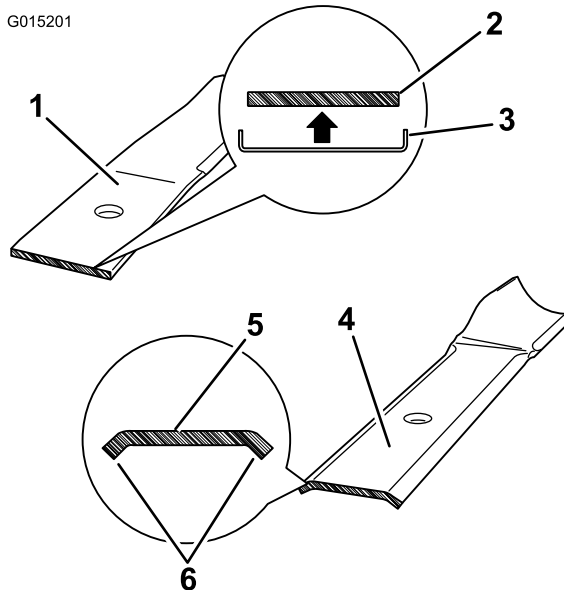

Figure 2

- 1. Standard blade
- 2. Cross section of standard blade
- 3. Stiffener required
- 4. New blade
- 5. Cross section of new blade
- 6. Bends in cross section provides internal rigidity.

### Installing the Blades

1. Install the blade onto the spindle shaft (Figure 3).



**Important:** The curved part of the blade must be pointing upward toward the inside of the mower to ensure proper cutting.

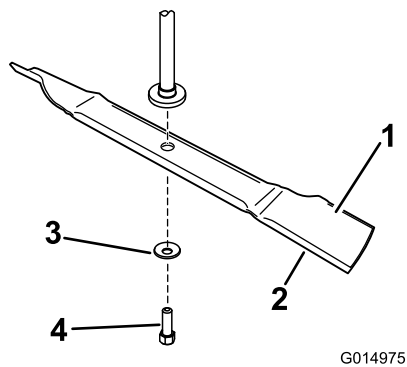

**Figure 3**

- |                       |                  |
|-----------------------|------------------|
| 1. Sail area of blade | 3. Curved washer |
| 2. Blade              | 4. Blade bolt    |

- 
2. Install the curved washer (cupped side toward the blade) and the blade bolt (Figure 3). **Do not install a blade stiffener.**

These blades do not require the blade stiffener bracket (Figure 2).

3. Torque the blade bolt to 35-65 ft-lb (47-88 N-m).