



Replacement Blade Kit

2007 and After TimeCutter® Riding Mowers with 50in Mowers

Model No. 79016

Form No. 3367-350 Rev A

Installation Instructions

Loose Parts

Use the chart below to verify that all parts have been shipped.

Description	Qty.	Use
No parts required	—	Remove the blades.
Blades	3	Install the blades.

Removing the Blades

Hold the blade end using a rag or thickly-padded glove. Remove the blade bolt, curved washer, blade stiffener and blade from the spindle shaft (Figure 1).

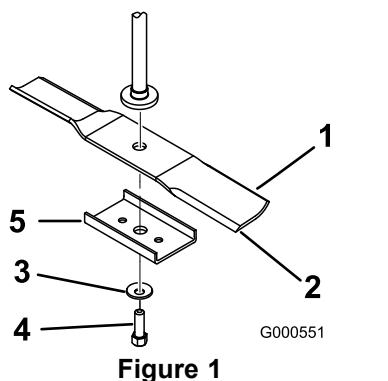

Figure 1

1. Sail area of blade
2. Blade
3. Curved washer
4. Blade bolt
5. Blade Stiffener

Retain the blade stiffener for use with blades that require it. The replacement blades within this kit have a different design which does not require the stiffener. (Figure 2)

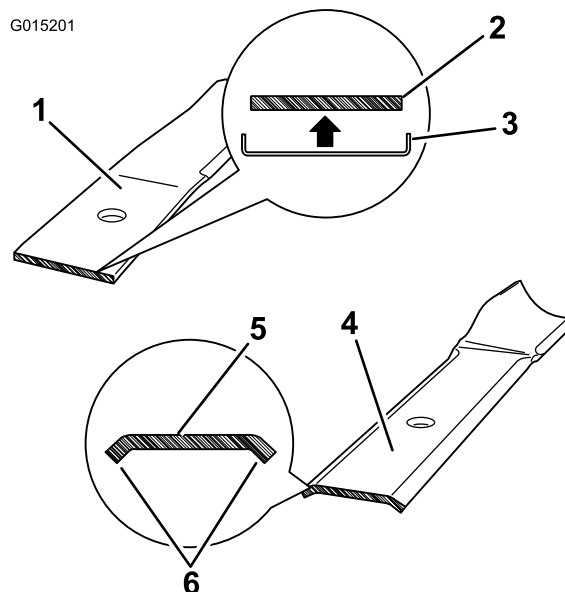

Figure 2

1. Standard blade
2. Cross section of standard blade
3. Stiffener required
4. New blade
5. Cross section of new blade
6. Bends in cross section provides internal rigidity.

Installing the Blades

1. Install the blade onto the spindle shaft (Figure 3).

Important: The curved part of the blade must be pointing upward toward the inside of the mower to ensure proper cutting.

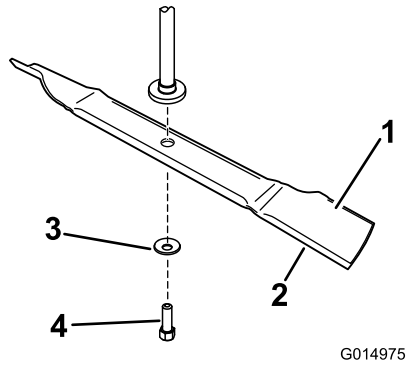

Figure 3

- | | |
|-----------------------|------------------|
| 1. Sail area of blade | 3. Curved washer |
| 2. Blade | 4. Blade bolt |

-
2. Install the curved washer (cupped side toward the blade) and the blade bolt (Figure 3). **Do not install a blade stiffener.**

These blades do not require the blade stiffener bracket (Figure 2).

3. Torque the blade bolt to 35-65 ft-lb (47-88 N-m).