



Workman® MD/MDX/MDE Bed Mount Kit

Pro Force™ Debris Blower

Model No. 44543—Serial No. 311000001 and Up

Model No. 44544—Serial No. 311000001 and Up

Model No. 44545—Serial No. 311000001 and Up

Installation Instructions

Loose Parts

Use the chart below to verify that all parts have been shipped.

Procedure	Description	Qty.	Use
1	No parts required	–	Prepare the ProForce.
2	Skid mount Flange nut (3/8 inch) Bolt (3/8 x 3 inches) Carriage bolt (3/8 x 1 inch)	2 6 2 4	Install the skid plates to the ProForce.
3	Friction lock plate Mounting bracket Flange nut (3/8 inch) Carriage bolt (3/8 x 1 inch) Carriage bolt (3/8 x 2 inches)	4 4 16 8 8	Install the ProForce on 2010 and older mid-duty vehicles.
4	Bed rail Bed stake Spacer Flange bolt (1/4 x 1-1/4 inches) Flat washer (1/4 inch) Flange nut (1/4 inch) Carriage bolt (3/8 x 1 inch) Flange nut (3/8 inch) Carriage bolt (3/8 x 1-1/2 inches)	2 4 4 8 8 8 8 16 8	Install the ProForce on 2011 and newer mid-duty vehicles.
5	Stake Locking plate Flange nut (3/8 inch) Carriage bolt (3/8 x 1 inch)	4 4 12 12	Install the ProForce on heavy duty vehicles.
6	Purchase correct hardware		Install the ProForce on universal vehicles.
7	Position indicator Rivot Chute bracket Carriage bolt (10-24 x 5/8 inches) Nozzle mount Locknut (10-24) Hitch pin Flange nut (1/4 inch) Extension shell Nozzle keel Bolt (1/4 x 3/4 inches)	1 3 2 4 2 4 2 10 2 2 10	Install the extension.

1

Preparing the ProForce™

No Parts Required

Procedure

Remove the tires, tow hitch, fenders and the stub axles from the ProForce trailer.

2

Installing the Skid Plates to the ProForce

Parts needed for this procedure:

2	Skid mount
6	Flange nut (3/8 inch)
2	Bolt (3/8 x 3 inches)
4	Carriage bolt (3/8 x 1 inch)

Procedure

- Using the same holes the stub shafts were installed in, install the skid plates to the left and right sides of the ProForce frame with 4 carriage bolts (3/8 x 1 inch) and 2 flange nuts (3/8 inch).

Install the carriage bolts into the rear holes of the skid plates.

- Install the new short tube hitch with 2 bolts (3/8 x 3 inches) and 2 flange nuts (3/8 inch).

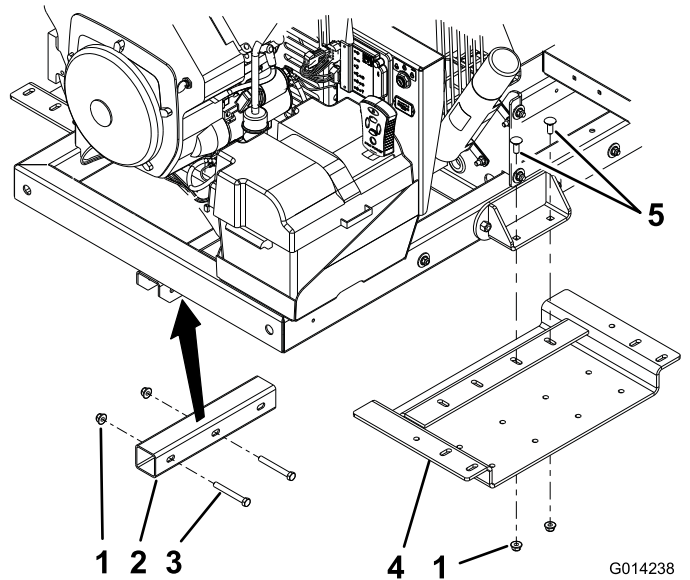

Figure 1

Mid-duty machines

- | | |
|--------------------------|------------------------------------------|
| 1. Flange nut (3/8 inch) | 4. Left hand skid plate (Mid-Duty shown) |
| 2. Short tube hitch | 5. Carriage bolt (3/8 x 1 inch) |
| 3. Bolt (3/8 x 3 inches) | |

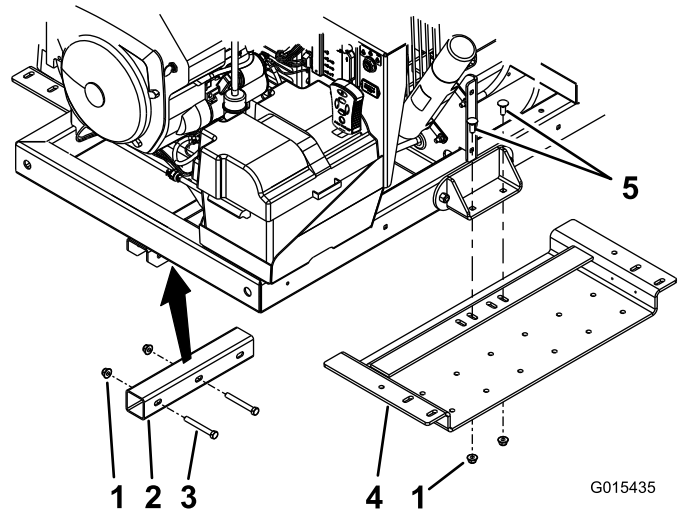

Figure 2

Heavy duty machines

- | | |
|--------------------------|------------------------------------------|
| 1. Flange nut (3/8 inch) | 4. Left hand skid plate (Mid-Duty shown) |
| 2. Short tube hitch | 5. Carriage bolt (3/8 x 1 inch) |
| 3. Bolt (3/8 x 3 inches) | |

3

Installing the ProForce on 2010 and Older Mid-Duty Vehicles

Parts needed for this procedure:

4	Friction lock plate
4	Mounting bracket
16	Flange nut (3/8 inch)
8	Carriage bolt (3/8 x 1 inch)
8	Carriage bolt (3/8 x 2 inches)

Procedure

1. Remove the end gate attached to the bed of the vehicle.
2. Install the ProForce unit into the bed of the vehicle.
3. For mid-duty vehicles 2010 and older, install the 4 friction lock plates into the slots and install the 4 mounting brackets to the skid plates and friction lock plates with 8 carriage bolts (3/8 x 1 inch), 8 carriage bolts (3/8 x 2 inches) and 16 flange nuts (3/8 inch) (Figure 3).

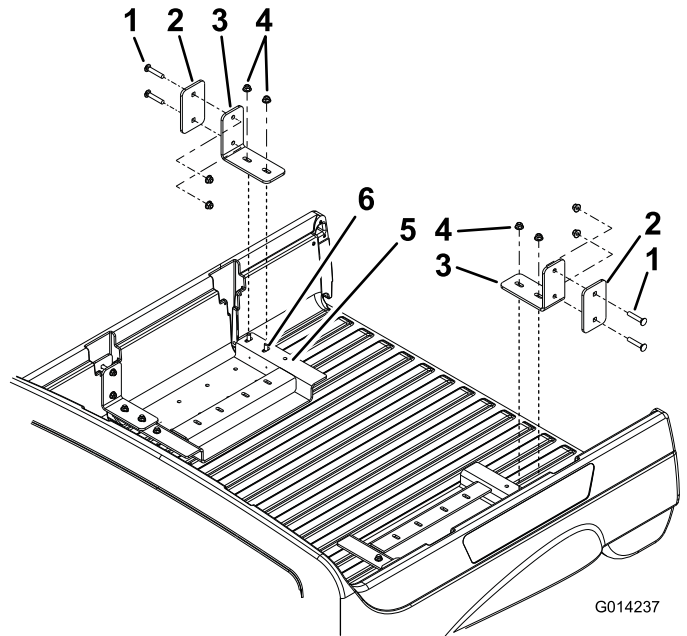

Figure 3

Mid-duty vehicles 2010 and older

- | | |
|-----------------------------------|------------------------------------------------|
| 1. Carriage bolt (3/8 x 2 inches) | 4. Flange nut (3/8 inch) |
| 2. Friction lock plate | 5. Skid plate (shown not attached to ProForce) |
| 3. Mounting bracket | 6. Carriage bolt (3/8 x 1 inch) |

4

Installing the ProForce on 2011 and Newer Mid-Duty Vehicles

Parts needed for this procedure:

2	Bed rail
4	Bed stake
4	Spacer
8	Flange bolt (1/4 x 1-1/4 inches)
8	Flat washer (1/4 inch)
8	Flange nut (1/4 inch)
8	Carriage bolt (3/8 x 1 inch)
16	Flange nut (3/8 inch)
8	Carriage bolt (3/8 x 1-1/2 inches)

Procedure

1. Remove the end gate attached to the bed of the vehicle.
2. Install the ProForce unit into the bed of the vehicle.

- For mid-duty vehicles 2011 and newer, install the bed rails to the side of the bed with 8 flange bolts (1/4 x 1-1/4 inches) and 4 flange nuts (1/4 inch) (Figure 4).
- Install the 4 bed stakes to the bed rails with 4 spacers, 8 carriage bolts (3/8 x 1-1/2 inches) and 8 flange nuts (3/8 inch) (Figure 4).
- Install the 4 bed stakes to the skid plates with 8 carriage bolts (3/8 x 1 inch), 8 carriage bolts (3/8 x 2 inches) and 8 flange nuts (3/8 inch) (Figure 4).

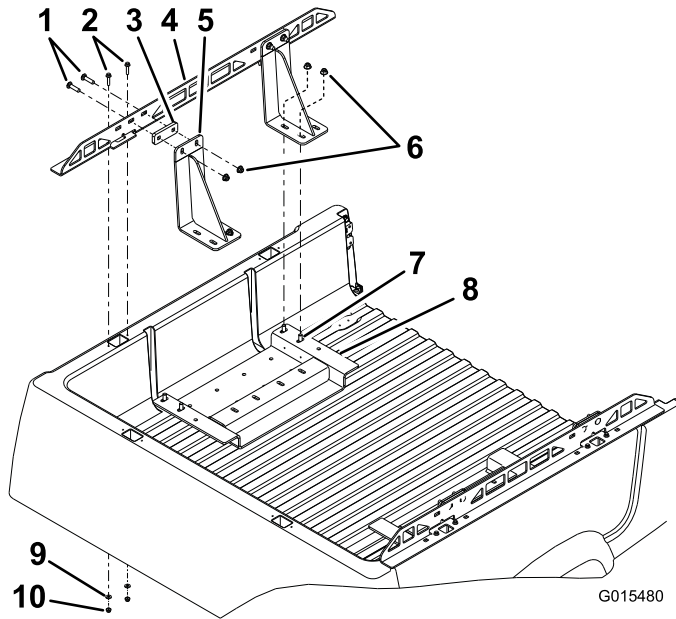

Figure 4

Mid-duty vehicles 2011 and newer

- | | |
|---------------------------------------|------------------------------------------------|
| 1. Carriage bolt (3/8 x 1-1/2 inches) | 6. Flange nut (3/8 inch) |
| 2. Flange bolt (1/4 x 1-1/4 inches) | 7. Carriage bolt (3/8 x 1 inch) |
| 3. Spacer | 8. Skid plate (shown not attached to ProForce) |
| 4. Bed rail | 9. Flat washer (1/4 inch) |
| 5. Bed stake | 10. Flange nut (1/4 inch) |

5

Installing the ProForce on Heavy Duty Vehicles

Parts needed for this procedure:

4	Stake
4	Locking plate
12	Flange nut (3/8 inch)
12	Carriage bolt (3/8 x 1 inch)

Procedure

- For heavy-duty vehicles, install the 4 stakes into the slots in the bed and fasten the stakes to the skid plates with 8 carriage bolts (3/8 x 1 inch) and 8 flange nuts (3/8 inch) (Figure 5).

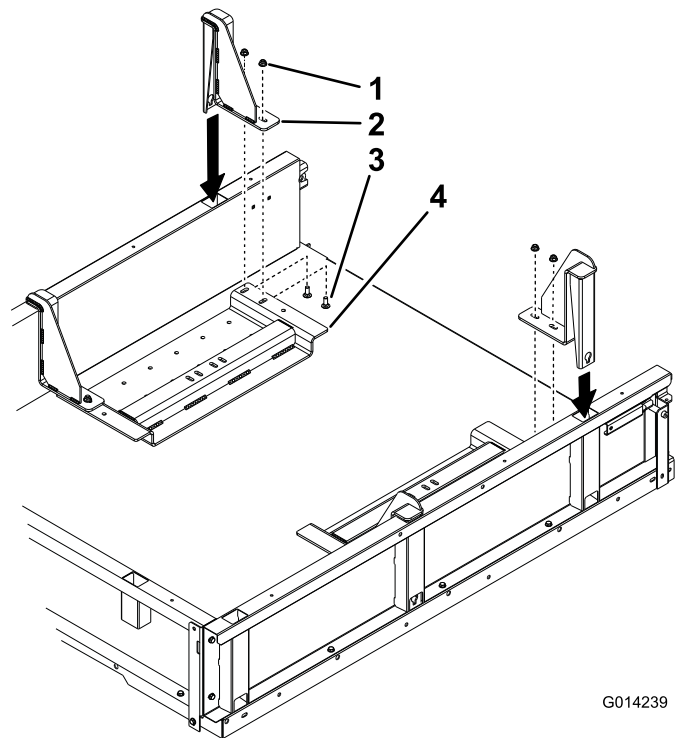

Figure 5

- | | |
|--------------------------|------------------------------------------------|
| 1. Flange nut (3/8 inch) | 3. Carriage bolt (3/8 x 1 inch) |
| 2. Stake | 4. Skid plate (shown not attached to ProForce) |

- Assemble the 4 carriage bolts (3/8 x 1 inch), 4 locking plates and 4 flange nuts (3/8 inch) (Figure 6).
- Secure the 4 stakes to the bed by installing the carriage bolt head into the key hole and sliding it down. Tighten the carriage bolts (Figure 6).

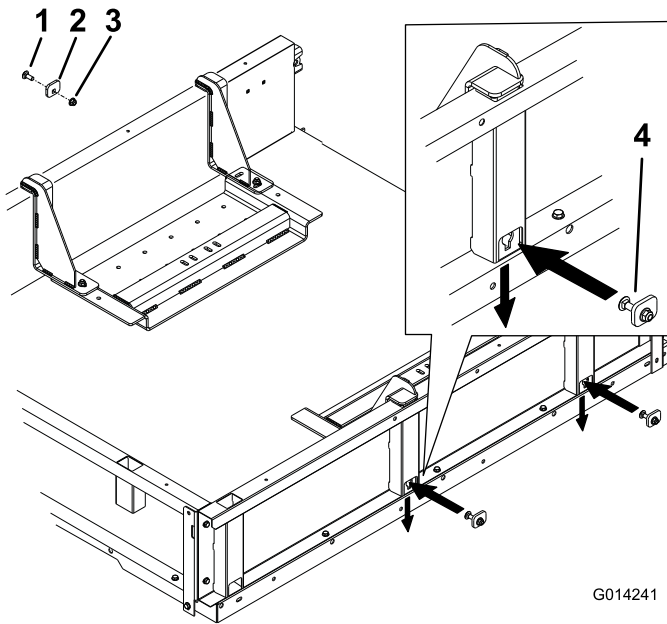

Figure 6

- | | |
|--------------------------|-----------------------------------|
| 1. Flange nut (3/8 inch) | 3. Carriage bolt (3/8 x 2 inches) |
| 2. Locking plate | 4. Locking plate assembly |

G014241

7

Installing the Extension

Parts needed for this procedure:

1	Position indicator
3	Rivot
2	Chute bracket
4	Carriage bolt (10-24 x 5/8 inches)
2	Nozzle mount
4	Locknut (10-24)
2	Hitch pin
10	Flange nut (1/4 inch)
2	Extension shell
2	Nozzle keel
10	Bolt (1/4 x 3/4 inches)

Procedure

1. Assemble the two extension shells and the two nozzle keels in between the extension shells with 10 bolts (1/4 x 3/4 inches) and 10 flange nuts (1/4 inch) (Figure 7).

6

Installing the ProForce on Universal Vehicles

Parts needed for this procedure:

Purchase correct hardware

Procedure

For universal vehicles, you will need to purchase the correct hardware to fasten the ProForce to the vehicle. Adjust the position of the ProForce to allow the nozzle to rotate without hitting the bed. Using the rear holes, mark and drill holes into the bed and fasten the ProForce to the bed of the vehicle.

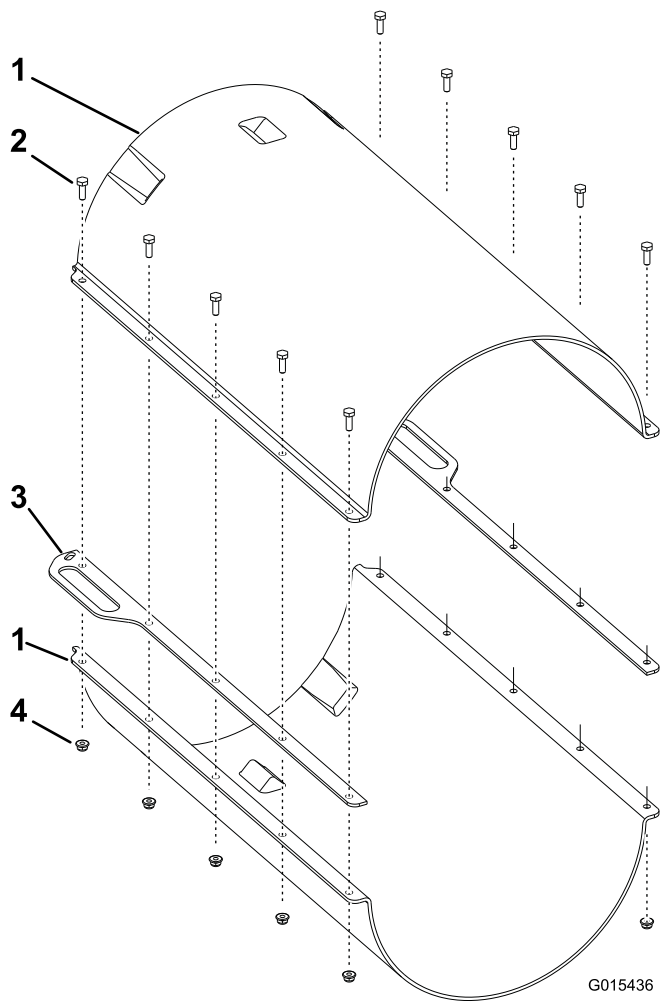
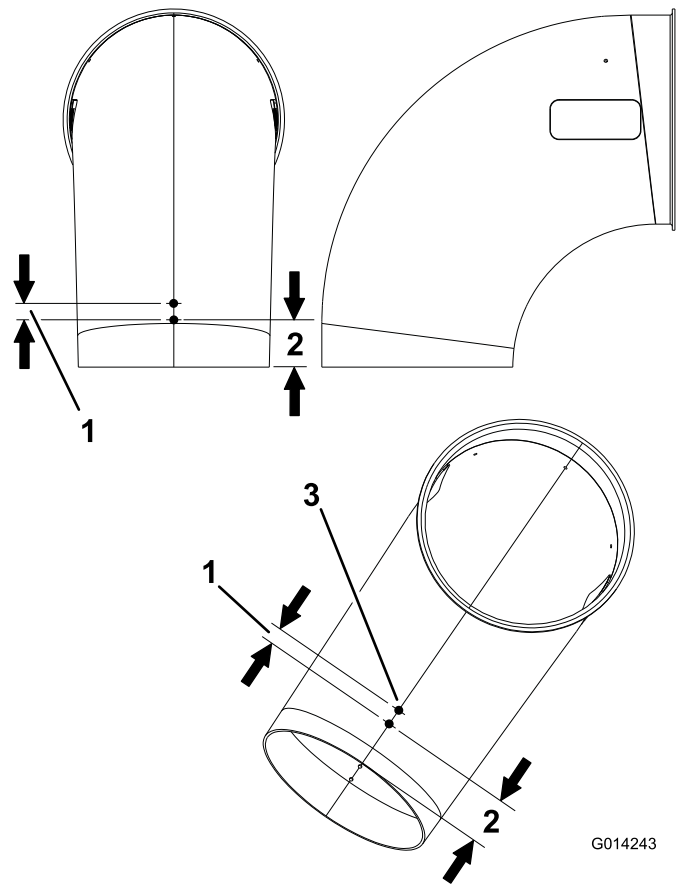

Figure 7

- | | |
|----------------------------|--------------------------|
| 1. Extension shells | 3. Nozzle keel |
| 2. Bolt (1/4 x 3/4 inches) | 4. Flange nut (1/4 inch) |

2. For 2010 and older machines, drill the four 1/4 inch holes shown in Figure 8 for the chute brackets.



G014243

Figure 8

- | | |
|---------------------------|-----------------------------|
| 1. 1-1/8 inches (28.5 mm) | 3. Drill 1/4 inch holes (4) |
| 2. 3-1/4 inches (82.5 mm) | |

3. For 2010 and older machines, drill the three 1/4 inch holes shown in Figure 9 for the position indicator.
4. Install the position indicator with the 3 rivots (Figure 10).

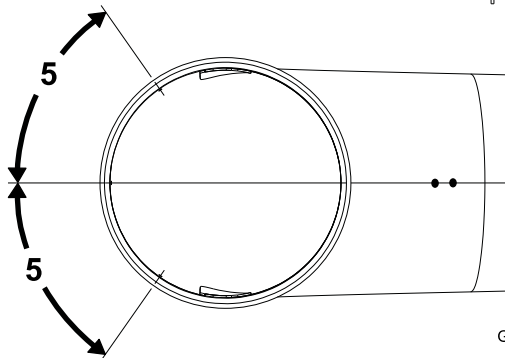
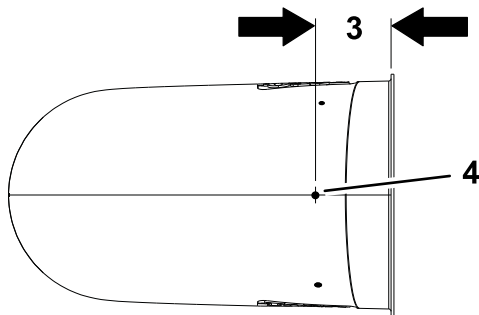
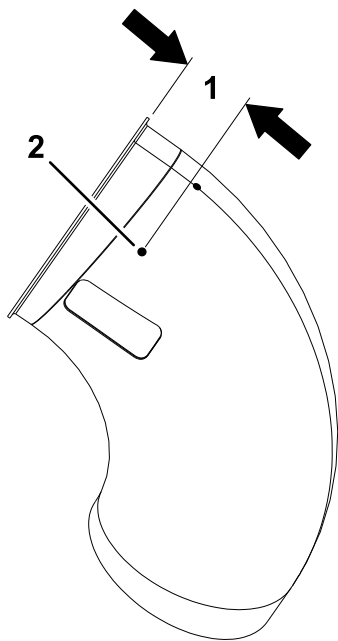

G014240

Figure 9

- | | |
|----------------------------|------------------------|
| 1. 4-3/8 inches (111 mm) | 4. Drill 1/4 inch hole |
| 2. Drill 1/4 inch hole | 5. 55 degrees |
| 3. 4-3/4 inches (120.6 mm) | |

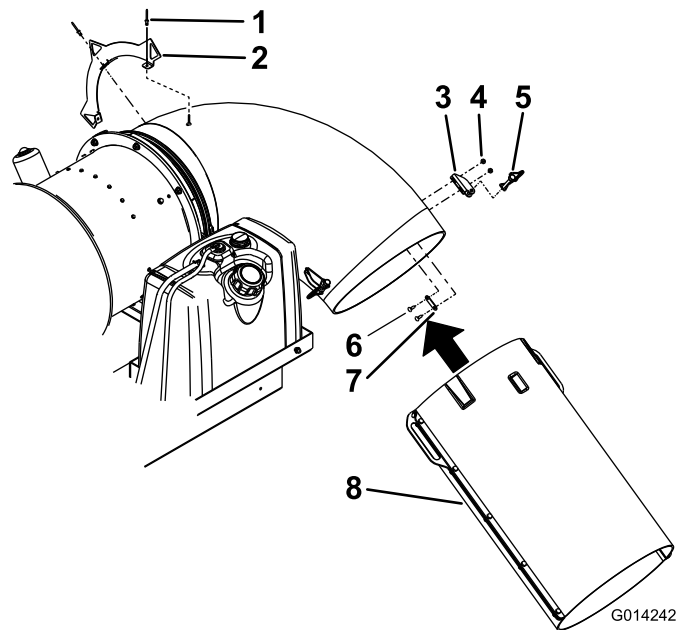

G014242

Figure 10

- | | |
|------------------------|--------------------------|
| 1. Rivot | 5. Hitch pin |
| 2. Position inditcator | 6. Carriage bolt (10-24) |
| 3. Chute bracket | 7. Nozzle mount |
| 4. Lock nut (10-24) | 8. Nozzle extension |

- Loosely install both chute brackets to the nozzle with 4 carriage bolts (10-24 x 5/8 inches), 2 nozzle mounts and 4 locknuts (10-24) (Figure 10).
- Install the extension onto the nozzle and attach it with the hitch pins. Tighten the chute brackets once the extension is installed (Figure 10).



Count on it.