



Belt Guard Kit
DH 200 Series Lawn Tractor
Model No. 120-1190

Form No. 3368-455 Rev A

Installation Instructions

Do not supply these instructions to the customer.

These instructions are for a dealer to install additional belt guards mandated by the French government.

Safety

Safety and Instructional Decals



Safety decals and instructions are easily visible to the operator and are located near any area of potential danger. Replace any decal that is damaged or lost.



120-1119

1. Fire hazard—read the *Operator's Manual*.

Installation

1

Preparing for Installation

No Parts Required

Procedure

Important: Refer to the *Operator's Manual* if you are unfamiliar with the specifics of operating this machine before proceeding. The manual contains important information about safely operating the machine. If you do not know this information, you could seriously injure yourself or others.

1. Park the machine on a level, smooth surface with sufficient space to access both sides of the mowing deck.
2. Lower the mowing deck to the shortest cutting height.

⚠ WARNING

Before working on the machine, stop the engine, set the parking brake, remove the ignition key, and disconnect the spark plug wire.

⚠ CAUTION

If you leave the key in the ignition switch, someone could accidentally start the engine and seriously injure you or other bystanders.

Remove the key from the ignition and disconnect the wire from the spark plug before you do any maintenance. Set the wire aside so that it does not accidentally contact the spark plug.

3. Support the rear axle on both sides and remove both rear wheels.

2

Installing the Deck Guard

Parts needed for this procedure:

1	Deck belt guard
2	Bolt (M5 x 12)
2	Washer (M5.3)
2	Locknut (M5)

Procedure

1. Remove the belt from the PTO clutch and the idler tension spring from the idler pulley (Figure 1).

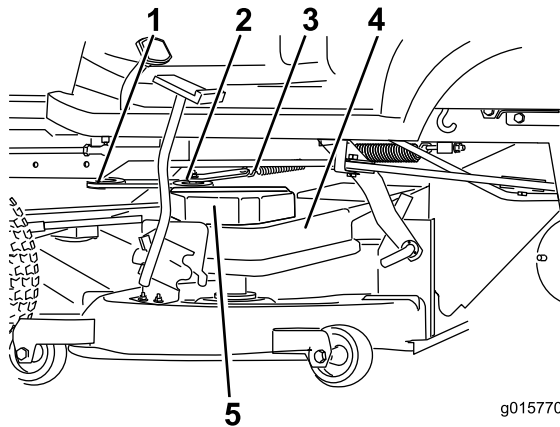

Figure 1

1. PTO clutch
2. Idler pulley
3. Idler tension spring
4. Deck cover
5. Pulley cover and pulley

2. Remove the idler pulley.
3. Remove the pulley cover and the pulley under it from the left side of deck belt cover (Figure 1).
4. Remove the deck belt cover from the deck.
5. Drill 2 holes in the top of the deck belt cover (Figure 2).

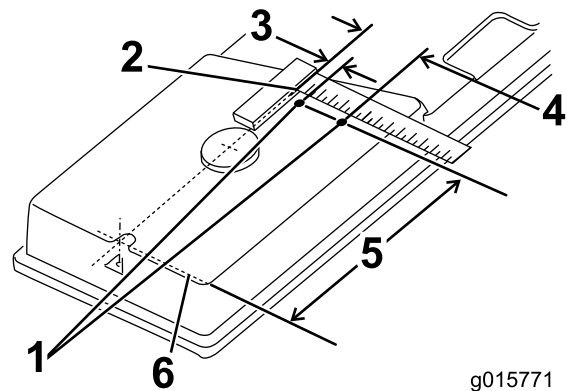

Figure 2

1. Drill 5.5 mm diameter (2)
2. Measure dimensions 3 and 4 from the line between the center of the right bolt hole and the center of the spindle.
3. 16 mm
4. 90 mm
5. 256 mm (2)
6. Measure dimension 5 from the centerline of the right bolt hole.

6. Mount the deck guard to the deck cover as shown in Figure 3.

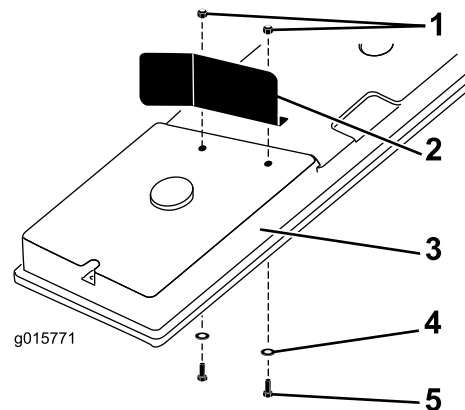

Figure 3

1. Locknut (M5)
2. Deck guard
3. Deck cover
4. Washer (M5.3)
5. Bolt (M5 x 12)

7. Assemble the deck.
8. Raise the deck to the tallest height-of-cut and verify that the newly installed guard clears all wires, switches and belts and will not interfere with the safe operation of the traction unit or the cutting deck.

3

Installing the Left Belt Guard

Parts needed for this procedure:

1	Left belt guard
1	Hex bolt (M8-1.25 x 12)
1	Washer (M8)
1	Locknut (NIM8-1.25)
2	Self-tapping screw (M4.2 x 13)

Procedure

1. On the left side of the machine, drill 2 holes as specified in Figure 4.

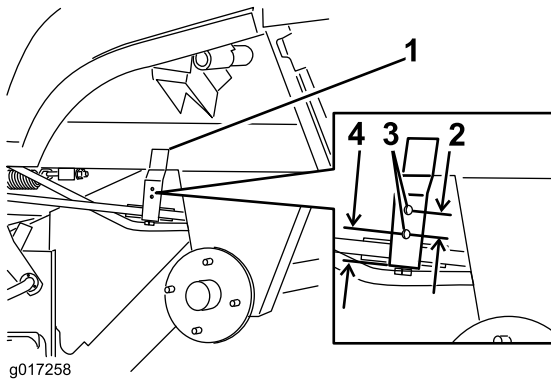

Figure 4

Measurements for drilling holes in the pulley bracket

1. Pulley bracket
 2. 25 mm
 3. 3.6 mm diameter (2)
 4. 35 mm
2. Remove the 2 locknuts located at both supports on the underside of the footrest.
 3. Install the left belt guard.

Note: Use the fasteners shown in Figure 5.

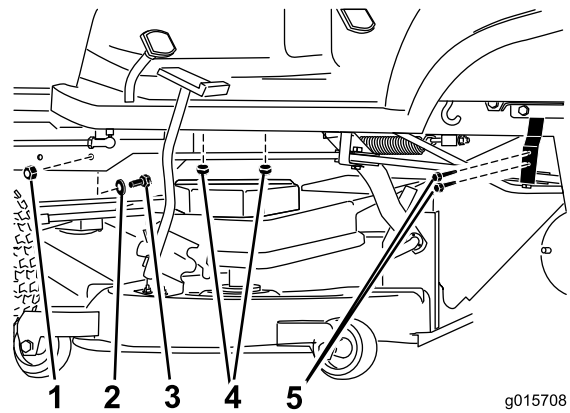

Figure 5

Fasteners and attachment points for the left belt guard

1. Locknut (NIM8-1.25)
2. Washer (M8)
3. Hex bolt (M8-1.25 x 12)
4. Locknut, existing (2)
5. Self-tapping screw (M4.2 x 13) (2)

Note: The installed left belt guard should appear as shown in Figure 6.

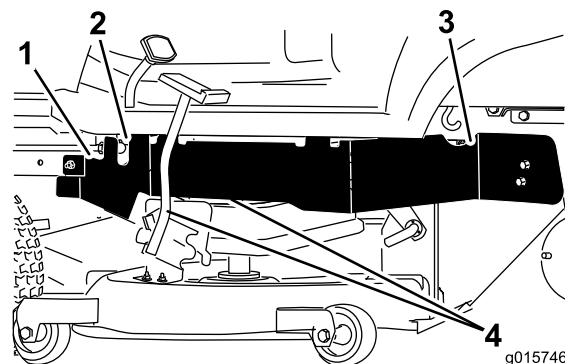

Figure 6

The left belt guard installed

1. Cutout for steering linkage
 2. Cutout for parking brake
 3. Cutout for the fuel line
 4. Guard passes between the bag-on-demand pedal and the pulley cover
4. Verify that the guard is clear of all moving parts across their full range of operation, that it will not cause damage to wires, hoses or other components and that it will not interfere with the safe operation of the traction unit or the cutting deck.

4

Installing the Right Belt Guard

Parts needed for this procedure:

1	Right belt guard
1	Hex bolt (M8-1.25 x 12)
1	Washer (M8)
1	Locknut (NIM8-1.25)
5	Self-tapping screw (M4.2 x 13)

Procedure

1. On the right side of the machine, drill holes in the pulley bracket, in the rear footrest support and in the front section of the frame (Figure 7).

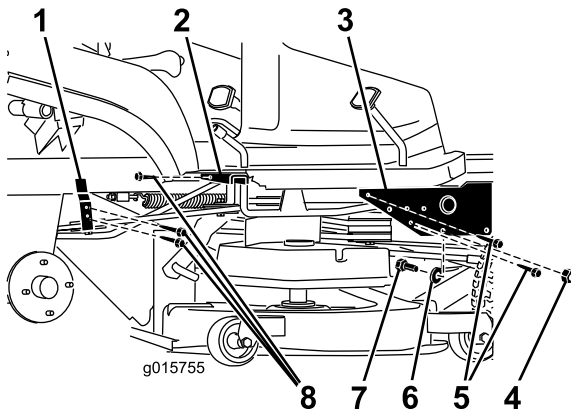

Figure 7

- | | |
|--------------------------|---------------------------------------|
| 1. Pulley bracket | 5. Self-tapping screw (M4.2 x 13) (2) |
| 2. Rear footrest support | 6. Washer (M8) |
| 3. Front frame section | 7. Hex bolt (M8-1.25 x 12) |
| 4. Locknut (NIM8-1.25) | 8. Self-tapping screw (M4.2 x 13) (3) |

- A. Measure the location for the holes in the pulley bracket as specified in Figure 4.
- B. For the hole in the rear footrest support, use the measurements in Figure 8.

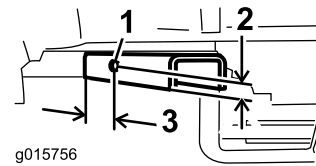

Figure 8

Measurements to drill hole in the rear footrest support

- | | |
|--------------------|----------|
| 1. 3.4 mm diameter | 3. 50 mm |
| 2. 11 mm | |

- C. Drill the holes in the front frame as specified in Figure 9.

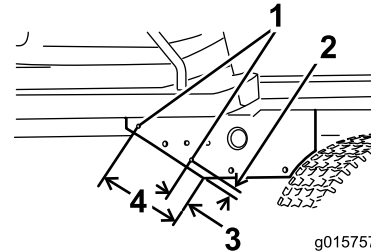

Figure 9

Measurements to drill holes in the front frame

- | | |
|------------------------|-------------|
| 1. 3.4 mm diameter (2) | 3. 25 mm |
| 2. 10 mm | 4. 152.5 mm |

2. Position the right belt guard behind the traction pedal assembly and the switch mounted behind it and attach it to the frame of the machine as shown in Figure 10.

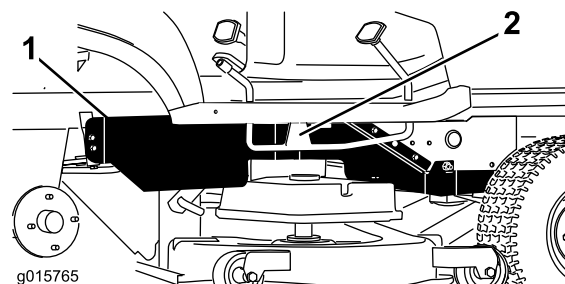

Figure 10

- | | |
|---------------------|----------------------------|
| 1. Right belt guard | 2. Traction pedal assembly |
|---------------------|----------------------------|

3. Verify that the guard is clear of all moving parts across their full range of operation, that it will not cause damage to wires, hoses or other components and that it will not interfere with the safe operation of the traction unit or the cutting deck.