

# Hour Meter Kit

## for Zero-Turn-Radius Riding Mower

Model No. 108-7158

### Installation Instructions

**Note:** Determine the left and right sides of the machine from the normal operating position.

## Installation

### Loose Parts

Use the chart below to verify that all parts have been shipped.

| Procedure | Description                    | Qty. | Use                             |
|-----------|--------------------------------|------|---------------------------------|
| <b>2</b>  | Hour meter                     | 1    | Install the hour meter.         |
|           | Mounting clip (some kits only) | 1    |                                 |
|           | Self tapping screw             | 2    |                                 |
| <b>3</b>  | Wiring harness                 | 1    | Install the hour meter harness. |

# 1

## Preparing the Machine

### No Parts Required

### Procedure

1. Park the machine on a level surface and disengage the blade control switch.
2. Move the motion control levers outward to the park position, stop the engine, remove the key, and wait for all moving parts to stop before leaving the operating position.
3. Lift the seat forward to access the battery, frame and wiring harness.
4. Locate the battery and negative terminal.



**Servicing a machine with a live electrical system can result in electric shock.**

**Always *disconnect* the negative (black) battery cable before performing any service on the machine.**

5. Disconnect the negative (black) ground cable from the battery post. Retain all fasteners.



**Incorrect battery cable routing could damage the machine and cables causing sparks. Sparks can cause the battery gasses to explode, resulting in personal injury.**

- Always *disconnect* the negative (black) battery cable before disconnecting the positive (red) cable.
- Always *connect* the positive (red) battery cable before connecting the negative (black) cable.

# 2

## Installing the Hour Meter

### Parts needed for this procedure:

|   |                                |
|---|--------------------------------|
| 1 | Hour meter                     |
| 1 | Mounting clip (some kits only) |
| 2 | Self tapping screw             |

### Assemble the Hour Meter

Locate and inspect the hourmeter in loose parts.

- For hourmeters with a separate mounting clip:  
Install the hour meter to the bracket with a mounting clip as shown in Figure 1.

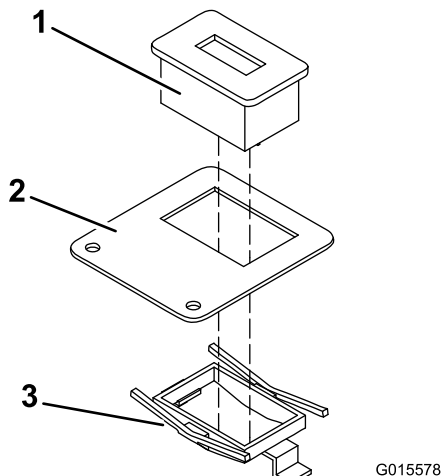

**Figure 1**

- |               |                  |
|---------------|------------------|
| 1. Hour meter | 3. Mounting clip |
| 2. Bracket    |                  |

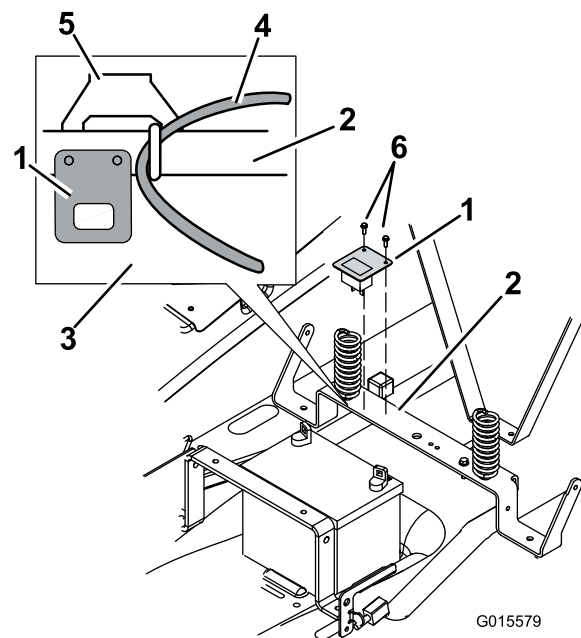

**Figure 3**

- |                                  |                           |
|----------------------------------|---------------------------|
| 1. Hour meter and bracket        | 4. Positive battery cable |
| 2. Seat support                  | 5. Fuse block             |
| 3. Top view of frame and bracket | 6. Screws                 |

- For hourmeters with integrated mounting clips:  
Install the hour meter to the bracket as shown in Figure 2.

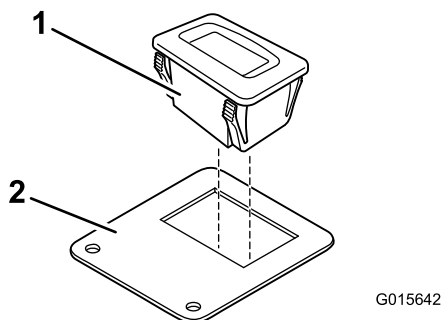

**Figure 2**

- |               |            |
|---------------|------------|
| 1. Hour meter | 2. Bracket |
|---------------|------------|

- Drill two 11/32 inch diameter holes at the spots marked.
- Use the self tapping screws to install the bracket onto the seat support in the orientation shown in Figure 3.

## For Machines with Welded Frames

Install the hour meter assembly to the location described in Figure 4 for any machines with a welded frame.

- Using the bracket as a template, mark the two spots to be drilled at the approximate location on the frame shown in Figure 4.

**Note:** Lower seat before drilling to verify the seat support springs will not interfere with the hour meter bracket. Adjust bracket placement as necessary.

## For Machines with Stamped Frames

Install the hour meter assembly to the location described in Figure 3 for any machines with a stamped frame.

- Using the bracket as a template, mark the two spots to be drilled at the approximate location on the seat support shown in Figure 3.

**Note:** Place the bracket so it does not interfere with the routing of the positive battery cable (Figure 3).

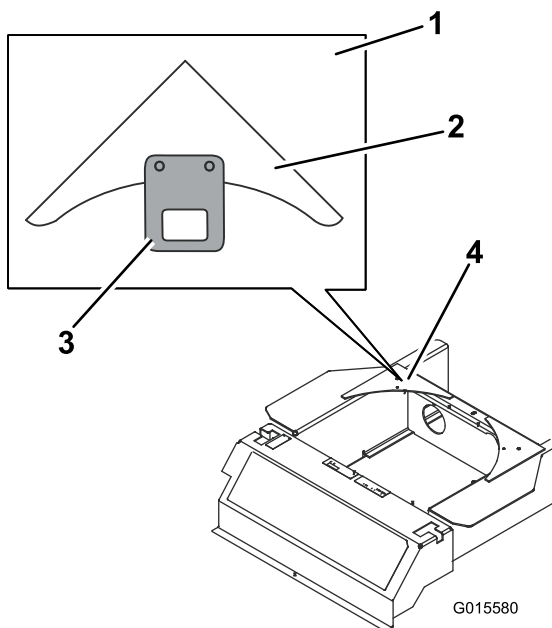

**Figure 4**

1. Top view of frame and bracket
2. Welded angle on frame
3. Hour meter and bracket
4. Frame under seat

2. Drill two 11/32 inch diameter holes at the spots marked.
3. Use the self tapping screws to install the bracket onto the machine frame in the orientation shown in Figure 4.

# 3

## Connecting the Hour Meter

### Parts needed for this procedure:

|   |                |
|---|----------------|
| 1 | Wiring harness |
|---|----------------|

### Procedure

1. Locate the hour meter wiring harness in loose parts.
2. Locate the female connectors at the end of the wiring harness.
3. Install the positive female connector (red wire) to the positive male plug and install the negative female connector (black wire) to the negative male plug (Figure 5).

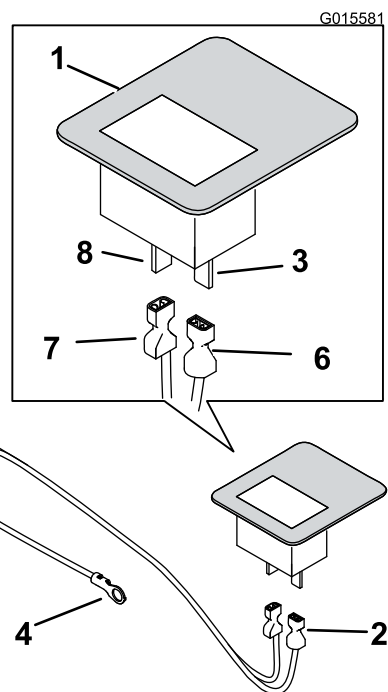

**Figure 5**

1. Hour meter
2. Female connectors, wiring harness
3. Positive male plug
4. Ring connector, wiring harness
5. Piggy back terminal, wiring harness
6. Positive connector (red wire)
7. Negative connector (black wire)
8. Negative male plug

**Note:** For hourmeters with integrated mounting clips there are three spade connectors on the back. Use Figure 6 to determine the positive and negative connectors.

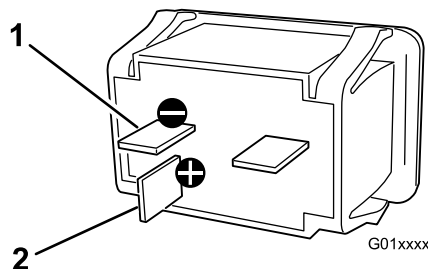

**Figure 6**

Hourmeters with integrated mounting clip

1. Negative connector
2. Positive connector

4. Locate the piggy back terminal at the opposite end of the wiring harness (Figure 5).
5. Route the piggy back terminal to the under side of the control panel and locate the ignition switch base (Figure 7).

**Note:** Depending on the machine, it may be necessary to remove the four screws securing the

control panel to the console to access the ignition switch base.

6. Remove the single wire from the outer terminal at the base of the ignition switch (Figure 7).

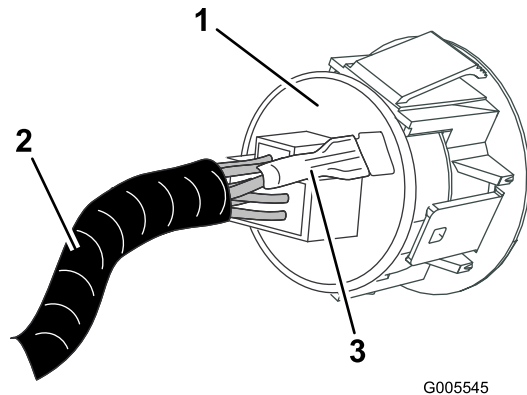

**Figure 7**

- |                         |                                   |
|-------------------------|-----------------------------------|
| 1. Ignition switch base | 3. Single wire and outer terminal |
| 2. Wiring harness       |                                   |

7. Install the piggy back terminal to the open terminal and install wire removed previously over it (Figure 8).

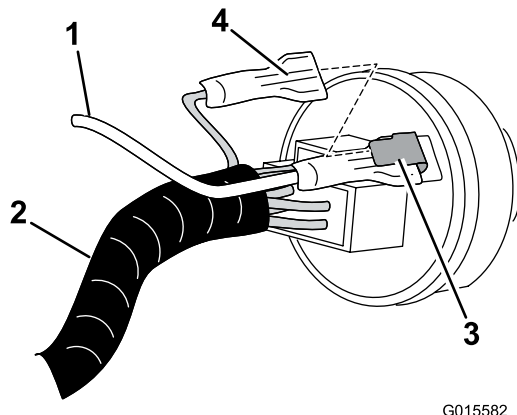

**Figure 8**

- |                         |                                   |
|-------------------------|-----------------------------------|
| 1. Lead from hour meter | 3. Piggy back terminal            |
| 2. Wiring harness       | 4. Single wire removed previously |

8. Route the remaining ring terminal on the hour meter harness to the negative battery post. Secure the hour meter ring terminal and negative battery cable to the negative terminal using the existing fasteners.
9. Verify the display has power by turning the ignition key to run.

# Operation

## Hour Meter Operation

The hour meter will run when the ignition key is in the Run position. An hourglass symbol flashes on the meter display when it is running.