



# Rear Roller Scraper Kit with Roller

## 18in and 21in Greensmaster® Flex™ Cutting Reel

Model No. 120-9627

Model No. 115-7383

Form No. 3369-651 Rev A

### Installation Instructions

1. Place the cutting unit on a level surface.
2. Remove the (2) capscrews and nuts securing the roller clamps to each end of the cutting unit (Figure 1). Remove the roller.

**Note:** Replace the roller with the roller/scraper assembly included in the kit. Use the following instructions to verify that the scraper is properly adjusted.

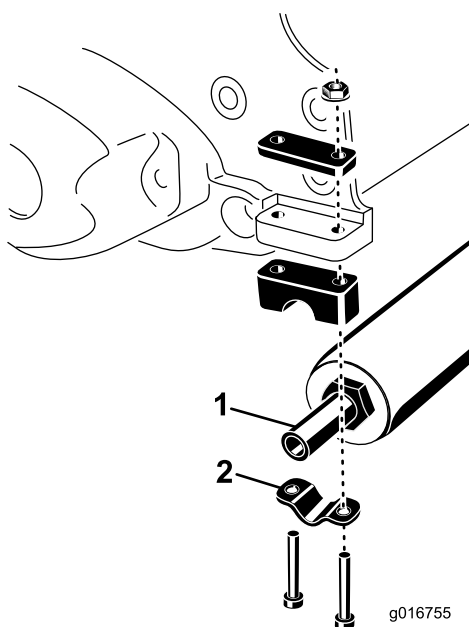

Figure 1

1. Rear roller
2. Roller clamp

8. Rotate the scraper until the bottom edge is approximately 1/4 inch (6.4 mm) from the ground.
9. Tighten all the capscrews and nuts.

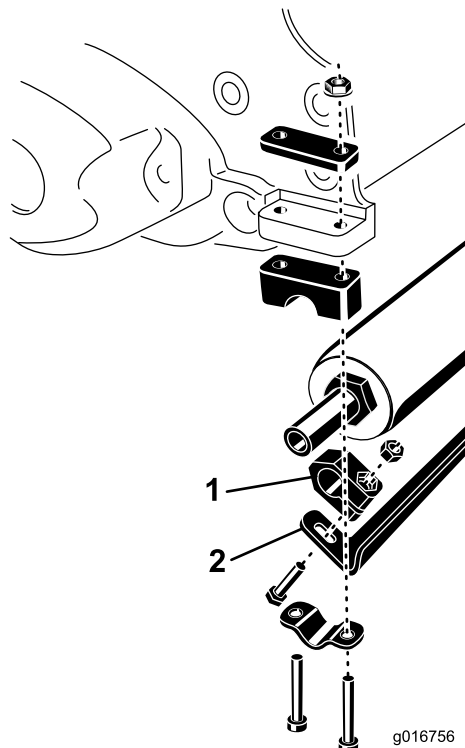

Figure 2

1. Clamp block
2. Roller scraper

3. Loosely install the roller scraper to each end of the roller with a clamp block, capscrew and nut. Position the components as shown in Figure 2.
4. Loosely install the roller to the cutting unit with the capscrews, clamps and nuts previously removed (Figure 2).
5. Center the roller on the cutting unit and tighten the roller clamp capscrews and nuts (Figure 2).
6. Center the scraper on the roller.
7. Move the scraper in or out in the clamps until the clearance between the scraper bar and roller is .015 to .030 inches (.38 to .76 cm). Make sure the scraper is parallel to the roller and the level surface.