



Auxiliary Power Point Kit

Groundsmaster 360 Traction Unit

Model No. 120-6675

Installation Instructions

Loose Parts

Use the chart below to verify that all parts have been shipped.

Procedure	Description	Qty.	Use
1	No parts required	–	Disconnect the battery
2	Power point body Power point bracket Power point cover	1 1 1	Install the power point
3	Switch Decal Hole plug	1 1 1	Install the switch
4	Fuse block 10-amp blade fuse Hex washer-head screw Locknut	1 1 2 2	Install the fuse block
5	Wiring harness	1	Install the wire harness
6	No parts required	–	Connect the battery

Media and Additional Parts

Description	Qty.	Use
Installation Instructions	1	Use to aid in the installation of the kit
Parts Catalog	1	Use to reference part numbers

Important: The Groundsmaster 360 must be equipped with the **Quick Attach Front Frame Kit, Model 30509** to operate the Auxiliary Power Point Kit.

1

Disconnecting the Battery

No Parts Required

Procedure

1. Park the machine on a level surface, and lower the mower deck and any attachments to the ground.

2. Stop the engine, wait for all moving parts to stop, engage the parking brake, and remove the key from the ignition switch.
3. Disconnect the negative (–) battery cable from the battery.

▲ WARNING

Wear safety goggles and rubber gloves when working with batteries. Since the gases are explosive, keep open flames and electrical sparks away from batteries. Do not smoke near the battery.

4. Move the seat latch (located on the left-hand side of the seat) rearward to unlatch the seat, then pull forward on the top of the seat until the seat latch catches the supporting seat plate (Figure 1).

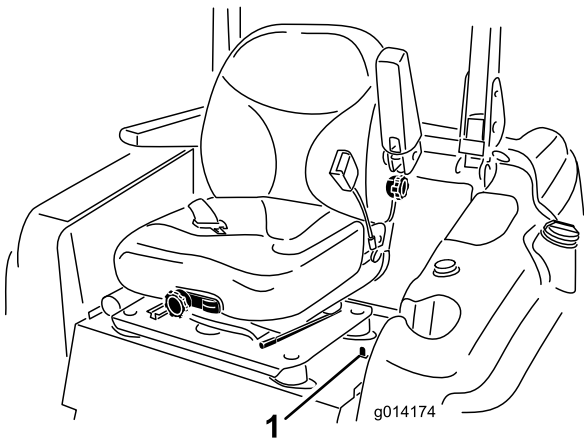

Figure 1

1. Seat latch

3. Plug the wire harness connectors onto the power point terminals. The yellow wire goes to the positive terminal (+) and the blue wire goes to negative terminal (-).
4. Assemble the power point cover to the bracket, ensuring that the covering on the wiring harness is captured by the slot at the rear of the bracket.
5. Remove the nut from the R-clamp bolt that secures the right front traction hose (Figure 3)

2

Installing the Power Point

Parts needed for this procedure:

1	Power point body
1	Power point bracket
1	Power point cover

Procedure

1. Unscrew the nut from the threaded power point connector body (Figure 2).
2. Insert the power point connector body into the hole in the front of the bracket and secure it with the nut previously removed (Figure 2).

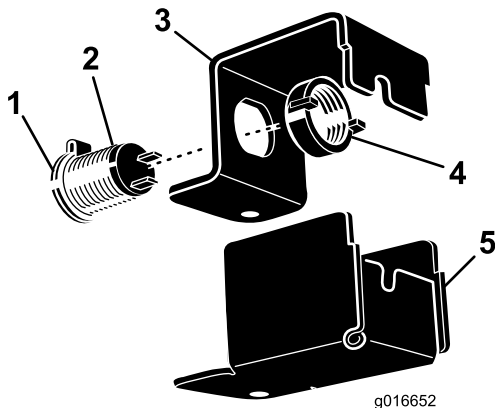

Figure 2

1. Sealing cap
2. Power point connector body
3. Power point bracket
4. Nut
5. Power point cover

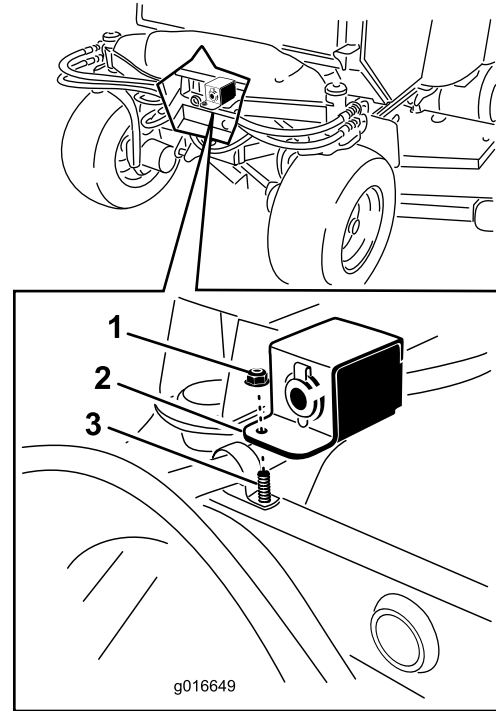

Figure 3

1. R-clamp nut
2. Power point assembly
3. R-clamp bolt

6. Install the power point bracket and cover box onto the bolt and secure it with the nut previously removed (Figure 3).
7. Close the sealing cap when the power point is not in use (Figure 2).

3

Installing the Switch

Parts needed for this procedure:

1	Switch
1	Decal
1	Hole plug

Procedure

- To access the control panel, proceed as follows:
 - For a machine with a cab: Remove the (2) fasteners that secure the access panel and remove the access panel.
 - For a machine without a cab: Remove the (5) fasteners that secure the control panel cover and remove the control panel cover.
- Locate the (2) knockouts, under the decal, on the rear of the control panel (Figure 4).
- Trim the control panel decal with a utility knife to prevent it from tearing.
- Remove the (2) knockouts from the control panel (Figure 4).

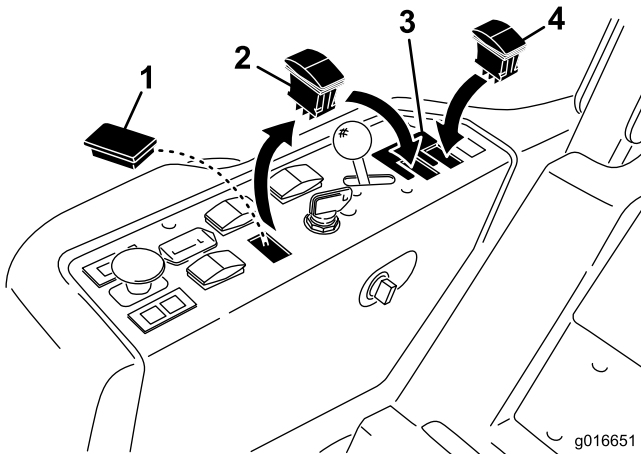

Figure 4

- | | |
|---|------------------------------------|
| 1. Hole plug | 3. Decal |
| 2. Remove this switch and install in new front hole | 4. Install new switch in rear hole |

Note: Remove any burrs from the knockout holes with a metal file.

- Affix the new decal onto the control panel in the location shown in Figure 4.
- Unplug and remove the switch on the control panel in front of the ignition switch and insert it into the

new **front** hole location shown in Figure 4. Plug the harness back into the switch.

Note: The switch must be installed in the new front hole.

- Install the switch, included in kit, in the new **rear** hole in the control panel (Figure 4).
- Install the plug in the vacated hole in the control panel (Figure 4).

4

Installing the Fuse Block

Parts needed for this procedure:

1	Fuse block
1	10-amp blade fuse
2	Hex washer-head screw
2	Locknut

Procedure

- Secure the fuse block to the seat support frame under the seat with the (2) hex washer head screws and (2) locknuts as shown in Figure 5.

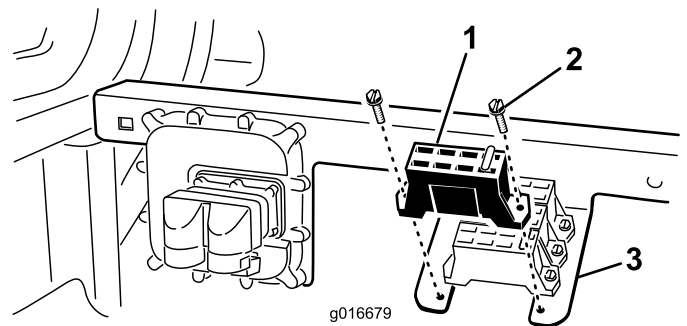

Figure 5

- | | |
|--------------------------|-----------------------|
| 1. Fuse block | 3. Seat support frame |
| 2. Hex washer head screw | |

- Insert the 10 amp fuse into the fuse block at the location shown in Figure 5.
- Unplug the existing attachment fuse block wire from the traction unit wire harness.

Note: This is the fuse block added for the Quick Attach Front Frame Kit .

- Plug the wires from the new fuse block into the connectors vacated in the previous step.

5

Installing the Wire Harness

Parts needed for this procedure:

1	Wiring harness
---	----------------

Procedure

1. Route the wiring harness from the power point box along the hydraulic hard line on the right hand side of the machine to the control panel.
 2. Plug the harness connector onto the new switch.
 3. Install the control panel, as follows:
 - For a machine with a cab: Install the control panel cover and secure the fasteners.
 - For a machine without a cab: Install the control panel to the tank cover with the screws previously removed.
- Note:** Torque the screws to 25 in-lb (2.8 N-m).
Do not overtighten the screws.
4. Continue to route the wiring harness from the control panel to the fuse block following the main wiring harness under the seat support channel.
 5. Connect the terminal from the wiring harness to the connector on the fuse block.
 6. Connect the ring terminal to the ground block.

Important: Ensure that the wiring harness is clear of all hot, sharp, or moving components.

6

Connecting the Battery

No Parts Required

Procedure

Connect the negative (–) battery cable to the battery.

Note: When the kit is properly installed, the power point and fuse block should only have power when the traction unit ignition switch is in the ON position.

Operation

Switch Functions

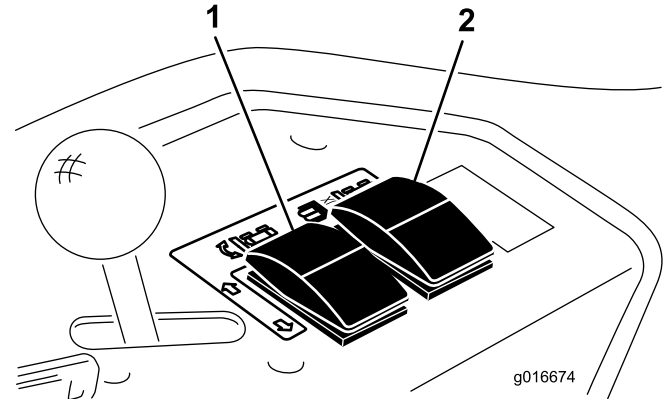

Figure 6

1. Switch #1

2. Switch #2

Snow Blower

- Pressing the front or back of switch #1 will rotate the discharge chute to the right or left.
- Pressing the front or back of switch #2 will pivot the discharge chute up or down.

V-Plow*

- Pressing the front or back of switch #1 will pivot the left V-plow blade forward or rearward.
- Pressing the front or back of switch #2 while holding down switch #2 will pivot the right V-plow blade forward or backward.

* Attachment operation may vary depending on manufacturer.