



# Replacement Coupler Kit

## Sand Pro 3040 and 5040 Traction Unit

Model No. 120-3477

Form No. 3369-752 Rev A

### Installation Instructions

## Loose Parts

Use the chart below to verify that all parts have been shipped.

Procedure	Description	Qty.	Use
1	Rubber coupler	1	Installing the kit.
	Hex-head bolt	4	
	Locknut	4	
	Pump hub	1	
	Engine hub	1	
	Square-head set screw (1/2 inch)	3	
	Square-head set screw (3/4 inch)	1	

1

## Parts needed for this procedure:

1	Rubber coupler
4	Hex-head bolt
4	Locknut
1	Pump hub
1	Engine hub
3	Square-head set screw (1/2 inch)
1	Square-head set screw (3/4 inch)

## Procedure

1. Remove the shield that covers the hydrostat.
2. Remove the 4 bolts, 4 spacers, and 4 nuts shown in Figure 1 so that one rubber disk and the center coupler remain assembled.

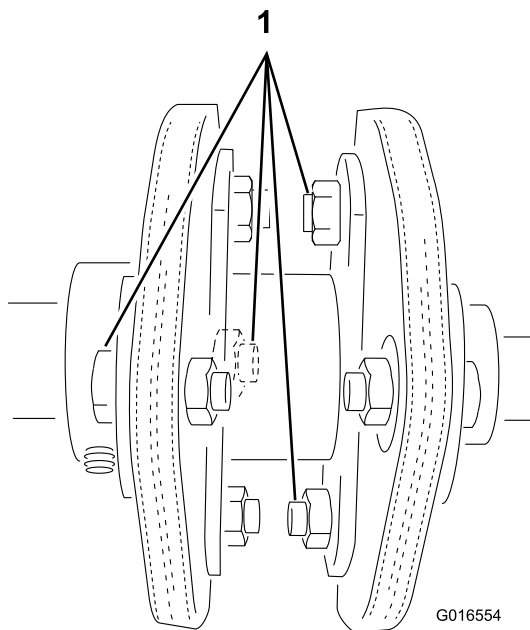
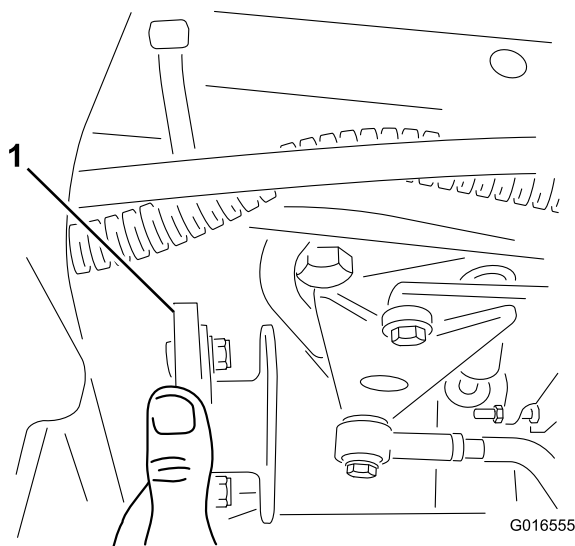

Figure 1

1. Remove these fasteners
3. Pull the one disk and middle coupler out from the side of the engine cradle and traction unit (Figure 2).



**Figure 2**

1. Disk and middle coupler

4. Remove the other hub and the hub and disk by removing the square-head set screws on the hubs and carefully sliding the hubs off the shafts.

**Note:** Slide the hubs off the shafts carefully to save the keystone in each hub for future use.

5. Install the new engine hub but do not tighten the 2 set screws (1/2 inch).
6. Install the new pump hub, ensuring that the 1/2-inch set screw is in the key location and the 3/4-inch set screw is used in the full-depth location.

**Important:** Do not yet tighten these set screws, because doing so may pre-load the coupler and severely reduce the operating life of the coupler components.

7. Insert the rubber coupler and fasten it to the engine and pump cast couplers with the hardware from loose parts.

**Note:** Mount the cast couplers onto the raised lugs as shown in Figure 3.

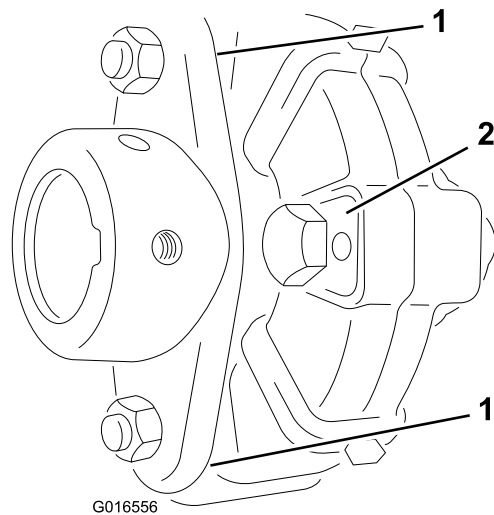

**Figure 3**

1. Raised lug
2. Recessed lug

**Note:** The assembly has been removed for the purpose of clarity.

8. Start the engine and idle the machine for 15 to 30 seconds to allow the assembly to locate itself on the shafts.
9. Stop the engine and tighten all 4 set screws.
10. Install the hydrostat cover.